

Single door type

1-Inside Room; 2-Outside Room.

When confirming the direction, we default to the way you open the door when you stand outdoors and need to enter the room.

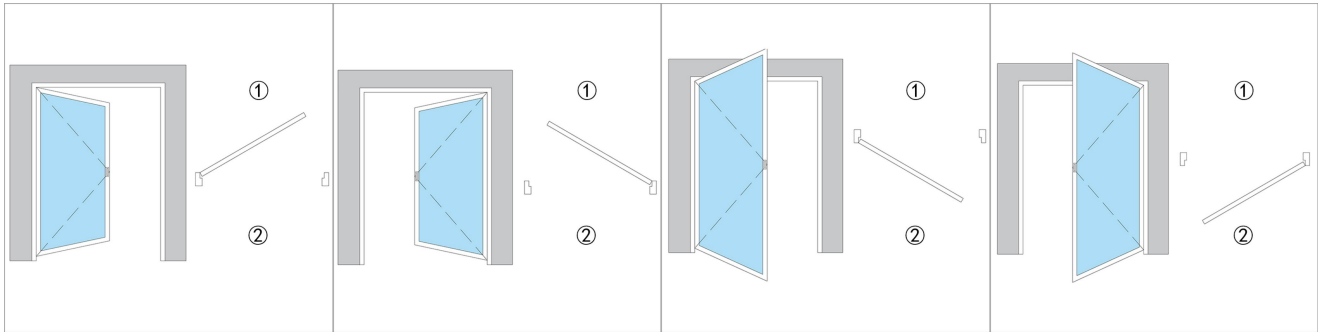

A1=Right Lock Inswing

A2=Left Lock Inswing

A3=Right Lock Outswing

A4=Left Lock Outswing

Double unequal door type

1-Inside Room; 2-Outside Room.

When confirming the direction, we default to the way you open the door when you stand outdoors and need to enter the room. For Double Unequal Door, when the narrow door is not normally open, it can be fixed with a bolt. The small door can be opened when needed.

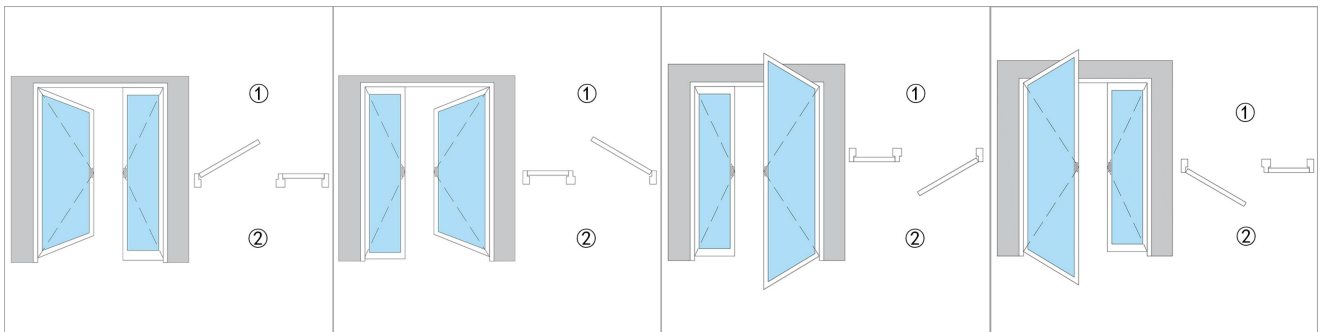

B1=Left Active Inswing

B2=Right Active Inswing

B3=Right Active Outswing

B4=Left Active Outswing

Double door type

1-Inside Room; 2-Outside Room.

When confirming the direction, we default to the way you open the door when you stand outdoors and need to enter the room. For Double Door, the door leaf that don't open often will have door latches fixed.

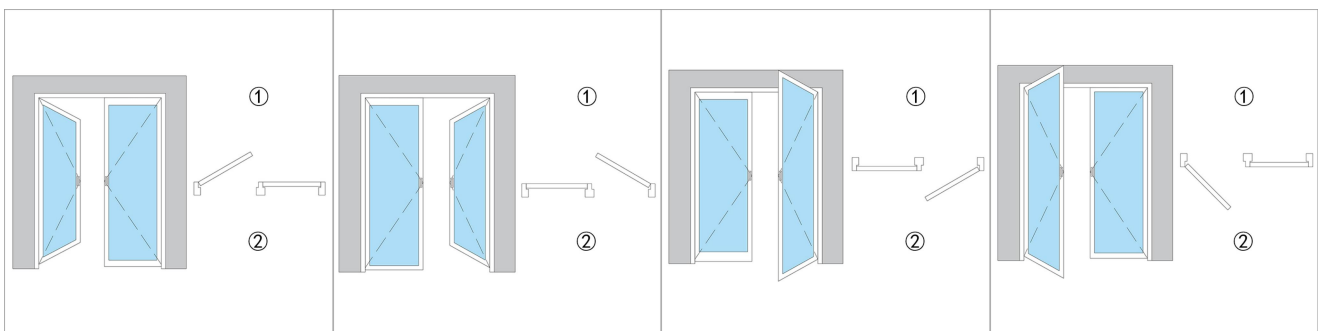

C1=Left Active Inswing

C2=Right Active Inswing

C3=Right Active Outswing

C4=Left Active Outswing

Aluminum window open way

1-Inside Room; 2-Outside Room.

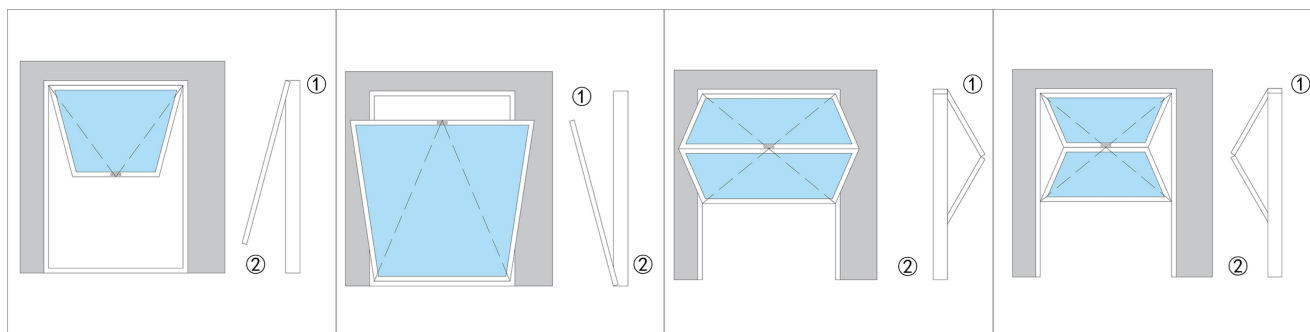

W1=Overing window

W2=Lower Hanging

W3=Indoor Folding Up&Down

W4=Outdoor Folding Up&Down

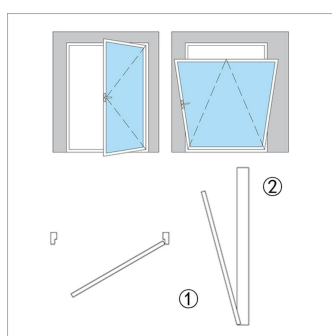

W5=Aluminium Tilt Turn

Pivot Door Open Way

1-Inside Room; 2-Outside Room When confirming the diredtion, we default to the way you open the door when you stand outdoors and need to enter the room.

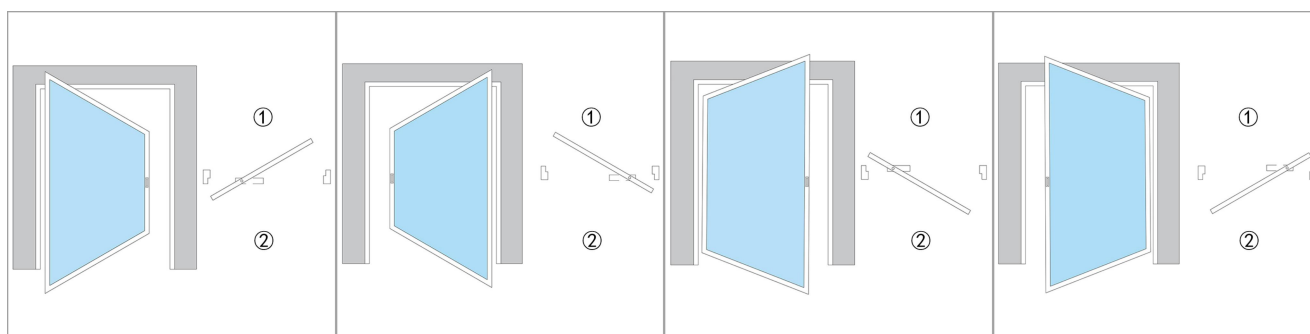

PD1=Right Lock Inswing

PD2=Left Lock Inswing

PD3=Right Lock Outswing

PD4=Left Lock Outswing

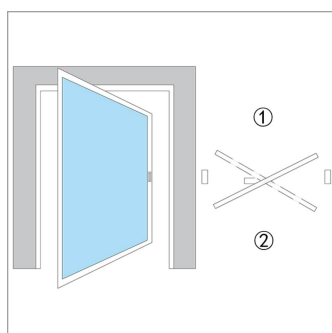

PD5=Flat Frame Middle Floor Hinge

Aluminum Bifold Door Open Way

1-Inside Room; 2-Outside Room

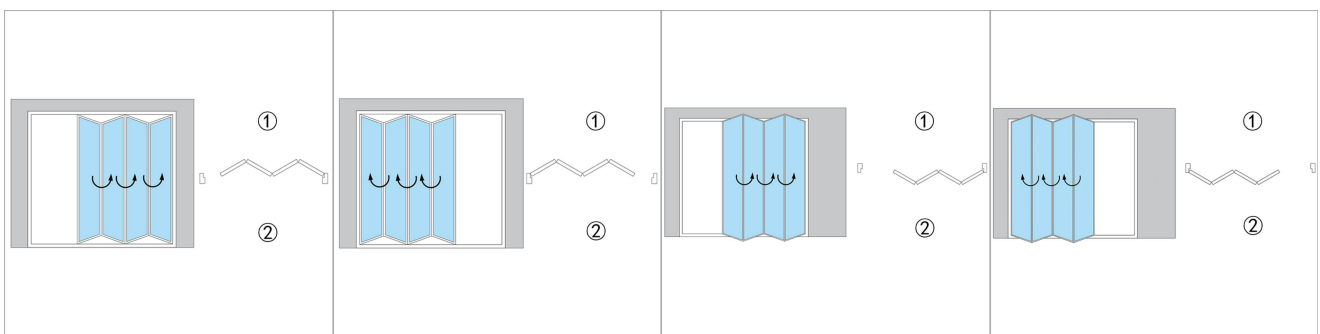
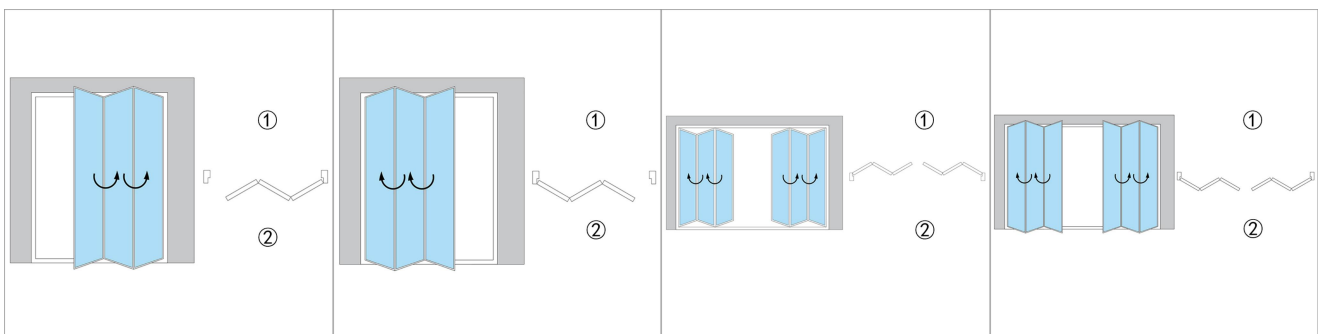
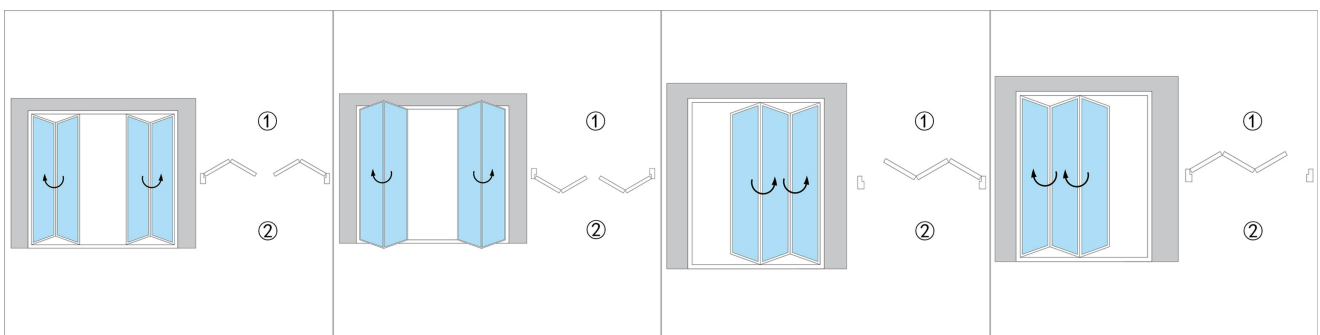
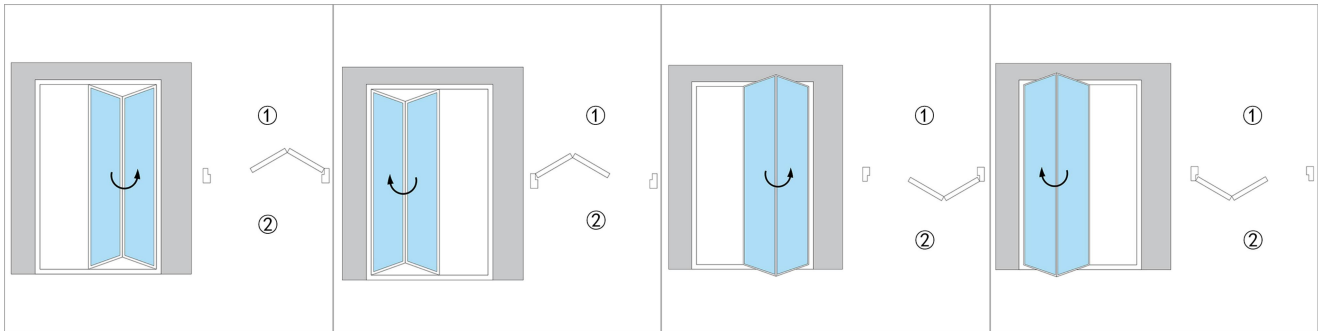

Aluminum Sliding Door Open Way

1-Inside Room; 2-Outside Room

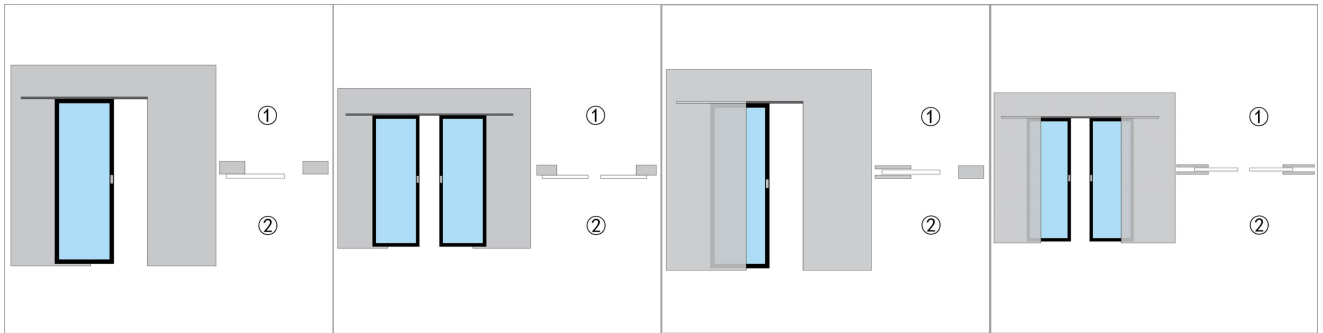

S1=Single Sliding Door

S2=Single Track External
Different Direction Linkage
Door

P1=Single Sliding Pocket Door

P2=Single Track Double
Opsite Pocket Door

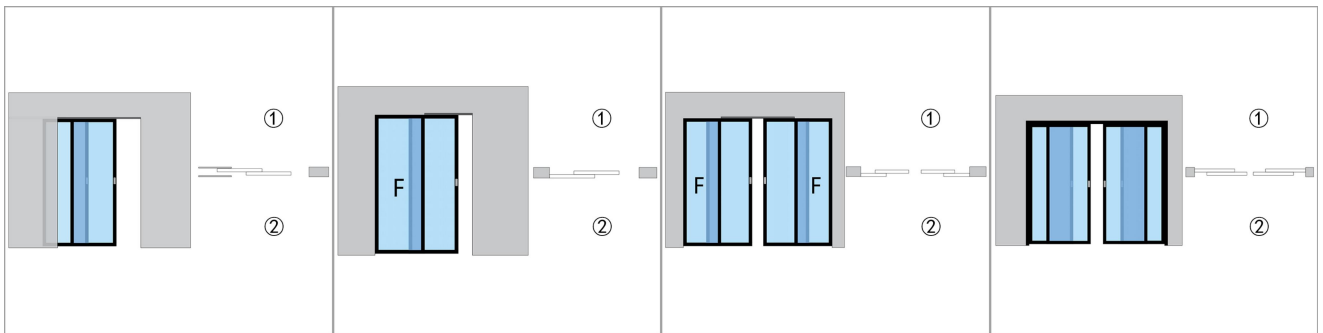

P3=2-Rail Linkage Pocket
Door

FS1=Single Fixed Plus Single
Sliding Door

FS2=2 Track 4-Door
Panels,Middle Door Leaf Inside
Room

FS3=2 Track 4 Door Panels +
Opposite Direction

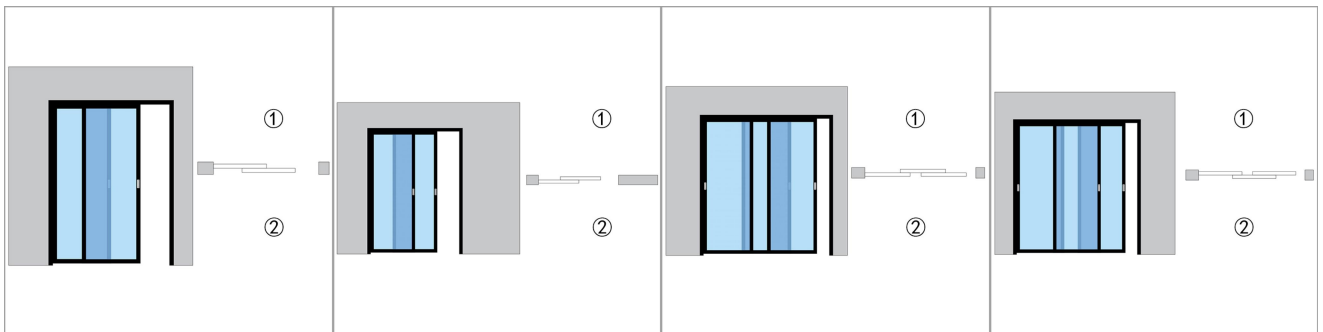

DS1=2 Tracks 2-Door
Leaf,Right Leaf At Outside

DS2=2 Tracks 2-Door Leaf,
Left Leaf At Outside

TS1=2 Track 3-Leafs,Middle
Leat At Inside Room

TS2=2 Track 3-Leafs,Middle
Leat At Outside Room

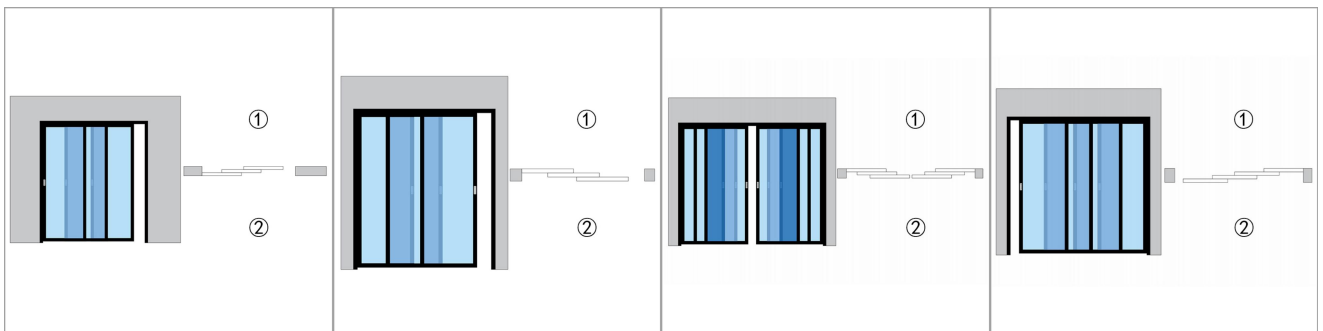

LS1=3 Linkage Door + Left
Door Leaf At Outside

LS2=3 Linkage Door Right
Door Leaf At Outside

LS3=3 Linkage 6 Door Leafs &
Open Opposite Direction

BFS1=4 Linkage 4 Doors Left
Door Leaf At Outside

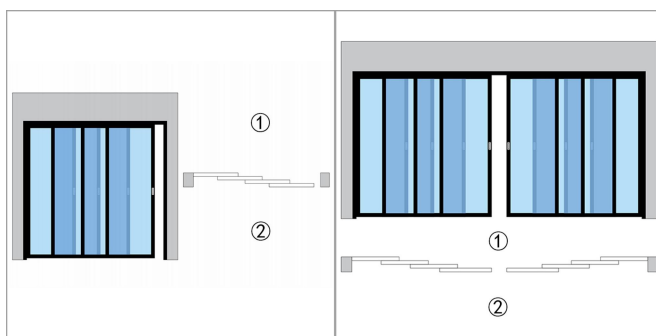

BFS2=4 Linkage 4 Doors Right
Door Leat At Outside

BFS3=4 Linkage 8 Doors
Opposite Direction