

01

Floor Hinge



Floor Hinge List

Diagram	Code	Location type	Door width	Maximum Loading	Life cycle	Speed control	page
	HD101/HDF101	90°/Non-hold	650~1050mm	100Kg	>500,000 Cycles	One speed section	P3
	HD102	90°	650~900mm	90Kg	>300,000 Cycles	One speed section	P5
	HD103/ BDH10003(New)	90°/Non-hold	600~950mm	65Kg	>300,000 Cycles	One speed section	P7
	HD201	90°	650~1050mm	90Kg	>500,000 Cycles	Two speed section	P9
	BDH20114	90°	650~750mm (Unilateral)	85~100Kg	>500,000 Cycles	Two speed section	P11
	BDH20314/ BDH20304(New)	90°/Non-hold	650~1050mm	100Kg	>500,000 Cycles	Two speed section	P13
	BDH20315/ BDH20305(New)	90°/Non-hold	800~1200mm	130Kg	>500,000 Cycles	Two speed section	P15
	HD203/HDF203	90°/Non-hold	650~1050mm	100Kg	>1,000,000 Cycles	Two speed section	P17
	HD204	90°	750~1100mm	115Kg	>1,000,000 Cycles	Two speed section	P19
	HD205/HDF205	90°/Non-hold	800~1200mm	130Kg	>1,000,000 Cycles	Two speed section	P21
	HD304	90°/120°-180° hold	650~1050mm	100Kg	>1,000,000 Cycles	Two speed section	P23
	HD305	90°/120°-180° hold	800~1200mm	130Kg	>1,000,000 Cycles	Two speed section	P25
	HD403	90°	650~1050mm	100Kg	>1,000,000 Cycles	Two speed section	P27
	HD405	90°	800~1200mm	130Kg	>1,000,000 Cycles	Two speed section	P29
	HD406/HDF406	90°/Non-hold	1100~1300mm	150Kg	>1,000,000 Cycles	Two speed section	P31
	BDH40017	90°	1150~1400mm	180Kg	>1,000,000 Cycles	Two speed section	P33
	HD407/BDH40008	90°/Non-hold	1200~1400mm	200Kg	>1,000,000 Cycles	Two speed section	P35
	BDH50011/ BDH50001	90°/Non-hold	1200~1400mm	250Kg	>500,000 Cycles	Two speed section	P37
	BDH50012	90°	Door width: 1200~1500mm Maximum Door high: 3200mm	300Kg	>500,000 Cycles	Two speed section	P39
	BDH50013	90°	Door width: 1200~1500mm Maximum Door high: 3800mm	350Kg	>500,000 Cycles	Two speed section	P41
	BDH50014	90°	Door width: 1200~1500mm Maximum Door high: 4200mm	400Kg	>500,000 Cycles	Two speed section	P43
	BDH60015(New)	90°	800~1000mm	85Kg	>500,000 Cycles	Two speed section	P45
	BDH60016(New)	90°	800~1200mm	100Kg	>500,000 Cycles	Two speed section	P45
	BDH70014	90°~130°hold	650~800mm	85Kg	>300,000 Cycles	Two speed section	P48
	BDH70015	90°~130°hold	750~900mm	100Kg	>300,000 Cycles	Two speed section	P48



HD101 / HDF101 Floor Hinge

Product Drawing

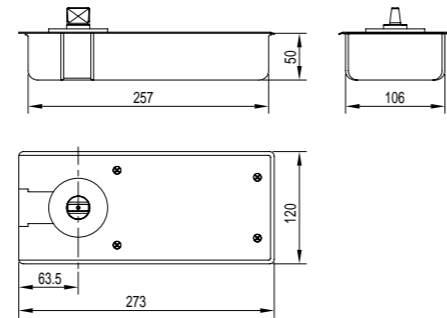

Functional Characteristic

Passed the test of industrial standard QB/T 2697
 Passed the test of SGS & DGM
 Passed the test of EN1154 standard of door closing detection
 Originate the special filler with anti-rust, water proof, keep warm, insect prevention
 It can be used on both left and right side door
 Bidirection opening and the single side opening should be achieved by auxiliary method
 Suit for wooden door, metal door, glass door, frame door

Technical Parameters

Location type: 90°/Non-hold
 Door width: 650~1050mm
 Maximum Loading: 100kg
 Life cycle: >500,000 Cycles
 Main Material: Main body-Gray cast-iron; Cover plate—SS304
 Speed control: One speed section
 Suitable Temperature: -15°C~40°C
 Surface of the cover plate: 400#Hairline
 Max open degree: 120°
 Structure of main body: Single cylinder
 Cover plate thickness: 1.2mm
 Spindle: 14°or 6°

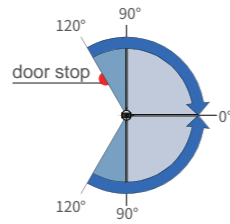

Application Performance

Speed-section 1 closed The buffer
 0°is closing , 90° is location
 Graphics HD101, HDF101 has not 90°hold function
 To prevent the door from opening beyond the maximum angle, it is recommended to install the door stopper.

Adjustment diagram

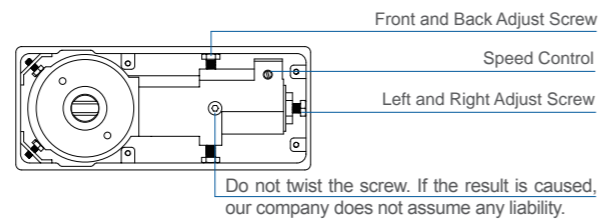

Direction diagram	Name	Adjustment
Up and down	Up and down	—
Left and right	Left and right	6mm
Front and back	Front and back	4mm

Accessory products

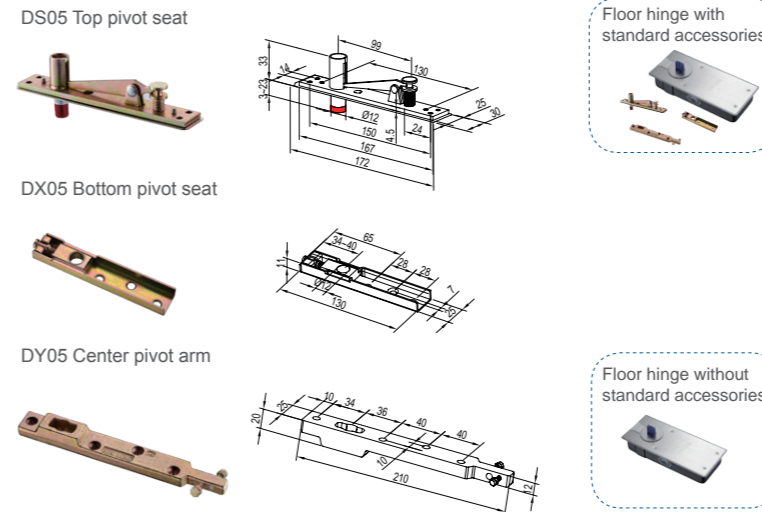

- ◆When it is used for the wooden door, metal door, frame door, please select the standard accessories
- ◆When it is used for the frameless glass door, please select floor hinge without accessories and the pivot hinge hardware (As below)

No.	Products	Page
1	Patch fitting	P126-P130
2	Brackets	P139-P142
3	Long patch fitting	P145-P146

Spindle can be heightened(Please remark before ordering if required)

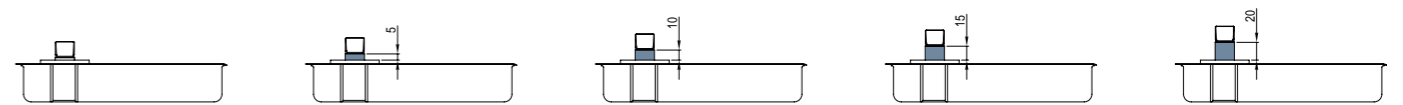

Installation Diagram

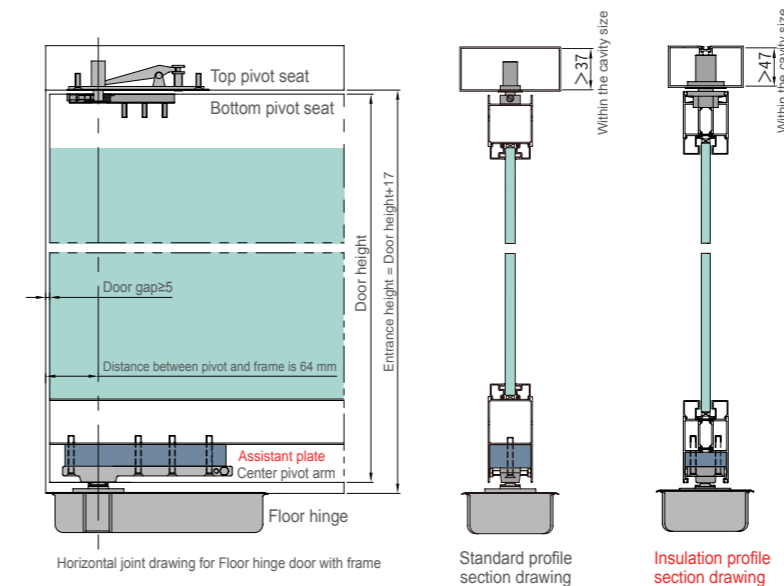

Note :1.Standard products has no assistant plate, thickness of assistant plate is based on the size of space inside profile
 2.Insulation profile accessories need to be purchased separately, technical parameters as Page 49.

Filler Application Instruction

- Put it into the floor hinge
- Fix and test the door

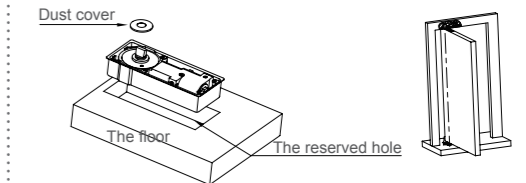

- Pour the powder inside the box
- Fix the cover

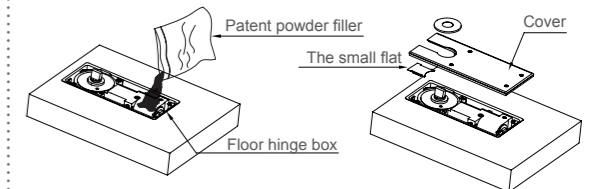

HD102 Floor Hinge

Product Drawing

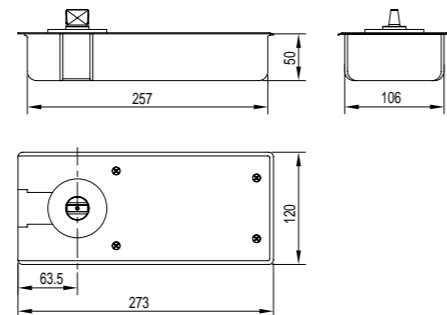

Functional Characteristic

Passed the test of industrial standard QB/T 2697
 Passed the test of SGS & DGM
 Passed the test of EN1154 standard of door closing detection
 Originate the special filler with anti-rust, water proof, keep warm, insect prevention
 It can be used on both left and right side door
 Bidirection opening and the single side opening should be achieved by auxiliary method
 Suit for wooden door, metal door, glass door, frame door

Technical Parameters

Location type: 90°
 Door width: 650-900mm
 Maximum Loading: 90kg
 Life cycle: >300,000 Cycles
 Main Material: Main body-Gray cast-iron;
 Cover plate—SS304
 Speed control: One speed section

Suitable Temperature: -15°C~40°C
 Surface of the cover plate: 400#Hairline
 Max open degree: 116°
 Structure of main body: Single cylinder
 Cover plate thickness: 1.2mm
 Spindle: 14° or 6°

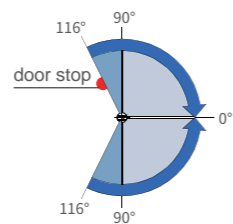

Application Performance

Speed-section 1 closed The buffer
 0° is closing, 90° is location

To prevent the door from opening beyond the maximum angle, it is recommended to install the door stopper.

Adjustment diagram

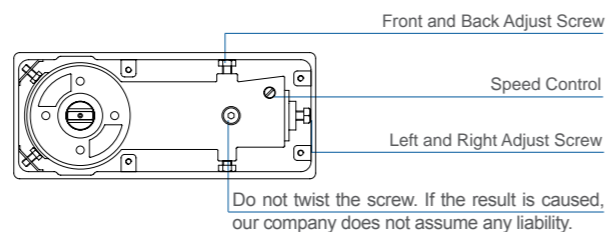

Direction diagram	Name	Adjustment
Up and down	Up and down	—
Left and right	Left and right	8mm
Front and back	Front and back	8mm

Accessory products

DS05 Top pivot seat

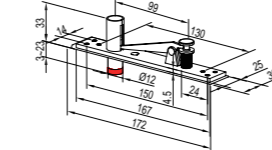

Floor hinge with standard accessories



DX05 Bottom pivot seat

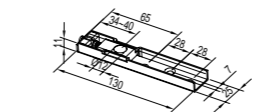
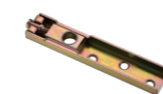

DY05 Center pivot arm

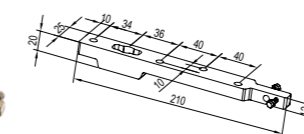

Floor hinge without standard accessories



- ◆ When it is used for the wooden door, metal door, frame door, please select the standard accessories
- ◆ When it is used for the frameless glass door, please select floor hinge without accessories and the pivot hinge hardware (As below)

No.	Products	Page
1	Patch fitting	P126-P130
2	Brackets	P139-P142
3	Long patch fitting	P145-P146

Spindle can be heightened(Please remark before ordering if required)

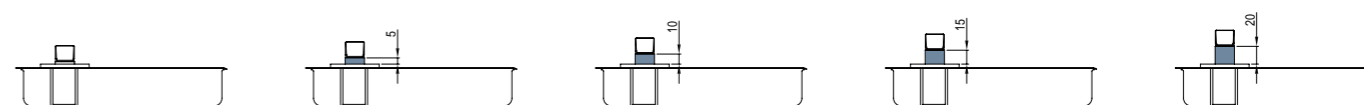

Installation Diagram

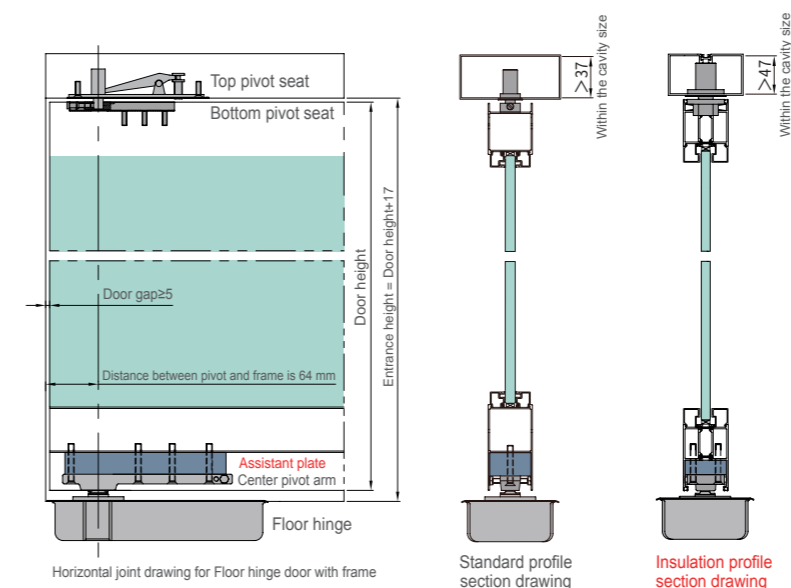

Note :1. Standard products has no assistant plate, thickness of assistant plate is based on the size of space inside profile
 2. Insulation profile accessories need to be purchased separately, technical parameters as Page 49.

Filler Application Instruction

- Put it into the floor hinge
- Fix and test the door

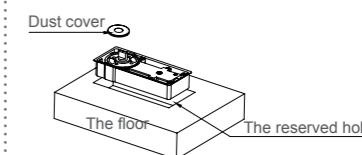

- Pour the powder inside the box
- Fix the cover

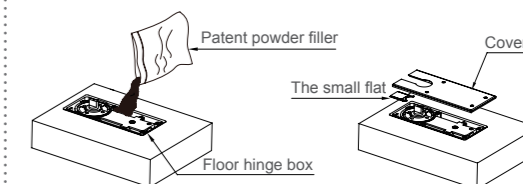

HD103/BDH10003 Floor Hinge New

Product Drawing

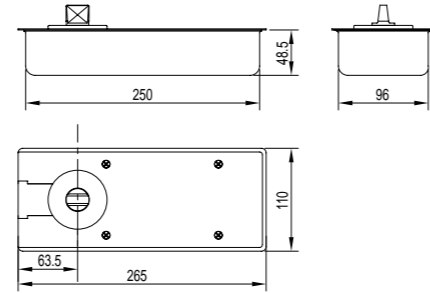

Functional Characteristic

- Passed the test of industrial standard QB/T 2697
- Passed the test of SGS & DGM
- Passed the test of EN1154 standard of door closing detection
- Originate the special filler with anti-rust, water proof, keep warm, insect prevention
- It can be used on both left and right side door
- Bidirection opening and the single side opening should be achieved by auxiliary method
- Suit for wooden door, metal door, glass door, frame door

Technical Parameters

- Location type: 90°/Non-hold
- Door width: 650~1050mm
- Maximum Loading: 65kg
- Life cycle: >300,000 Cycles
- Main Material: Main body-Gray cast-iron; Cover plate—SS304
- Speed control: One speed section
- Suitable Temperature: -15°C~40°C
- Surface of the cover plate: 400#Hairline
- Max open degree: 116°
- Structure of main body: Single cylinder
- Cover plate thickness: 1.2mm
- Spindle: 14° or 6°

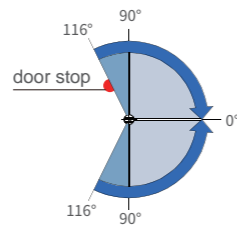

Application Performance

- Speed-section 1 closed
- The buffer
- 0° is closing, 90° is location
- Graphics HD103, BDH10003 has not 90° hold function
- To prevent the door from opening beyond the maximum angle, it is recommended to install the door stopper.

Adjustment diagram

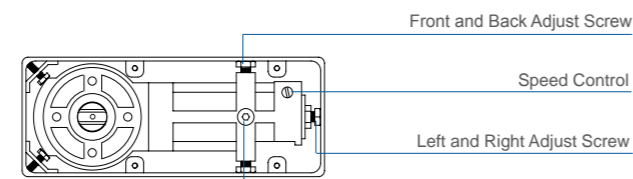

Do not twist the screw. If the result is caused, our company does not assume any liability.

Direction diagram	Name	Adjustment
Up and down	Up and down	—
Left and right	Left and right	4mm
Front and back	Front and back	4mm

Accessory products

DS05 Top pivot seat

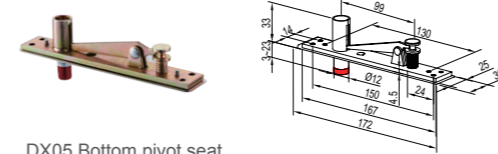

DX05 Bottom pivot seat

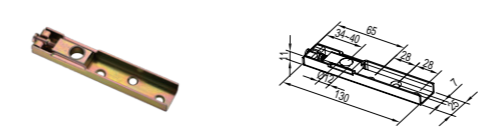

DY05 Center pivot arm

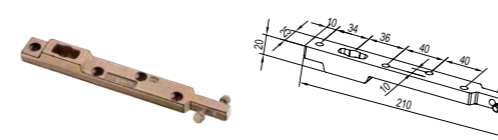

Floor hinge with standard accessories



Floor hinge without standard accessories



- ◆ When it is used for the wooden door, metal door, frame door, please select the standard accessories
- ◆ When it is used for the frameless glass door, please select floor hinge without accessories and the pivot hinge hardware (As below)

No.	Products	Page
1	Patch fitting	P126-P130
2	Brackets	P139
3	Long patch fitting	P145-P146

Spindle can be heightened(Please remark before ordering if required)

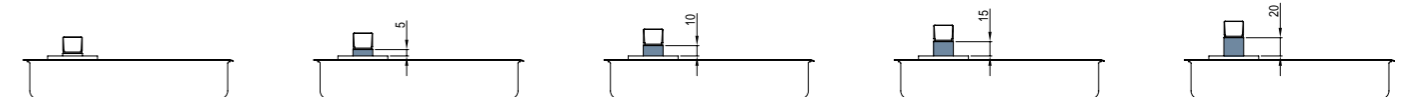

Installation Diagram

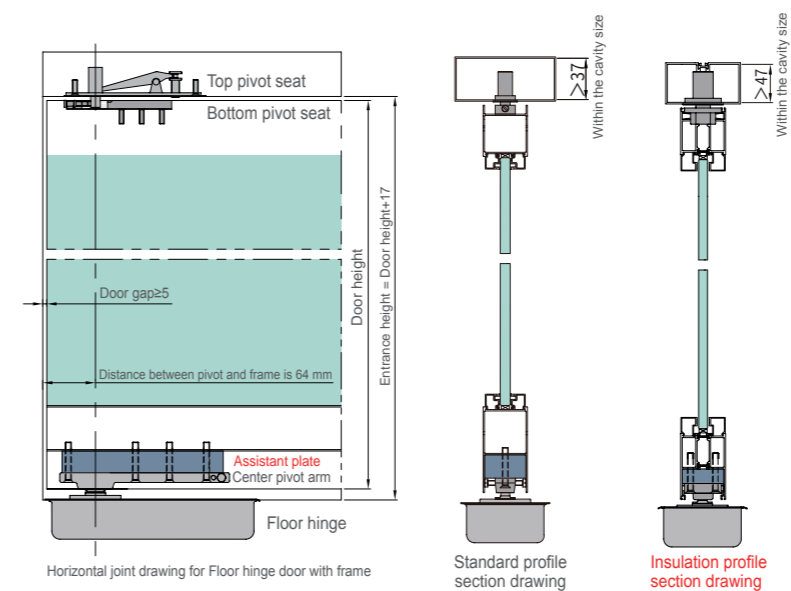

Note: 1. Standard products has no assistant plate, thickness of assistant plate is based on the size of space inside profile
2. Insulation profile accessories need to be purchased separately, technical parameters as Page 49.

Filler Application Instruction

- Put it into the floor hinge
- Fix and test the door

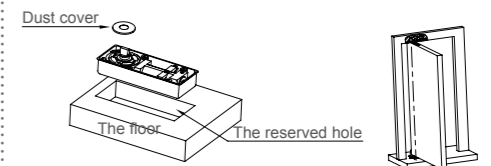

- Pour the powder inside the box
- Fix the cover

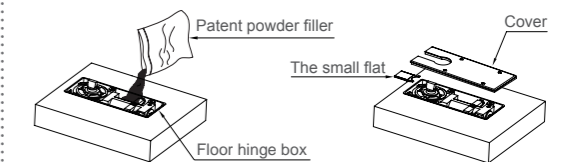

HD201 Floor Hinge

Product Drawing

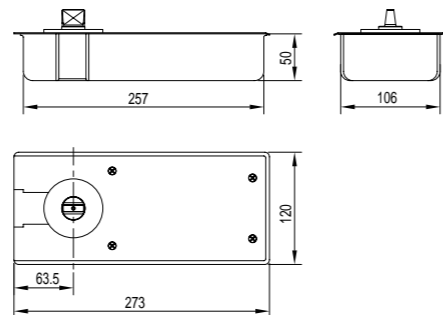

Functional Characteristic

- Passed the test of industrial standard QB/T 2697
- Passed the test of SGS & DGM
- Passed the test of EN1154 standard of door closing detection
- Originate the special filler with anti-rust, water proof, keep warm, insect prevention
- It can be used on both left and right side door
- Bidirection opening and the single side opening should be achieved by auxiliary method
- Suit for wooden door, metal door, glass door, frame door

Technical Parameters

- Location type: 90°
- Door width: 650~1050mm
- Maximum Loading: 90kg
- Life cycle: >500,000 Cycles
- Main Material: Main body-Gray cast-iron; Cover plate—SS304
- Speed control: Two speed section
- Suitable Temperature: -15°C~40°C
- Surface of the cover plate: 400#Hairline
- Max open degree: 116°
- Structure of main body: Single cylinder
- Cover plate thickness: 1.2mm
- Spindle: 14° or 6°

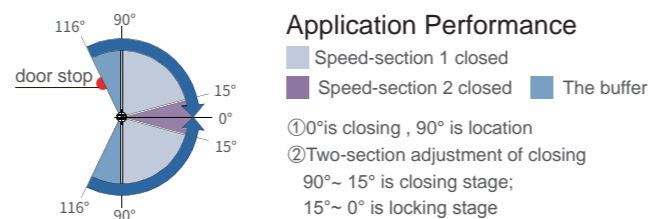

To prevent the door from opening beyond the maximum angle, it is recommended to install the door stopper.

Adjustment diagram

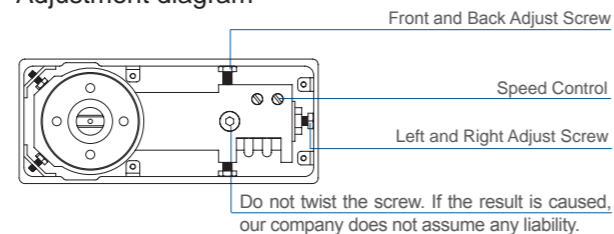

Direction diagram	Name	Adjustment
Up and down	Up and down	—
Left and right	Left and right	5mm
Front and back	Front and back	5mm

Accessory products

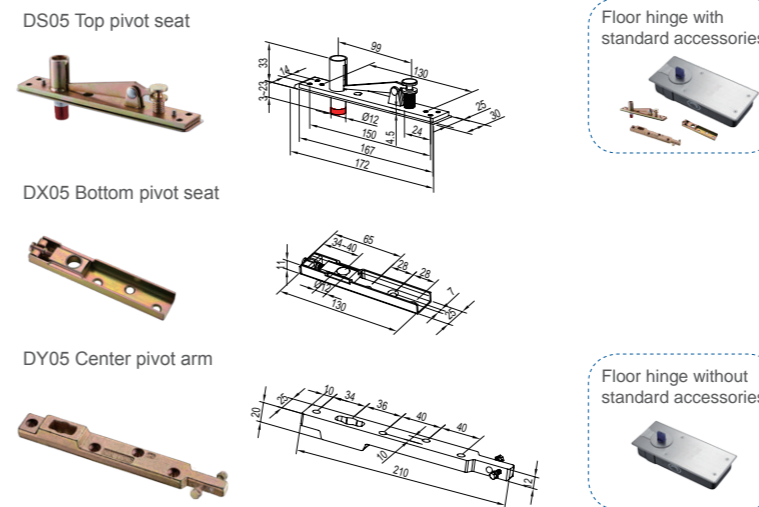

- ◆ When it is used for the wooden door, metal door, frame door, please select the standard accessories
- ◆ When it is used for the frameless glass door, please select floor hinge without accessories and the pivot hinge hardware (As below)

No.	Products	Page
1	Patch fitting	P126-P130
2	Brackets	P139-P142
3	Long patch fitting	P145-P146

Spindle can be heightened(Please remark before ordering if required)



Installation Diagram

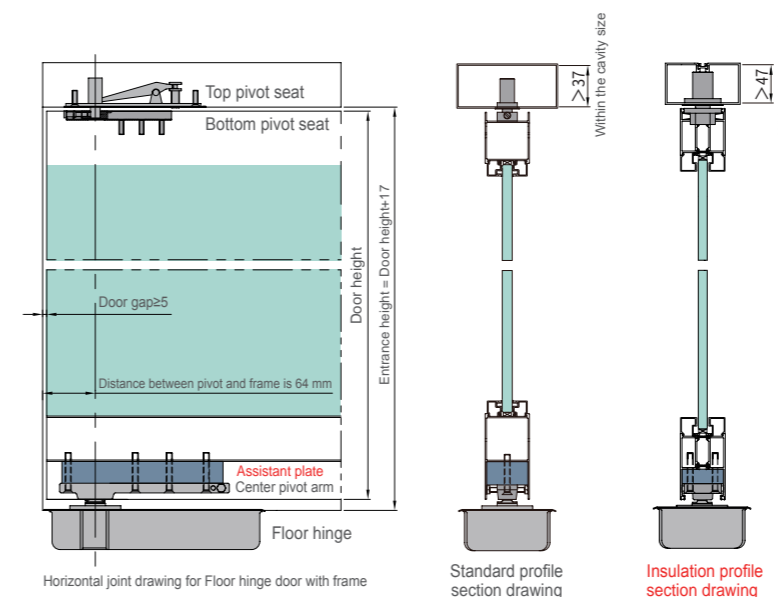

Note: 1. Standard products has no assistant plate, thickness of assistant plate is based on the size of space inside profile
 2. Insulation profile accessories need to be purchased separately, technical parameters as Page 49.

Filler Application Instruction

- Put it into the floor hinge
- Fix and test the door

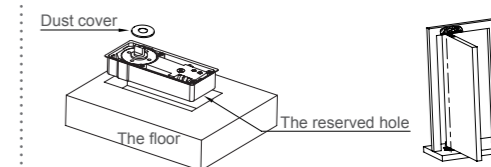

- Pour the powder inside the box
- Fix the cover

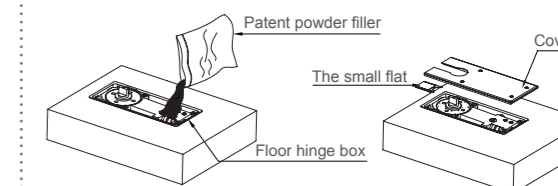



BDH20114 Floor Hinge

Product Drawing

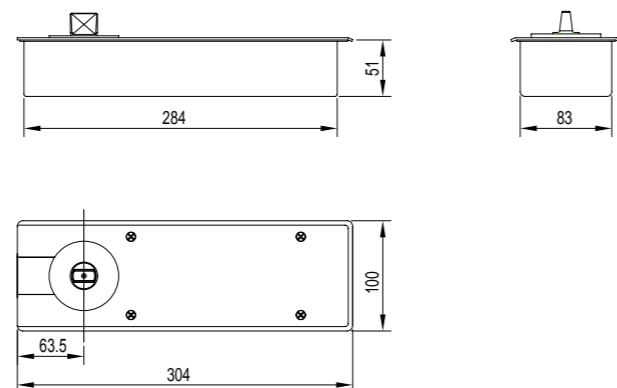

Functional Characteristic

- Passed the test of industrial standard QB/T 2697
- Passed the test of SGS & DGM
- Passed the test of EN1154 standard of door closing detection
- Originate the special filler with anti-rust, water proof, keep warm, insect prevention
- It can be used on both left and right side door
- Suit for wooden door, metal door, glass door, frame door (For center installations only)

Technical Parameters

- Location type: 90°
- Door width: 650~750mm(Unilateral)
- Maximum Loading: 85~100kg
- Life cycle: >500,000 Cycles
- Main Material: Main body-Gray cast-iron; Cover plate-SS304
- Speed control: Two speed section
- Suitable Temperature: -15°C~40°C
- Surface of the cover plate: 400#Hairline
- Max open degree: 360°
- Structure of main body: Single cylinder
- Cover plate thickness: 2.0mm
- Spindle: 14° or 6°

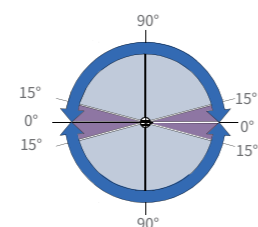

Application Performance

- Speed-section 1 closed
- Speed-section 2 closed
- ① 0° is closing, 90° is location
- ② Two-section adjustment of closing: 90°~15° is closing stage; 15°~0° is locking stage

Adjustment diagram

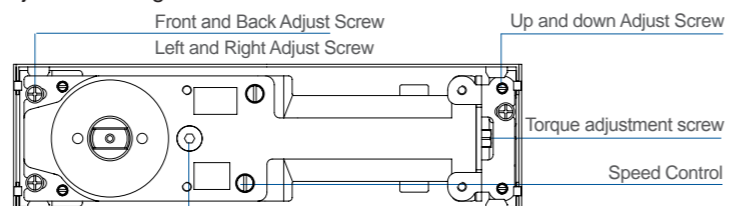

Do not twist the screw. If the result is caused, our company does not assume any liability.

Direction diagram	Name	Adjustment
Up and down	Up and down	2mm
Front and back	Front and back	2mm
Left and right	Left and right	2mm

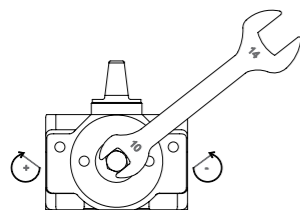

Torque adjustment table	
Category	Adjust the number of turns
2	-3
3	0
Note: "3" force before leaving the factory	
Torque increase	Torque decreases

Accessory products

DS03 Top pivot seat



DX03 Bottom pivot seat

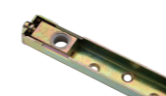

DY05 Center pivot arm

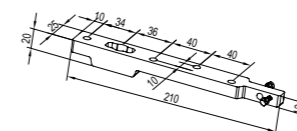
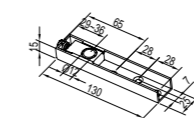
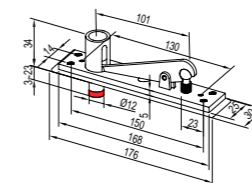

Floor hinge with standard accessories



Spindle can be heightened (Please remark before ordering if required)

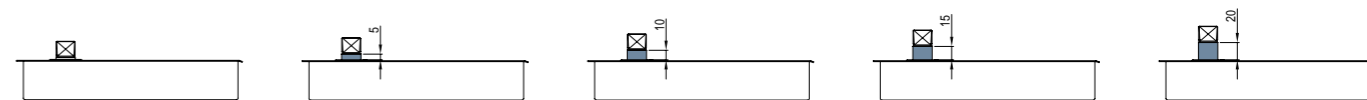

Installation Diagram

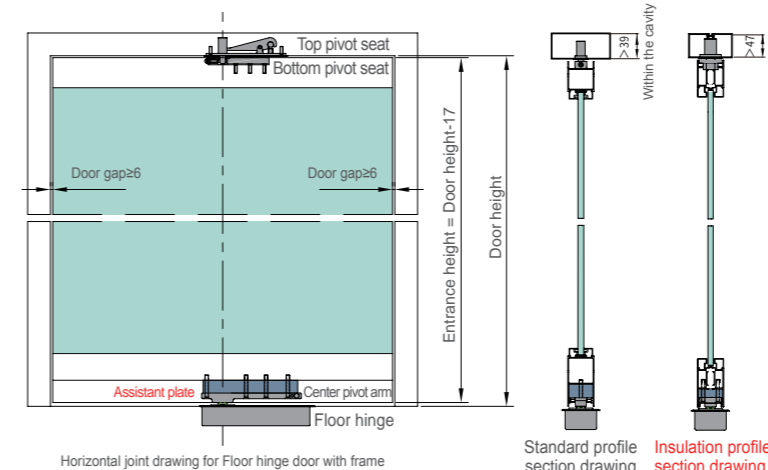

Horizontal joint drawing for Floor hinge door with frame

Standard profile section drawing
Insulation profile section drawing

Note: 1. Standard products has no assistant plate, thickness of assistant plate is based on the size of space inside profile
2. Insulation profile accessories need to be purchased separately, technical parameters as Page 49.

Filler Application Instruction

- Put it into the floor hinge
- Fix and test the door

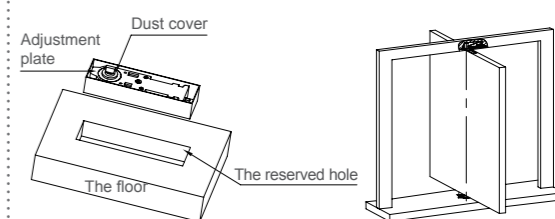

- Pour the powder inside the box
- Fix the cover

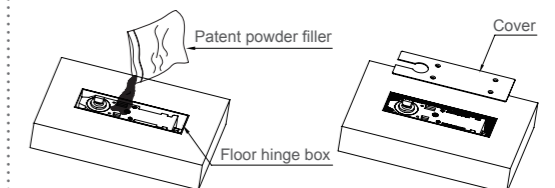

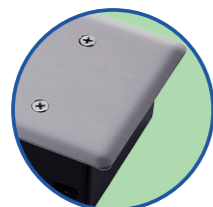

Ultra narrow

BDH20314/BDH20304 Floor Hinge New

Product Drawing

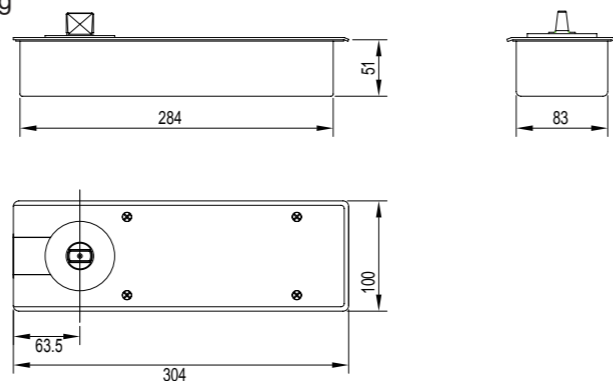

Functional Characteristic

- Passed the test of industrial standard QB/T 2697
- Passed the test of SGS & DGM
- Passed the test of EN1154 standard of door closing detection
- Originate the special filler with anti-rust, water proof, keep warm, insect prevention
- It can be used on both left and right side door
- Bidirection opening and the single side opening should be achieved by auxiliary method
- Suit for wooden door, metal door, glass door, frame door

Technical Parameters

- Location type: 90°/Non-hold
- Door width: 650~1050mm
- Maximum Loading: 100kg
- Life cycle: >500,000 Cycles
- Main Material: Main body-Gray cast-iron; Cover plate—SS304
- Speed control: Two speed section
- Suitable Temperature: -15°C~40°C
- Surface of the cover plate: 400#Hairline
- Max open degree: 130°
- Structure of main body: Single cylinder
- Cover plate thickness: 2.0mm
- Spindle: 14°or 6°

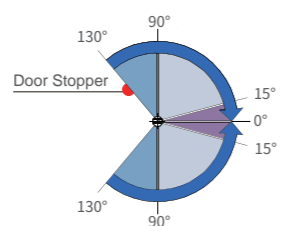

Application Performance

- Speed-section 1 closed
- Speed-section 2 closed
- The buffer
- ①0°is closing, 90° is location
- ②Two-section adjustment of closing
- 90°~ 15° is closing stage;
- 15°~ 0° is locking stage

Graphics BDH20314,BDH20304 has not 90°hold function

To prevent the door from opening beyond the maximum angle, it is recommended to install the door stopper.

Adjustment diagram

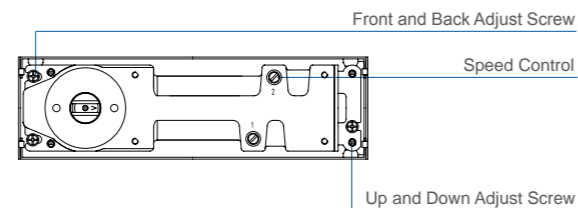

Direction diagram	Name	Adjustment
	Up and down	2mm
	Front and back	2mm
	Left and right	2mm

Accessory products

DS03 Top pivot seat



DX03 Bottom pivot seat

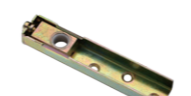

DY05 Center pivot arm

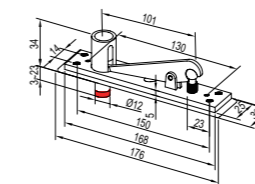

Floor hinge with standard accessories

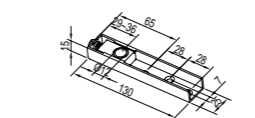

Floor hinge without standard accessories

- ◆When it is used for the wooden door, metal door, frame door, please select the standard accessories
- ◆When it is used for the frameless glass door, please select floor hinge without accessories and the pivot hinge hardware (As below)

No.	Products	Page
1	Patch fitting	P127-P132
2	Brackets	P139-P142
3	Long patch fitting	P145-P148

Spindle can be heightened(Please remark before ordering if required)

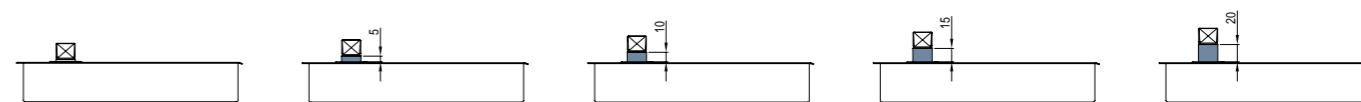

Installation Diagram

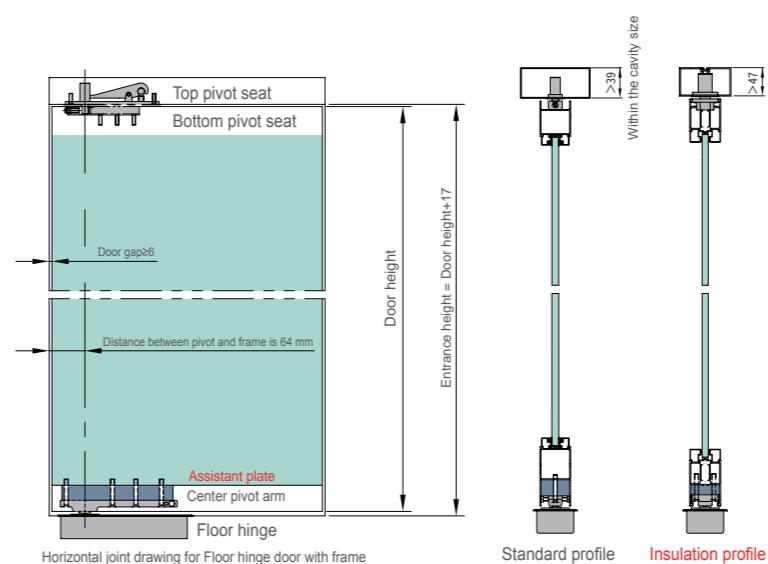

- Note :1.Standard products has no assistant plate, thickness of assistant plate is based on the size of space inside profile
- 2.Insulation profile accessories need to be purchased separately, technical parameters as Page 49.

Filler Application Instruction

- Put it into the floor hinge
- Fix and test the door

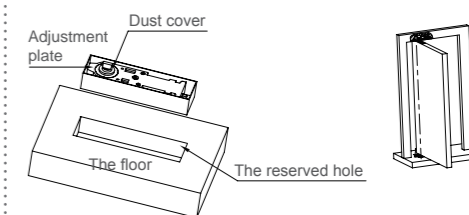

- Pour the powder inside the box
- Fix the cover

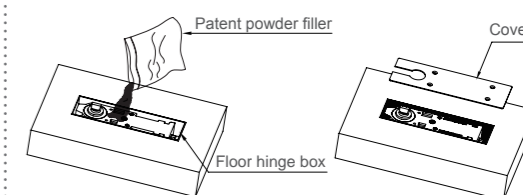

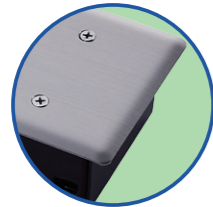

Ultra narrow

BDH20315/BDH20305 Floor Hinge New

Product Drawing

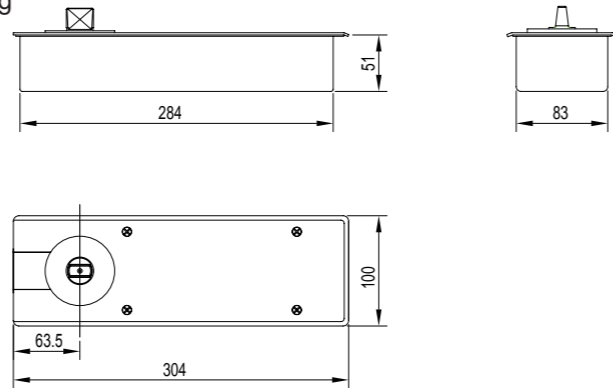

Functional Characteristic

- Passed the test of industrial standard QB/T 2697
- Passed the test of SGS & DGM
- Passed the test of EN1154 standard of door closing detection
- Originate the special filler with anti-rust, water proof, keep warm, insect prevention
- It can be used on both left and right side door
- Bidirection opening and the single side opening should be achieved by auxiliary method
- Suit for wooden door, metal door, glass door, frame door

Technical Parameters

- Location type: 90°/Non-hold
- Door width: 800~1200mm
- Maximum Loading: 130kg
- Life cycle: >500,000 Cycles
- Main Material: Main body-Gray cast-iron; Cover plate—SS304
- Speed control: Two speed section
- Suitable Temperature: -15°C~40°C
- Surface of the cover plate: 400#Hairline
- Max open degree: 130°
- Structure of main body: Single cylinder
- Cover plate thickness: 2.0mm
- Spindle: 14°or 6°

Application Performance

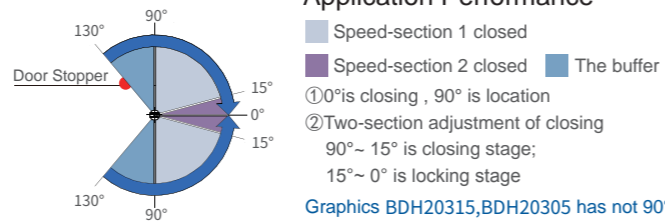

Graphics BDH20315, BDH20305 has not 90° hold function
To prevent the door from opening beyond the maximum angle, it is recommended to install the door stopper.

Adjustment diagram

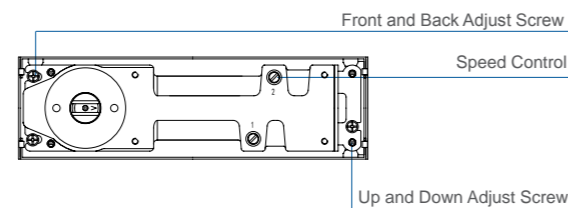

Direction diagram	Name	Adjustment
Up and down	Up and down	2mm
Left and right	Left and right	2mm
Front and back	Front and back	2mm

Accessory products

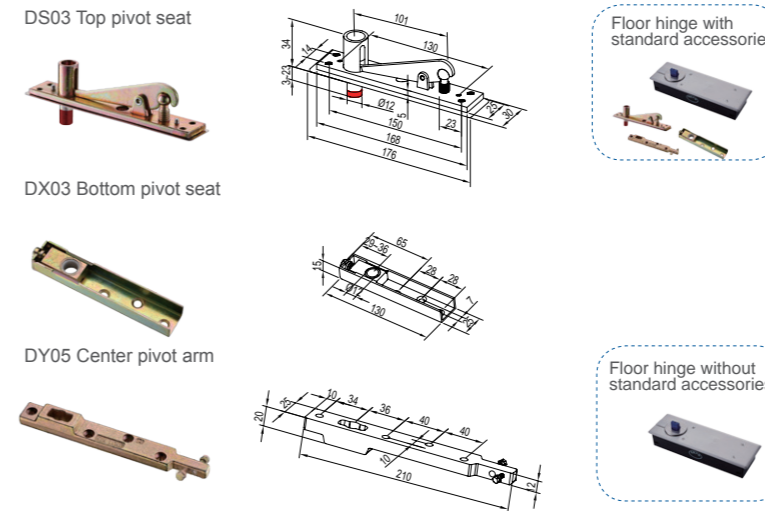

- ◆ When it is used for the wooden door, metal door, frame door, please select the standard accessories
- ◆ When it is used for the frameless glass door, please select floor hinge without accessories and the pivot hinge hardware (As below)

No.	Products	Page
1	Patch fitting	P127-P132
2	Brackets	P139-P142
3	Long patch fitting	P145-P148

Spindle can be heightened (Please remark before ordering if required)

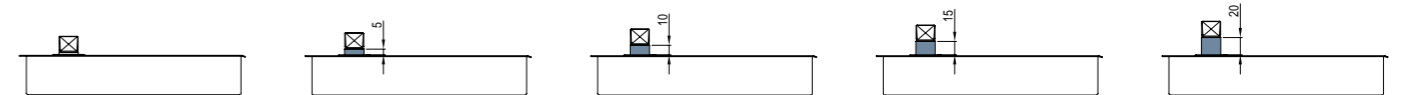

Installation Diagram

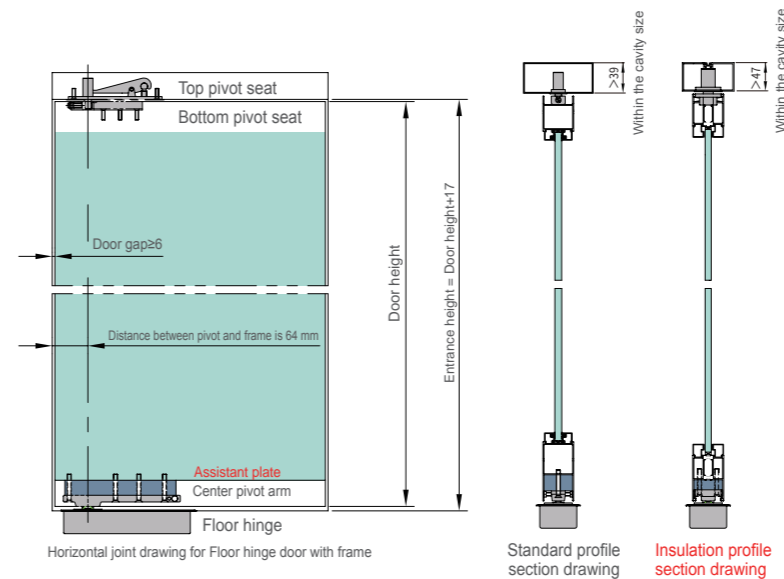

Note: 1. Standard products has no assistant plate, thickness of assistant plate is based on the size of space inside profile
2. Insulation profile accessories need to be purchased separately, technical parameters as Page 49.

Filler Application Instruction

- Put it into the floor hinge
- Fix and test the door

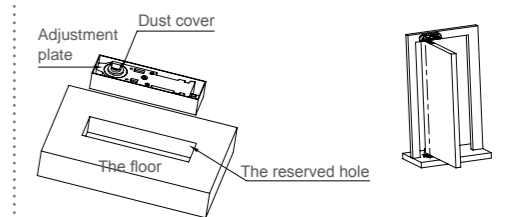

- Pour the powder inside the box
- Fix the cover

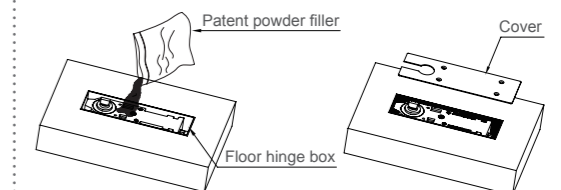

HD203 / HDF203 Floor Hinge

Product Drawing

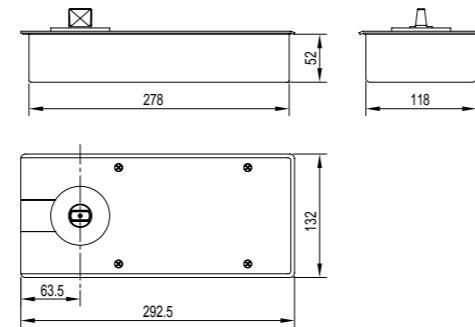

Functional Characteristic

- Passed the test of industrial standard QB/T 2697
- Passed the test of SGS & DGM
- Passed the test of EN1154 standard of door closing detection
- Originate the special filler with anti-rust, water proof, keep warm, insect prevention
- It can be used on both left and right side door
- Bidirection opening and the single side opening should be achieved by auxiliary method
- Suit for wooden door, metal door, glass door, frame door

Technical Parameters

- Location type: 90°/Non-hold
- Door width: 650~1050mm
- Maximum Loading: 100kg
- Life cycle: >1,000,000 Cycles
- Main Material: Main body-Gray cast-iron; Cover plate—SS304
- Speed control: Two speed section
- Suitable Temperature: -15°C~40°C
- Surface of the cover plate: 400#Hairline
- Max open degree: 130°
- Structure of main body: Single cylinder
- Cover plate thickness: 2.0mm
- Spindle: 14°or 6°

Application Performance

- Speed-section 1 closed
- Speed-section 2 closed
- The buffer

①0°is closing, 90° is location
②Two-section adjustment of closing
90°~ 15° is closing stage;
15°~ 0° is locking stage

Graphics HD203, HDF203 has not 90°hold function
To prevent the door from opening beyond the maximum angle, it is recommended to install the door stopper.

Adjustment diagram

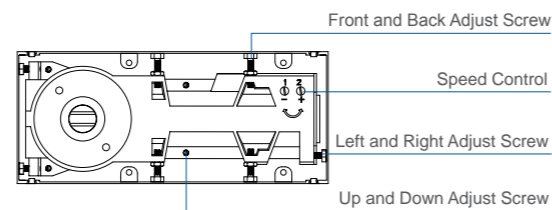

Direction diagram	Name	Adjustment
	Up and down	5mm
	Left and right	10mm
	Front and back	9mm

Accessory products

DS03 Top pivot seat

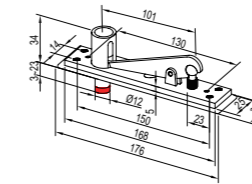

Floor hinge with standard accessories



DX03 Bottom pivot seat

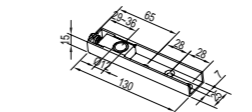

DY05 Center pivot arm

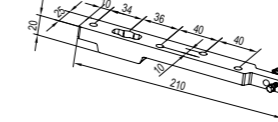

Floor hinge without standard accessories



- ◆When it is used for the wooden door, metal door, frame door, please select the standard accessories
- ◆When it is used for the frameless glass door, please select floor hinge without accessories and the pivot hinge hardware (As below)

No.	Products	Page
1	Patch fitting	P127-P132
2	Brackets	P139-P142
3	Long patch fitting	P145-P148

Spindle can be heightened(Please remark before ordering if required)

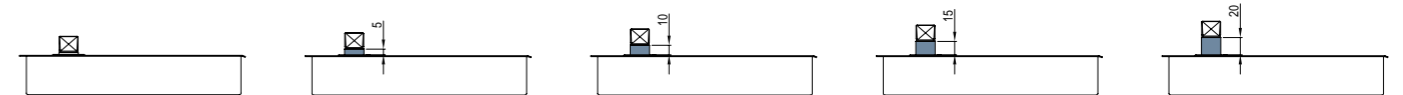

Installation Diagram

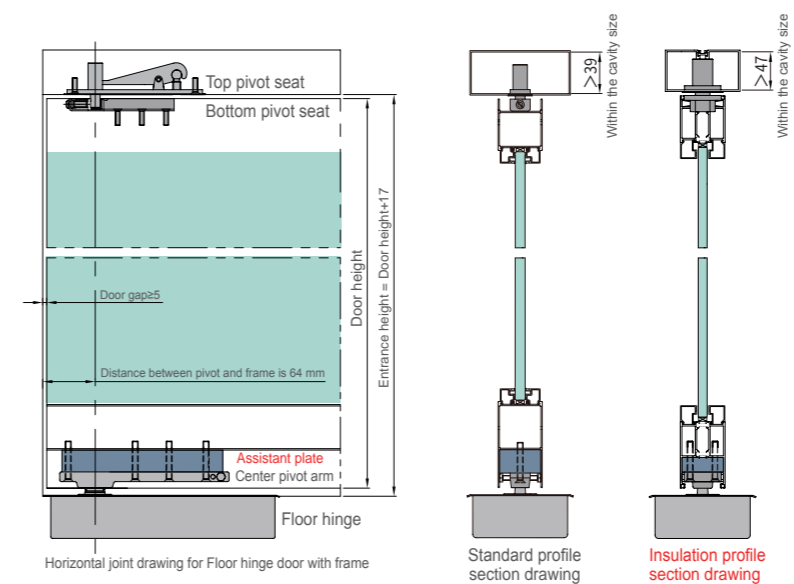

Note :1.Standard products has no assistant plate, thickness of assistant plate is based on the size of space inside profile
2.Insulation profile accessories need to be purchased separately, technical parameters as Page 49.

Filler Application Instruction

- Put it into the floor hinge
- Fix and test the door

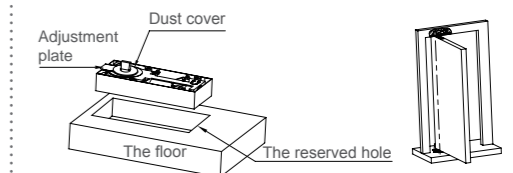

- Pour the powder inside the box
- Fix the cover

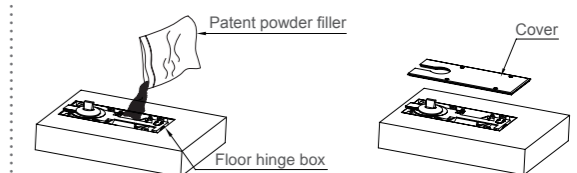

HD204 Floor Hinge

Product Drawing

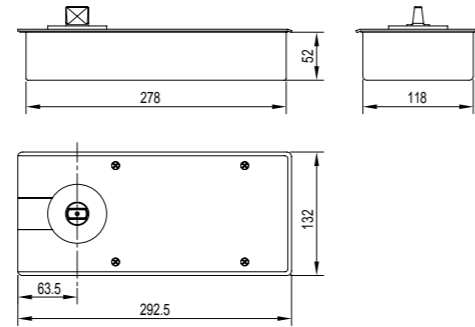

Functional Characteristic

Passed the test of industrial standard QB/T 2697
 Passed the test of SGS & DGM
 Passed the test of EN1154 standard of door closing detection
 Originate the special filler with anti-rust, water proof, keep warm, insect prevention
 It can be used on both left and right side door
 Bidirection opening and the single side opening should be achieved by auxiliary method
 Suit for wooden door, metal door, glass door, frame door

Technical Parameters

Location type: 90° Suitable Temperature: -15°C~40°C
 Door width: 750~1100mm Surface of the cover plate: 400#Hairline
 Maximum Loading: 115kg Max open degree: 130°
 Life cycle: >1,000,000 Cycles Structure of main body: Single cylinder
 Main Material: Main body-Gray cast-iron; Cover plate thickness: 2.0mm
 Cover plate—SS304 Spindle: 14°or 6°
 Speed control: Two speed section

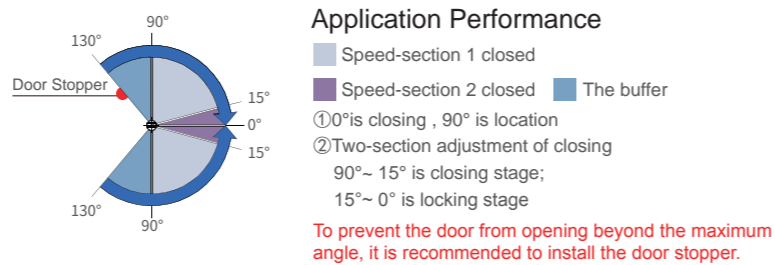

Adjustment diagram

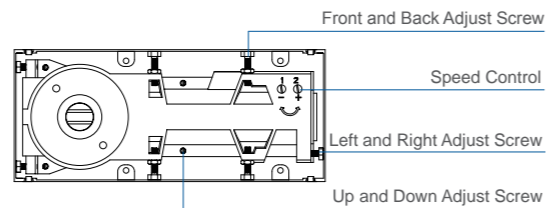

Direction diagram	Name	Adjustment
	Up and down	5mm
	Left and right	10mm
	Front and back	9mm

Accessory products

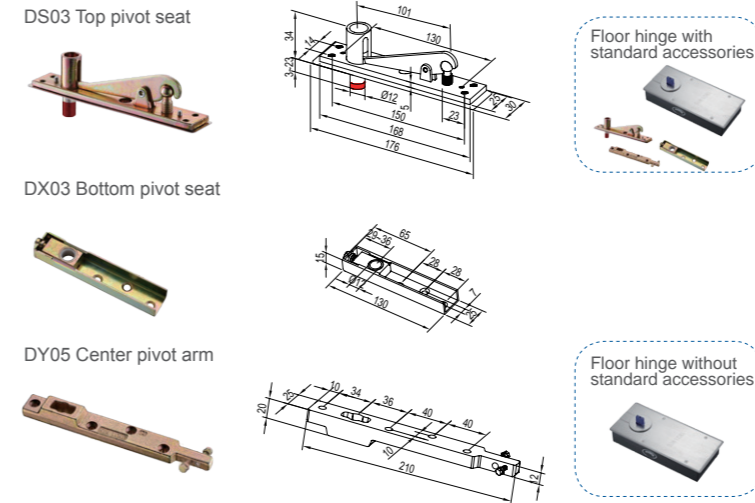

- ◆When it is used for the wooden door, metal door, frame door, please select the standard accessories
- ◆When it is used for the frameless glass door, please select floor hinge without accessories and the pivot hinge hardware (As below)

No.	Products	Page
1	Patch fitting	P127-P132
2	Brackets	P139-P142
3	Long patch fitting	P145-P148

Spindle can be heightened(Please remark before ordering if required)

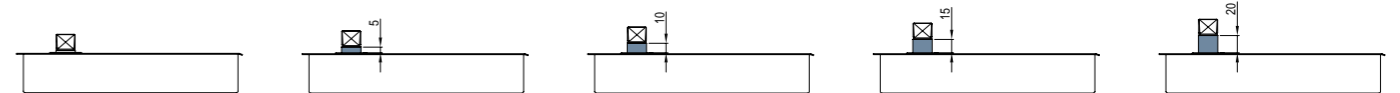

Installation Diagram

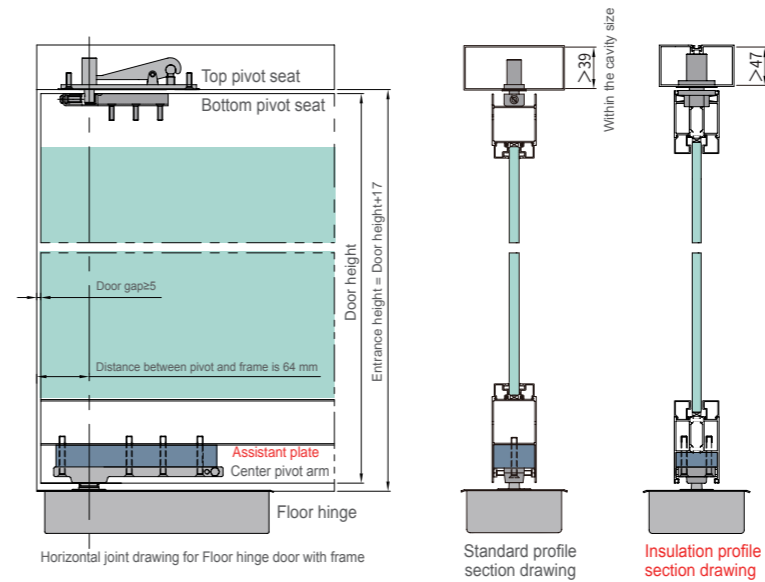

Note :1.Standard products has no assistant plate, thickness of assistant plate is based on the size of space inside profile
 2.Insulation profile accessories need to be purchased separately, technical parameters as Page 49.

Filler Application Instruction

- Put it into the floor hinge
- Fix and test the door

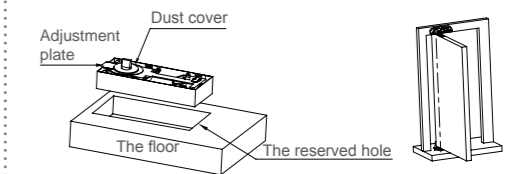

- Pour the powder inside the box
- Fix the cover

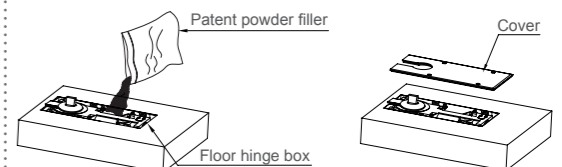

HD205/HDF205 Floor Hinge

Product Drawing

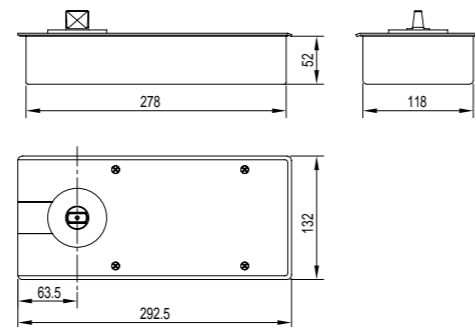

Functional Characteristic

- Passed the test of industrial standard QB/T 2697
- Passed the test of SGS & DGM
- Passed the test of EN1154 standard of door closing detection
- Originate the special filler with anti-rust, water proof, keep warm, insect prevention
- It can be used on both left and right side door
- Bidirection opening and the single side opening should be achieved by auxiliary method
- Suit for wooden door, metal door, glass door, frame door

Technical Parameters

- Location type: 90°/Non-hold
- Door width: 800~1200mm
- Maximum Loading: 130kg
- Life cycle: >1,000,000 Cycles
- Main Material: Main body-Gray cast-iron; Cover plate—SS304
- Speed control: Two speed section
- Suitable Temperature: -15°C~40°C
- Surface of the cover plate: 400#Hairline
- Max open degree: 130°
- Structure of main body: Single cylinder
- Cover plate thickness: 2.0mm
- Spindle: 14°or 6°

Application Performance

- Speed-section 1 closed
- Speed-section 2 closed
- The buffer

① 0° is closing, 90° is location
 ② Two-section adjustment of closing
 90°~15° is closing stage;
 15°~0° is locking stage

Graphics HD205, HDF205 has not 90°hold function
 To prevent the door from opening beyond the maximum angle, it is recommended to install the door stopper.

Adjustment diagram

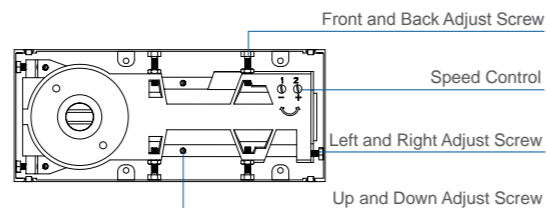

Direction diagram	Name	Adjustment
	Up and down	5mm
	Left and right	10mm
	Front and back	9mm

Accessory products

DS03 Top pivot seat

DX03 Bottom pivot seat

DY05 Center pivot arm

Floor hinge with standard accessories

Floor hinge without standard accessories

- ◆When it is used for the wooden door, metal door, frame door, please select the standard accessories
- ◆When it is used for the frameless glass door, please select floor hinge without accessories and the pivot hinge hardware (As below)

No.	Products	Page
1	Patch fitting	P127-P132
2	Brackets	P139-P142
3	Long patch fitting	P145-P148

Spindle can be heightened(Please remark before ordering if required)

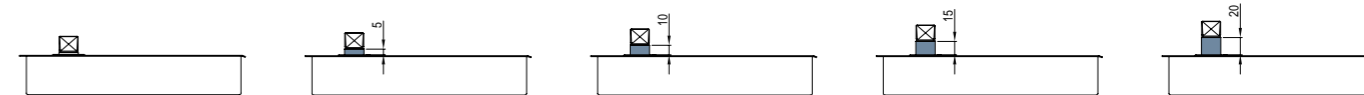

Installation Diagram

- Note : 1. Standard products has no assistant plate, thickness of assistant plate is based on the size of space inside profile
 2. Insulation profile accessories need to be purchased separately, technical parameters as Page 49.

Filler Application Instruction

- Put it into the floor hinge
- Fix and test the door

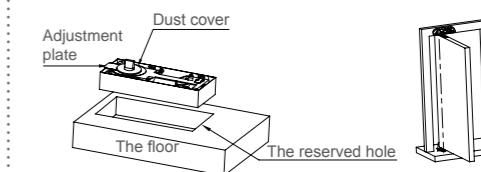

- Pour the powder inside the box
- Fix the cover

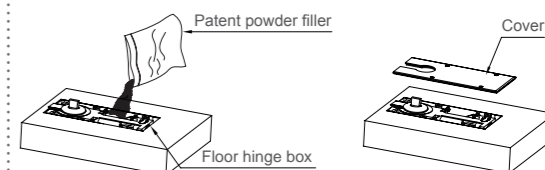

HD304 Floor Hinge

Product Drawing

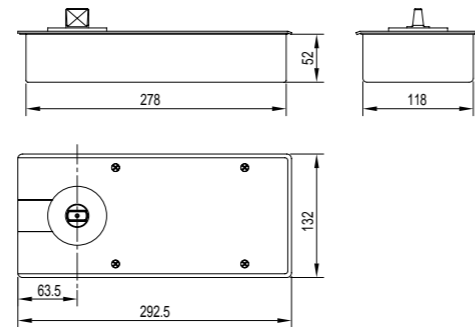

Functional Characteristic

- Passed the test of industrial standard QB/T 2697
- Passed the test of SGS & DGM
- Passed the test of EN1154 standard of door closing detection
- Originate the special filler with anti-rust, water proof, keep warm, insect prevention
- It can be used on both left and right side door
- Bidirection opening and the single side opening should be achieved by auxiliary method
- Suit for wooden door, metal door, glass door, frame door

Technical Parameters

- Location type: 90°/120°-180°hold
- Door width: 650~1050mm
- Maximum Loading: 100kg
- Life cycle: >1,000,000 Cycles
- Main Material: Main body-Gray cast-iron; Cover plate—SS304
- Speed control: Two speed section
- Suitable Temperature: -15°C~40°C
- Surface of the cover plate: 400#Hairline
- Max open degree: 180°
- Structure of main body: Single cylinder
- Cover plate thickness: 2.0mm
- Spindle: 14°or 6°

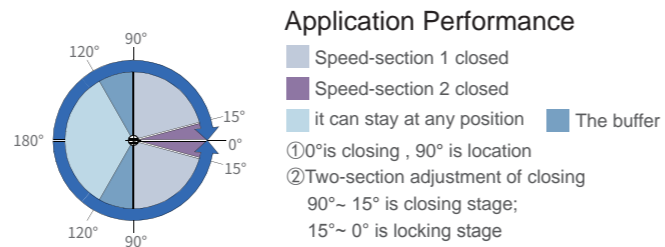

To prevent the door from opening beyond the maximum angle, it is recommended to install the door stopper.

Adjustment diagram

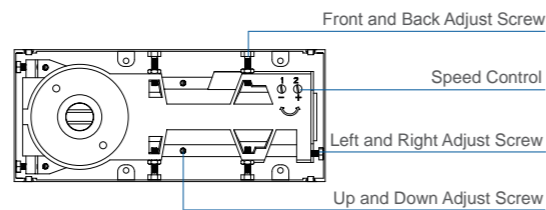

Direction diagram	Name	Adjustment
	Up and down	5mm
	Left and right	10mm
	Front and back	9mm

Accessory products

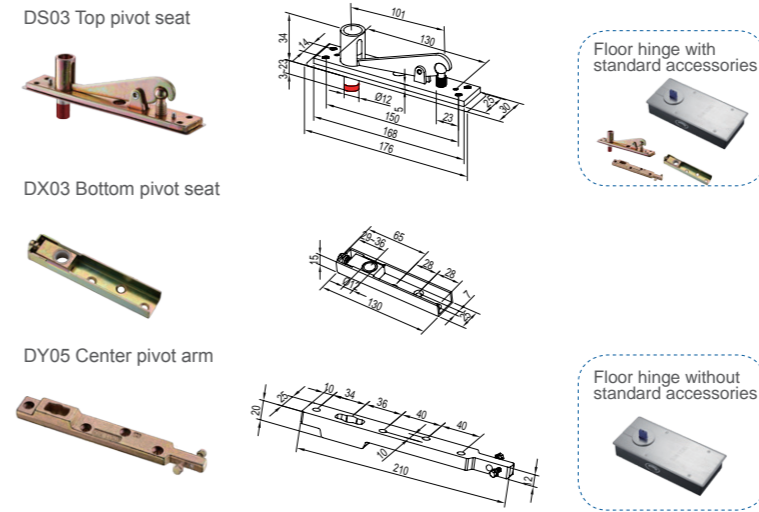

- ◆When it is used for the wooden door, metal door, frame door, please select the standard accessories
- ◆When it is used for the frameless glass door, please select floor hinge without accessories and the pivot hinge hardware (As below)

No.	Products	Page
1	Patch fitting	P127-P132
2	Brackets	P139-P142
3	Long patch fitting	P145-P148

Spindle can be heightened(Please remark before ordering if required)

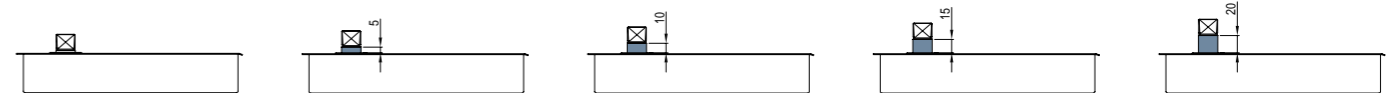

Installation Diagram

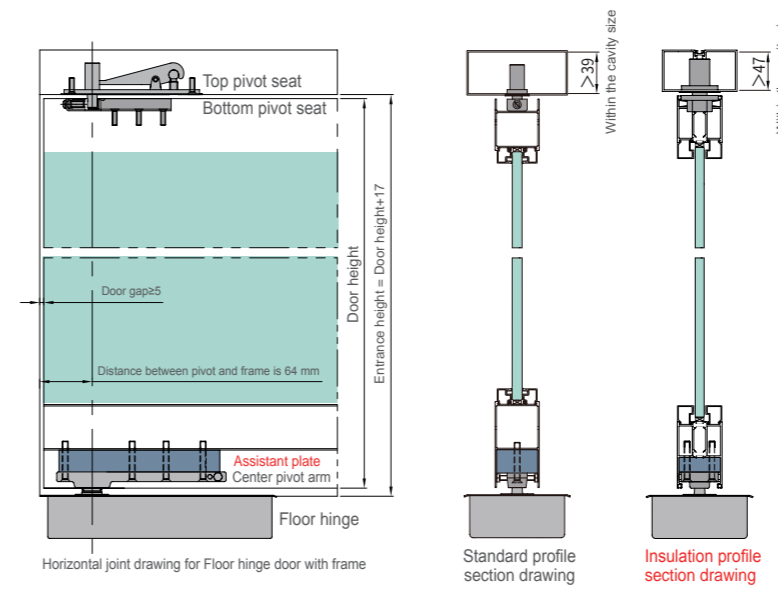

Note : 1. Standard products has no assistant plate, thickness of assistant plate is based on the size of space inside profile
 2. Insulation profile accessories need to be purchased separately, technical parameters as Page 49.

Filler Application Instruction

- Put it into the floor hinge
- Fix and test the door

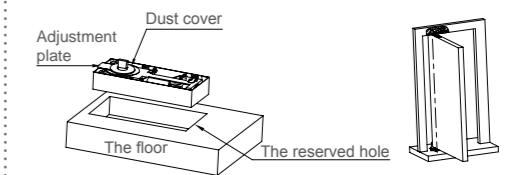

- Pour the powder inside the box
- Fix the cover

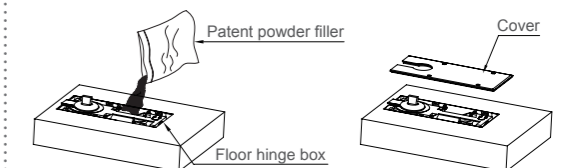

HD305 Floor Hinge

Product Drawing

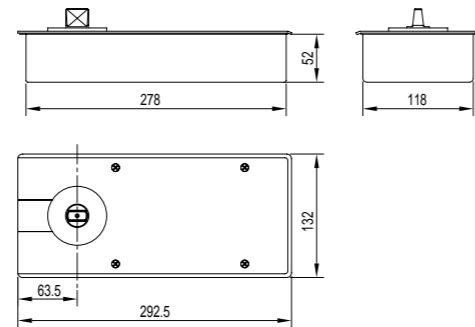

Functional Characteristic

- Passed the test of industrial standard QB/T 2697
- Passed the test of SGS & DGM
- Passed the test of EN1154 standard of door closing detection
- Originate the special filler with anti-rust, water proof, keep warm, insect prevention
- It can be used on both left and right side door
- Bidirection opening and the single side opening should be achieved by auxiliary method
- Suit for wooden door, metal door, glass door, frame door

Technical Parameters

- Location type: 90°/120°-180°hold
- Door width: 800~1200mm
- Maximum Loading: 130kg
- Life cycle: >1,000,000 Cycles
- Main Material: Main body-Gray cast-iron; Cover plate—SS304
- Speed control: Two speed section
- Suitable Temperature: -15°C~40°C
- Surface of the cover plate: 400#Hairline
- Max open degree: 180°
- Structure of main body: Single cylinder
- Cover plate thickness: 2.0mm
- Spindle: 14°or 6°

Application Performance

- Speed-section 1 closed
- Speed-section 2 closed
- it can stay at any position
- The buffer

① 0° is closing, 90° is location
 ② Two-section adjustment of closing
 90°~15° is closing stage;
 15°~0° is locking stage

To prevent the door from opening beyond the maximum angle, it is recommended to install the door stopper.

Adjustment diagram

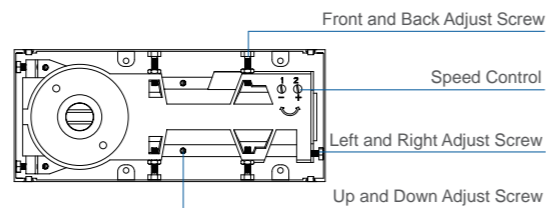

Direction diagram	Name	Adjustment
	Up and down	5mm
	Left and right	10mm
	Front and back	9mm

Accessory products

DS03 Top pivot seat



DX03 Bottom pivot seat



DY05 Center pivot arm

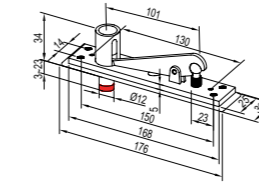

Floor hinge with standard accessories

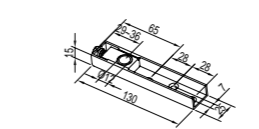

Floor hinge without standard accessories



- ◆ When it is used for the wooden door, metal door, frame door, please select the standard accessories
- ◆ When it is used for the frameless glass door, please select floor hinge without accessories and the pivot hinge hardware (As below)

No.	Products	Page
1	Patch fitting	P127-P132
2	Brackets	P139-P142
3	Long patch fitting	P145-P148

Spindle can be heightened(Please remark before ordering if required)



Installation Diagram

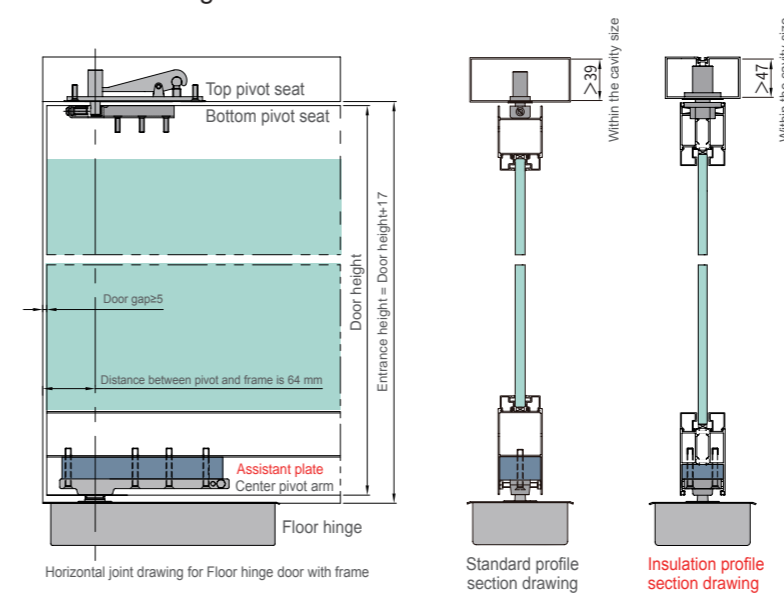

Note : 1. Standard products has no assistant plate, thickness of assistant plate is based on the size of space inside profile
 2. Insulation profile accessories need to be purchased separately, technical parameters as Page 49.

Filler Application Instruction

- Put it into the floor hinge
- Fix and test the door

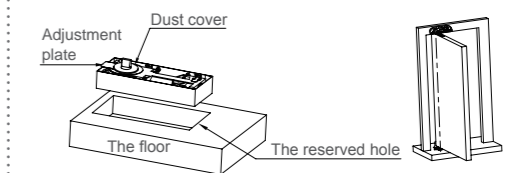

- Pour the powder inside the box
- Fix the cover

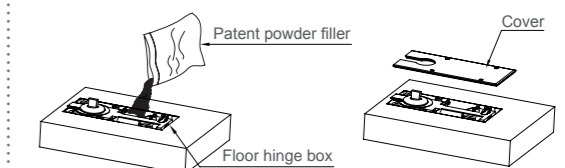

HD403 Floor Hinge

Product Drawing

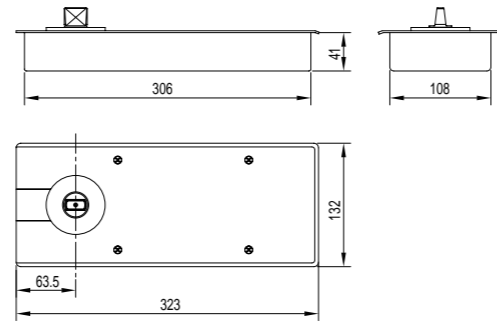

Functional Characteristic

Passed the test of industrial standard QB/T 2697
 Passed the test of SGS & DGM
 Passed the test of EN1154 standard of door closing detection
 Originate the special filler with anti-rust, water proof, keep warm, insect prevention
 It can be used on both left and right side door
 Bidirection opening and the single side opening should be achieved by auxiliary method
 Suit for wooden door, metal door, glass door, frame door

Technical Parameters

Location type: 90°
 Door width: 650~1050mm
 Maximum Loading: 100kg
 Life cycle: >1,000,000 Cycles
 Main Material: Main body-Gray cast-iron;
 Cover plate—SS304
 Speed control: Two speed section

Suitable Temperature: -15°C~40°C
 Surface of the cover plate: 400#Hairline
 Max open degree: 130°
 Structure of main body: Single cylinder
 Cover plate thickness: 2.0mm
 Spindle: 14° or 6°

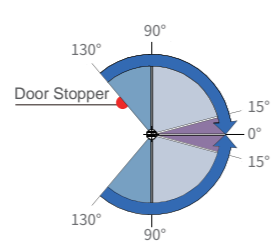

Application Performance

Speed-section 1 closed
 Speed-section 2 closed
 The buffer

① 0° is closing, 90° is location
 ② Two-section adjustment of closing
 90°~15° is closing stage;
 15°~0° is locking stage

To prevent the door from opening beyond the maximum angle, it is recommended to install the door stopper.

Adjustment diagram

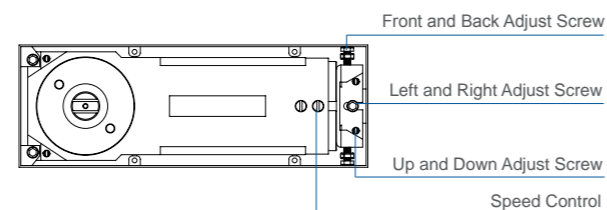

Direction diagram	Name	Adjustment
	Up and down	5mm
	Left and right	8mm
	Front and back	6mm

Accessory products

DS03 Top pivot seat



DX03 Bottom pivot seat



DY05 Center pivot arm

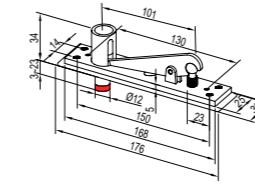

Floor hinge with standard accessories

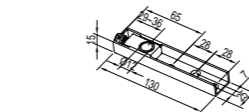

Floor hinge without standard accessories

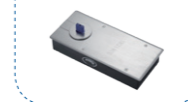

- ◆ When it is used for the wooden door, metal door, frame door, please select the standard accessories
- ◆ When it is used for the frameless glass door, please select floor hinge without accessories and the pivot hinge hardware (As below)

No.	Products	Page
1	Patch fitting	P127-P132
2	Brackets	P139-P142
3	Long patch fitting	P145-P148

Spindle can be heightened(Please remark before ordering if required)

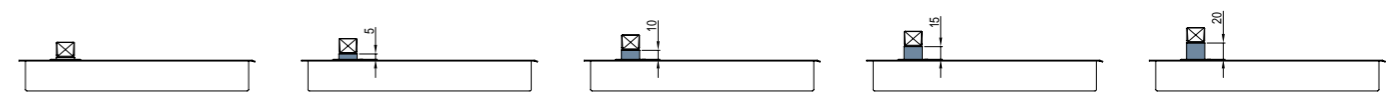

Installation Diagram

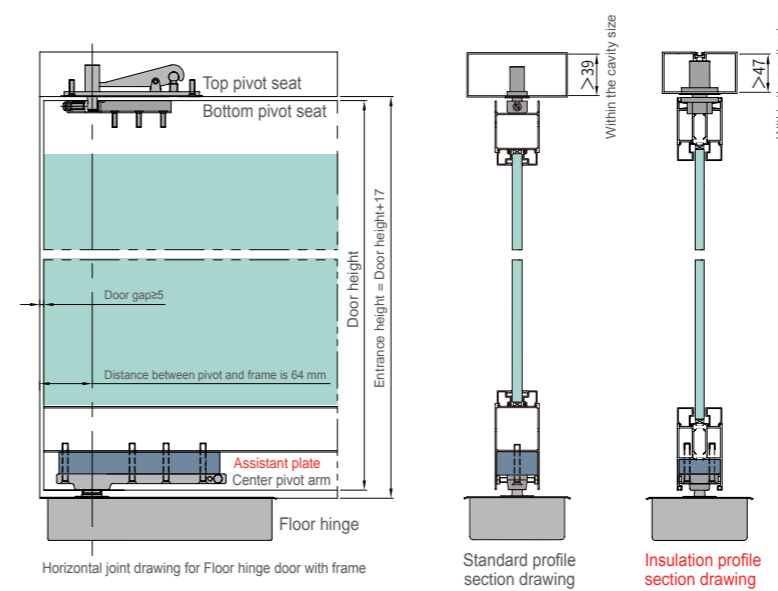

Filler Application Instruction

- Put it into the floor hinge
- Fix and test the door

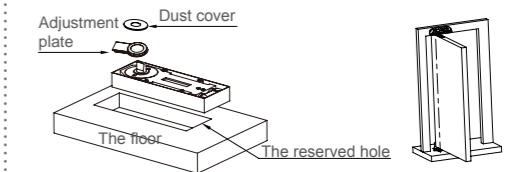

- Pour the powder inside the box
- Fix the cover

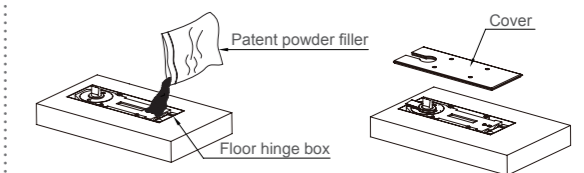

Note : 1. Standard products has no assistant plate, thickness of assistant plate is based on the size of space inside profile
 2. Insulation profile accessories need to be purchased separately, technical parameters as Page 49.

HD405 Floor Hinge

Product Drawing

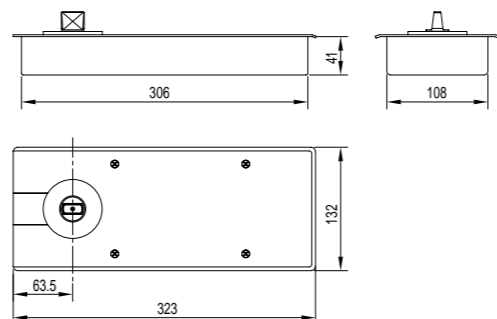

Functional Characteristic

Passed the test of industrial standard QB/T 2697
 Passed the test of SGS & DGM
 Passed the test of EN1154 standard of door closing detection
 Originate the special filler with anti-rust, water proof, keep warm, insect prevention
 It can be used on both left and right side door
 Bidirection opening and the single side opening should be achieved by auxiliary method
 Suit for wooden door, metal door, glass door, frame door

Technical Parameters

Location type: 90°
 Door width: 800~1200mm
 Maximum Loading: 130kg
 Life cycle: >1,000,000 Cycles
 Main Material: Main body-Gray cast-iron;
 Cover plate—SS304
 Speed control: Two speed section

Suitable Temperature: -15°C~40°C
 Surface of the cover plate: 400#Hairline
 Max open degree: 130°
 Structure of main body: Single cylinder
 Cover plate thickness: 2.0mm
 Spindle: 14° or 6°

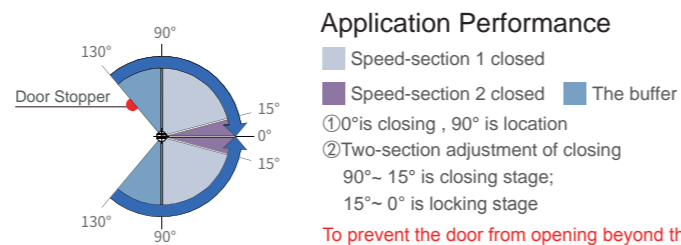

Adjustment diagram

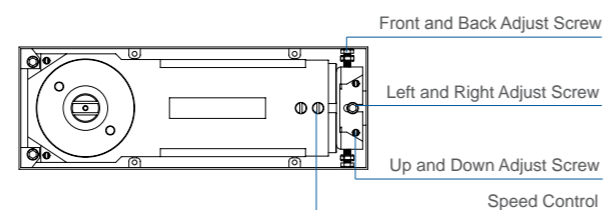

Direction diagram	Name	Adjustment
	Up and down	5mm
	Left and right	8mm
	Front and back	6mm

Accessory products

DS03 Top pivot seat



DX03 Bottom pivot seat

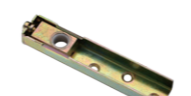

DY05 Center pivot arm

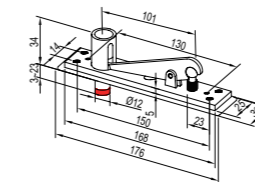

Floor hinge with standard accessories

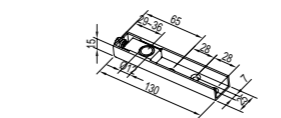

Floor hinge without standard accessories



- ◆ When it is used for the wooden door, metal door, frame door, please select the standard accessories
- ◆ When it is used for the frameless glass door, please select floor hinge without accessories and the pivot hinge hardware (As below)

No.	Products	Page
1	Patch fitting	P127-P132
2	Brackets	P139-P142
3	Long patch fitting	P145-P148

Spindle can be heightened(Please remark before ordering if required)

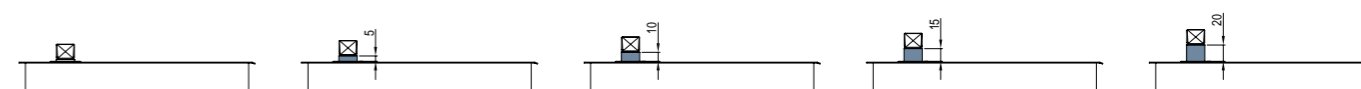

Installation Diagram

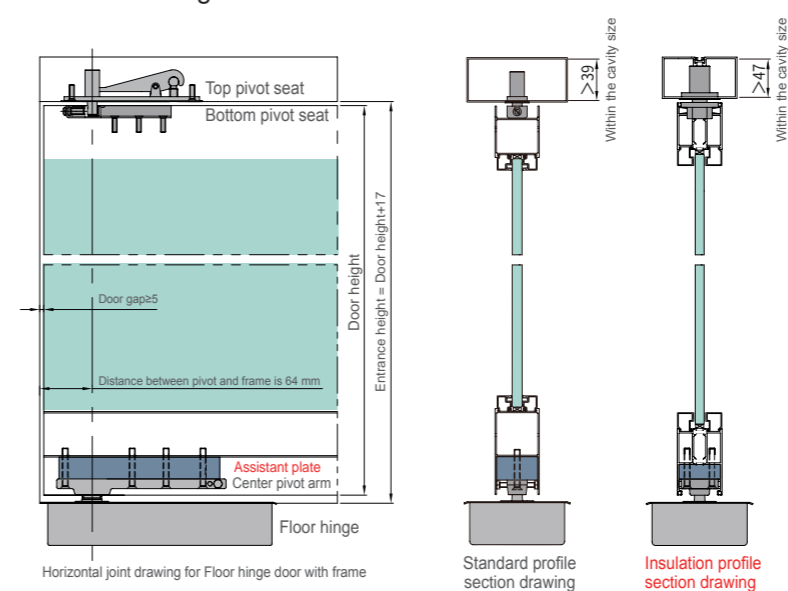

Note : 1. Standard products has no assistant plate, thickness of assistant plate is based on the size of space inside profile
 2. Insulation profile accessories need to be purchased separately, technical parameters as Page 49.

Filler Application Instruction

- Put it into the floor hinge
- Fix and test the door

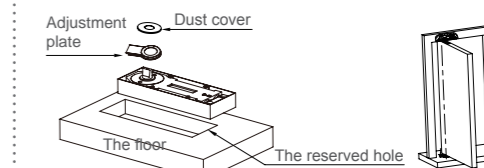

- Pour the powder inside the box
- Fix the cover

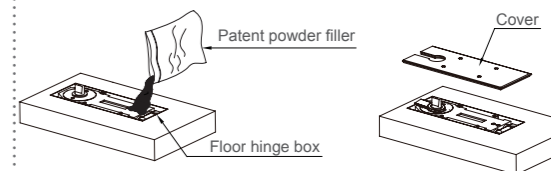

HD406 / HDF406 Floor Hinge

Product Drawing

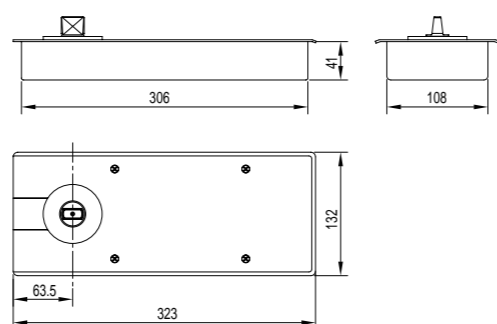

Functional Characteristic

Passed the test of industrial standard QB/T 2697
 Passed the test of SGS & DGM
 Passed the test of EN1154 standard of door closing detection
 Originate the special filler with anti-rust, water proof, keep warm, insect prevention
 It can be used on both left and right side door
 Bidirection opening and the single side opening should be achieved by auxiliary method
 Suit for wooden door, metal door, glass door, frame door

Technical Parameters

Location type: 90°/Non-hold Suitable Temperature: -15°C~40°C
 Door width: 1100~1300mm Surface of the cover plate: 400#Hairline
 Maximum Loading: 150kg Max open degree: 130°
 Life cycle: >1,000,000 Cycles Structure of main body: Double-cylinder
 Main Material: Main body-Gray cast-iron; Cover plate thickness: 2.0mm
 Cover plate—SS304 Spindle: 14°or 6°
 Speed control: Two speed section

Application Performance

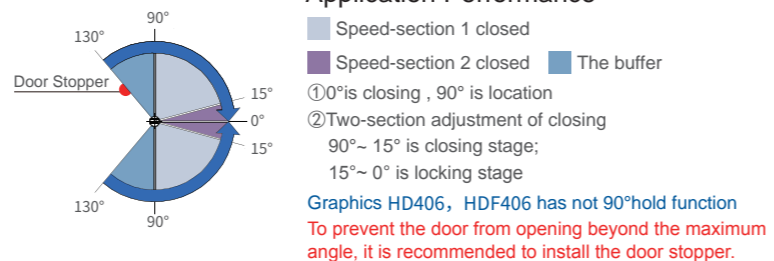

Adjustment diagram

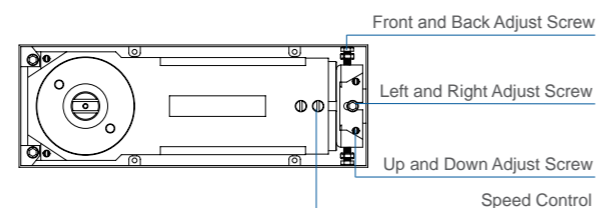

Direction diagram	Name	Adjustment
	Up and down	5mm
	Left and right	8mm
	Front and back	6mm

Accessory products

DS03 Top pivot seat

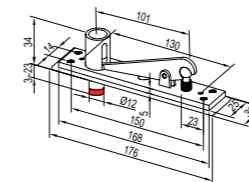

DX03 Bottom pivot seat

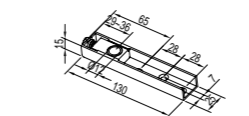

DY05 Center pivot arm

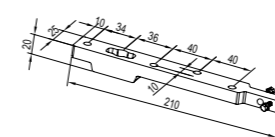

- ◆When it is used for the wooden door, metal door, frame door, please select the standard accessories
- ◆When it is used for the frameless glass door, please select floor hinge without accessories and the pivot hinge hardware (As below)

No.	Products	Page
1	Patch fitting	P131-P136
2	Brackets	P143-P144
3	Long patch fitting	P144-P150

Spindle can be heightened(Please remark before ordering if required)

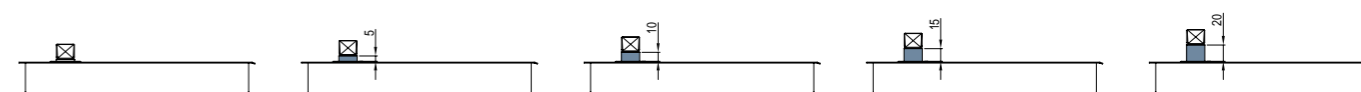

Installation Diagram

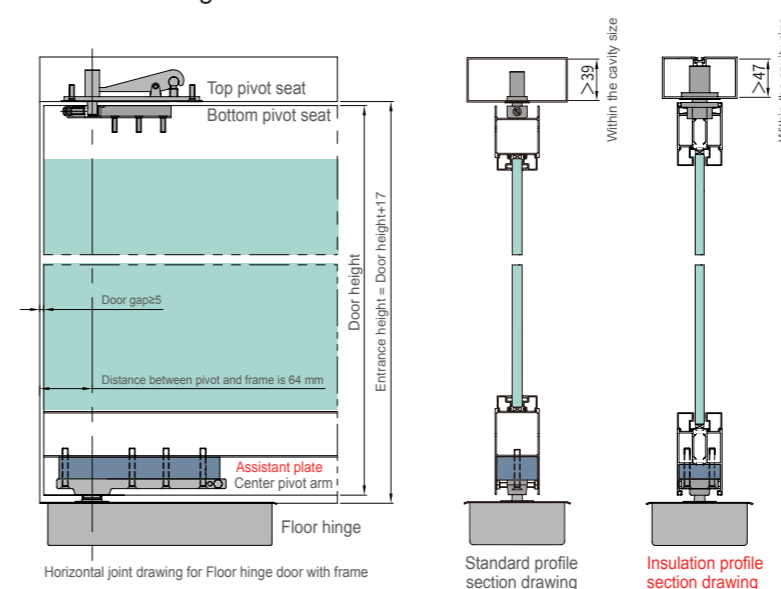

Note :1.Standard products has no assistant plate, thickness of assistant plate is based on the size of space inside profile
 2.Insulation profile accessories need to be purchased separately, technical parameters as Page 49.

Filler Application Instruction

- Put it into the floor hinge
- Fix and test the door

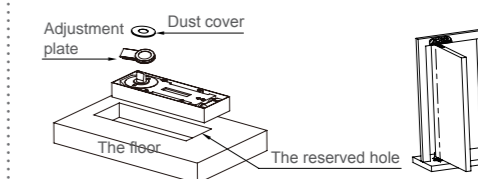

- Pour the powder inside the box
- Fix the cover

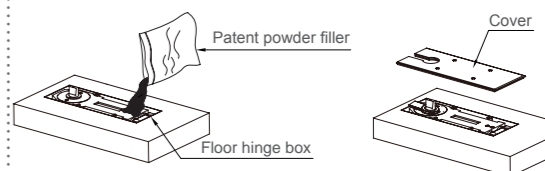

BDH40017 Floor Hinge

Product Drawing

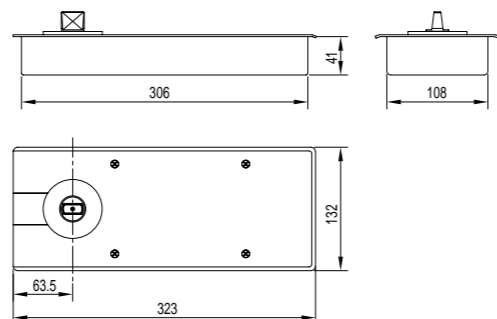

Functional Characteristic

Passed the test of industrial standard QB/T 2697
 Passed the test of SGS & DGM
 Passed the test of EN1154 standard of door closing detection
 Originate the special filler with anti-rust, water proof, keep warm, insect prevention
 It can be used on both left and right side door
 Bidirection opening and the single side opening should be achieved by auxiliary method
 Suit for wooden door, metal door, glass door, frame door

Technical Parameters

Location type: 90°
 Door width: 1150~1400mm
 Maximum Loading: 180kg
 Life cycle: >1,000,000 Cycles
 Main Material: Main body-Gray cast-iron;
 Cover plate—SS304
 Speed control: Two speed section

Suitable Temperature: -15°C~40°C
 Surface of the cover plate: 400#Hairline
 Max open degree: 130°
 Structure of main body: Double-cylinder
 Cover plate thickness: 2.0mm
 Spindle: 14° or 6°

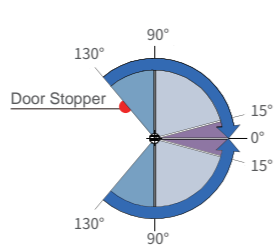

Application Performance

Speed-section 1 closed
 Speed-section 2 closed
 The buffer

① 0° is closing, 90° is location
 ② Two-section adjustment of closing
 90°~15° is closing stage;
 15°~0° is locking stage

To prevent the door from opening beyond the maximum angle, it is recommended to install the door stopper.

Adjustment diagram

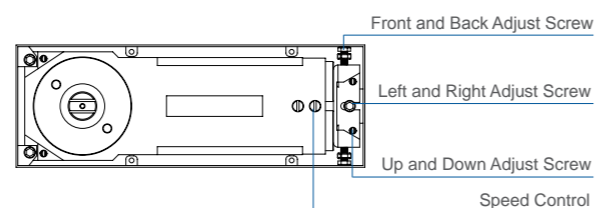

Direction diagram	Name	Adjustment
	Up and down	5mm
	Left and right	8mm
	Front and back	6mm

Accessory products

DS04 Top pivot seat



DX04 Bottom pivot seat



DY05 Center pivot arm

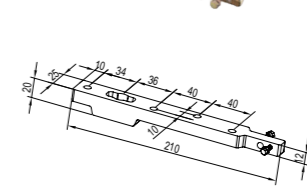
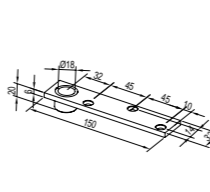
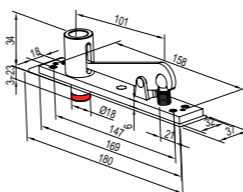

◆ When it is used for the wooden door, metal door, frame door, please select the standard accessories
 ◆ When it is used for the frameless glass door, please select floor hinge without accessories and the pivot hinge hardware (As below)

Floor hinge with standard accessories



Floor hinge without standard accessories

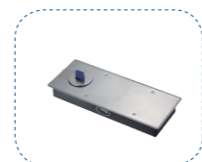

No.	Products	Page
1	Patch fitting	P131-P136
2	Brackets	P143-P144
3	Long patch fitting	P149-P150

selective accessories

BDP40102 Bottom pivot seat (The adjustable)

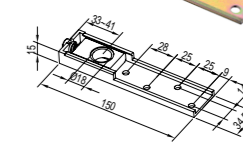
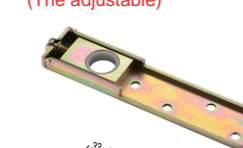

BDP10001 Safety chain

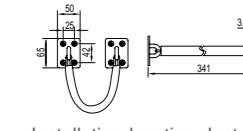

Installation location: Installed at the top of the door sash and door frame
 Applicable door weight: 65~400kg

Spindle can be heightened(Please remark before ordering if required)



Installation Diagram

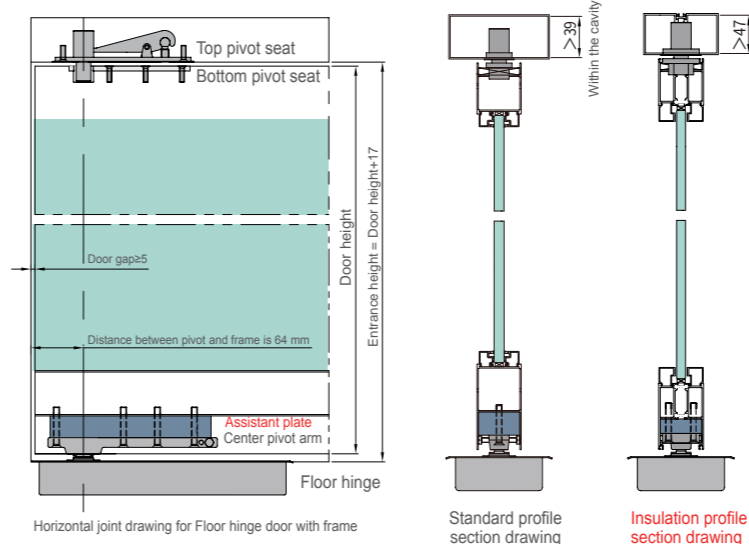

Note : 1. Standard products has no assistant plate, thickness of assistant plate is based on the size of space inside profile
 2. Insulation profile accessories need to be purchased separately, technical parameters as Page 49.

Filler Application Instruction

- Put it into the floor hinge
- Fix and test the door

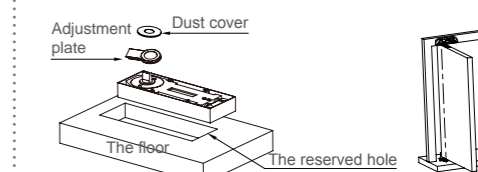

- Pour the powder inside the box
- Fix the cover

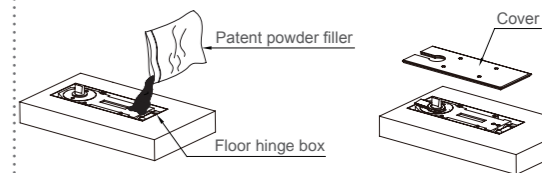

HD407/BDH40008 Floor Hinge

Product Drawing

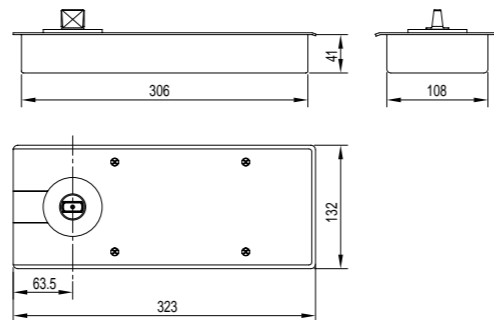

Functional Characteristic

- Passed the test of industrial standard QB/T 2697
- Passed the test of SGS & DGM
- Passed the test of EN1154 standard of door closing detection
- Originate the special filler with anti-rust, water proof, keep warm, insect prevention
- It can be used on both left and right side door
- Bidirection opening and the single side opening should be achieved by auxiliary method
- Suit for wooden door, metal door, glass door, frame door

Technical Parameters

- Location type: 90°/Non-hold
- Door width: 1200~1400mm
- Maximum Loading: 200kg
- Life cycle: >1,000,000 Cycles
- Main Material: Main body-Gray cast-iron; Cover plate—SS304
- Speed control: Two speed section
- Suitable Temperature: -15°C~40°C
- Surface of the cover plate: 400#Hairline
- Max open degree: 130°
- Structure of main body: Double-cylinder
- Cover plate thickness: 2.0mm
- Spindle: 14°or 6°

Application Performance

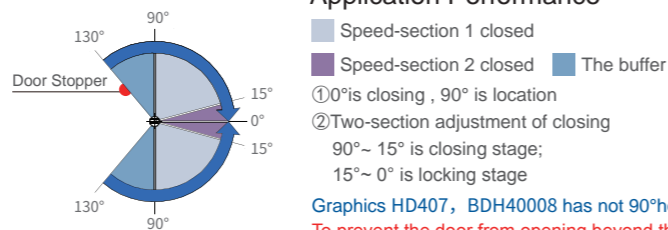

- ①0°is closing , 90° is location
 - ②Two-section adjustment of closing
 - 90°~ 15° is closing stage;
 - 15°~ 0° is locking stage
- Graphics HD407, BDH40008 has not 90°hold function
To prevent the door from opening beyond the maximum angle, it is recommended to install the door stopper.

Adjustment diagram

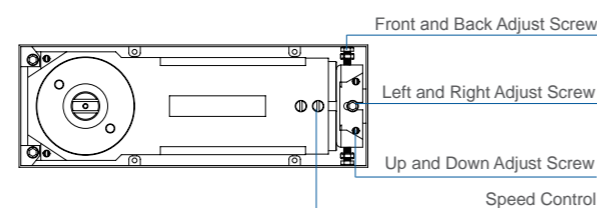

Direction diagram	Name	Adjustment
	Up and down	5mm
	Left and right	8mm
	Front and back	6mm

Accessory products

DS04 Top pivot seat



DX04 Bottom pivot seat



DY05 Center pivot arm

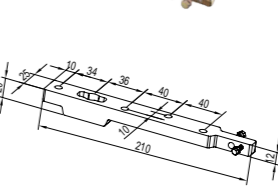
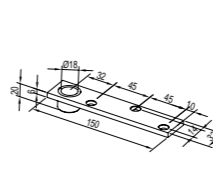
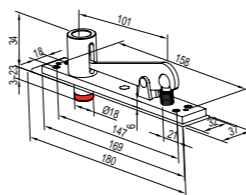

Floor hinge with standard accessories



Floor hinge without standard accessories

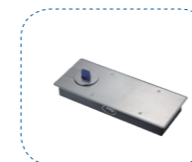

- ◆When it is used for the wooden door, metal door, frame door, please select the standard accessories
- ◆When it is used for the frameless glass door, please select floor hinge without accessories and the pivot hinge hardware (As below)

No.	Products	Page
1	Patch fitting	P131-P136
2	Long patch fitting	P149-P150

selective accessories

BDP40102 Bottom pivot seat (The adjustable)

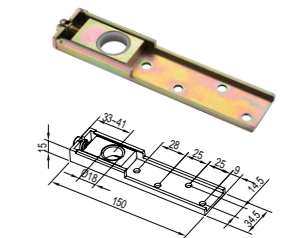

BDP10001 Safety chain

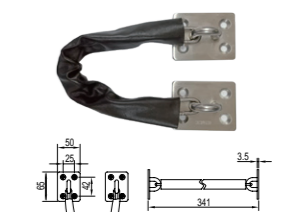

Installation location: Installed at the top of the door sash and door frame
Applicable door weight: 65~400kg

Spindle can be heightened(Please remark before ordering if required)

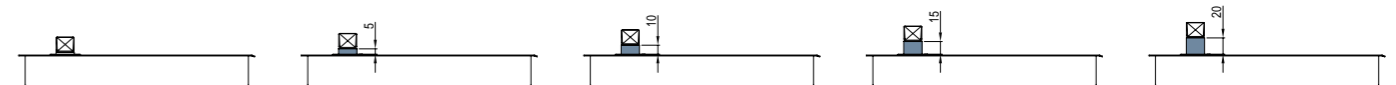

Installation Diagram

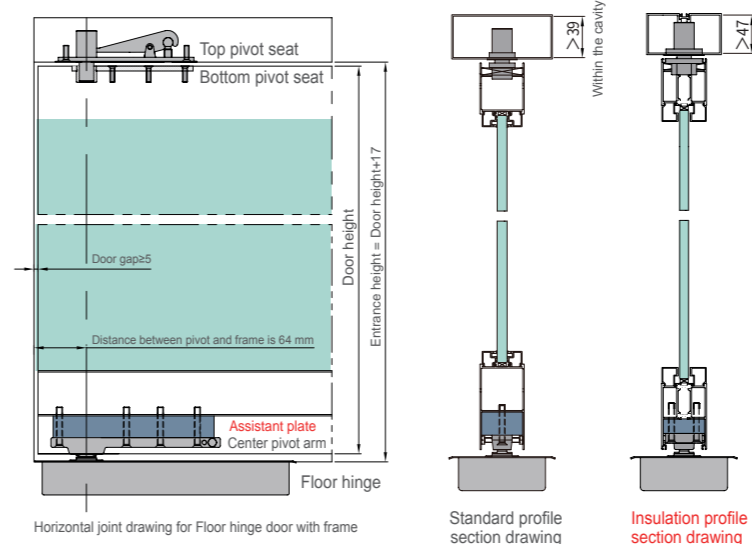

Note :1. Standard products has no assistant plate, thickness of assistant plate is based on the size of space inside profile
2. Insulation profile accessories need to be purchased separately, technical parameters as Page 49.

Filler Application Instruction

- Put it into the floor hinge
- Fix and test the door

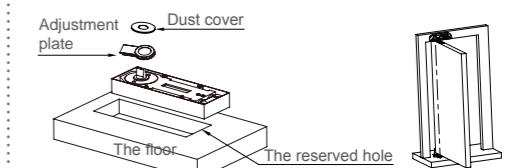

- Pour the powder inside the box
- Fix the cover

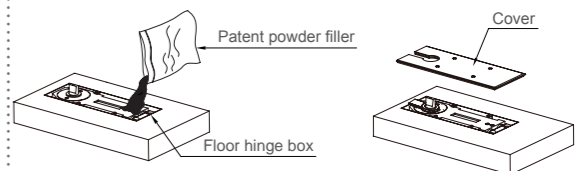

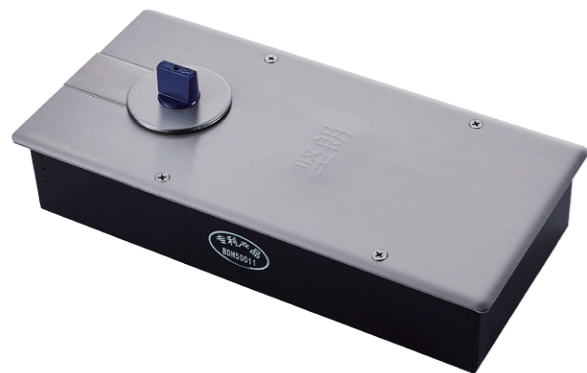

BDH50011/BDH50001 Floor Hinge

Product Drawing

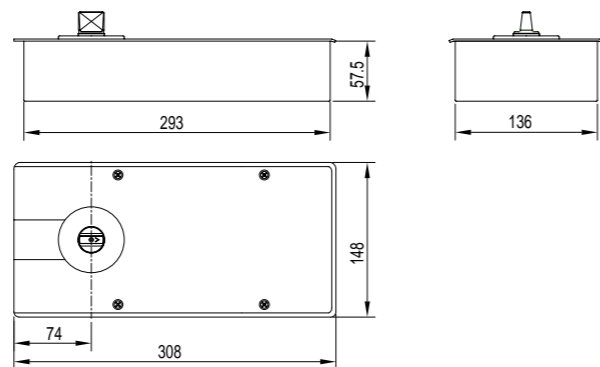

Functional Characteristic

- Passed the test of industrial standard QB/T 2697
- Passed the test of SGS & DGM
- Passed the test of EN1154 standard of door closing detection
- Originate the special filler with anti-rust, water proof, keep warm, insect prevention
- It can be used on both left and right side door
- Bidirection opening and the single side opening should be achieved by auxiliary method
- Suit for wooden door, metal door, glass door, frame door

Technical Parameters

- Location type: 90°/Non-hold
- Door width: 1200~1400mm
- Maximum Loading: 250kg
- Life cycle: >500,000 Cycles
- Main Material: Main body-Gray cast-iron; Cover plate—SS304
- Speed control: Two speed section
- Suitable Temperature: -15°C~40°C
- Surface of the cover plate: 400#Hairline
- Max open degree: 120°
- Structure of main body: Double-cylinder
- Cover plate thickness: 2.0mm
- Spindle: 14°or 6°

Application Performance

- Speed-section 1 closed
- Speed-section 2 closed
- The buffer

① 0° is closing, 90° is location
 ② Two-section adjustment of closing
 90°~15° is closing stage;
 15°~0° is locking stage

Graphics BDH50011, BDH50001 has not 90° hold function
 To prevent the door from opening beyond the maximum angle, it is recommended to install the door stopper.

Adjustment diagram

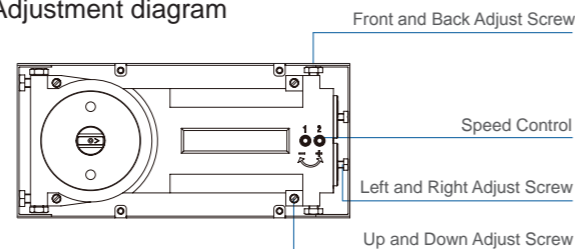

Direction diagram	Name	Adjustment
	Up and down	5mm
	Left and right	5mm
	Front and back	5mm

Accessory products

DS04 Top pivot seat



DX04 Bottom pivot seat



DY05 Center pivot arm

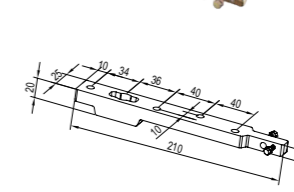
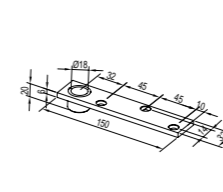
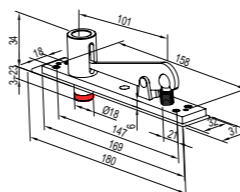

Floor hinge with standard accessories



Floor hinge without standard accessories



- ◆ When it is used for the wooden door, metal door, frame door, please select the standard accessories
- ◆ When it is used for the frameless glass door, please select floor hinge without accessories and the pivot hinge hardware (As below)

No.	Products	Page
1	Patch fitting	P137-P138
2	Long patch fitting	P149-P150

selective accessories

BDP40102 Bottom pivot seat (The adjustable)

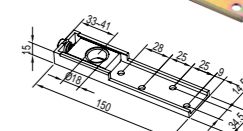

BDP10001 Safety chain

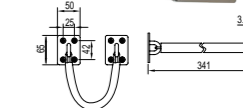

Installation location: Installed at the top of the door sash and door frame
 Applicable door weight: 65~400kg

Spindle can be heightened (Please remark before ordering if required)

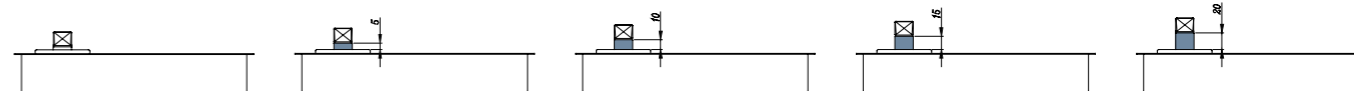

Installation Diagram

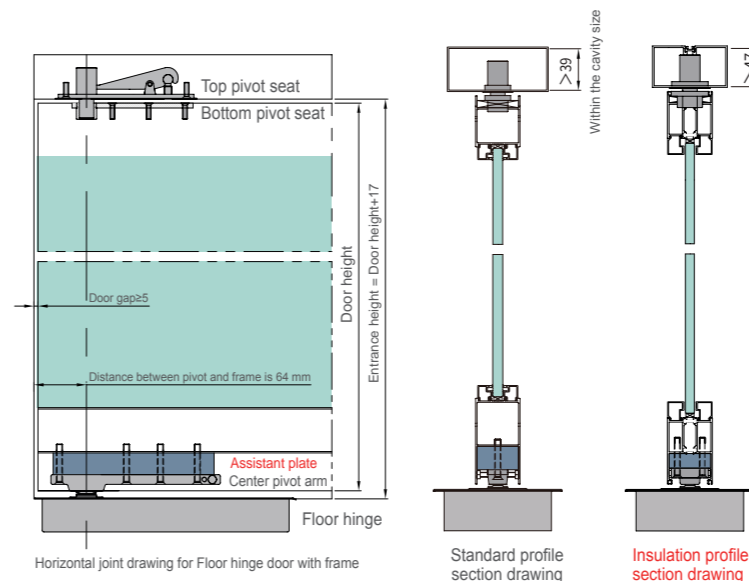

Note : 1. Standard products has no assistant plate, thickness of assistant plate is based on the size of space inside profile
 2. Insulation profile accessories need to be purchased separately, technical parameters as Page 49.

Filler Application Instruction

- Put it into the floor hinge
- Fix and test the door

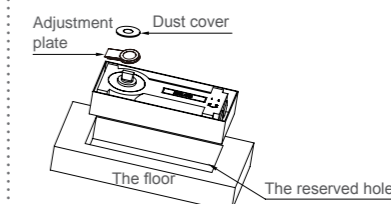

- Pour the powder inside the box
- Fix the cover

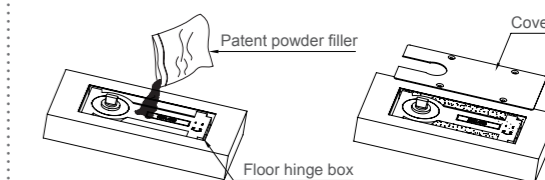



BDH50012 Floor Hinge

Product Drawing

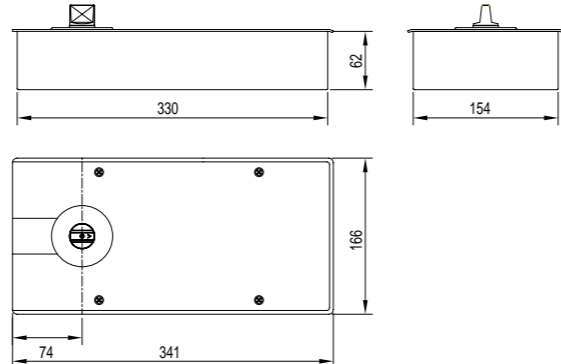

Functional Characteristic

Passed the test of industrial standard QB/T 2697
 Passed the test of SGS & DGM
 Passed the test of EN1154 standard of door closing detection
 Originate the special filler with anti-rust, water proof, keep warm, insect prevention
 It can be used on both left and right side door
 Bidirection opening and the single side opening should be achieved by auxiliary method
 Suit for wooden door, metal door, glass door, frame door

Technical Parameters

Location type: 90° Suitable Temperature: -15°C~40°C
 Door width: 1200~1500mm; Surface of the cover plate: 400#Hairline
 Maximum Door high: 3200mm Max open degree: 120°
 Maximum Loading: 300kg Structure of main body: Double-cylinder
 Life cycle: >500,000 Cycles Cover plate thickness: 2.0mm
 Main Material: Main body-Gray cast-iron; Spindle: 14°
 Cover plate—SS304
 Speed control: Two speed section

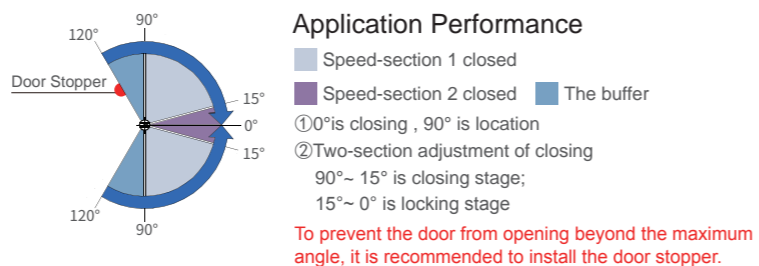

Adjustment diagram

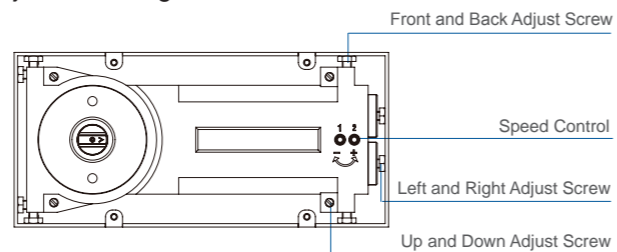

Direction diagram	Name	Adjustment
Up and down	Up and down	5mm
Left and right	Left and right	5mm
Front and back	Front and back	7mm

Accessory products

DS04 Top pivot seat



DX04 Bottom pivot seat



BDP60103 Center pivot arm

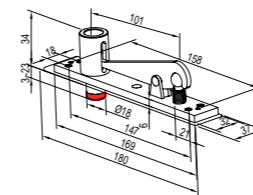
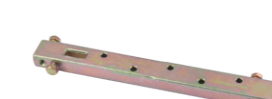

Floor hinge with standard accessories



Floor hinge without standard accessories

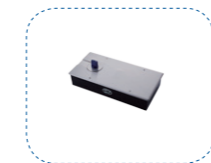

- ◆When it is used for the wooden door, metal door, frame door, please select the standard accessories
- ◆When it is used for the frameless glass door, please select floor hinge without accessories and the pivot hinge hardware (As below)

No.	Products	Page
1	Patch fitting	P137-P138

selective accessories

BDP40102 Bottom pivot seat (The adjustable)

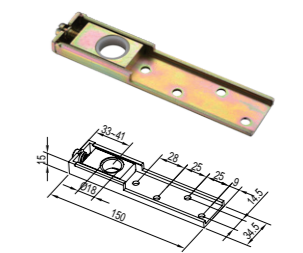

BDP10001 Safety chain

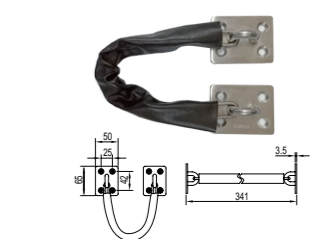

Installation location: Installed at the top of the door sash and door frame
 Applicable door weight: 65~400kg

Spindle can be heightened(Please remark before ordering if required)

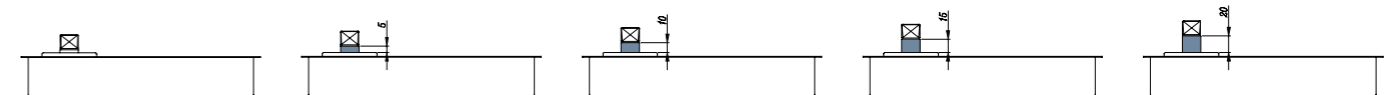

Installation Diagram

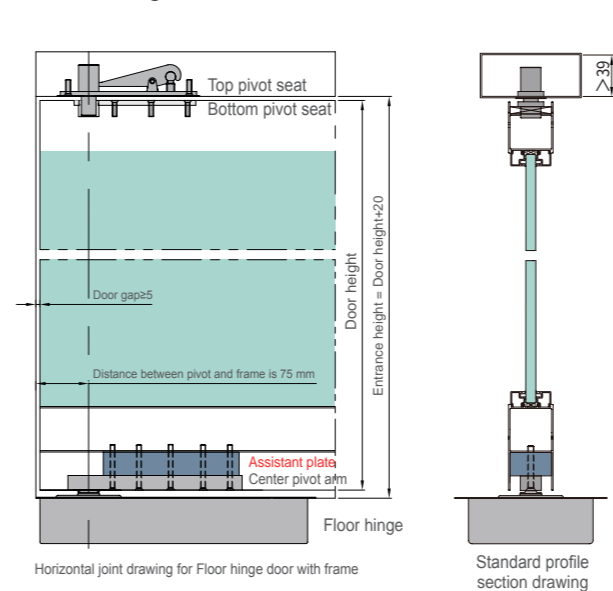

Note: Standard products has no assistant plate, thickness of assistant plate is based on the size of space inside profile

Filler Application Instruction

- Put it into the floor hinge
- Fix and test the door

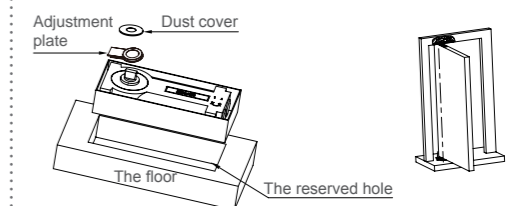

- Pour the powder inside the box
- Fix the cover

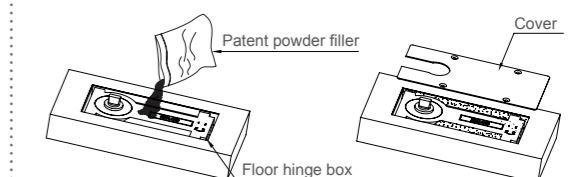



BDH50013 Floor Hinge

Product Drawing

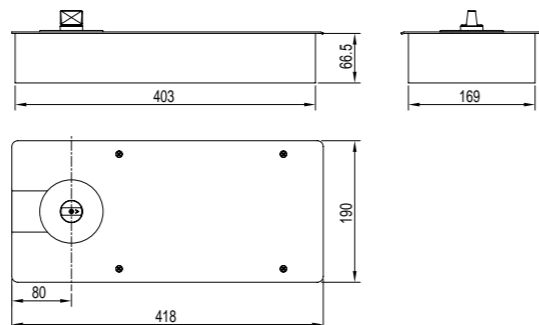

Functional Characteristic

Passed the test of industrial standard QB/T 2697
 Passed the test of SGS & DGM
 Passed the test of EN1154 standard of door closing detection
 Originate the special filler with anti-rust, water proof, keep warm, insect prevention
 It can be used on both left and right side door
 Bidirection opening and the single side opening should be achieved by auxiliary method
 Suit for wooden door, metal door, glass door, frame door

Technical Parameters

Location type: 90°
 Door width: 1200~1500mm;
 Maximum Door high: 3800mm
 Maximum Loading: 350kg
 Life cycle: >500,000 Cycles
 Main Material: Main body-Gray cast-iron;
 Cover plate—SS304
 Speed control: Two speed section
 Suitable Temperature: -15°C~40°C
 Surface of the cover plate: 400#Hairline
 Max open degree: 120°
 Structure of main body: Double-cylinder
 Cover plate thickness: 2.0mm
 Spindle: 14°

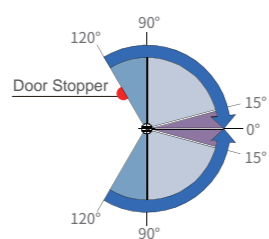

Application Performance

Speed-section 1 closed
 Speed-section 2 closed
 The buffer
 ① 0° is closing, 90° is location
 ② Two-section adjustment of closing
 90°~15° is closing stage;
 15°~0° is locking stage

To prevent the door from opening beyond the maximum angle, it is recommended to install the door stopper.

Adjustment diagram

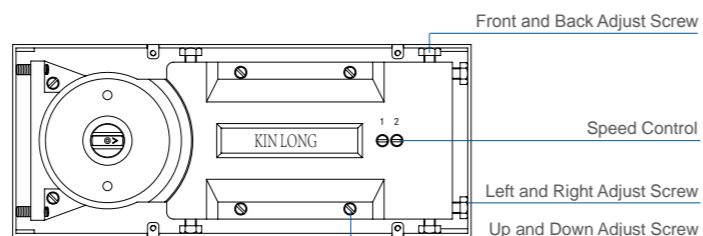

Direction diagram	Name	Adjustment
Up and down	Up and down	5mm
Left and right	Left and right	7mm
Front and back	Front and back	5mm

Accessory products

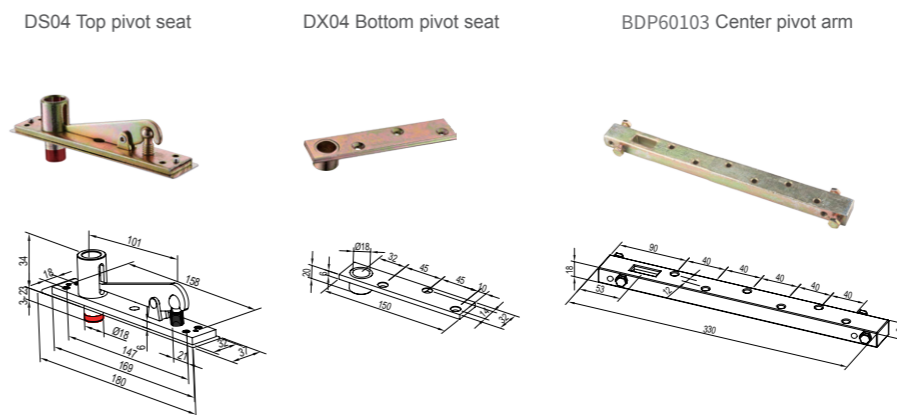

Floor hinge with standard accessories



selective accessories

BDP40102 Bottom pivot seat
 (The adjustable)

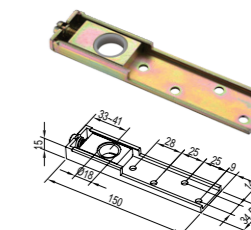

BDP10001 Safety chain

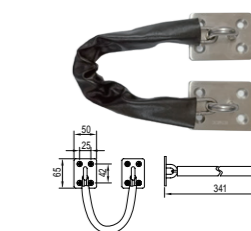

Installation location: Installed at the top of the door sash and door frame
 Applicable door weight: 65~400kg

Spindle can be heightened(Please remark before ordering if required)

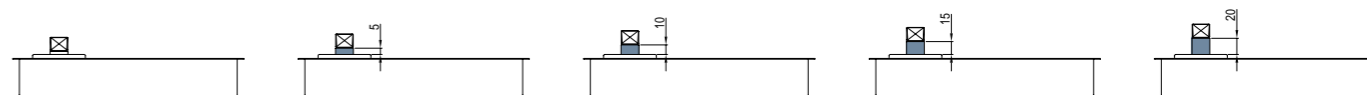

Installation Diagram

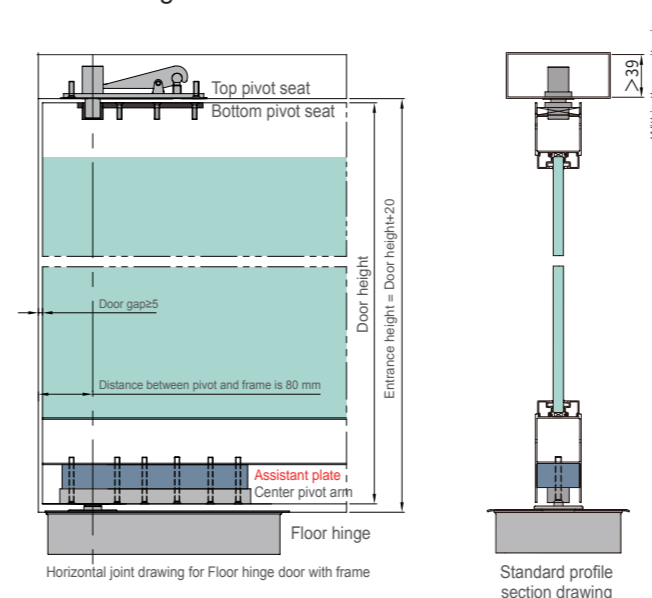

Note: Standard products has no assistant plate, thickness of assistant plate is based on the size of space inside profile

Filler Application Instruction

- Put it into the floor hinge
- Fix and test the door

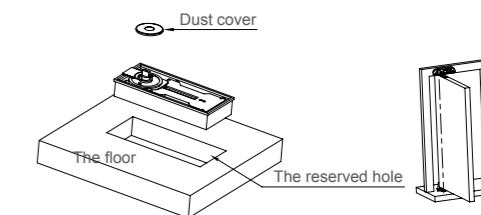

- Pour the powder inside the box
- Fix the cover

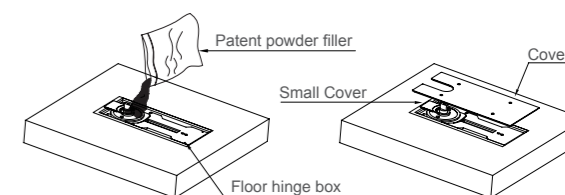



BDH50014 Floor Hinge

Product Drawing

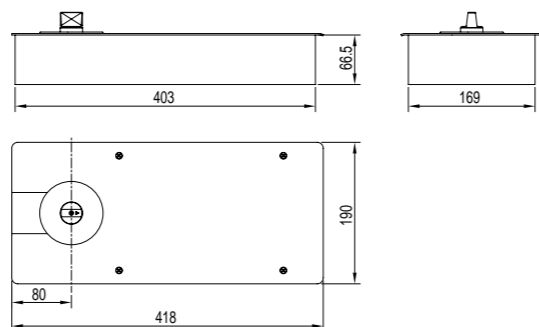

Functional Characteristic

Passed the test of industrial standard QB/T 2697
 Passed the test of SGS & DGM
 Passed the test of EN1154 standard of door closing detection
 Originate the special filler with anti-rust, water proof, keep warm, insect prevention
 It can be used on both left and right side door
 Bidirection opening and the single side opening should be achieved by auxiliary method
 Suit for wooden door, metal door, glass door, frame door

Technical Parameters

Location type: 90° Suitable Temperature: -15°C~40°C
 Door width: 1200~1500mm; Surface of the cover plate: 400#Hairline
 Maximum Door high: 4200mm; Max open degree: 120°
 Maximum Loading: 400kg Structure of main body: Double-cylinder
 Life cycle: >500,000 Cycles Cover plate thickness: 2.0mm
 Main Material: Main body-Gray cast-iron; Spindle: 14°
 Cover plate—SS304
 Speed control: Two speed section

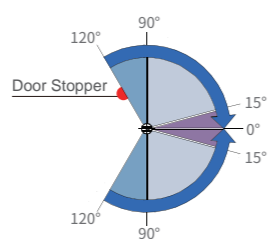

Application Performance

- Speed-section 1 closed
 - Speed-section 2 closed
 - The buffer
- ① 0° is closing, 90° is location
 ② Two-section adjustment of closing
 90°~15° is closing stage;
 15°~0° is locking stage

To prevent the door from opening beyond the maximum angle, it is recommended to install the door stopper.

Adjustment diagram

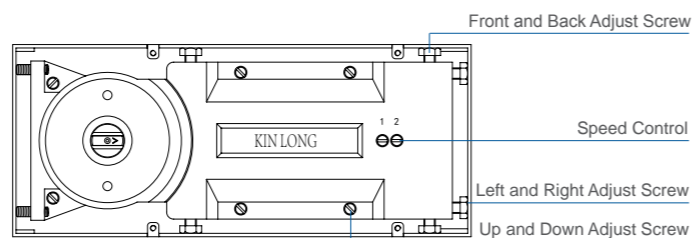

Direction diagram	Name	Adjustment
Up and down	Up and down	5mm
	Left and right	7mm
Front and back	Front and back	5mm

Accessory products

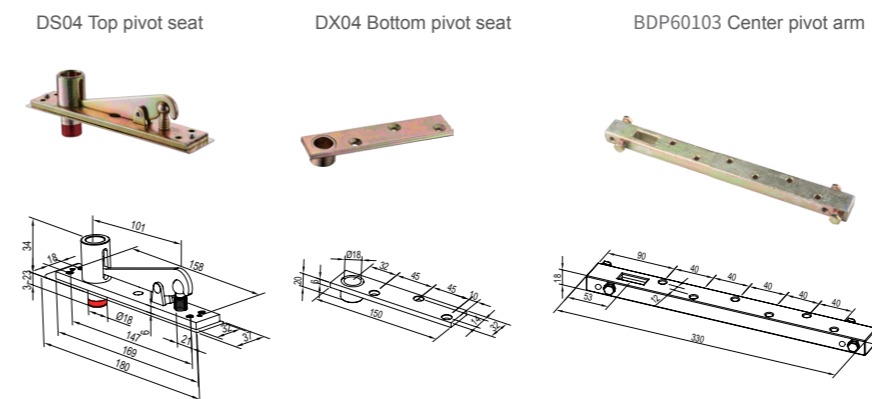

Floor hinge with standard accessories



selective accessories

BDP40102 Bottom pivot seat (The adjustable)

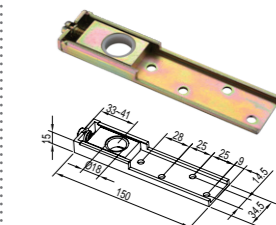

BDP10001 Safety chain

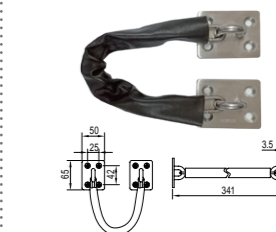

Installation location: Installed at the top of the door sash and door frame
 Applicable door weight: 65~400kg

Spindle can be heightened(Please remark before ordering if required)

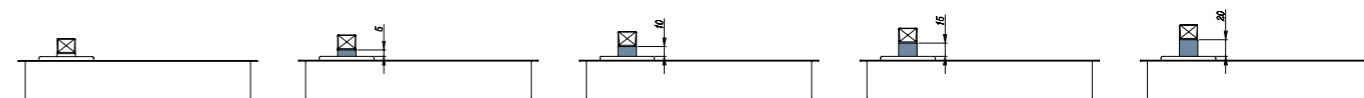

Installation Diagram

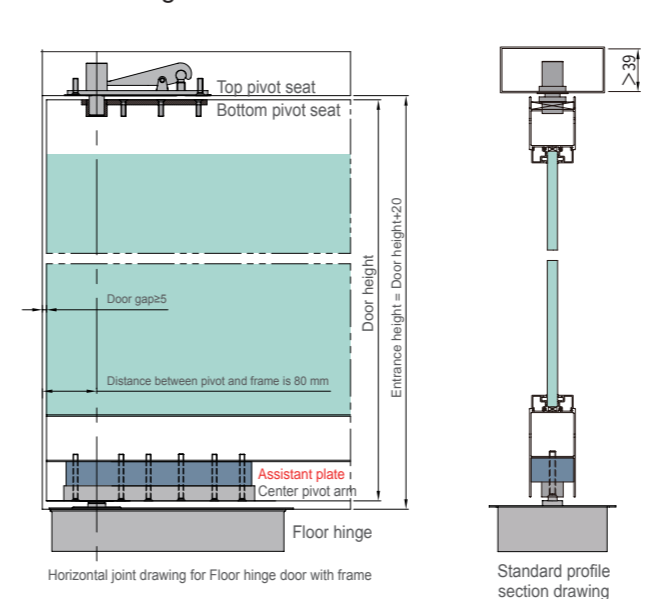

Note: Standard products has no assistant plate, thickness of assistant plate is based on the size of space inside profile

Filler Application Instruction

- Put it into the floor hinge
- Fix and test the door

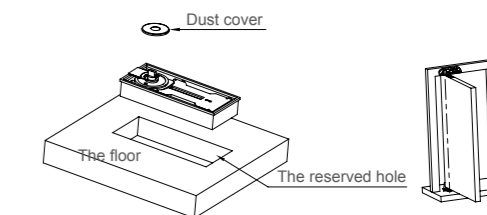

- Pour the powder inside the box
- Fix the cover

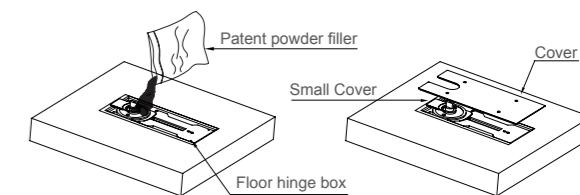



BDH60015/BDH60016 Sky Hinge New

Product Drawing

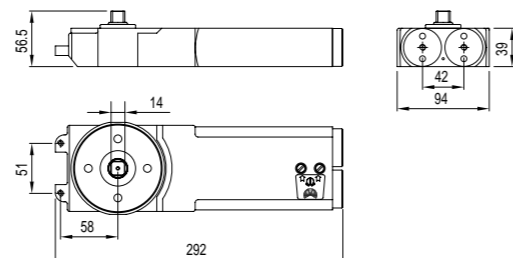

Functional Characteristic

Passed the test of industrial standard QB/T 2697
 Passed the test of EN1154 standard of door closing detection
 Bidirection opening and the single side open should be achieved by auxiliary method
 Suit for wooden door, metal door, glass door, frame door (only for top installation)

Technical Parameters

Location type: 90°	Speed control: Two speed section
Door width: 800~1000mm/800~1200mm	Suitable Temperature: -15°C~40°C
Maximum Loading: 85kg/100kg	Max open degree: 130°
Life cycle: >500,000 Cycles	Structure of main body: Double-cylinder
Main Material: Main body-Grey cast-iron;	Spindle: Square Shaft

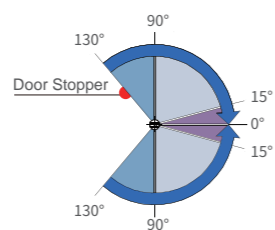

Application Performance

- Speed-section 1 closed
 - Speed-section 2 closed
 - The buffer
- ① 0° is closing, 90° is location
 ② Two-section adjustment of closing
 90°~15° is closing stage;
 15°~0° is locking stage

To prevent the door from opening beyond the maximum angle, it is recommended to install the door stopper.

Accessory products

BDH60016-09 Rear mount support

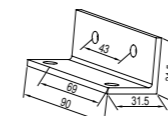

BDH60016-12 Front mount support

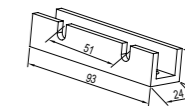

BDH60016-16 Undercarriage

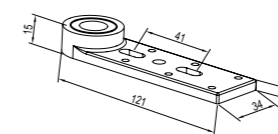

BDH60016-08 Rocker



BDH60016-06 Bottom support

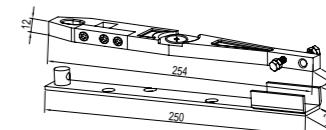
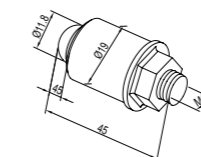

Installation Diagram

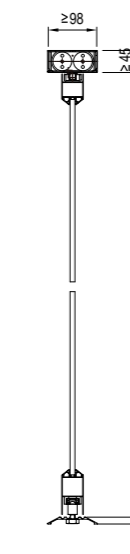
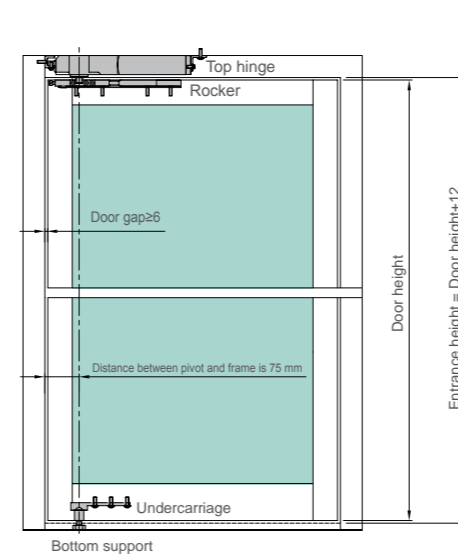

Installation instructions for standard accessories

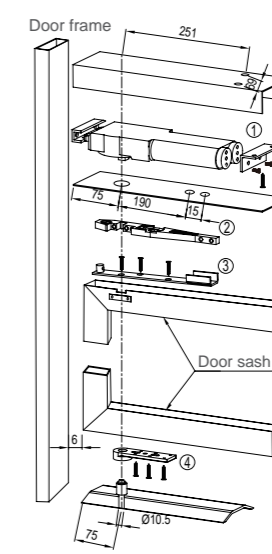

Installation instructions for optional accessories

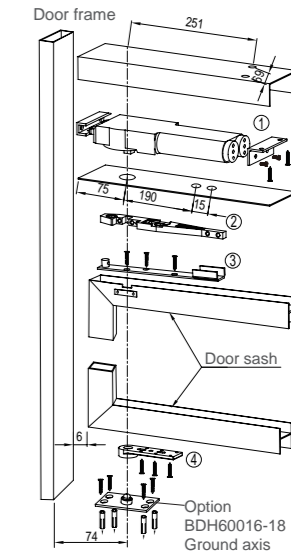

Concealed Floor Hinge



Part Details

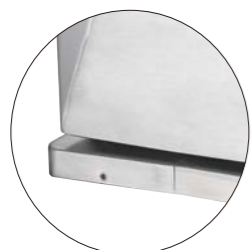

Rhombus edge design



High quality shaft



Base support

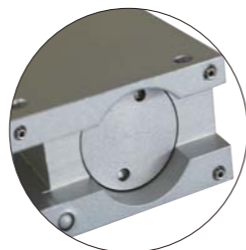

Aluminium alloy machine core

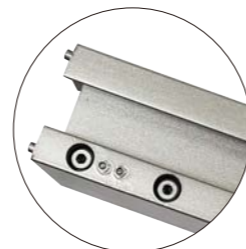

Two speed section

BDH70014 / BDH70015 Concealed Floor Hinge

Product Drawing

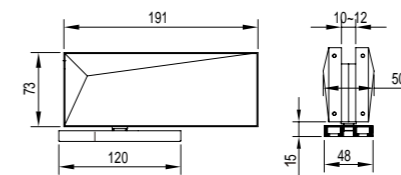

Cut-out Drawing

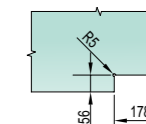

Functional Characteristic

Passed the test of industrial standard QB/T 2697
 Passed the test of EN1154 standard of door closing detection
 Install on ground, convenient for construction.
 Has delicate appearance design, and combine the traditional floor hinge with the bottom patch.
 No need to dig hole, shortening construction period, and do not destroy the floor structure.
 The base is adjustable: front and back ± 3 mm, left and right ± 3 mm, angle $\pm 4^\circ$
 Two-way opening door leaf, one-way opening must be realized by auxiliary method.
 It's suitable for the frameless glass door.

Technical Parameters

Location type	90°-130°hold-open
Door width	650-800mm/750-900mm
Maximum Bearing	85Kg/100Kg
Service life	>300,000 cycles

Main Body Material	Aluminum alloy
Speed control	Two speed section
Suitable Temperature	-15°C-40°C
Max open degree	130°

Spindle	3°
Structure of main body	Mirror + Satin
Steel cover material/ thickness	S.S 304/1.0mm
glass thickness	10-12mm

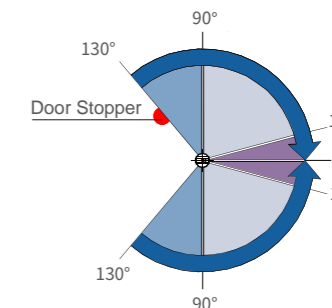

Application Performance

- Speed-section 1 closed
- Speed-section 2 closed
- Buffer zone

- ① 0° is closing, 90°-130° is location;
- ② Two-section adjustment of closing:
 90°-15° is closing stage;
 15°-0° is locking stage.

Installation Diagram

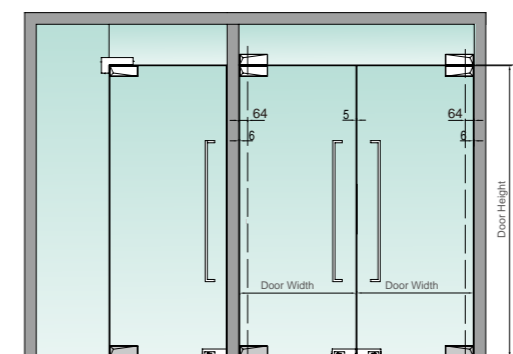

The laying-off of glass door leaf height = Doorway height- 20 (up and down)

◆ Concealed floor hinge can be used with door control hardware. (See the form below)

No.	Name	Page
1	Upper patch KMJ44320	P125
2	Top patch KMJ44330	P125
3	Top pivot seat DS03/ DS05	P12/P4
4	Top Pivot KHY53520 KHY53511	P178

Accessories for insulation profile

■ DS07 Top pivot seat

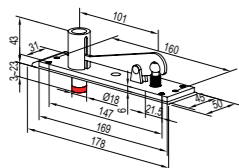
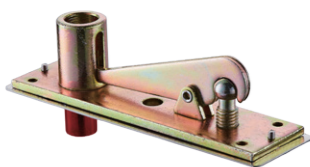

■ DX07 Bottom pivot seat

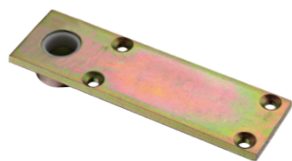

■ DY07 Center pivot arm

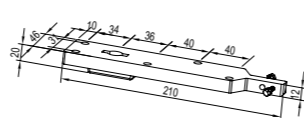

■ BDP70201 Top pivot seat

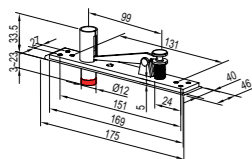
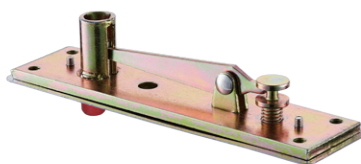

■ BDP70202 Bottom pivot seat

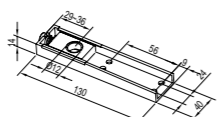
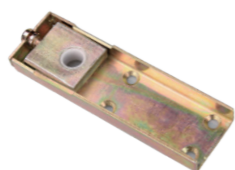

■ BDP70203 Center pivot arm

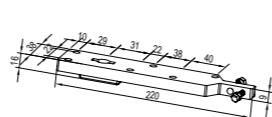
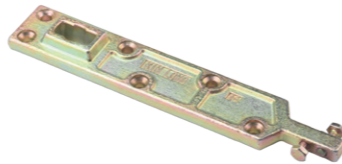

Accessories for circular tube profile

■ DS03 Top pivot seat

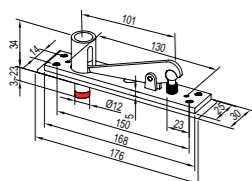
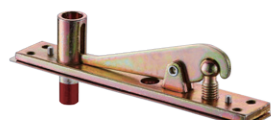

■ DX09 Bottom pivot seat

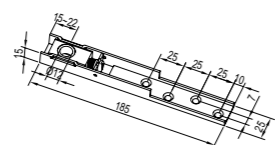
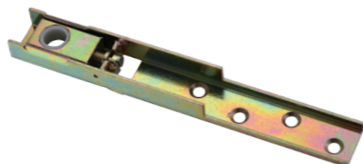

■ DY09 Center pivot arm

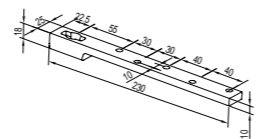

Configuration comparison table of standard floor hinge accessories

No.	Floor hinge code	Standard profile			Insulation profile		
		Top pivot seat code	Bottom pivot seat code	Center pivot arm code	Top pivot seat code	Bottom pivot seat code	Center pivot arm code
1	HD101/HDF101	DS05	DX05	DY05	DS07/BDP70201	DX07/BDP70202	DY07/BDP70203
2	HD102						
3	HD103/BDH10003						
4	HD201						
5	BDH20114						
6	HD203/HDF203						
7	HD204						
8	BDH20314/BDH20304						
9	BDH20315/BDH20305						
10	HD205/HDF205						
11	HD304						
12	HD305						
13	HD403						
14	HD405						
15	HD406/HDF406						
16	BDH40017	DS04	DX04	BDP60103			
17	HD407/BDH40008				/	/	/
18	BDH50011/BDH50001				/	/	/
19	BDH50012				/	/	/
20	BDH50013			BDP60003			
21	BDH50014						

Matters need attention:

- The selection is mainly based on the width, weight of the door and the actual situation of the project; Improper selection will affect the using effectiveness and product life.
- Glass door weight (kg) = glass area (m²) x glass thickness (mm) x 2.56 (density)
- Profile door weight (kg) = glass area (m²) x glass thickness (mm) x 2.56 (density) x 1.2 (safety coefficient)
- Whole door weight (kg) = glass door weight / profile door weight + all parts weight

Glass door weight list					
Common glass thickness	8mm	10mm	12mm	15mm	19mm
Weight per (m ²)	20.5Kg	25.6Kg	30.7Kg	38.4Kg	48.6Kg