

Centaurus Adjustable Standoff

- Patented product
- Load tested by NATA accredited laboratory
- Quick and easy adjustment after installation without removing glass panel
- No shims or washers required between wall and standoff base
- Available diameter: 38mm and 50mm
- Available standoff base length: 30mm, 40mm and 50mm
- Standoff base is made of 2205SS and cap is made of 316SS
- Heavy duty threaded rod made from 316 stainless steel
- Additional fixing holes in base for extra rigidity
- Available in mirror polished, satin and matt black finish

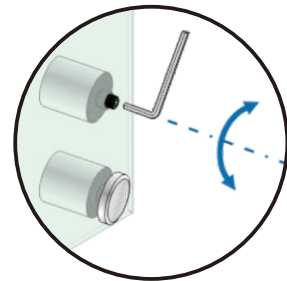

Adjustment after installation with just an Allen key and no need to remove glass panel

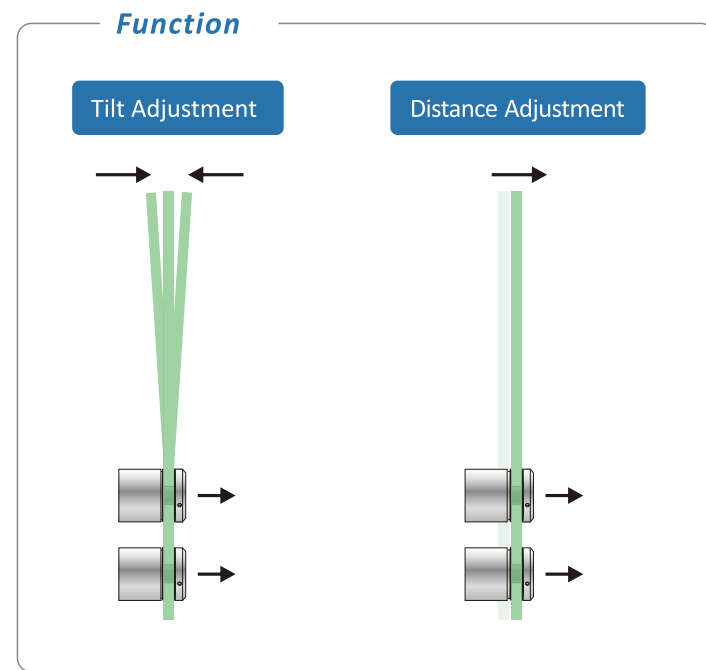

There are additional ø5.5mm fixing holes in standoff base, extra screws can be used if extra rigidity is needed



Standoff Gear
Code: PQR3850B

Recommended tightening tool for fastening standoff base and cap. Details please refer to page 47.

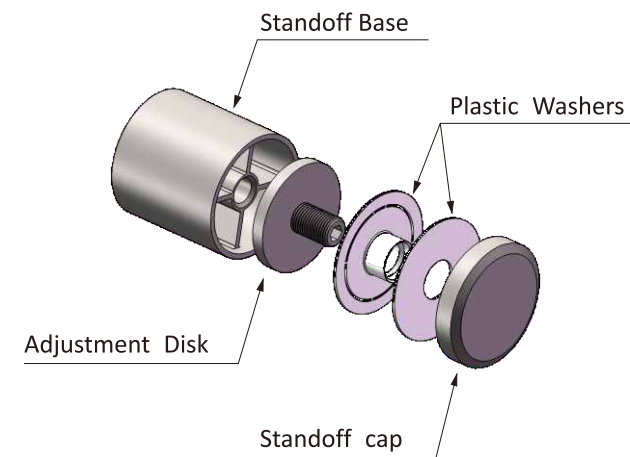

Code	Finish
SOA3832M6	Polished
SOA3832S6	Satin
SOA3832B5	Matt Black
Centaurus adjustable standoff 2205, 316 stainless steel Diameter 38mm Base length 30mm	



Code	Finish
SOA3842M6	Polished
SOA3842S6	Satin
SOA3842B5	Matt Black
Centaurus adjustable standoff 2205, 316 stainless steel Diameter 38mm Base length 40mm	



Code	Finish
SOA3852M6	Polished
SOA3852S6	Satin
SOA3852B5	Matt Black
Centaurus adjustable standoff 2205, 316 stainless steel Diameter 38mm Base length 50mm	



Code	Finish
SOA5032M6	Polished
SOA5032S6	Satin
SOA5032B5	Matt Black
Centaurus adjustable standoff 2205, 316 stainless steel Diameter 50mm Base length 30mm	



Code	Finish
SOA5042M6	Polished
SOA5042S6	Satin
SOA5042B5	Matt Black
Centaurus adjustable standoff 2205, 316 stainless steel Diameter 50mm Base length 40mm	



Code	Finish
SOA5052M6	Polished
SOA5052S6	Satin
SOA5052B5	Matt Black
Centaurus adjustable standoff 2205, 316 stainless steel Diameter 50mm Base length 50mm	

Solid Standoff And Accessories

- 316 Stainless Steel (cap is made of 316 L)
- Threaded rods and lag screws also made of 316 stainless steel
- Engineered for 12mm (1/2") glass
- Precision machining on cap with beveled edge
- Threaded through entire base, allows flexibility in installation
- 30mm long heavy duty 12mm (M12) threaded rod connecting base and cap
- Longer threaded rod is available for thicker glass

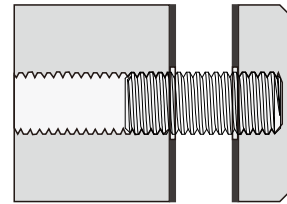

Standoff-Diameter 38mm

Code	Finish
SOR3850M6	Polished
SOR3850S6	Satin
SOR3850B6	Matt Black

Code	Finish
SOR3840M6	Polished
SOR3840S6	Satin
SOR3840B6	Matt Black

Code	Finish
SOR3830M6	Polished
SOR3830S6	Satin
SOR3830B6	Matt Black

Code	Finish
SOR3820M6	Polished
SOR3820S6	Satin
SOR3820B6	Matt Black

Code	Finish
SOR3810M6	Polished
SOR3810S6	Satin
SOR3810B6	Matt Black

Standoff-Diameter 50mm

Code	Finish
SOR5050M6	Polished
SOR5050S6	Satin
SOR5050B6	Matt Black

Code	Finish
SOR5040M6	Polished
SOR5040S6	Satin
SOR5040B6	Matt Black

Code	Finish
SOR5030M6	Polished
SOR5030S6	Satin
SOR5030B6	Matt Black

Code	Finish
SOR5020M6	Polished
SOR5020S6	Satin
SOR5020B5	Matt Black

Code	Finish
SOR5010M6	Polished
SOR5010S6	Satin
SOR5010B5	Matt Black

Standoff Base

Code	Finish
SOR3805-2M6	Polished
SOR3805-2S6	Satin
SOR3805-2B6	Matt Black

Code	Finish
SOR3810-2M6	Polished
SOR3810-2S6	Satin
SOR3810-2B6	Matt Black

Code	Finish
SOR3820-2M6	Polished
SOR3820-2S6	Satin
SOR3820-2B6	Matt Black

Code	Finish
SOR3830-2M6	Polished
SOR3830-2S6	Satin
SOR3830-2B6	Matt Black

Code	Finish
SOR3840-2M6	Polished
SOR3840-2S6	Satin
SOR3840-2B6	Matt Black

Code	Finish
SOR3850-2M6	Polished
SOR3850-2S6	Satin
SOR3850-2B6	Matt Black

Code	Finish
SOR5005-2M6	Polished
SOR5005-2S6	Satin
SOR5005-2B6	Matt Black

Code	Finish
SOR5010-2M6	Polished
SOR5010-2S6	Satin
SOR5010-2B6	Matt Black

Code	Finish
SOR5020-2M6	Polished
SOR5020-2S6	Satin
SOR5020-2B5	Matt Black

Code	Finish
SOR5030-2M6	Polished
SOR5030-2S6	Satin
SOR5030-2B6	Matt Black

Code	Finish
SOR5040-2M6	Polished
SOR5040-2S6	Satin
SOR5040-2B6	Matt Black

Code	Finish
SOR5050-2M6	Polished
SOR5050-2S6	Satin
SOR5050-2B6	Matt Black

316 Stainless Steel Screws

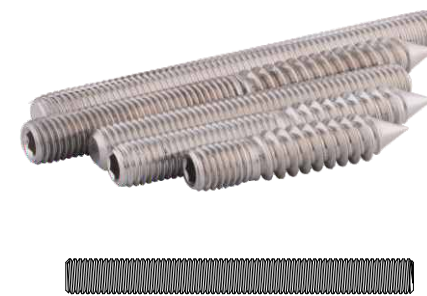

Code	SMJ12060	SMJ12090	SMJ12120	SMJ12150
Size	M12x60mm	M12x90mm	M12x120mm	M12x150mm

Note: Length can be customized



Code	SMG12060	SMG12090	SMG12120	SMG12150
Size	M12x60mm	M12x90mm	M12x120mm	M12x150mm

Note: Length can be customized

Standoff Cap

Code	Finish
SOR3810-1M6	Polished
SOR3810-1S6	Satin
SOR3810-1B6	Matt Black

316L Stainless Steel
Size: ø38x10mm

Code	Finish
SOR5010-1M6	Polished
SOR5010-1S6	Satin
SOR5010-1B6	Matt Black

316L Stainless Steel
Size: ø50x10mm

Washers -1mm Thickness

Code	Size
POR3801B	ø38x14mm
POR3802B	ø38x16mm
POR5001B	ø50x14mm
POR5002B	ø50x16mm

Standoff Gear

A Patented Product Engineered For
Easy Installation of $\phi 38\text{mm}$ & $\phi 50\text{mm}$ standoffs.



Code: PQR3850A



Code: PQR3850B

Used for tightening standoff caps
Suits both diameter 38mm and 50mm

Equipped with two steel pins for
fastening Centaurus Adjustable base



Tighten Standoff Cap

Choose the side of standoff gear with matching diameter to the standoff cap, hook the pin into the hole on standoff cap and ensure the standoff cap is level and embedded completely within the standoff gear, then rotate to tighten the standoff cap.

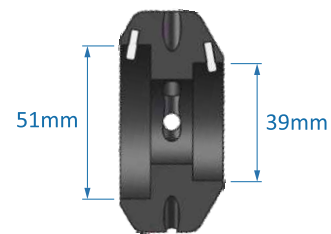

Suits both $\phi 38\text{mm}$ and $\phi 50\text{mm}$ standoff caps

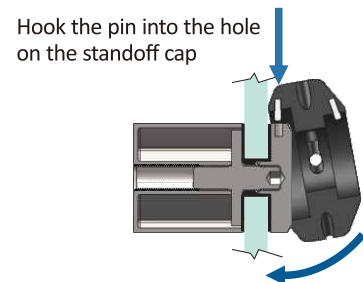

Hook the pin into the hole
on the standoff cap

Embed the standoff cap completely
within the standoff gear

There are four additional holes on the
side of standoff gear for screwdriver to
be inserted if more torque is required
to tighten the standoff cap.



Fasten Standoff Base



There are two pins in the standoff
gear which can be screwed out with
a M5 Allen key.



Insert two pins into the standoff base and
rotate to fasten the standoff base.

