

GLA1910MA 19mm f/1.0 Manual Optical Athermalized Infrared Lens

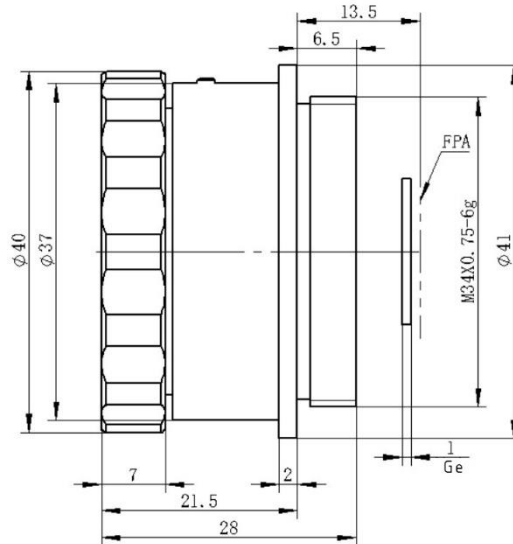

| HFOV | 160x120 | 320x240 | 336x256 | 384x288 | 640x480 | 640x512 |
|------------|---------|---------|---------|---------|---------|---------|
| 25 μ m | 12° | 23.8° | 24.9° | 28.4° | | |
| 17 μ m | 8.2° | 16.3° | 17.1° | 19.5° | 32° | 32° |
| 12 μ m | 5.8° | 11.5° | 12.1° | 13.8° | 22.9° | 22.9° |

Optical

| | |
|--------------|--------------|
| Focal Length | 19mm |
| F/# | 1.0 |
| Wavelength | 8-12 μ m |
| Focus Range | 1m-Infinity |

Mechanical

| | |
|-----------------|-----------------------------|
| Interface | Thread |
| Focus Mechanism | Manual Optical Athermalized |
| Dimensions (mm) | $\phi 41 \times 28$ |
| Weight | <67g |

Environmental

| | |
|-----------------------|----------------|
| Operating Temperature | -40°C to +60°C |
| Storage Temperature | -40°C to +80°C |
| External Coating | AR |
| Front Element Sealing | IP67 |

MTF@+20°C 640x512 17 μ m

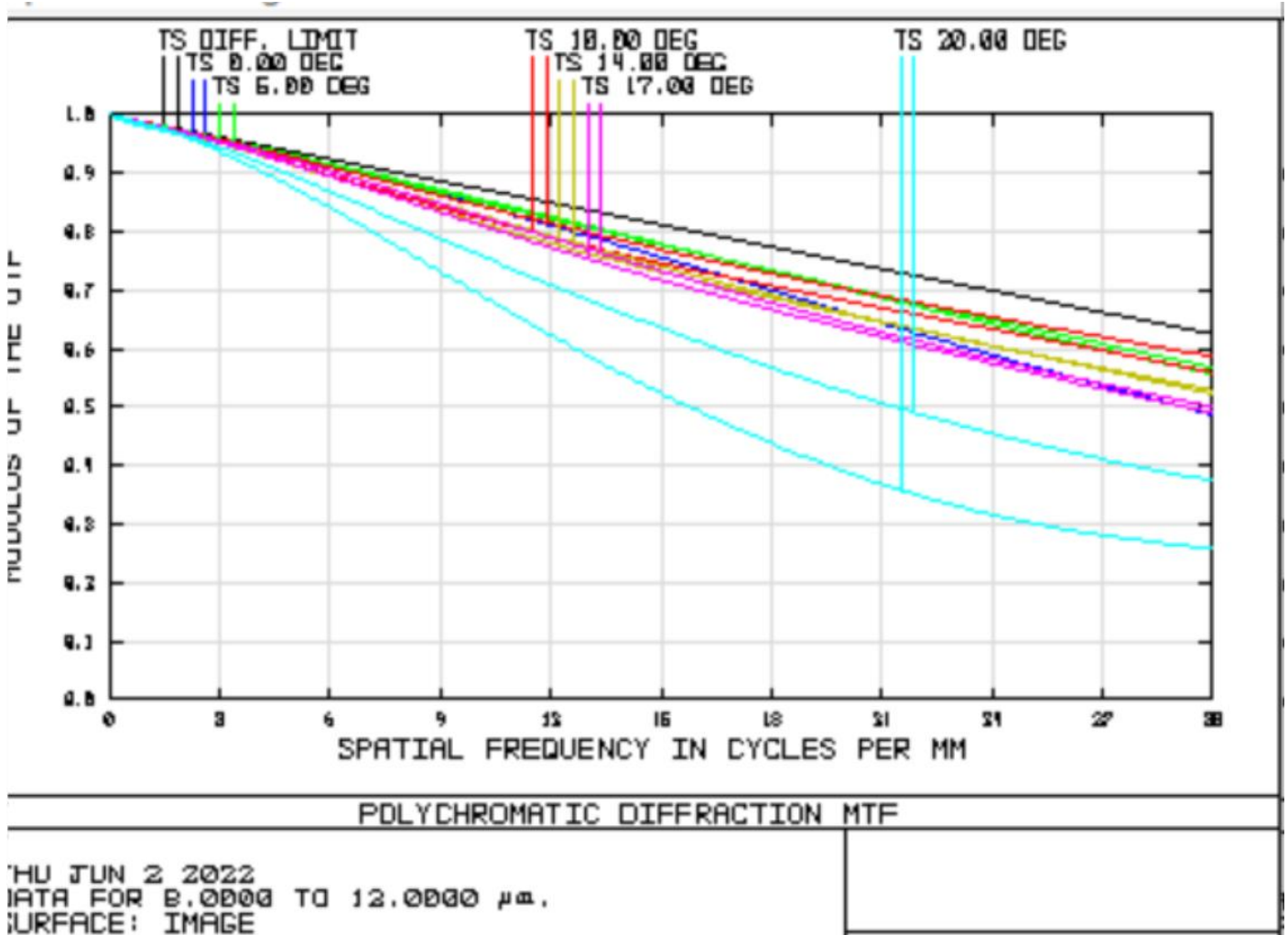

MTF@-40°C 640x512 17 μ m

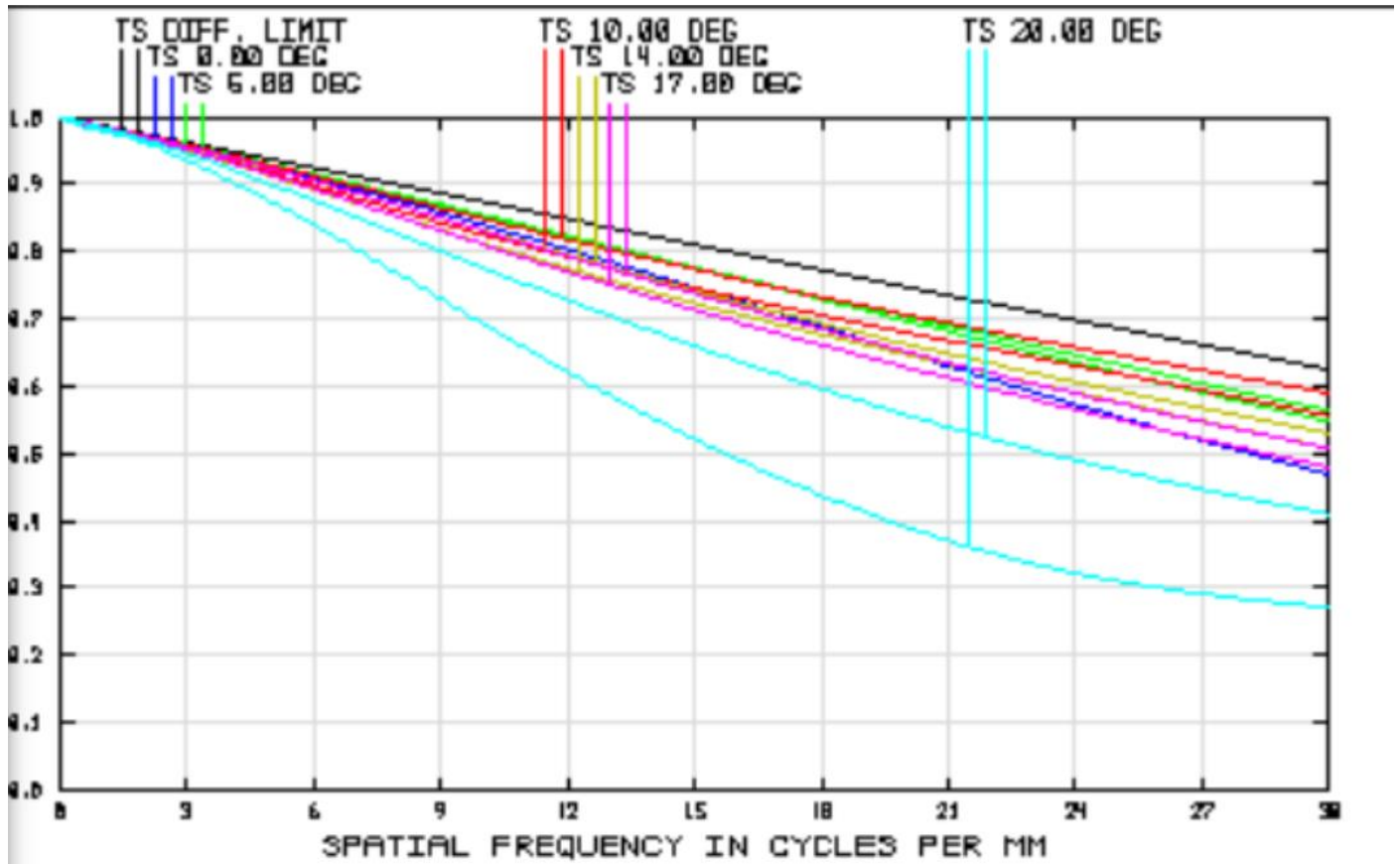

POLYCHROMATIC DIFFRACTION MTF

JUN 2 2022
FOR 8.0000 TO 12.0000 μ m,
FACE: IMAGE

MTF@+60°C 640x512 17 μ m

