

GLE26013D 260mm f/1.3 Motorized Infrared Lens

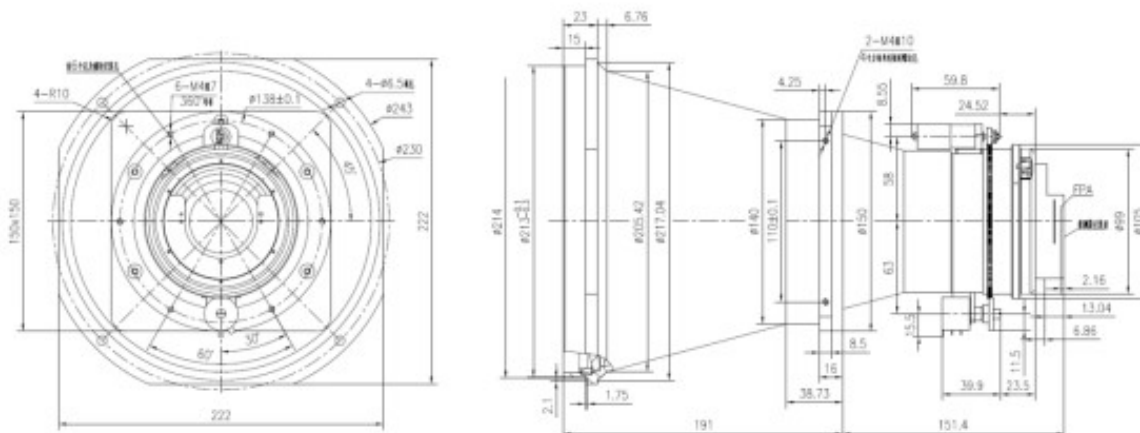

HFOV	160x120	320x240	336x256	384x288	640x480	640x512	1024x768	1280x1024
25μm	0.9°	1.8°	1.9°	2.1°	3.5°			
17μm	0.6°	1.2°	1.3°	1.4°	2.4°	2.4°	3.8°	
12μm	0.4°	0.8°	0.9°	1.0°	1.7°	1.7°	2.7°	3.4°

Optical

Focal Length	260mm
F/#	1.3
Wavelength	8-12μm
Focus Range	30m-Infinty
Format	Ø20

Mechanical

Focus Mechanism	Motorized
Dimensions (mm)	Ø342.4x 214
Weight	≤4.26kg

Electrical & Communications

Power Input	DC 12V
Communications	NA

Environmental

Operating Temperature	-40°C to +60°C
Storage Temperature	-50°C to +80°C
Front Element Sealing	IP67
External Coating	DLC