

Laura 100ml



Brimful Capacity **108 ± 2 ml**

Net Weight **220 ± 5 g**

Dimensions **Dia53 x H98.4 mm**

Neck Finish **FEA15**

Laura 100ml

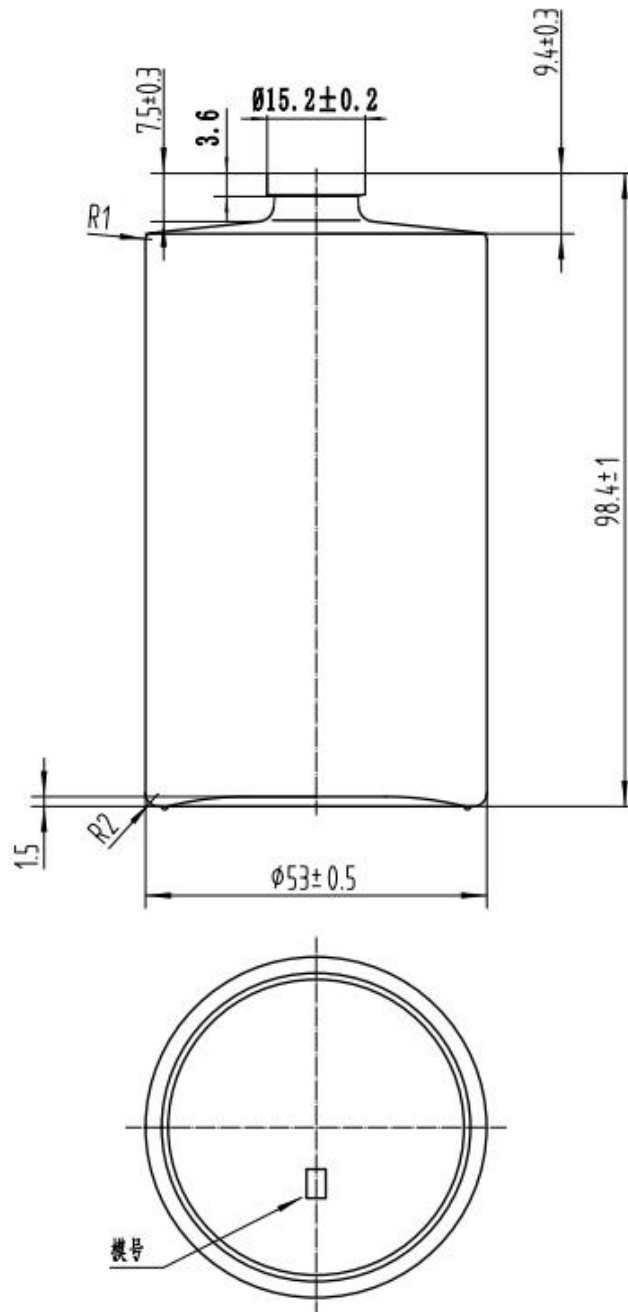

With integrated service of design, customization, wholesale, contract manufacturing, decoration, GP Bottles is providing bespoke perfume bottle packaging solutions for niche perfume brand.