

**T_{aper}
B_{ore} W/WH weld-on hubs**

This type of taper bore weld-on hubs adopt the Europe standards.

Taper Bore Weld-on Hubs are made of steel; drilled, tapped and taper bored to receive standard taper bushes. The extended flange provides a convenient means of welding hubs into fan rotors, steel pulleys, plate sprockets, impellers, agitators and many other devices which must be firmly fastened.

These are entirely suitable for severe operating conditions. Tightening the screws will contract the bores of the bush thereby locking it to the shaft with the equivalent of a press fit. This type of construction eliminates mounting difficulties. It also prevents loosening and wearing that may occur during operation.

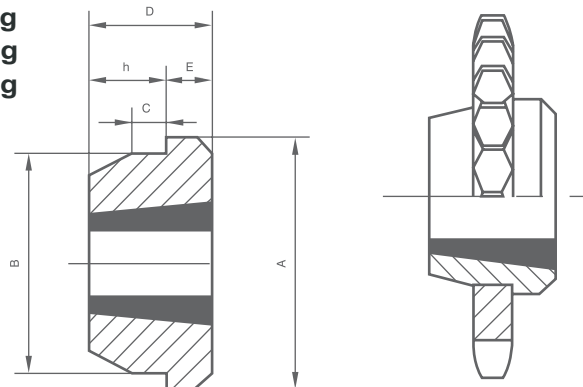
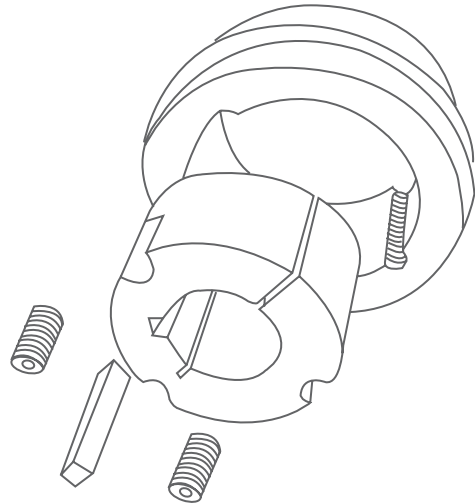

WH WELD-ON HUBS

Hub Rel	Bush No	A	B	C	D	E	h
WH1210	1210	73	60	10	25	9	16
WH1215	1215	76	60	11	38	16	22
WH1610	1610	83	70	10	25	9	16
WH1615	1615	83	70	11	38	16	22
WH2012	2012	96	90	12	32	10	22
WH2517	2517	127	110	13	45	19	26
WH3020	3020	152	130	18	51	24	27
WH3030	3030	152	130	19	76	25	51
WH3525	3525	184	155	25	65	25	40
WH3535	3535	184	155	25	89	32	57
WH4040	4040	225	195	35	102	32	70
WH4545	4545	254	220	40	114	38	76
WH5050	5050	276	242	40	127	38	89