

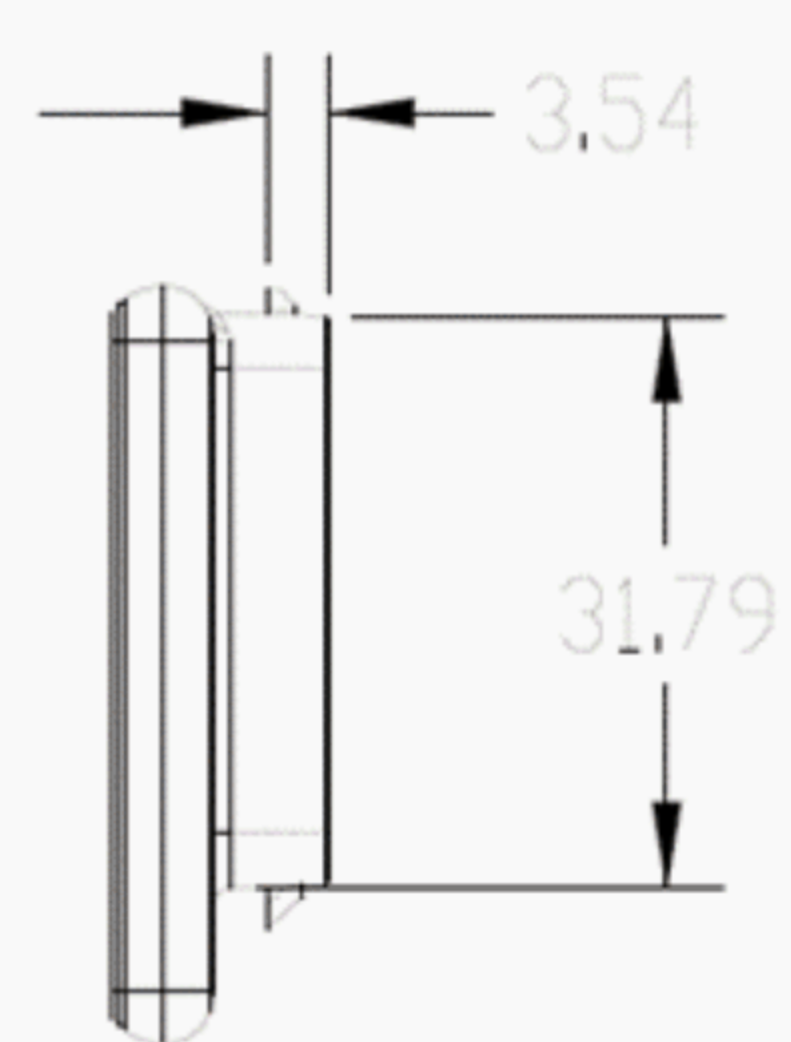

# 2.90" BWRY ESL

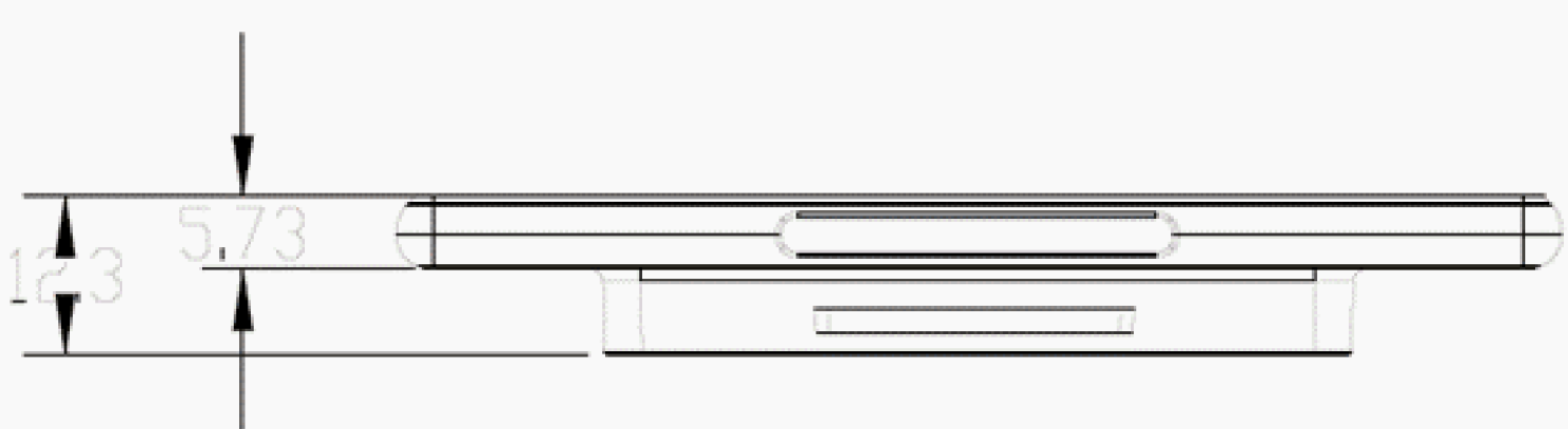

## TECHNICAL DRAWINGS

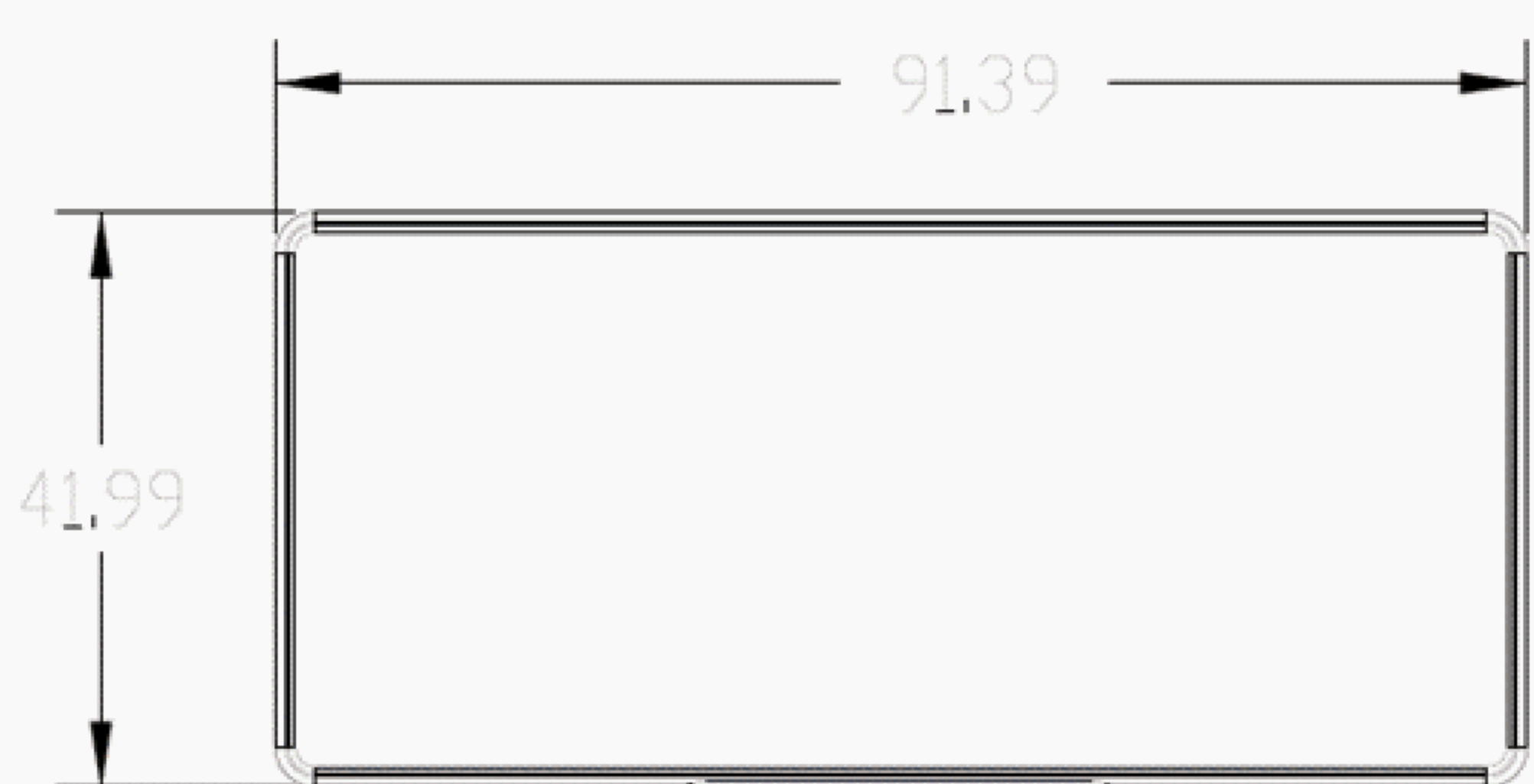

## TECHNICAL DETAILS

Model	SETRV3-0290-3E
Dimensions (mm)	91.39 x 41.99 x 12.3
Color	White
Weight	40g
Display technology	Full graphic E-ink display
Pixel color	Black / White / Red / Yellow
Active display area (mm)	66.9 x 29.06
Resolution (Pixel)	296 x 128
Pixel density	112 DPI
Viewing angle	>170°
Operating temperature	0°- 40°C
Storage temperature	0°- 40°C
Operating Humidity	45% - 70%RH
Protection Grade	IP65
Battery	2 x CR2450
Wireless connectivity	Private Protocol
ESL operating frequency	2.400-2.480 GHz, maximum EIRP ≤ 10mW
Communication mode	AP
Communication Distance	Within 30m (Open distance: 50m)
NFC	YES
Wireless firmware update	YES
Usable pages	8
LED	Red, Green and Blue, 7 colors can be displayed
Complicance	CE, RoHS
Package unit	300/Box, 13.0Kg, 390mm*350mm*240mm