

## **BIMETAL THERMOMETER H221C**

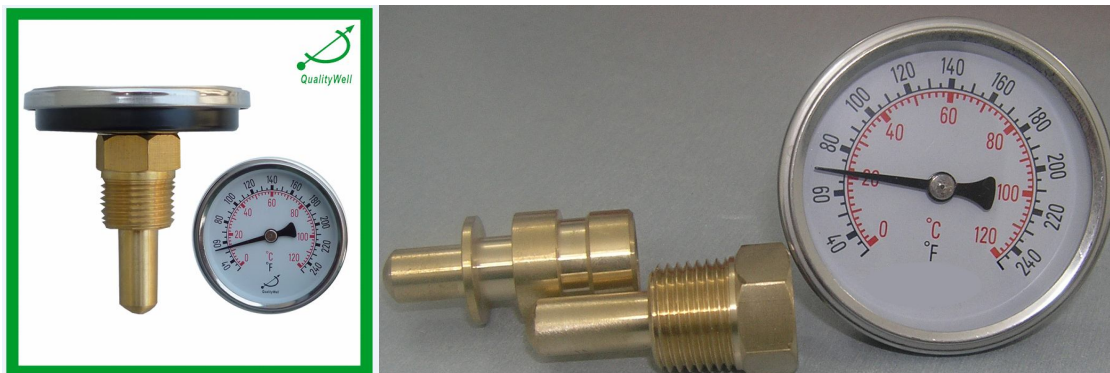

### **APPLICATIONS**

Hot water lines, boilers and hydronic heating

### **DESCRIPTION**

An economical and accurate way to measure air or water temperatures

Easy to install

2.5" dial, black steel case, SS304 crimped bezel, black pointer, PC lens, 9mm stem OD, with brass thermowell, Range 0-250F&0/120C

### **GENERAL SPECIFICATIONS**

**Case:** Black steel

**Dial:** aluminum with white matt finish, dish type. It offers accurate indication of °C and °F scales.

**External Reset:** None'

**Window:** Polycarbonate

**Stem:**brass

**Bimetal Element:** an extremely responsive temperature sensing element which has been carefully sized and tested in order to ensure continued accuracy.

**Thermowell:** 1/2"NPT/BSP male well or no thread Cop Well, separable

**Standards:** QualityWell manufactures bimetal thermometers in compliance with the ISO 9001:2008, RoHS and ASME B40.200-2008 standards.

**Accuracy:**  $\pm 1.5\%$

**1-Year Warranty:** the units are guaranteed to be free from defects in material and workmanship under normal use and service.



**STANDARD: EN 13190:2001; ASME B40.200-2008**



1/2"NPT male IPS well

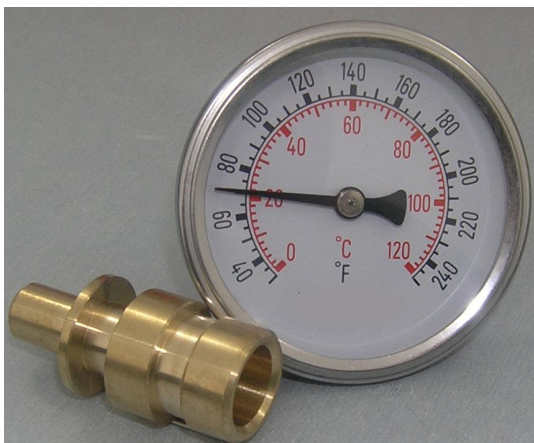

No thread Cop Well

### STANDARD FEATURES

<b>Measuring element:</b>	bi-metal coil
<b>Case:</b>	Black steel
<b>Bezel:</b>	SS304, sealed type
<b>Nominal Size:</b>	63mm
<b>Dial:</b>	aluminum, dish type, black lettering
<b>Pointer:</b>	aluminum, black
<b>Zero adjustment:</b>	None
<b>Window:</b>	Polycarbonate
<b>Stem:</b>	brass, diameter 9mm, plain,
<b>Connection:</b>	back conn.
<b>Accuracy:</b>	$\pm 1.5\%$
<b>Range:</b>	dual in $^{\circ}\text{C}/^{\circ}\text{F}$
<b>Thermowell:</b>	1/2"NPT male IPS well or no thread Cop Well, separable
<b>Temperature limits for storage and transport:</b>	-20 ... +60 $^{\circ}\text{C}$
<b>SCALE RANGES :</b>	0-250F&0/120C

### Drawing (Size:mm)

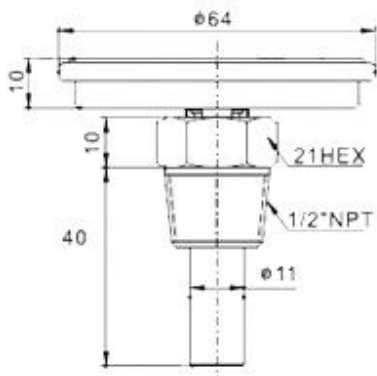

**STANDARD: EN 13190:2001; ASME B40.200-2008**