

PanelView Plus 7 Standard Terminals Mounting Levers

Catalog Number 2711P-RMCS

Topic	Page
Summary of Changes	1
Prepare for Panel Mounting	2
Mounting Lever Orientation and Lock Sequence	3
Mount the Terminal in a Panel	3
Apply the Static Discharge Warning Label	6
Additional Resources	6

Summary of Changes

This publication contains new and updated information as indicated in the following table.

Topic	Page
Added a Table of Contents and Summary of Changes.	1
Added instructions on how to apply the static discharge warning label.	6

Prepare for Panel Mounting

ATTENTION:

- Disconnect all electrical power from the panel before making the panel cutout.
- Make sure the area around the panel cutout is clear and that the panel is clean of any debris, oil, or other chemicals.
- Make sure that metal cuttings do not enter any components that are already installed in the panel and that the edges of the cutout have no burrs or sharp edges.
- Failure to follow these warnings can result in personal injury or damage to panel components.

IMPORTANT See the PanelView™ Plus 7 Standard Terminals User Manual, publication [2711P-UM007](#), for complete installation instructions.

Mounting levers insert into the slots around the bezel to secure the terminal in the panel. The number of mounting levers varies by terminal size. Each slot has six notches with alignment marks that are locking positions for a mounting lever. The thickness of the panel in which you mount the terminal determines the locking position that is required to maintain NEMA, UL Type, and IP seals.

Mounting Lever Lock Position

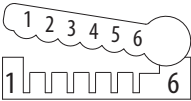
Mounting Slot	Mounting Lever Lock Position	Panel Thickness Range	Typical Gauge
	1	1.50...2.01 mm (0.060...0.079 in.)	16
	2	2.03...2.64 mm (0.080...0.104 in.)	14
	3	2.67...3.15 mm (0.105...0.124 in.)	12
	4	3.17...3.66 mm (0.125...0.144 in.)	10
	5	3.68...4.16 mm (0.145...0.164 in.)	8/9
	6	4.19...4.80 mm (0.165...0.188 in.)	7

Mounting Lever Orientation and Lock Sequence

IMPORTANT The mounting lever orientations that are shown are required to maintain NEMA, UL Type, and IP seals. If you require a NEMA, UL Type, or IP seal, do not use a mounting lever in a different orientation than shown.

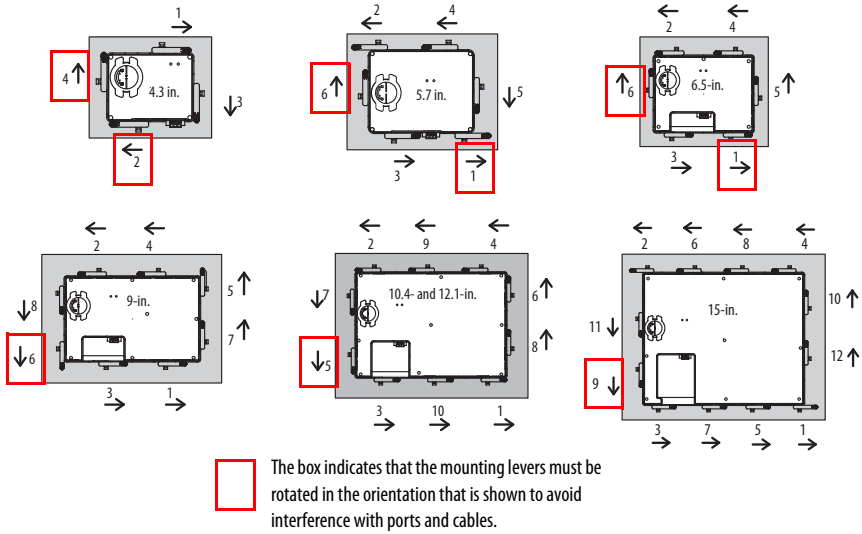

Mount the Terminal in a Panel

Follow these steps to mount the terminal in a panel cutout.

1. Use the cutout template that is shipped with your terminal to mark the cutout dimensions and cut the hole in the panel.
2. Verify the sealing gasket is present on the terminal.
This gasket forms a compression type seal. Do not use sealing compounds.
3. Center the terminal in the panel cutout.

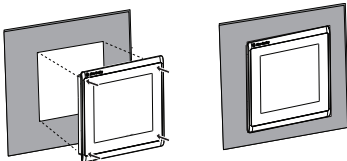

4. Secure the terminal in the panel.
 - a. Verify the orientation of the mounting levers.

The direction that you rotate each mounting lever is different for each terminal size. See [Mounting Lever Orientation and Lock Sequence on page 3](#).

IMPORTANT Use catalog number 2711P-RMCS mounting levers for PanelView Plus 7 standard terminals. Do not use these mounting levers with any other PanelView Plus terminals.

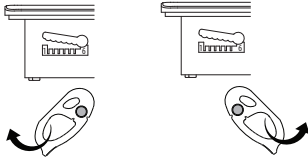

TIP The mounting levers for PanelView Plus 7 standard terminals are gray, similar to the color of the bezel. Do not use black mounting levers; they are not compatible with PanelView Plus 7 standard terminals.

- b. Hold the first mounting lever in the locking sequence vertical to the slot and insert its knob into the large end of the slot.

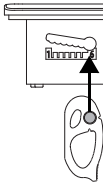

- c. Slide the mounting lever to a notch that is one or two positions greater than the final locking position for your panel thickness.

If the final locking position is 1, slide the mounting lever to position 2 or 3.

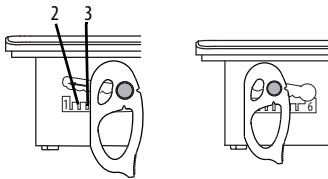

TIP Use an erasable marker or grease pencil to mark the alignment marks for visibility of the slot positions and to mark the final lock position.

- d. Rotate the mounting lever until its flat side comes in contact with the panel.

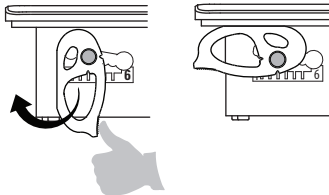

TIP The mounting levers are designed to break off the pin if they are over torqued. This helps to prevent damage to the bezel. If a pin is broken, turn the mounting lever around and use the other pin to continue the installation. See [Mounting Lever Orientation and Lock Sequence on page 3](#) for restrictions.

- e. Repeat steps [a](#) through [d](#) for the remaining mounting levers.

5. Adjust each mounting lever to its final position by using the locking sequence in [Mounting Lever Orientation and Lock Sequence on page 3](#).
 - a. Unlock mounting lever one in the sequence by rotating it away from the bezel.
 - b. With the mounting lever positioned vertically to the slot, slide the mounting lever to its final locking position as determined by [Mounting Lever Lock Position on page 2](#).
 - c. Carefully rotate the mounting lever back toward panel.
 - d. Repeat steps [a](#) through [c](#) to lock the remaining mounting levers in the final position.
6. Inspect all mounting levers to make sure each lever is in the correct locked position.

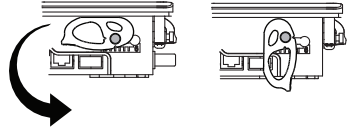

IMPORTANT All mounting levers must be in the correct and same locked position to provide an adequate gasket seal between the terminal and the panel. Rockwell Automation assumes no responsibility for water or chemical damage to the terminal or other equipment within the enclosure because of improper installation.

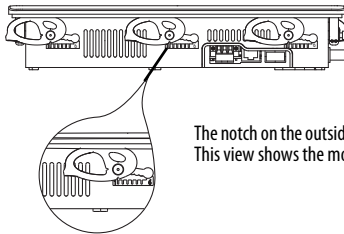

The notch on the outside of mounting lever shows its locked position. This view shows the mounting levers locked in position 1.

Apply the Static Discharge Warning Label

IMPORTANT Rockwell Automation recommends applying the static discharge warning label for all hazardous location applications according to the instructions below. If the intended application requires ATEX or IECEx certification, the static discharge warning label **MUST** be applied according to the instructions below.

A static discharge warning label is included in the box with the PanelView Plus 7 Standard terminal. If required for your installation, this label must be affixed to the panel in a location that is visible to the operator.



Follow these steps to apply the static discharge warning label.

1. Identify a location for the static discharge warning label that is visible to the operator during operation.
2. Clean the desired install location with isopropyl alcohol.
3. Remove the backing from the static discharge warning label and apply the label to the desired location.
4. Verify that operator visibility to the static discharge warning label is not obstructed at any time during operation.

Additional Resources

These documents contain additional information concerning related products from Rockwell Automation.

Resource	Description
PanelView Plus 7 Standard Terminals User Manual, publication 2711P-UM007	Provides details on how to install, configure, and operate the PanelView Plus 7 standard terminals.

You can view or download publications at <http://www.rockwellautomation.com/literature/>. To order paper copies of technical documentation, contact your local Allen-Bradley distributor or Rockwell Automation sales representative.

Notes:

Rockwell Automation maintains current product environmental information on its website at

<http://www.rockwellautomation.com/rockwellautomation/about-us/sustainability-ethics/product-environmental-compliance.page>.

Allen-Bradley, PanelView, Rockwell Automation, and Rockwell Software are trademarks of Rockwell Automation, Inc.
Trademarks not belonging to Rockwell Automation are property of their respective companies.



PN-573164

Rockwell Otomasyon Ticaret A.Ş., Kar Plaza İş Merkezi E Blok Kat:6 34752 İçerenköy, İstanbul, Tel: +90 (216) 5698400

www.rockwellautomation.com

Power, Control and Information Solutions Headquarters

Americas: Rockwell Automation, 1201 South Second Street, Milwaukee, WI 53204-2496 USA, Tel: (1) 414.382.2000, Fax: (1) 414.382.4444
Europe/Middle East/Africa: Rockwell Automation NV, Pegasus Park, De Kleetlaan 12a, 1831 Diegem, Belgium, Tel: (32) 2 663 0600, Fax: (32) 2 663 0640
Asia Pacific: Rockwell Automation, Level 14, Core F, Cyberport 3, 100 Cyberport Road, Hong Kong, Tel: (852) 2887 4788, Fax: (852) 2508 1846

Publication 2711P-IN032B-EN-P - February 2020

Supersedes publication 2711P-IN032A-EN-P - July 2014

Copyright © 2020 Rockwell Automation, Inc. All rights reserved. Printed in Japan.