

Front View

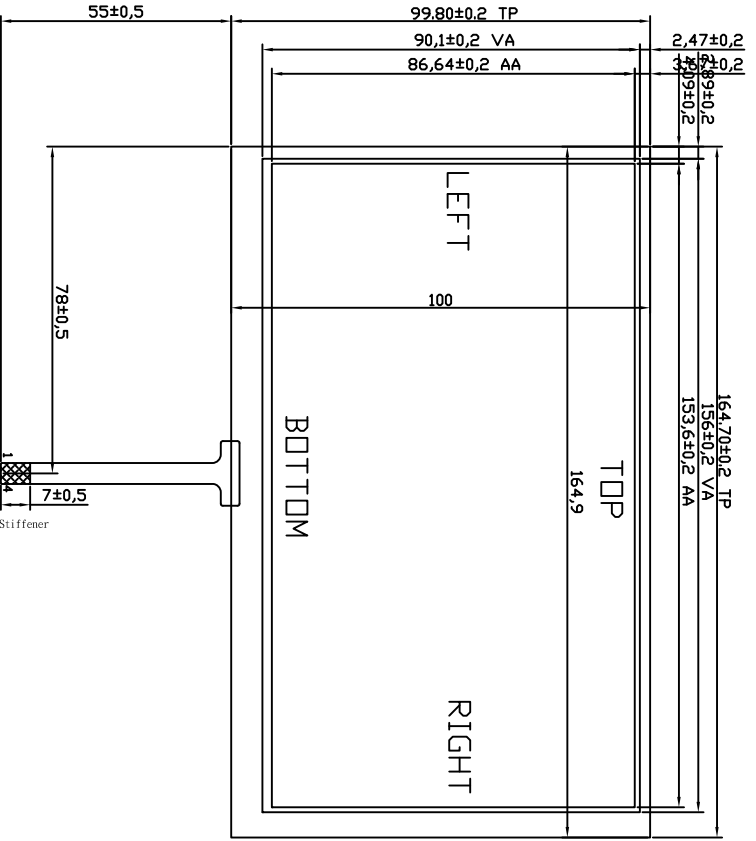

Back View

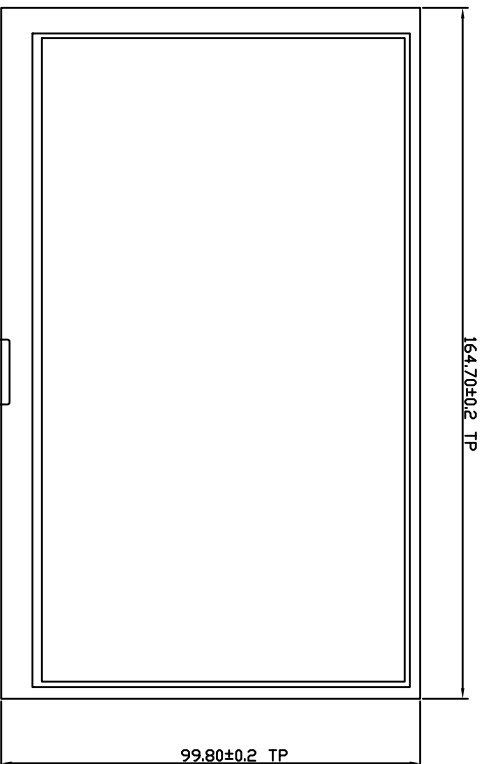

Front View

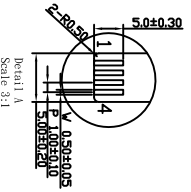
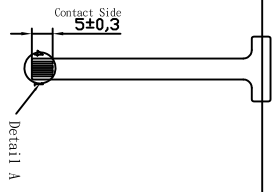
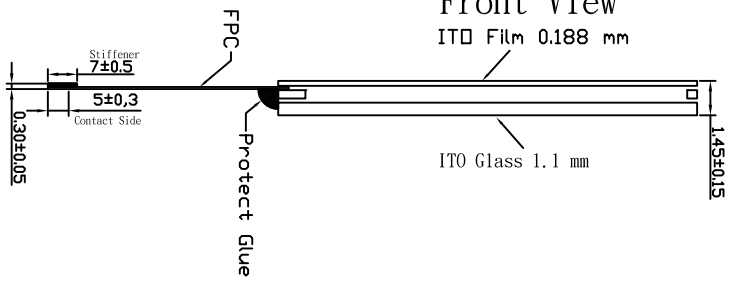

PIN #	ASSIGNMENT
PIN 1	Left
PIN 2	TOP
PIN 3	Right
PIN 4	Bottom

- Notes:
- 1.Type : Film/Glass/FPC tail
 - 2.Rated Voltage: 5V 1mA
 - 3.Insulation Resistance: >20MΩ(DC 25V)
 - 4.Linearity:<1.5%
 - 5.Operation Force: 30~150g
 - 6.Transparency:>85%
 - 7.Hitting Durability:>1000K
 - 8.Chattering:<15ms
 - 9.Operation Temperature: -20~70℃
 - 10.Storage Temperature: -30~80℃(ITD Film)

Like KA Type ITD Film>35~85%

REV./DATE	REVISED DESCRIPTIONS	DIMENSION UNIT	mm	MODEL NO.	GP-070F-4M-NA05A	CUSTOMER APPROVED	NOTE
1	DRAWN	STEVE	ISSUE DATE	2013/03/11	SCALE	-/-	
2	CHECK	MIKE	CUSTOMER ID	GTOUCH			
3	APPROVED	SCOTT					



坤巨資訊股份有限公司
Groovy Technology Corp.