

DomiOP eBIS510

The DomiOP eBIS Series 500 HMI products combine state-of-the-art features and top performance with an outstanding design. They are the ideal choice for all demanding HMI applications including factory and building automation.

The eBIS510 features a bright 10"4 TFT display with a fully dimmable LED backlight.

The JMobile software offers full vector graphic capabilities and plenty of connectivity options.



- 10"4 SVGA TFT color display, LED backlight
- 800x600 pixel (SVGA) resolution, 64K colors
- Resistive touchscreen
- 2 Ethernet ports with switch function
- 2 USB Host ports
- SD Card Slot
- Connection to fieldbus systems and I/O using optional plug-in modules
- Slim design. Mounting depth less than 50mm

Highlights

The eBIS Series 500 HMI panels have been designed to run the JMobile software.

- JMobile runtime included. Full compatibility with JMobile Studio.
- Full vector graphic support. Native support of SVG graphic objects. Transparency and alpha blending.
- Full object dynamics: control visibility and transparency, move, resize, rotate any object on screen. Change properties of basic and complex objects.
- TrueType fonts
- Multilanguage applications. Easily create and manage your applications in multiple languages to meet global requirements. Far East languages are supported. Tools available in JMobile Studio support easy third-party translations and help reducing development and maintenance costs of the application
- Data display in numerical, text, bargraph, analog gauges and graphic image formats.
- Rich set of state-of-the-art HMI features: data acquisition, alarm handling, scheduler and timed actions (daily and weekly schedulers, exception dates), recipes, users and passwords, eRSS feeds, rotating menus
- Includes support for a wide range of communication drivers for Factory and Building Automation systems.
- Multiple drivers communication capability.
- Remote monitoring and control. Client-Server functionality. Mobile clients supported.
- Remote maintenance and support with VNC-based functionality.
- Off-line simulation of the HMI application with JMobile Studio.
- Powerful scripting language for automating HMI applications. Script debugging improves efficiency in application development.
- Rich gallery of symbols and objects
- Project templates
- Optional plug-in modules for fieldbus systems, I/O and controllers.
- Display backlight dimmable 0%



Technical Data

Display Type Resolution Active display area Colors Backlight Brightness Dimming		TFT 800x600, SVGA 10"4 diagonal 64K LED 300 Cd/m ² typ. Yes	Alarms Historical event list Users and passwords Hardware Real Time Clock Screen saver Buzzer	Yes Yes Yes Yes, with battery back-up Yes Yes, audible feedback for touchscreen
System Resources Operating System User memory RAM		Microsoft Windows CE 6.0 256 MB Flash 256MB DDR	Ratings Power supply voltage Current consumption Fuse Weight Battery	24 Vdc (18 to 30 Vdc) 1A at 24Vdc(max.) Automatic Approx 2.1 Kg Rechargeable Lithium battery, not user-replaceable
Operator Interface Touchscreen LED indicators		Analog resistive 1 (dual color)	Environmental Conditions Operating temperature Storage temperature Operating and storage humidity Protection class	5 to 40 °C (vertical installation) -20 to +70 °C 5 – 85 % relative humidity, non-condensing IP20
Interface Ethernet USB Serial Expansion Slot Memory Card		2 10/100 Mbit with integrated Switch 2 Host Interface (1 version 2.0, 1 version 2.0 and 1.1) RS-232, RS-485, RS-422, software configurable 2 Optional plug-in SD Card Slot	Dimensions Faceplate LxH Cutout AxH Depth D+T	287x232 mm (11.3x9.13") 276x221 mm (10.86x8.70") 56+4 mm (2.20+0.16")
Functionality Vector graphics Object dynamics TrueType fonts Multiple driver communication Data acquisition and trend presentation Multilanguage Recipes		Yes, includes SVG support Yes. Visibility, opacity, position, size, rotation for most object types. Yes Yes, max 2 drivers Yes. Flash memory storage limited only by available memory Yes, with runtime language switching. Yes. Flash memory storage limited only by available memory	Approvals CE	EN 50090-2-2 + EN 50090-2- 2/A1+EN 50090-2-2/A2 Immunity EN 61000-6-1, Emission EN 61000-6-3 for installation in residential environments

Dimensions

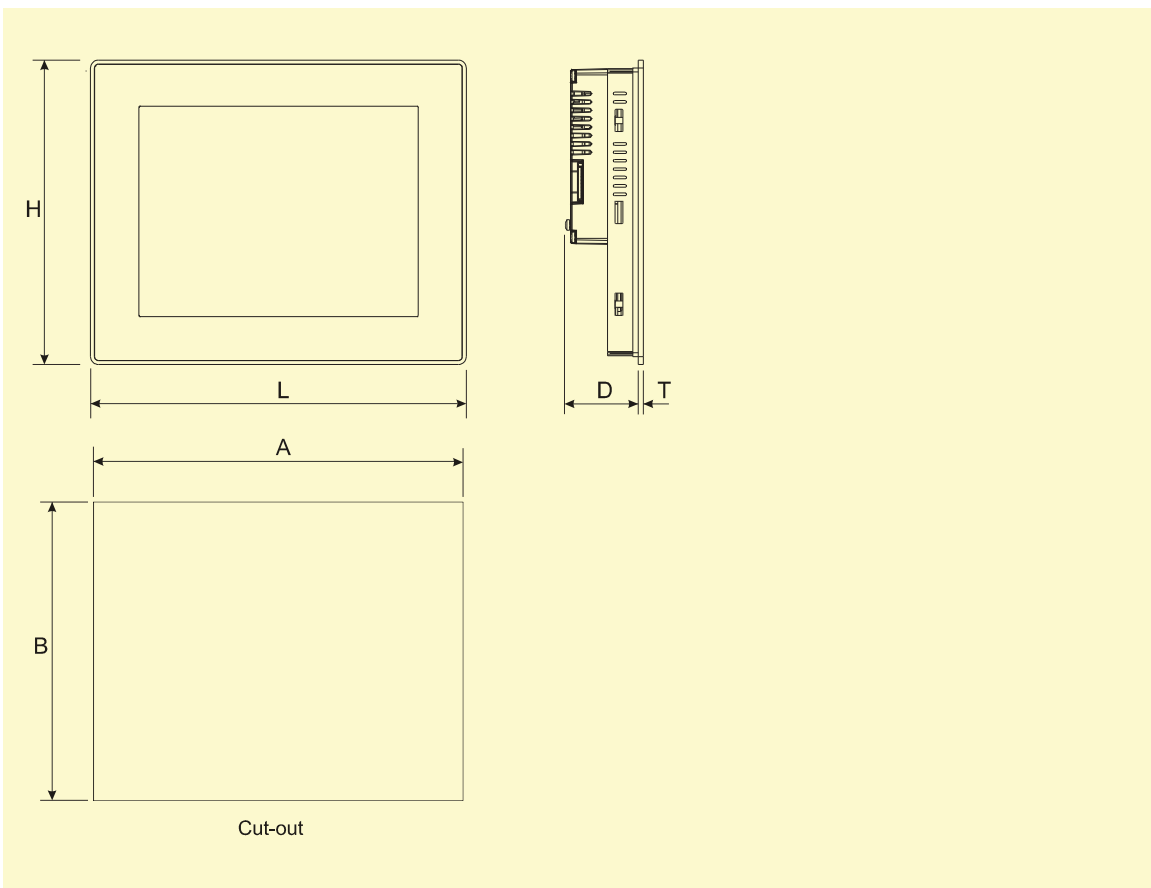

Connections

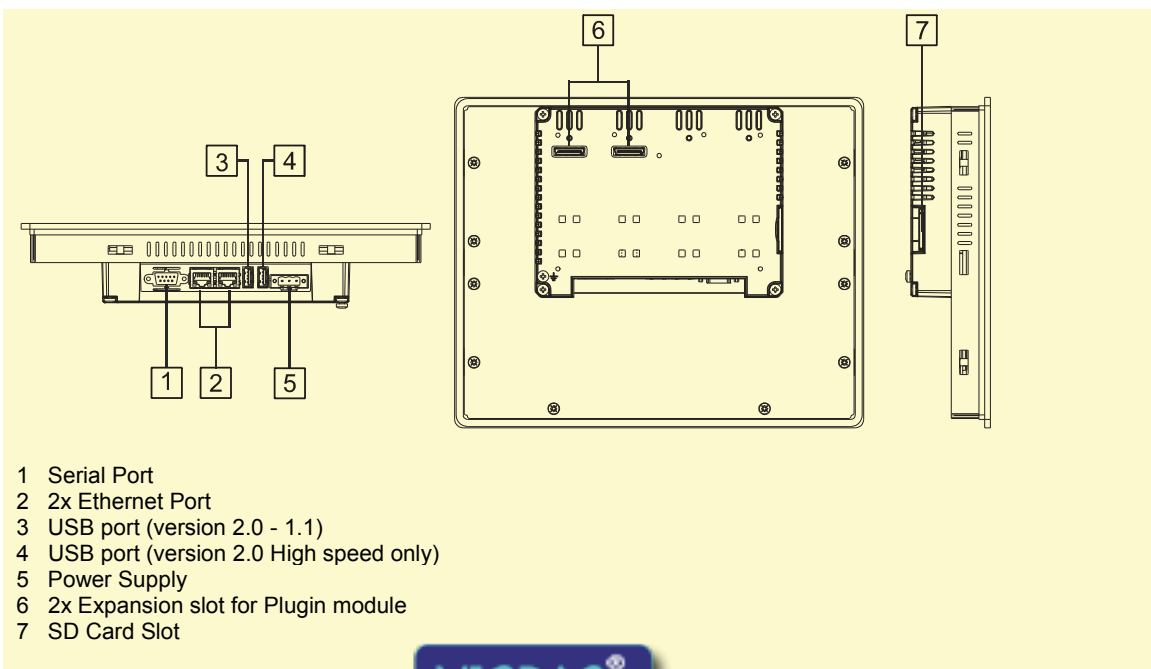

Mounting into Wall-mount Box (sequence)

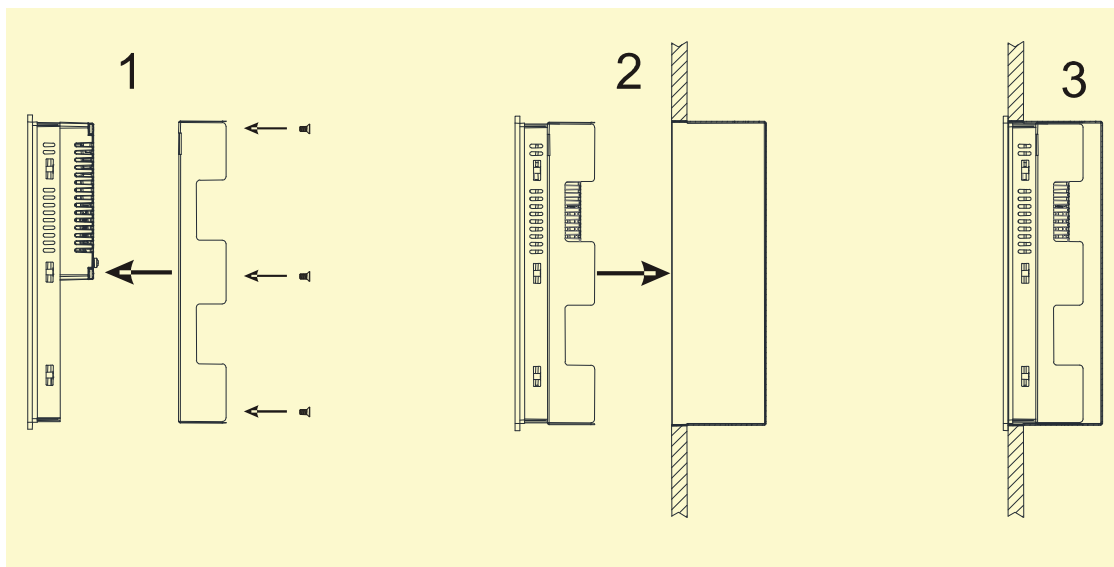

Ordering Information

Model	Part Number	Description
eBIS510-White	+EBIS510U101	10"4 TFT color touchscreen with Ethernet and USB interfaces. JMobile run-time. White front panel.
eBIS510-Silver	+EBIS510U201	10"4 TFT color touchscreen with Ethernet and USB interfaces. JMobile run-time. Silver front panel.
eBIS510-Black	+EBIS510U301	10"4 TFT color touchscreen with Ethernet and USB interfaces. JMobile run-time. Black front panel.
BOX510-01	R-BOX12	Wall-mount box (279,2 x 224,2 x 80) for eBIS510

ptn0388

Ver. 1.3

Copyright © 2012-2014 Exor International S.p.A. – Verona, Italy

Subject to change without notice

The information contained in this document is provided for informational purposes only. While efforts were made to verify the accuracy of the information contained in this documentation, it is provided "as is" without warranty of any kind.

www.uniop.com

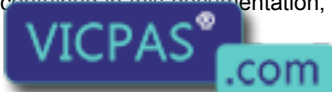

Everything for your HMI running

✉ sales@vicpas.com

☎ +86-15876525394