



High Performance Cutting

# HD200/300MAX

High Definition oxygen gas Plasma cutting system with Extra Productivity



Better Quality | Higher Cutting Speed | Long Lifetime | Low Costs

## Maximized Productivity

- HD200/300MAX provides faster cutting speed to maximize productivity.
- Engineered with 100% duty cycle for the most demanding production environments.

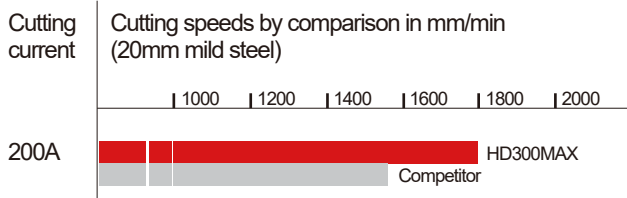

## Long-life Consumables

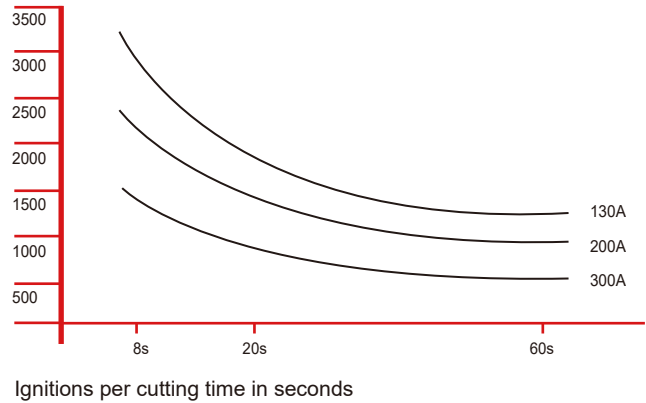

## Efficient Gas Supply

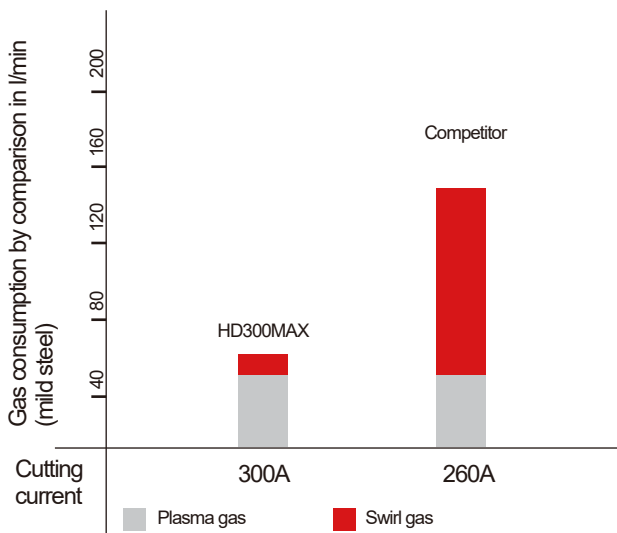

## Superior Cutting Performance



Optimized gas parameters are set and controlled by the software. With air or oxygen plasma gas, the HD200/300MAX plasma cutting system achieves impressive cut speeds, consistent cut quality and exceptional consumable life.

## Specifications

System	HD200MAX	HD300MAX
Input Voltages	380VAC, 3PH, 50Hz/60Hz 400VAC, 3PH, 50Hz/60Hz	380VAC, 3PH, 50Hz/60Hz 400VAC, 3PH, 50Hz/60Hz
Max. Load Power Capacity	50KVA	75KVA
Rated output voltage	50~200VDC	50~200VDC
Max output current	200A	300A
Open circuit voltage (OCV)	430VDC	430VDC
Duty cycle rating	100% @ 200A, at 40°C (104°F)	100% @ 300A, at 40°C (104°F)
Operating temperature	-10 °C~40°C	-10 °C~40°C
Torch	TP300MAX, 1.5m	TP300MAX, 1.5m
Dimensions	960*420*1100	1300*800*580mm
Weight	165KG	256KG
Certifications	CE,ROHS	CE,ROHS
Gas supply		
Plasma gas	Air/O <sub>2</sub>	Air/O <sub>2</sub>
Shield gas	Air, Water-spray	Air, Water-spray
Supply gas pressure	6.2±0.7Bar	6.2±0.7Bar

# Cutting Capacity

	HA200MAX	HA300MAX
<b>Mild steel cut capacity</b>	<b>Thickness</b>	<b>Thickness</b>
<b>Dross free*</b>	25mm	35mm
<b>Production pierce</b>	32mm	40mm
<b>Maximum cutting capacity</b>	60mm	80mm
<b>Stainless steel cut capacity</b>	<b>Thickness</b>	<b>Thickness</b>
<b>Production pierce</b>	25mm	32mm
<b>Maximum cutting capacity</b>	54mm	75mm
<b>Aluminum cut capacity</b>	<b>Thickness</b>	<b>Thickness</b>
<b>Production pierce</b>	25mm	32mm
<b>Maximum cutting capacity</b>	54mm	75mm

\* Feature and material type can influence dross free performance.

## Operating data (Mild steel)

Cutting current (A)	Cutting voltage (V)	Material thickness (mm)	Cutting speed (mm/min)	Nozzle
130	130	6	3400	TP110213
	132	8	2500	
	134	10	2400	
	136	12	2000	
	139	15	1500	
	145	20	1100	

Cutting current (A)	Cutting voltage (V)	Material thickness (mm)	Cutting speed (mm/min)	Nozzle
200	126	12	3200	TP110217
	127	15	2800	
	129	20	1800	
	137	25	1500	
	143	30	900	

Cutting current (A)	Cutting voltage (V)	Material thickness (mm)	Cutting speed (mm/min)	Nozzle
300	118	6	7000	TP110227
	120	8	5600	
	121	10	4700	
	121	12	4000	
	125	15	3200	
	124	20	2100	
	132	25	1600	

Cutting current (A)	Cutting voltage (V)	Material thickness (mm)	Cutting speed (mm/min)	Nozzle
300	135	30	1200	TP110227
	138	35	900	
	142	40	720	

## TP300MAX torch and consumables

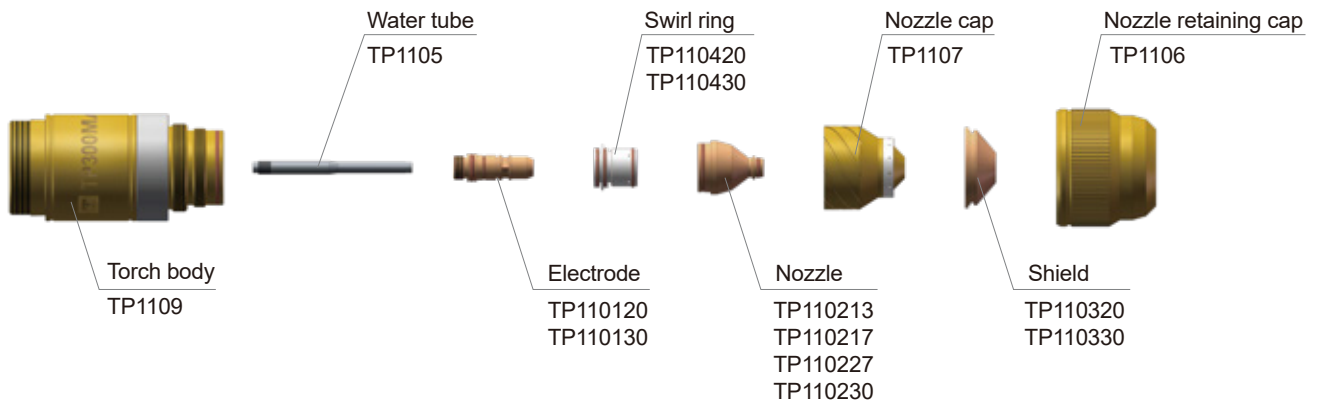

High Performance Cutting

### Web & Mail

www.cn-topwell.com  
sales@topwellwelders.com

### Phone

(+86)571-88231791  
(+86)571-88231792