



## Product catalogue



### EURO TORCHES

|               |     |
|---------------|-----|
| MIG MINI 15   | 005 |
| MIG 15        | 006 |
| MIG 24        | 007 |
| MIG 25        | 008 |
| MIG 26        | 009 |
| MIG 36        | 010 |
| MIG 40        | 011 |
| MIG 240       | 012 |
| MIG 401D/501D | 013 |



### TW TORCHES

|        |     |
|--------|-----|
| TW 200 | 019 |
| TW 400 | 020 |



### SUPER MAXI TORCHES

|              |     |
|--------------|-----|
| MIG MAXI 150 | 021 |
| MIG MAXI 250 | 022 |
| MIG MAXI 350 | 023 |
| MIG MAXI 450 | 024 |



### PAN TORCHES

|          |     |
|----------|-----|
| MIG P180 | 014 |
| MIG P350 | 015 |
| MIG P500 | 016 |



### BND TORCHES

|             |     |
|-------------|-----|
| BND 300/350 | 017 |
| BND 400     | 018 |

### EURO TORCHES

|                           |     |
|---------------------------|-----|
| CONTACT TIPS              | 025 |
| NOZZLES                   | 027 |
| TW TYPE NOZZLES           | 029 |
| DIFFUSERS AND TIP HOLDERS | 031 |
| LINERS                    | 033 |
| COMPLETE CABLES           | 036 |
| CENTRAL ADAPTORS          | 037 |

# MIG MINI 15

Rating: Water Cooled, 400Amp Co., 300Amp MIX. wires: 0.8-1.6mm.

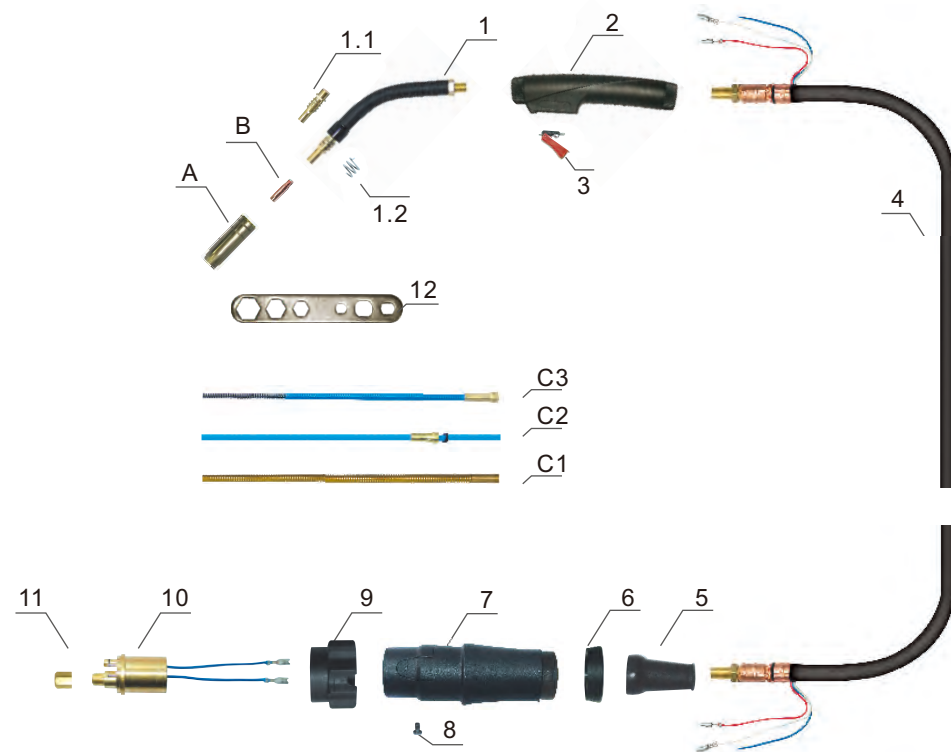

### Model

| Description                                 | Part Number |         |         |
|---|-------------|---------|---------|
| MIG MINI 15 torch Euro adaptor spring pings | 3m          | 4m      | 5m      |
|   | ICT2050     | ICT2056 | ICT2057 |

### Nozzles

| No. | Part Number | Description                         |
|-----|-------------|-------------------------------------|
| A   | ICS0062     | Gas nozzle $\Phi$ 9.5mm             |
|     | ICS0063     | Gas nozzle $\Phi$ 12mm              |
|     | ICS0064     | Gas nozzle $\Phi$ 16mm              |
|     | ICS0070     | Spot welding gas nozzle $\Phi$ 16mm |
|     | ICS0711     | Tapered gas nozzle $\Phi$ 13mm      |

### Contact Tips

| No. | Part Number | Description                           |
|-----|-------------|---------------------------------------|
| B   | ICU0003-06  | Contact tip $\Phi$ 0.6mm M6x25 Ecu    |
|     | ICU0003-08  | Contact tip $\Phi$ 0.8mm M6x25 Ecu    |
|     | ICU0003-09  | Contact tip $\Phi$ 0.9mm M6x25 Ecu    |
|     | ICU0003-10  | Contact tip $\Phi$ 1.0mm M6x25 Ecu    |
|     | ICU0003-58  | Contact tip $\Phi$ 0.8mm M6x25 CuAl   |
|     | ICU0003-59  | Contact tip $\Phi$ 0.9mm M6x25 CuAl   |
|     | ICU0003-60  | Contact tip $\Phi$ 1.0mm M6x25 CuAl   |
|     | ICU0003-62  | Contact tip $\Phi$ 1.2mm M6x25 CuAl   |
|     | ICU0003-76  | Contact tip $\Phi$ 0.6mm M6x25 CuCrZr |
|     | ICU0003-78  | Contact tip $\Phi$ 0.8mm M6x25 CuCrZr |
|     | ICU0003-80  | Contact tip $\Phi$ 1.0mm M6x25 CuCrZr |
|     | ICU0003-82  | Contact tip $\Phi$ 1.2mm M6x25 CuCrZr |

### Liners

| No. | Part Number | Description                           |
|-----|-------------|---------------------------------------|
| C   | IIC0220     | Brass terminal $\Phi$ 2.0x4.0mm 0.35m |
|     | IIC0100     | Teflon liner $\Phi$ 4.0x1.5mm 3m Blue |
|     | IIC0500     | Blue liner $\Phi$ 0.6-0.8mm 3m        |

### Components

| No. | Part Number | Description                           |
|-----|-------------|---------------------------------------|
| 1   | ICZ0087     | Torch head 15 with fitting            |
| 1.1 | IZH0662     | Gas diffuser 15AK                     |
| 1.2 | IFT0808     | Spring 15AK                           |
| 2   | ICV6050     | MIG Mini handle black                 |
| 3   | IHQ0070     | Trigger                               |
| 4   | ICN6760     | Coaxial cable 3m                      |
| 5   | IHJ0028     | Rear Joint for 15AK                   |
| 6   | IHJ0715     | Handle closing ring                   |
| 7   | IHJ0703     | Back box                              |
| 8   | IFT0063     | Screw M4x6                            |
| 9   | IHJ0063     | Adaptor nut                           |
| 10  | ITB0059     | Euro central adaptor body/air cooling |
| 11  | IZT0071     | Liner nut                             |
| 12  | ICG6000     | Spanner for MIG torches               |

# MIG 15

Rating: Water Cooled, 400Amp Co., 300Amp MIX. wires: 0.8-1.6mm.

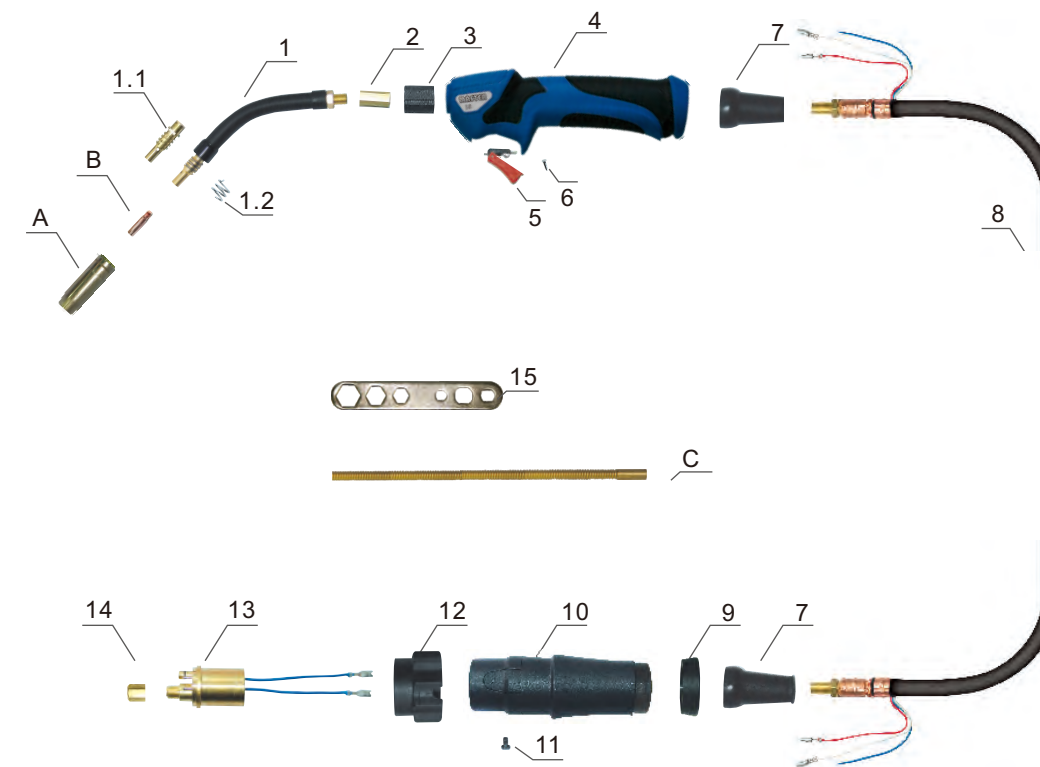
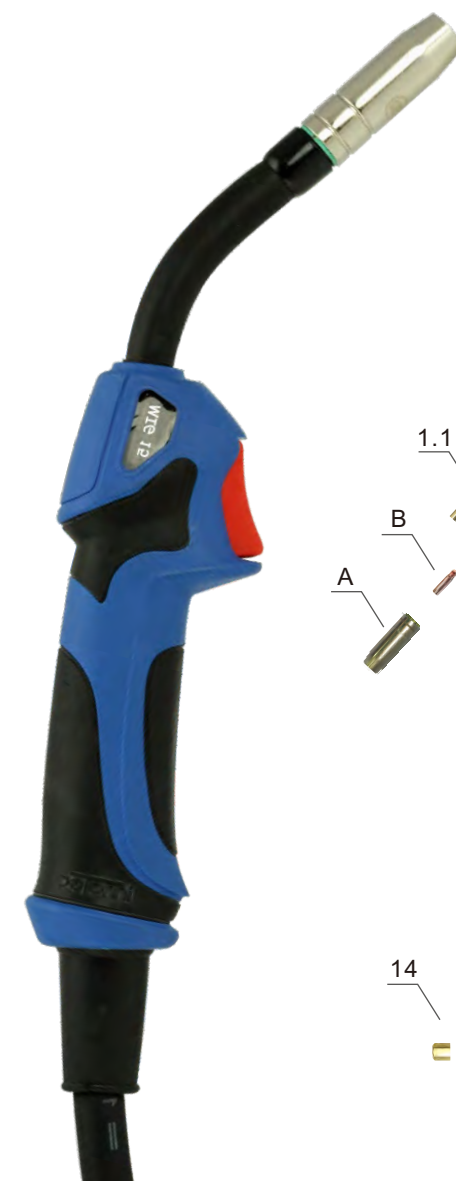

### Model

| Description                              | Part Number |            |            |
|--|-------------|------------|------------|
| MIG 15AK torch Euro adaptor spring pings | 3m          | 4m         | 5m         |
|  | ICT2098-36  | ICT2099-36 | ICT2095-36 |

### Nozzles

| No. | Part Number | Description                         |
|-----|-------------|-------------------------------------|
| A   | ICS0062     | Gas nozzle $\Phi$ 9.5mm             |
|     | ICS0063     | Gas nozzle $\Phi$ 12mm              |
|     | ICS0064     | Gas nozzle $\Phi$ 16mm              |
|     | ICS0070     | Spot welding gas nozzle $\Phi$ 16mm |
|     | ICS0711     | Tapered gas nozzle $\Phi$ 13mm      |

### Contact Tips

| No. | Part Number | Description                           |
|-----|-------------|---------------------------------------|
| B   | ICU0003-06  | Contact tip $\Phi$ 0.6mm M6x25 Ecu    |
|     | ICU0003-08  | Contact tip $\Phi$ 0.8mm M6x25 Ecu    |
|     | ICU0003-09  | Contact tip $\Phi$ 0.9mm M6x25 Ecu    |
|     | ICU0003-10  | Contact tip $\Phi$ 1.0mm M6x25 Ecu    |
|     | ICU0003-58  | Contact tip $\Phi$ 0.8mm M6x25 CuAl   |
|     | ICU0003-59  | Contact tip $\Phi$ 0.9mm M6x25 CuAl   |
|     | ICU0003-60  | Contact tip $\Phi$ 1.0mm M6x25 CuAl   |
|     | ICU0003-62  | Contact tip $\Phi$ 1.2mm M6x25 CuAl   |
|     | ICU0003-76  | Contact tip $\Phi$ 0.6mm M6x25 CuCrZr |
|     | ICU0003-78  | Contact tip $\Phi$ 0.8mm M6x25 CuCrZr |
|     | ICU0003-80  | Contact tip $\Phi$ 1.0mm M6x25 CuCrZr |
|     | ICU0003-82  | Contact tip $\Phi$ 1.2mm M6x25 CuCrZr |

### Liners

| No. | Part Number | Description                           |
|-----|-------------|---------------------------------------|
| C   | IIC0220     | Brass terminal $\Phi$ 2.0x4.0mm 0.35m |
|     | IIC0100     | Teflon liner $\Phi$ 4.0x1.5mm 3m Blue |
|     | IIC0500     | Blue liner $\Phi$ 0.6-0.8mm 3m        |

### Components

| No. | Part Number | Description                           |
|-----|-------------|---------------------------------------|
| 1   | ICZ0087     | Torch head 15 with fitting            |
| 1.1 | IZH0662     | Gas diffuser 15AK                     |
| 1.2 | IFT0808     | Spring 15AK                           |
| 2   | IZH0667     | Hexagonal fitting                     |
| 3   | IHJ0030-01  | Plastic Body                          |
| 4   | ICV0890     | MIG handle Blue/Grip                  |
| 5   | IHQ0070     | Trigger                               |
| 6   | IFT0874     | Screw M3x10                           |
| 7   | IHJ0782     | Joint for 15                          |
| 8   | ICN0663     | Coaxial cable 3m                      |
| 9   | IHJ0715     | Housing for handle                    |
| 10  | IHJ0703     | Back box                              |
| 11  | IFT0063     | Screw M4x6                            |
| 12  | IHJ0063     | Adaptor nut                           |
| 13  | ITB0059     | Euro central adaptor body/air cooling |
| 14  | IZT0071     | Liner nut                             |
| 15  | ICG6000     | Spanner for MIG torches               |

# MIG 24



Rating: Gas Cooled, 250Amp Co., 220Amp MIX. wires: 0.8-1.2mm.



# MIG 25



Rating: Gas Cooled, 230Amp Co., 200Amp MIX. wires: 0.8-1.2mm.



### Model

| Description                              | Part Number |            |            |
|--|-------------|------------|------------|
| MIG 24KD torch Euro adaptor spring pings | 3m          | 4m         | 5m         |
|  | ICT2698-36  | ICT2699-36 | ICT2695-36 |

### Nozzles

| No. | Part Number | Description              |
|-----|-------------|--------------------------|
| A   | ICS0800     | Gas nozzle $\Phi$ 17mm   |
|     | ICS0806     | Gas nozzle $\Phi$ 12.5mm |
|     | ICS0807     | Gas nozzle $\Phi$ 10mm   |
|     | ICS0808     | Spot welding gas nozzle  |

### Contact Tips

| No. | Part Number | Description                           |
|-----|-------------|---------------------------------------|
| B   | ICU0003-06  | Contact tip $\Phi$ 0.6mm M6x25 Ecu    |
|     | ICU0003-08  | Contact tip $\Phi$ 0.8mm M6x25 Ecu    |
|     | ICU0003-09  | Contact tip $\Phi$ 0.9mm M6x25 Ecu    |
|     | ICU0003-10  | Contact tip $\Phi$ 1.0mm M6x25 Ecu    |
|     | ICU0003-58  | Contact tip $\Phi$ 0.8mm M6x25 CuAl   |
|     | ICU0003-59  | Contact tip $\Phi$ 0.9mm M6x25 CuAl   |
|     | ICU0003-60  | Contact tip $\Phi$ 1.0mm M6x25 CuAl   |
|     | ICU0003-62  | Contact tip $\Phi$ 1.2mm M6x25 CuAl   |
|     | ICU0003-76  | Contact tip $\Phi$ 0.6mm M6x25 CuCrZr |
|     | ICU0003-78  | Contact tip $\Phi$ 0.8mm M6x25 CuCrZr |
|     | ICU0003-80  | Contact tip $\Phi$ 1.0mm M6x25 CuCrZr |
|     | ICU0003-82  | Contact tip $\Phi$ 1.2mm M6x25 CuCrZr |

### Liners

| No. | Part Number | Description                           |
|-----|-------------|---------------------------------------|
| C   | IIC0220     | Brass terminal $\Phi$ 2.0x4.0mm 0.35m |
|     | IIC0160     | Teflon liner $\Phi$ 2.0x3.0mm 3m Red  |
|     | IIC0560     | Red liner $\Phi$ 1.0-1.2mm 3m         |

### Components

| No.  | Part Number | Description                           |
|------|-------------|---------------------------------------|
| 1    | ICU0683     | Contact tip holder 24KD M6X26mm       |
| 2    | ICF0539     | White ceramic gas diffuser 24KD       |
| 3    | ICZ0630     | Torch head 24KD                       |
| 4    | ICV0890     | MIG handle Blue/Grip                  |
| 5    | IHQ0070     | Trigger                               |
| 6    | IFT0874     | Screw M3X10                           |
| 7    | IHJ0021     | Joint for MIG handle                  |
| 8    | IFT0882     | Spring for cable support              |
| 9    | ICN0664     | Coaxial cable 3m                      |
| 10   | IHJ0703     | Back box                              |
| 10.1 | IHJ0715     | Housing for handle                    |
| 11   | IFT0063     | Screw M4X6                            |
| 12   | IHJ0072     | Adaptor nut                           |
| 13   | ITB0059     | Euro central adaptor body/air cooling |
| 14   | Izt0071     | Liner nut                             |
| 15   | ICG6000     | Spanner for MIG torches               |

### Model

| Description                              | Part Number |            |            |
|--|-------------|------------|------------|
| MIG 25AK torch Euro adaptor spring pings | 3m          | 4m         | 5m         |
|  | ICT2798-36  | ICT2799-36 | ICT2795-36 |

### Nozzles

| No. | Part Number | Description                         |
|-----|-------------|-------------------------------------|
| A   | ICS0077     | Gas nozzle $\Phi$ 11mm              |
|     | ICS0078     | Gas nozzle $\Phi$ 15mm              |
|     | ICS0079     | Gas nozzle $\Phi$ 18mm              |
|     | ICS0715     | Tapered gas nozzle $\Phi$ 11mm      |
|     | ICS0712     | Tapered gas nozzle $\Phi$ 14mm      |
|     | ICS0075     | Spot welding gas nozzle $\Phi$ 18mm |

### Contact Tips

| No. | Part Number | Description                           |
|-----|-------------|---------------------------------------|
| B   | ICU0004-06  | Contact tip $\Phi$ 0.6mm M6x28 Ecu    |
|     | ICU0004-08  | Contact tip $\Phi$ 0.8mm M6x28 Ecu    |
|     | ICU0004-10  | Contact tip $\Phi$ 1.0mm M6x28 Ecu    |
|     | ICU0004-12  | Contact tip $\Phi$ 1.2mm M6x28 Ecu    |
|     | ICU0004-16  | Contact tip $\Phi$ 1.6mm M6x28 CuAl   |
|     | ICU0004-58  | Contact tip $\Phi$ 0.8mm M6x28 CuAl   |
|     | ICU0004-59  | Contact tip $\Phi$ 0.9mm M6x28 CuAl   |
|     | ICU0004-60  | Contact tip $\Phi$ 1.0mm M6x28 CuAl   |
|     | ICU0004-62  | Contact tip $\Phi$ 1.2mm M6x28 CuCrZr |
|     | ICU0004-66  | Contact tip $\Phi$ 1.6mm M6x28 CuCrZr |
|     | ICU0004-78  | Contact tip $\Phi$ 0.8mm M6x28 CuCrZr |
|     | ICU0004-80  | Contact tip $\Phi$ 1.0mm M6x28 CuCrZr |
|     | ICU0004-82  | Contact tip $\Phi$ 1.2mm M6x28 CuCrZr |

### Liners

| No. | Part Number | Description                           |
|-----|-------------|---------------------------------------|
| C   | IIC0220     | Brass terminal $\Phi$ 2.0x4.0mm 0.35m |
|     | IIC0160     | Teflon liner $\Phi$ 2.0x3.0mm 3m Red  |
|     | IIC0560     | Red liner $\Phi$ 1.0-1.2mm 3m         |

### Components

| No.  | Part Number | Description                           |
|------|-------------|---------------------------------------|
| 1    | ICF0061     | Gas diffuser M6X35mm                  |
| 2    | ICZ0088     | Torch head 25AK                       |
| 3    | IHJ0030-01  | Plastic Body                          |
| 4    | ICV0890     | MIG handle Blue/Grip                  |
| 5    | IHQ0070     | Trigger                               |
| 6    | IFT0874     | Screw M3X10                           |
| 7    | IHJ0021     | Joint for MIG handle                  |
| 8    | IFT0882     | Spring for cable support              |
| 9    | ICN0664     | Coaxial cable 3m                      |
| 10   | IHJ0703     | Back box                              |
| 10.1 | IHJ0715     | Housing for handle                    |
| 11   | IFT0063     | Screw M4X6                            |
| 12   | IHJ0072     | Adaptor nut                           |
| 13   | ITB0059     | Euro central adaptor body/air cooling |
| 14   | Izt0071     | Liner nut                             |
| 15   | ICG6000     | Spanner for MIG torches               |

# MIG 26



Rating: Gas Cooled, 290Amp Co., 260Amp MIX. wires: 0.8-1.2mm.

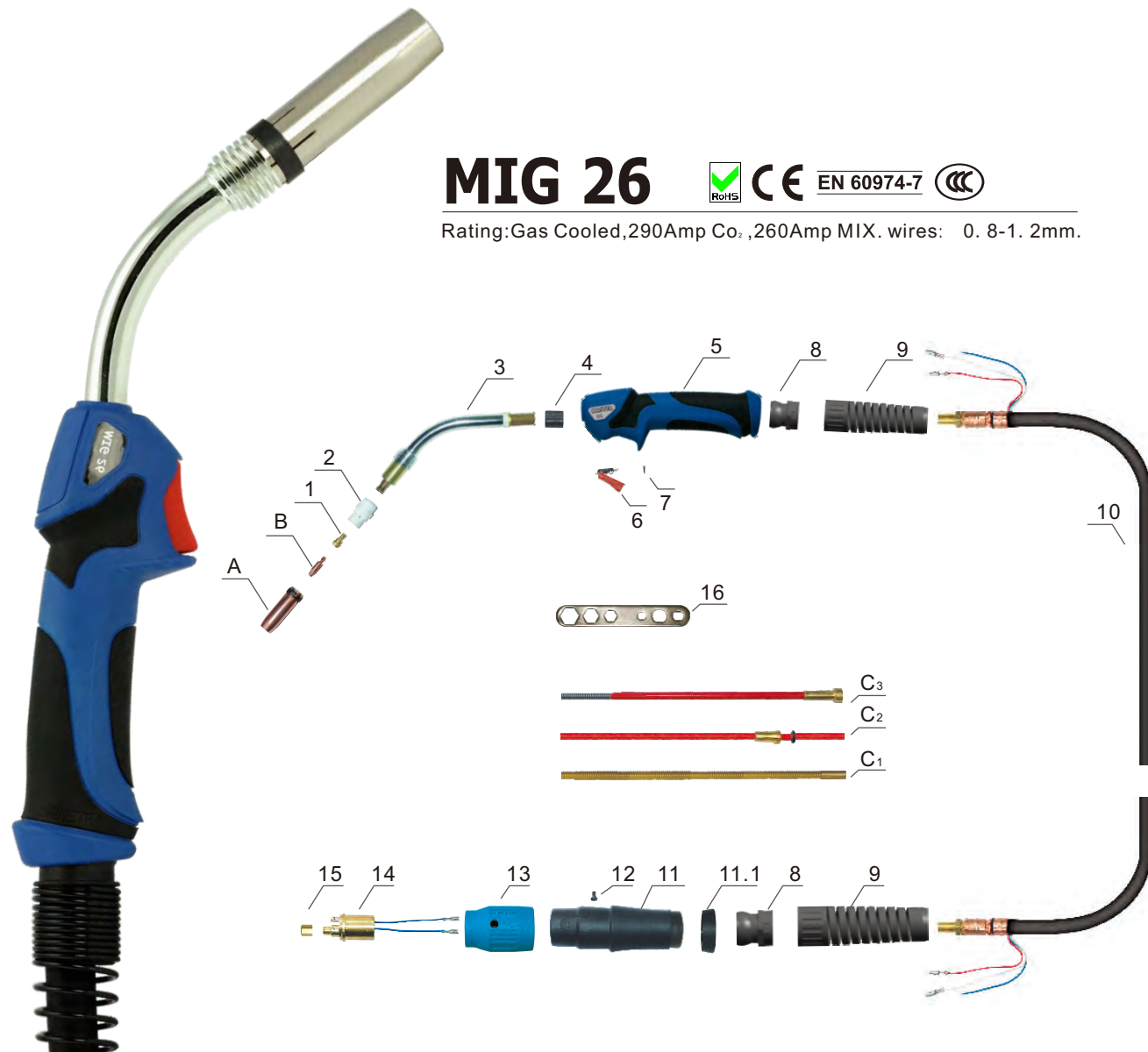

# MIG 36



Rating: Gas Cooled, 340Amp Co., 300Amp MIX. wires: 0.8-1.6mm.

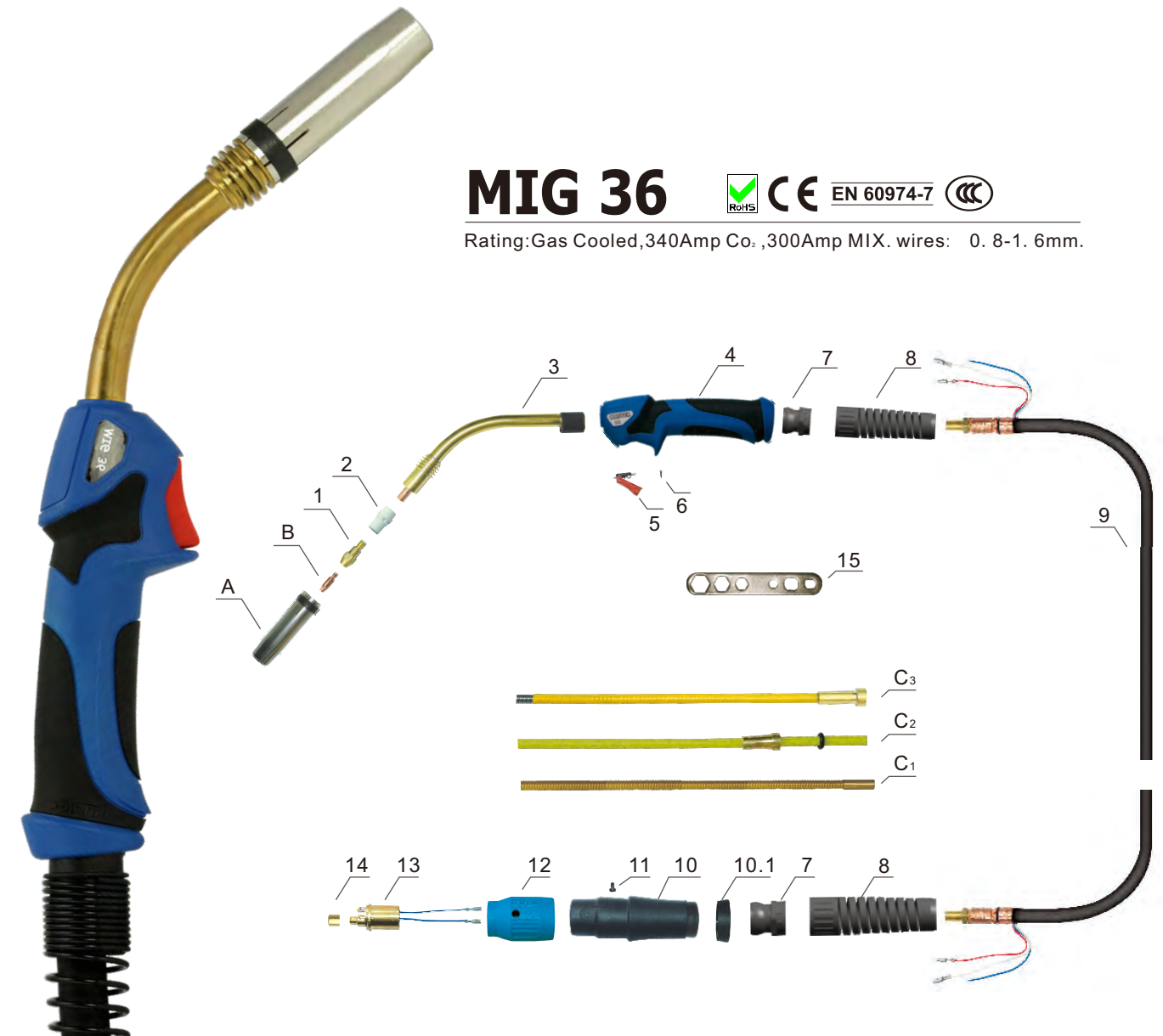

### Model

| Description                 | Part Number |            |            |
|-----------------------------|-------------|------------|------------|
| MIG 26KD torch Euro adaptor | 3m          | 4m         | 5m         |
| spring pings                | ICT2898-36  | ICT2899-36 | ICT2895-36 |

### Nozzles

| No. | Part Number | Description                         |
|-----|-------------|-------------------------------------|
| A   | ICS0713     | Gas nozzle $\Phi$ 16mm              |
|     | ICS0740     | Gas nozzle $\Phi$ 14mm              |
|     | ICS0746     | Gas nozzle $\Phi$ 19mm              |
|     | ICS0747     | Adjusted tapered nozzle $\Phi$ 15mm |
|     | ICS0748     | Spot welding gas nozzle $\Phi$ 20mm |

### Contact Tips

| No. | Part Number | Description                           |
|-----|-------------|---------------------------------------|
| B   | ICU0004-06  | Contact tip $\Phi$ 0.6mm M6x28 Ecu    |
|     | ICU0004-08  | Contact tip $\Phi$ 0.8mm M6x28 Ecu    |
|     | ICU0004-10  | Contact tip $\Phi$ 1.0mm M6x28 Ecu    |
|     | ICU0004-12  | Contact tip $\Phi$ 1.2mm M6x28 Ecu    |
|     | ICU0004-16  | Contact tip $\Phi$ 1.6mm M6x28 CuAl   |
|     | ICU0004-58  | Contact tip $\Phi$ 0.8mm M6x28 CuAl   |
|     | ICU0004-59  | Contact tip $\Phi$ 0.9mm M6x28 CuAl   |
|     | ICU0004-60  | Contact tip $\Phi$ 1.0mm M6x28 CuAl   |
|     | ICU0004-62  | Contact tip $\Phi$ 1.2mm M6x28 CuCrZr |
|     | ICU0004-66  | Contact tip $\Phi$ 1.6mm M6x28 CuCrZr |
|     | ICU0004-78  | Contact tip $\Phi$ 0.8mm M6x28 CuCrZr |
|     | ICU0004-80  | Contact tip $\Phi$ 1.0mm M6x28 CuCrZr |
|     | ICU0004-82  | Contact tip $\Phi$ 1.2mm M6x28 CuCrZr |

### Liners

| No. | Part Number | Description                           |
|-----|-------------|---------------------------------------|
| C.  | IIC0220     | Brass terminal $\Phi$ 2.0x4.0mm 0.35m |
| C.  | IIC0160     | Teflon liner $\Phi$ 2.0x4.0mm 3m Red  |
| C.  | IIC0560     | Red liner $\Phi$ 1.0-1.2mm 3m         |

### Components

| No.  | Part Number | Description                           |
|------|-------------|---------------------------------------|
| 1    | ICU0016     | Contact tip holder M6X22mm            |
| 2    | ICF0535     | White ceramic gas diffuser 26KD       |
| 3    | ICZ0636     | Torch head 26KD                       |
| 4    | IHJ0030-01  | Plastic Body                          |
| 5    | ICV0890     | MIG handle Blue/Grip                  |
| 6    | IHQ0070     | Trigger                               |
| 7    | IFT0874     | Screw M3X10                           |
| 8    | IHJ0021     | Joint for MIG handle                  |
| 9    | IFT0882     | Spring for cable support              |
| 10   | ICN0664     | Coaxial cable 3m                      |
| 11   | IHJ0703     | Back box                              |
| 11.1 | IHJ0715     | Housing for handle                    |
| 12   | IFT0063     | Screw M4X6                            |
| 13   | IHJ0072     | Adaptor nut                           |
| 14   | ITB0059     | Euro central adaptor body/air cooling |
| 15   | IZT0071     | Liner nut                             |
| 16   | ICG6000     | Spanner for MIG torches               |

### Model

| Description                 | Part Number |            |            |
|-----------------------------|-------------|------------|------------|
| MIG 36KD torch Euro adaptor | 3m          | 4m         | 5m         |
| spring pings                | ICT2998-36  | ICT2999-36 | ICT2995-36 |

### Nozzles

| No. | Part Number | Description                         |
|-----|-------------|-------------------------------------|
| A   | ICS0071     | Gas nozzle $\Phi$ 12mm              |
|     | ICS0072     | Gas nozzle $\Phi$ 16mm              |
|     | ICS0073     | Gas nozzle $\Phi$ 19mm              |
|     | ICS0660     | Spot welding gas nozzle $\Phi$ 20mm |

### Contact Tips

| No. | Part Number | Description                           |
|-----|-------------|---------------------------------------|
| B   | ICU0004-06  | Contact tip $\Phi$ 0.6mm M6x28 Ecu    |
|     | ICU0004-08  | Contact tip $\Phi$ 0.8mm M6x28 Ecu    |
|     | ICU0004-10  | Contact tip $\Phi$ 1.0mm M6x28 Ecu    |
|     | ICU0004-12  | Contact tip $\Phi$ 1.2mm M6x28 Ecu    |
|     | ICU0004-16  | Contact tip $\Phi$ 1.6mm M6x28 CuAl   |
|     | ICU0004-58  | Contact tip $\Phi$ 0.8mm M6x28 CuAl   |
|     | ICU0004-60  | Contact tip $\Phi$ 1.0mm M6x28 CuAl   |
|     | ICU0004-62  | Contact tip $\Phi$ 1.2mm M6x28 CuCrZr |
|     | ICU0004-66  | Contact tip $\Phi$ 1.6mm M6x28 CuCrZr |
|     | ICU0004-78  | Contact tip $\Phi$ 0.8mm M6x28 CuCrZr |
|     | ICU0004-80  | Contact tip $\Phi$ 1.0mm M6x28 CuCrZr |
|     | ICU0004-82  | Contact tip $\Phi$ 1.2mm M6x28 CuCrZr |

### Liners

| No. | Part Number | Description                             |
|-----|-------------|---|
| C.  | IIC0226     | Brass terminal $\Phi$ 3.0x4.5mm 0.35m   |
| C.  | IIC0210     | Teflon liner $\Phi$ 0.3x4.5mm 3m Yellow |
| C.  | IIC0590     | Yellow liner $\Phi$ 1.2-1.6mm 3m        |

### Components

| No.  | Part Number | Description                           |
|------|-------------|---------------------------------------|
| 1    | ICU0686     | Contact tip holder M6X32mm            |
| 2    | ICF0562     | White ceramic gas diffuser            |
| 3    | ICZ0089     | Torch head 36KD                       |
| 4    | ICV0890     | MIG handle Blue/Grip                  |
| 5    | IHQ0070     | Trigger                               |
| 6    | IFT0874     | Screw M3X10                           |
| 7    | IHJ0021     | Joint for MIG handle                  |
| 8    | IFT0882     | Spring for cable support              |
| 9    | ICN0670     | Coaxial cable 3m                      |
| 10   | IHJ0703     | Back box                              |
| 10.1 | IHJ0715     | Housing for handle                    |
| 11   | IFT0063     | Screw M4X6                            |
| 12   | IHJ0072     | Adaptor nut                           |
| 13   | ITB0059     | Euro central adaptor body/air cooling |
| 14   | IZT0071     | Liner nut                             |
| 15   | ICG6000     | Spanner for MIG torches               |

# MIG 40



Rating: Gas Cooled, 380Amp Co., 360Amp MIX. wires: 1.0-2.4mm.

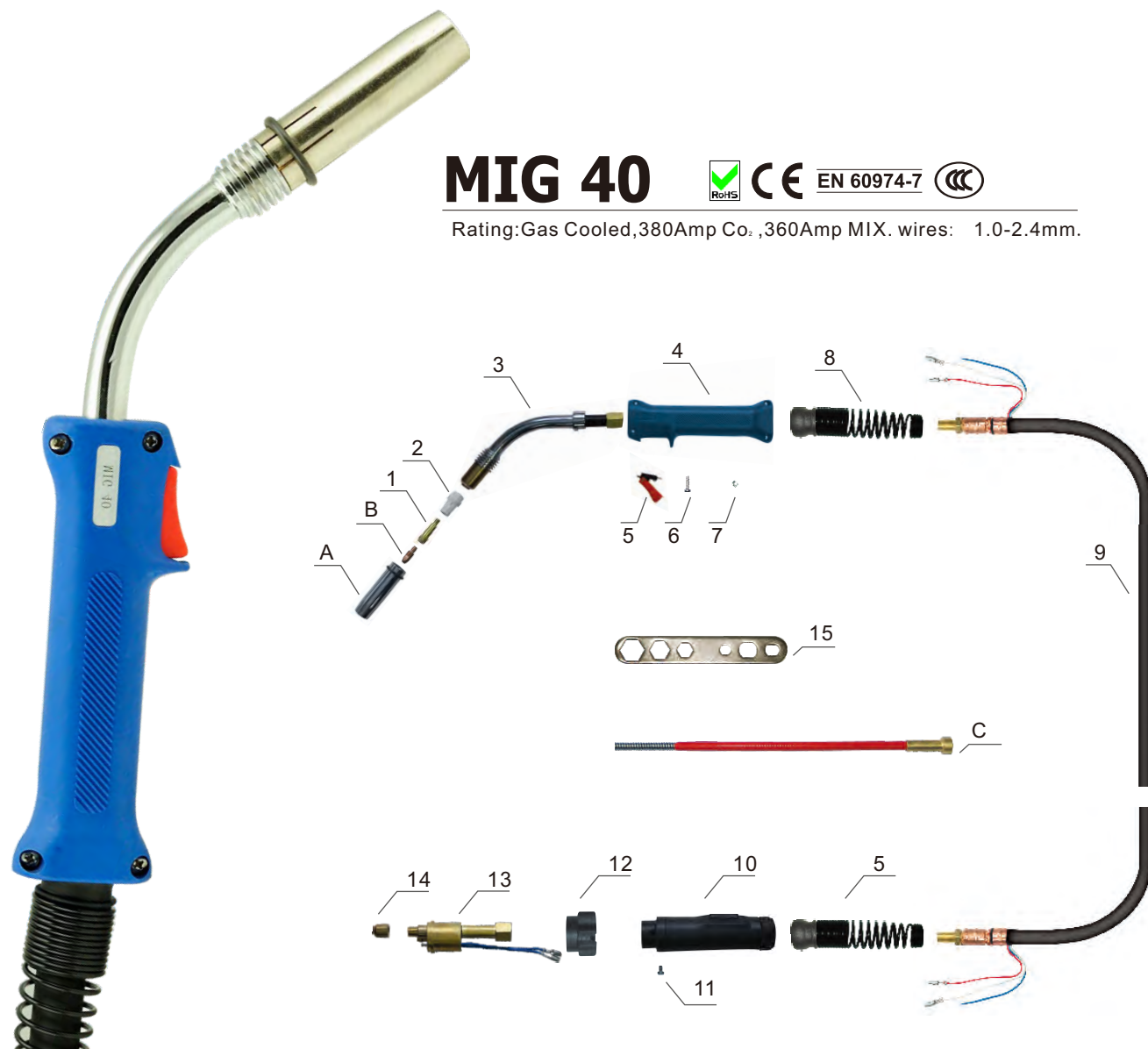

| Model                                    |             |         |         |
|--|-------------|---------|---------|
| Description                              | Part Number |         |         |
| MIG 40KD torch Euro adaptor spring pings | 3m          | 4m      | 5m      |
|  | ICT2198     | ICT2199 | ICT2195 |

| Nozzles |             |                        |
|---------|-------------|------------------------|
| No.     | Part Number | Description            |
| A       | ICS0700     | Gas nozzle $\Phi$ 18mm |
|         | ICS0701     | Gas nozzle $\Phi$ 21mm |
|         | ICS0702     | Gas nozzle $\Phi$ 14mm |

| Contact Tips |             |                                       |
|--------------|-------------|---------------------------------------|
| No.          | Part Number | Description                           |
| B            | ICU0005-08  | Contact tip $\Phi$ 0.8mm M8x30 Ecu    |
|              | ICU0005-10  | Contact tip $\Phi$ 1.0mm M8x30 Ecu    |
|              | ICU0005-12  | Contact tip $\Phi$ 1.2mm M8x30 Ecu    |
|              | ICU0005-16  | Contact tip $\Phi$ 1.6mm M8x30 Ecu    |
|              | ICU0005-20  | Contact tip $\Phi$ 2.0mm M8x30 Ecu    |
|              | ICU0005-24  | Contact tip $\Phi$ 2.4mm M8x30 Ecu    |
|              | ICU0005-58  | Contact tip $\Phi$ 0.8mm M8x30 CuAl   |
|              | ICU0005-59  | Contact tip $\Phi$ 0.9mm M8x30 CuAl   |
|              | ICU0005-60  | Contact tip $\Phi$ 1.0mm M8x30 CuAl   |
|              | ICU0005-62  | Contact tip $\Phi$ 1.2mm M8x30 CuAl   |
|              | ICU0005-66  | Contact tip $\Phi$ 1.6mm M8x30 CuAl   |
|              | ICU0005-70  | Contact tip $\Phi$ 2.0mm M8x30 CuAl   |
|              | ICU0005-74  | Contact tip $\Phi$ 2.4mm M8x30 CuAl   |
|              | ICU0005-78  | Contact tip $\Phi$ 0.8mm M8x30 CuCrZr |
|              | ICU0005-80  | Contact tip $\Phi$ 1.0mm M8x30 CuCrZr |
|              | ICU0005-82  | Contact tip $\Phi$ 1.2mm M8x30 CuCrZr |

| Contact Tips |             |                                       |
|--------------|-------------|---------------------------------------|
| No.          | Part Number | Description                           |
| B            | ICU0005-84  | Contact tip $\Phi$ 1.4mm M8x30 CuCrZr |
|              | ICU0005-86  | Contact tip $\Phi$ 1.6mm M8x30 CuCrZr |

| Liners |             |   |
|--------|-------------|---|
| No.    | Part Number | Description                             |
| C      | IIC0590     | Insulated steel liner 1.2-1.6/3m/Yellow |

| Components |             |   |
|------------|-------------|---|
| No.        | Part Number | Description   |
| 1          | ICU0027     | Contact tip holder 40KD /M8/47mm                        |
| 2          | ICF0531     | White ceramic gas diffuser 40KD                         |
| 3          | ICZ0082     | Torch head 40KD 50°                                     |
| 4          | ICV0800     | MIG handle 40KD Blue                                    |
| 5          | IHQ0070     | Trigger 21.8mm  |
| 6          | IFT0078     | Screw M4X14   |
| 7          | IFT0020     | Nut M4 UNI 5587 (Sp 4)                                  |
| 8          | IZH0864     | Joint with spring                                       |
| 9          | ICN0619     | Coaxial cable 3m  |
| 10         | IHJ0713     | Back box for air cooling for                            |
| 11         | IFT0063     | Screw M4X6 UNI 6107                                     |
| 12         | IHJ0070     | Gun plug nut  |
| 13         | ITB0019     | Euro central adaptor body/40KD/spring pins/Adaptor nutg |
| 14         | IZT0071     | Liner nut   |
| 15         | ICG6000     | Spanner for MIG torches                                 |

# MIG 240



Rating: Water Cooled, 300Amp Co., 270Amp MIX. wires: 0.8-1.2mm.



| Model                                   |             |            |            |
|---|-------------|------------|------------|
| Description                             | Part Number |            |            |
| MIG 240 torch Euro adaptor spring pings | 3m          | 4m         | 5m         |
|   | ICT2598-36  | ICT2599-36 | ICT2595-36 |

| Nozzles |             |                          |
|---------|-------------|--------------------------|
| No.     | Part Number | Description              |
| A       | ICS0800     | Gas nozzle $\Phi$ 17mm   |
|         | ICS0806     | Gas nozzle $\Phi$ 12.5mm |
|         | ICS0807     | Gas nozzle $\Phi$ 10mm   |
|         | ICS0808     | Spot welding gas nozzle  |

| Contact Tips |             |                                       |
|--------------|-------------|---------------------------------------|
| No.          | Part Number | Description                           |
| B            | ICU0003-06  | Contact tip $\Phi$ 0.6mm M6x25 Ecu    |
|              | ICU0003-08  | Contact tip $\Phi$ 0.8mm M6x25 Ecu    |
|              | ICU0003-09  | Contact tip $\Phi$ 0.9mm M6x25 Ecu    |
|              | ICU0003-10  | Contact tip $\Phi$ 1.0mm M6x25 Ecu    |
|              | ICU0003-58  | Contact tip $\Phi$ 0.8mm M6x25 CuAl   |
|              | ICU0003-59  | Contact tip $\Phi$ 0.9mm M6x25 CuAl   |
|              | ICU0003-60  | Contact tip $\Phi$ 1.0mm M6x25 CuAl   |
|              | ICU0003-62  | Contact tip $\Phi$ 1.2mm M6x25 CuAl   |
|              | ICU0003-76  | Contact tip $\Phi$ 0.6mm M6x25 CuCrZr |
|              | ICU0003-78  | Contact tip $\Phi$ 0.8mm M6x25 CuCrZr |
|              | ICU0003-80  | Contact tip $\Phi$ 1.0mm M6x25 CuCrZr |
|              | ICU0003-82  | Contact tip $\Phi$ 1.2mm M6x25 CuCrZr |

| Liners |             |                                       |
|--------|-------------|---------------------------------------|
| No.    | Part Number | Description                           |
| C      | IIC0220     | Brass terminal $\Phi$ 2.0X4.0mm 0.35m |
|        | IIC0160     | Teflon liner $\Phi$ 2.0x4.0mm 3m Red  |
|        | IIC0560     | Steel liner $\Phi$ 1.0-1.2mm 3m       |

| Components |             |  |
|------------|-------------|--|
| No.        | Part Number | Description  |
| 1          | ICU0683     | Contact tip holder M6X26mm                         |
| 2          | ICF0539     | White ceramic gas diffuser                         |
| 3          | ICI0091     | Torch head 240                                     |
| 4          | ICV0890     | MIG handle Blue/Grip                               |
| 5          | IHQ0070     | Trigger  |
| 6          | IFT0874     | Screw M3X10  |
| 7          | IHJ0021     | Joint for MIG handle                               |
| 8          | IHJ0852     | HOUSING RING/BIG/INSIDE                            |
| 8.1        | IFT0855     | HOUSING FOR PLASMA BACK BOX/BIG                    |
| 9          | IFT0822     | Spring for cable support                           |
| 10         | ICD0067     | Cable assembly 3m 401D-501D                        |
| 11         | IFT0737     | Clamp $\Phi$ 9.5                                   |
| 12         | IFT0734     | Clamp $\Phi$ 8.7                                   |
| 13         | IZT8070     | Quick connector water $\Phi$ 6mm                   |
| 14         | IHJ0763     | Back box for water cooled                          |
| 15         | IHJ0764     | Hose support for water cooled rear box             |
| 16         | IFT0063     | Screw M4X6   |
| 17         | IHJ0072     | Adaptor nut/Blue                                   |
| 18         | ITB0057     | Euro central adaptor body/water cooling            |
| 19         | IZT0071     | Liner nut  |
| 20         | IKH0605     | Output water tube M5X8mm 0.8m Red                  |
| 21         | IHJ0306     | Plastic support for water cooling connector / Red  |
| 22         | IHJ0308     | Plastic support for water cooling connector / Blue |
| 23         | ICG6000     | Spanner for MIG torches                            |

# MIG 401D/501D



Rating: Water Cooled, 400Amp Co., 350Amp MIX. wires: 0.8-1.2mm;  
 Rating: Water Cooled, 500Amp Co., 450Amp MIX. wires: 1.0-1.6mm.

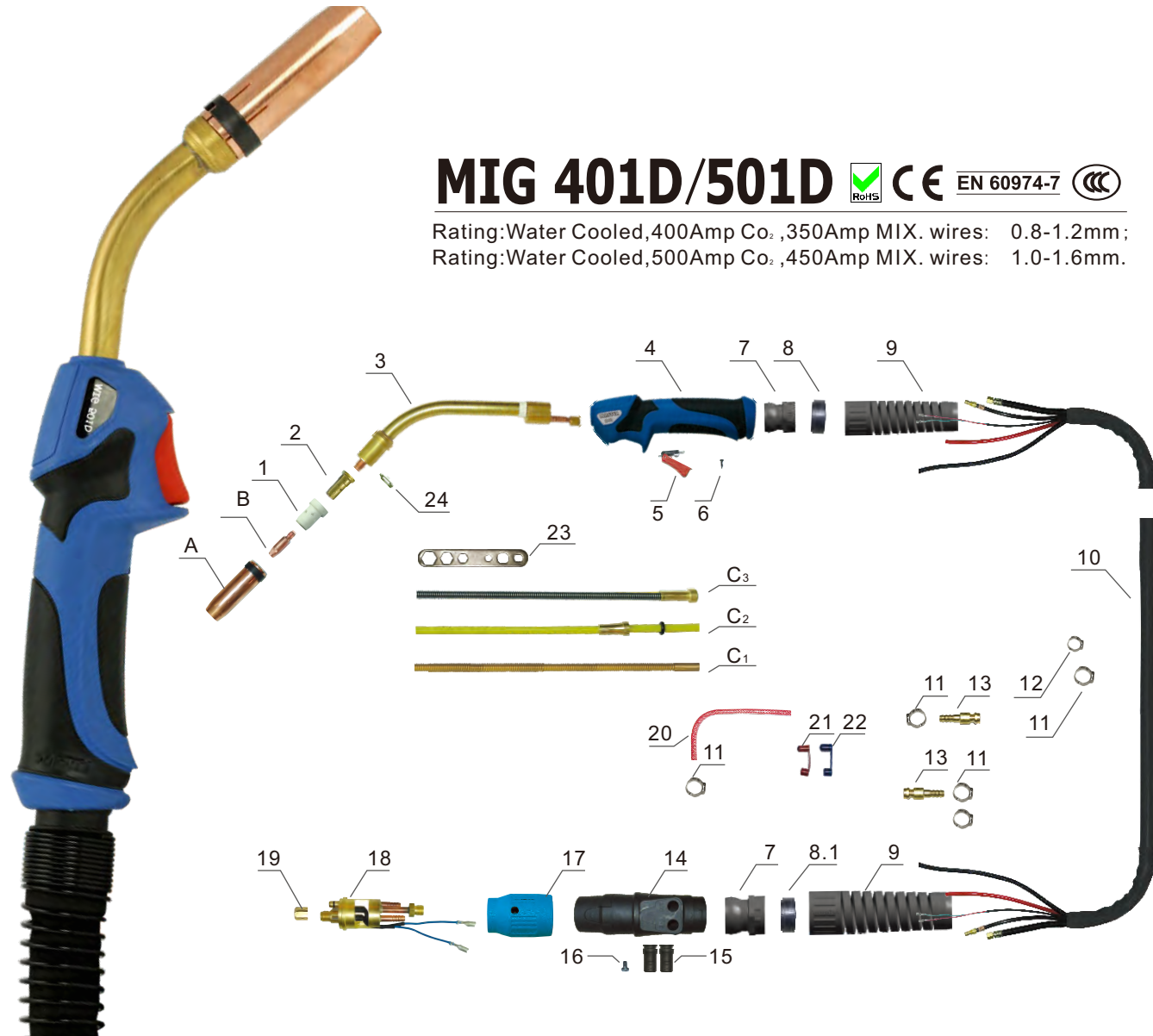

### Model

| Description                               | Part Number |            |            |
|---|-------------|------------|------------|
| MIG 401D torch Euro adaptor spring plings | 3m          | 4m         | 5m         |
|   | ICT2298-36  | ICT2299-36 | ICT2295-36 |
| MIG 501D torch Euro adaptor spring plings | 3m          | 4m         | 5m         |
|   | ICT2398-36  | ICT2399-36 | ICT2395-36 |

### Nozzles

| No. | Part Number | Description                         |
|-----|-------------|-------------------------------------|
| A   | ICS0713     | Gas nozzle $\Phi$ 16mm              |
|     | ICS0740     | Gas nozzle $\Phi$ 14mm              |
|     | ICS0746     | Gas nozzle $\Phi$ 19mm              |
|     | ICS0747     | Adjusted tapered nozzle $\Phi$ 15mm |
|     | ICS0748     | Spot welding gas nozzle $\Phi$ 20mm |

### Contact Tips

| No. | Part Number | Description                           |
|-----|-------------|---------------------------------------|
| B   | ICU0005-08  | Contact tip $\Phi$ 0.8mm M8x30 Ecu    |
|     | ICU0005-10  | Contact tip $\Phi$ 1.0mm M8x30 Ecu    |
|     | ICU0005-12  | Contact tip $\Phi$ 1.2mm M8x30 Ecu    |
|     | ICU0005-16  | Contact tip $\Phi$ 1.6mm M8x30 Ecu    |
|     | ICU0005-20  | Contact tip $\Phi$ 2.0mm M8x30 Ecu    |
|     | ICU0005-24  | Contact tip $\Phi$ 2.4mm M8x30 Ecu    |
|     | ICU0005-58  | Contact tip $\Phi$ 0.8mm M8x30 CuAl   |
|     | ICU0005-59  | Contact tip $\Phi$ 0.9mm M8x30 CuAl   |
|     | ICU0005-60  | Contact tip $\Phi$ 1.0mm M8x30 CuAl   |
|     | ICU0005-62  | Contact tip $\Phi$ 1.2mm M8x30 CuAl   |
|     | ICU0005-66  | Contact tip $\Phi$ 1.6mm M8x30 CuAl   |
|     | ICU0005-70  | Contact tip $\Phi$ 2.0mm M8x30 CuAl   |
|     | ICU0005-74  | Contact tip $\Phi$ 2.4mm M8x30 CuAl   |
|     | ICU0005-78  | Contact tip $\Phi$ 0.8mm M8x30 CuCrZr |
|     | ICU0005-80  | Contact tip $\Phi$ 1.0mm M8x30 CuCrZr |
|     | ICU0005-82  | Contact tip $\Phi$ 1.2mm M8x30 CuCrZr |

### Liners

| No. | Part Number | Description                             |
|-----|-------------|---|
| C   | IIC0226     | Brass terminal $\Phi$ 3.0x4.5mm 0.35m   |
|     | IIC0210     | Teflon liner $\Phi$ 3.0x4.5mm 3m Yellow |
|     | IIC0580     | Steel liner $\Phi$ 1.2-1.6mm 3m         |

### Components

| No. | Part Number | Description                                       |
|-----|-------------|---|
| 1   | ICU0683     | Contact tip holder M6X26mm                        |
| 2   | ICF0539     | White ceramic gas diffuser                        |
| 3   | ICI0091     | Torch head 240                                    |
| 4   | ICV0890     | MIG handle Blue/Grip                              |
| 5   | IHQ0070     | Trigger   |
| 6   | IFT0874     | Screw M3X10                                       |
| 7   | IHJ0021     | Joint for MIG handle                              |
| 8   | IHJ0852     | HOUSING RING/BIG/INSIDE                           |
| 8.1 | IFT0855     | HOUSING FOR PLASMA BACK BOX/BIG                   |
| 9   | IFT0822     | Spring for cable support                          |
| 10  | ICD0067     | Cable assembly 3m 401D-501D                       |
| 11  | IFT0737     | Clamp $\Phi$ 9.5                                  |
| 12  | IFT0734     | Clamp $\Phi$ 8.7                                  |
| 13  | IZT8070     | Quick connector water $\Phi$ 6mm                  |
| 14  | IHJ0763     | Back box for water cooled                         |
| 15  | IHJ0764     | Hose support for water cooled rear box            |
| 16  | IFT0063     | Screw M4X6  |
| 17  | IHJ0072     | Adaptor nut/Blue                                  |
| 18  | ITB0057     | Euro central adaptor body/water cooling           |
| 19  | IZT0071     | Liner nut   |
| 20  | IKH0605     | Output water tube M5X8mm 0.8m Red                 |
| 21  | IHJ0306     | Plastic support for water cooling connector /Red  |
| 22  | IHJ0308     | Plastic support for water cooling connector /Blue |
| 23  | ICG6000     | Spanner for MIG torches                           |
| 24  | IZH6723     | Insulator 401D-501D                               |

# MIG P180



Rating: Gas Cooled, 200Amp Co., 160Amp MIX. wires: 0.8-1.2mm.

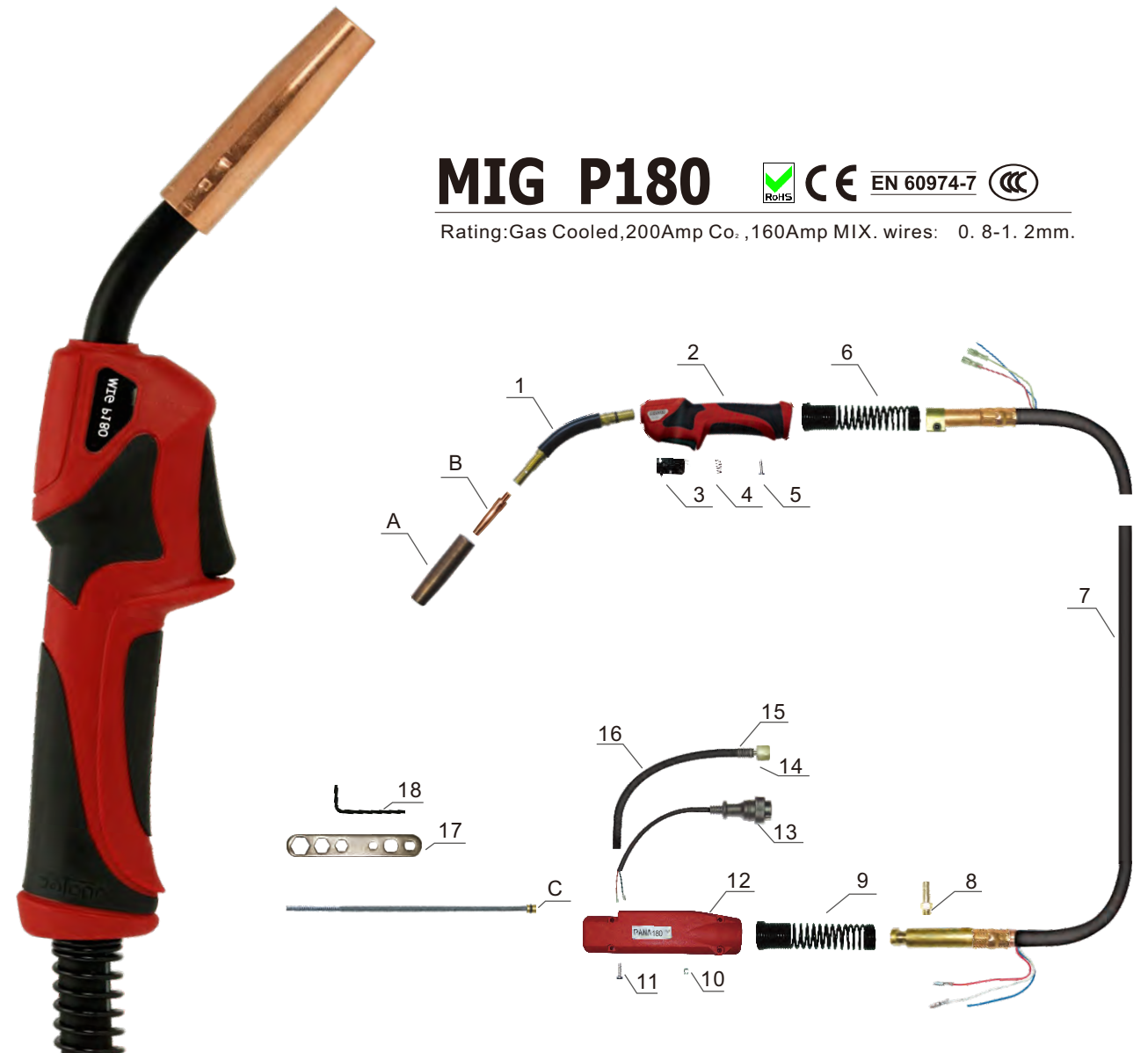

### Model

| Description         | Part Number |            |            |
|---------------------|-------------|------------|------------|
| MIG P180 torch /PAN | 3m          | 4m         | 5m         |
|                     | ICT6531-36  | ICT6532-36 | ICT6533-36 |

### Nozzles

| No. | Part Number | Description    |
|-----|-------------|----------------|
| A   | ICS0456     | NOZZLE PAN 180 |

### Contact Tips

| No. | Part Number | Description                           |
|-----|-------------|---------------------------------------|
| B   | ICU0746-08  | Contact tip $\Phi$ 0.8mm M6x45 Ecu    |
|     | ICU0746-10  | Contact tip $\Phi$ 1.0mm M6x45 Ecu    |
|     | ICU0746-12  | Contact tip $\Phi$ 1.2mm M6x45 Ecu    |
|     | ICU0746-14  | Contact tip $\Phi$ 1.4mm M6x45 Ecu    |
|     | ICU0746-16  | Contact tip $\Phi$ 1.6mm M6x45 Ecu    |
|     | ICU0746-60  | Contact tip $\Phi$ 1.0mm M6x45 CuAl   |
|     | ICU0746-62  | Contact tip $\Phi$ 1.2mm M6x45 CuAl   |
|     | ICU0746-64  | Contact tip $\Phi$ 1.4mm M6x45 CuAl   |
|     | ICU0746-78  | Contact tip $\Phi$ 0.8mm M6x45 CuCrZr |
|     | ICU0746-79  | Contact tip $\Phi$ 0.9mm M6x45 CuCrZr |
|     | ICU0746-80  | Contact tip $\Phi$ 1.0mm M6x45 CuCrZr |
|     | ICU0746-82  | Contact tip $\Phi$ 1.2mm M6x45 CuCrZr |
|     | ICU0746-84  | Contact tip $\Phi$ 1.4mm M6x45 CuCrZr |
|     | ICU0746-86  | Contact tip $\Phi$ 1.0mm M6x45 CuCrZr |
|     | ICU0746-100 | Contact tip $\Phi$ 1.0AL M6x45 CuCrZr |
|     | ICU0746-102 | Contact tip $\Phi$ 1.2AL M6x45 CuCrZr |

### Liners

| No. | Part Number | Description                                      |
|-----|-------------|--|
| C   | IIC0551     | Insulated steel liner 0.8-1.0 3.1m Black PAN 180 |

### Components

| No. | Part Number | Description                           |
|-----|-------------|---------------------------------------|
| 1   | ICZ0740     | Torch head PAN 180                    |
| 2   | ICV0895     | MIG handle PAN 180                    |
| 3   | IHQ0186     | Switch for MIG/PAN                    |
| 4   | IFT0860     | Spring for switch/PAN                 |
| 5   | IFT0874     | Screw M3X10 mm                        |
| 6   | IZH0825     | Spring cable support                  |
| 7   | ICN0110     | Coaxial cable assembly 3m/PAN         |
| 8   | IZH7065     | Gas connector for MIG torch/PAN       |
| 9   | IFT0821     | Spring cable support/PAN              |
| 10  | IFT0020     | Nut M4                                |
| 11  | IFT0079     | Screw M4x20                           |
| 12  | IHJ0640     | Back box for PAN torch                |
| 13  | IHQ0755     | Connector 2 holes/with connectors/PAN |
| 14  | IZT9009     | Connector with hexagonal nut 9/16-18  |
| 15  | IFT0803     | Spring for gas tube                   |
| 16  | IKH0668     | EPDM tube 5x10 300mm                  |
| 17  | ICG6000     | Spanner for MIG torches               |
| 18  | ICG6007     | Spanner for PAN torch                 |

# MIG P350



Rating: Gas Cooled, 340Amp Co., 320mp MIX. wires: 0.8-1.6mm.

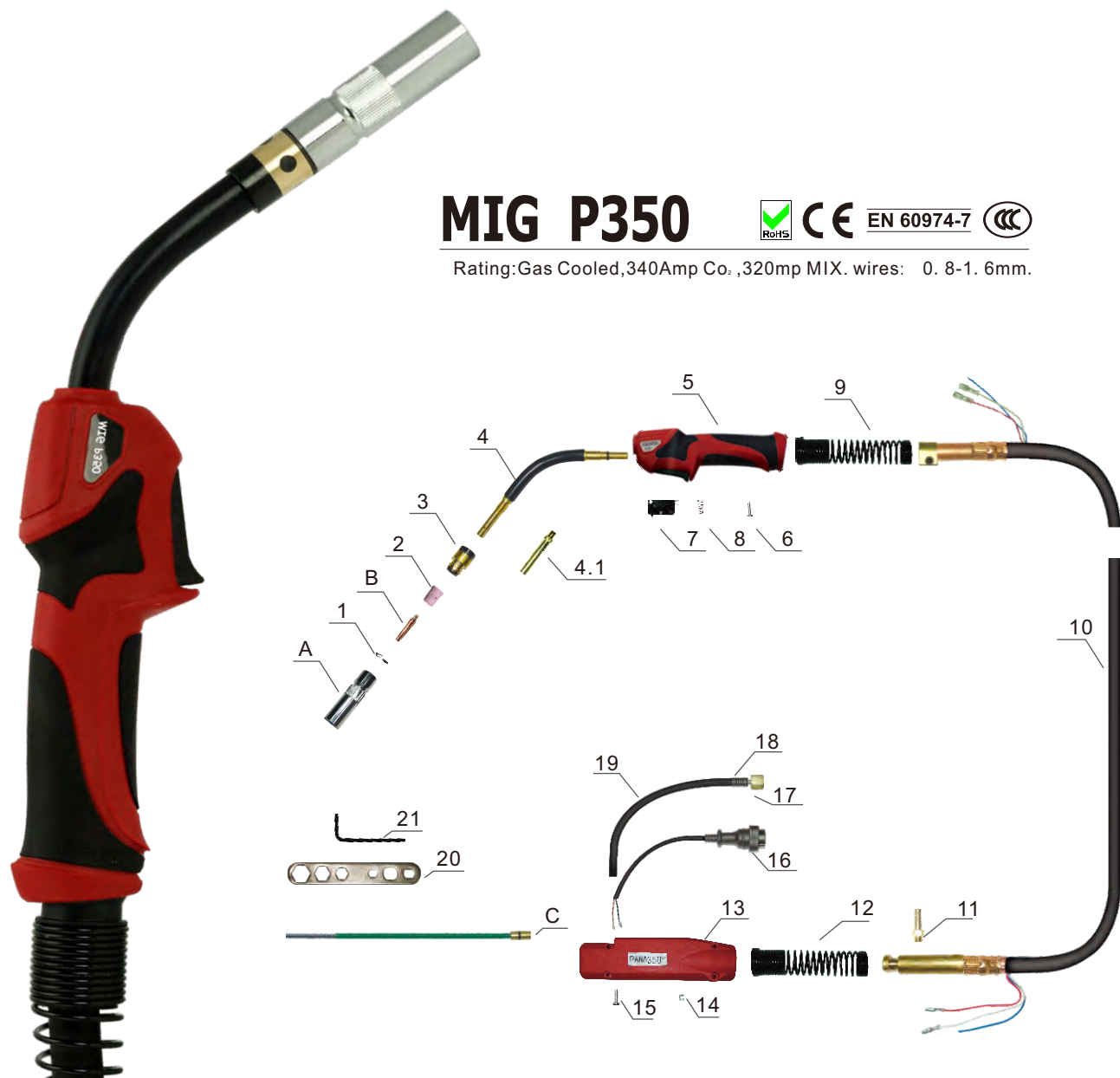

# MIG P500



Rating: Gas Cooled, 500Amp Co., 450Amp MIX. wires: 0.8-1.6mm.



| Model                |             |            |            |
|----------------------|-------------|------------|------------|
| Description          | Part Number |            |            |
| MIG P350 torch / PAN | 3m          | 4m         | 5m         |
|                      | ICT6230-36  | ICT6236-36 | ICT6237-36 |

| Nozzles |             |             |  |
|---------|-------------|-------------|--|
| No.     | Part Number | Description |  |
| A       | ICS0496     | NOZZLE P350 |  |

### Contact Tips

| No. | Part Number | Description                           |
|-----|-------------|---------------------------------------|
| B   | ICU0746-08  | Contact tip $\Phi$ 0.8mm M6x45 Ecu    |
|     | ICU0746-10  | Contact tip $\Phi$ 1.0mm M6x45 Ecu    |
|     | ICU0746-12  | Contact tip $\Phi$ 1.2mm M6x45 Ecu    |
|     | ICU0746-14  | Contact tip $\Phi$ 1.4mm M6x45 Ecu    |
|     | ICU0746-16  | Contact tip $\Phi$ 1.6mm M6x45 Ecu    |
|     | ICU0746-60  | Contact tip $\Phi$ 1.0mm M6x45 CuAl   |
|     | ICU0746-62  | Contact tip $\Phi$ 1.2mm M6x45 CuAl   |
|     | ICU0746-64  | Contact tip $\Phi$ 1.4mm M6x45 CuAl   |
|     | ICU0746-78  | Contact tip $\Phi$ 0.8mm M6x45 CuCrZr |
|     | ICU0746-79  | Contact tip $\Phi$ 0.9mm M6x45 CuCrZr |
|     | ICU0746-80  | Contact tip $\Phi$ 1.0mm M6x45 CuCrZr |
|     | ICU0746-82  | Contact tip $\Phi$ 1.2mm M6x45 CuCrZr |
|     | ICU0746-84  | Contact tip $\Phi$ 1.4mm M6x45 CuCrZr |
|     | ICU0746-86  | Contact tip $\Phi$ 1.0mm M6x45 CuCrZr |
|     | ICU0746-100 | Contact tip $\Phi$ 1.0AL M6x45 CuCrZr |
|     | ICU0746-102 | Contact tip $\Phi$ 1.2AL M6x45 CuCrZr |

### Liners

| No. | Part Number | Description                           |
|-----|-------------|---------------------------------------|
| C   | IIC0510     | Green steel liner $\Phi$ 1.0-1.2mm 3m |

| Components |             |                                       |  |
|------------|-------------|---------------------------------------|--|
| No.        | Part Number | Description                           |  |
| 1          | IFT0668     | Grower M21mm                          |  |
| 2          | ICF0976     | Ceramic diffuser P350                 |  |
| 3          | ICS6609     | Insulator P350                        |  |
| 4          | ICZ0749     | Torch head P350                       |  |
| 4.1        | ICF0971     | Torch head front part P350            |  |
| 5          | ICV0850     | MIG handle P350/500                   |  |
| 6          | IFT0874     | Screw M3X10 mm                        |  |
| 7          | IHQ0186     | Switch for MIG/PAN                    |  |
| 8          | IFT0860     | Spring for switch/PAN                 |  |
| 9          | IZH0864     | Joint with spring                     |  |
| 10         | ICN0188     | Coaxial cable 3m                      |  |
| 11         | IZH7065     | Gas connector for MIG torch/PAN       |  |
| 12         | IFT0821     | Spring cable support/PAN              |  |
| 13         | IHJ0640     | Back box for PAN torch                |  |
| 14         | IFT0020     | Nut M4                                |  |
| 15         | IFT0079     | Screw M4x20                           |  |
| 16         | IHQ0755     | Connector 2 holes/with connectors/PAN |  |
| 17         | IZT9009     | Connector with hexagonal nut 9/16-18  |  |
| 18         | IFT0803     | Spring for gas tube                   |  |
| 19         | IKH0668     | EPDM tube 5x10 300mm                  |  |
| 20         | ICG6000     | Spanner for MIG torches               |  |
| 21         | ICG6007     | Spanner for PAN torch                 |  |

| Model                |             |            |            |
|----------------------|-------------|------------|------------|
| Description          | Part Number |            |            |
| MIG P500 torch / PAN | 3m          | 4m         | 5m         |
|                      | ICT6240-36  | ICT6246-36 | ICT6247-36 |

| Nozzles |             |             |  |
|---------|-------------|-------------|--|
| No.     | Part Number | Description |  |
| A       | ICS0496     | NOZZLE P500 |  |

### Contact Tips

| No. | Part Number | Description                           |
|-----|-------------|---------------------------------------|
| B   | ICU0746-08  | Contact tip $\Phi$ 0.8mm M6x45 Ecu    |
|     | ICU0746-10  | Contact tip $\Phi$ 1.0mm M6x45 Ecu    |
|     | ICU0746-12  | Contact tip $\Phi$ 1.2mm M6x45 Ecu    |
|     | ICU0746-14  | Contact tip $\Phi$ 1.4mm M6x45 Ecu    |
|     | ICU0746-16  | Contact tip $\Phi$ 1.6mm M6x45 Ecu    |
|     | ICU0746-60  | Contact tip $\Phi$ 1.0mm M6x45 CuAl   |
|     | ICU0746-62  | Contact tip $\Phi$ 1.2mm M6x45 CuAl   |
|     | ICU0746-64  | Contact tip $\Phi$ 1.4mm M6x45 CuAl   |
|     | ICU0746-78  | Contact tip $\Phi$ 0.8mm M6x45 CuCrZr |
|     | ICU0746-79  | Contact tip $\Phi$ 0.9mm M6x45 CuCrZr |
|     | ICU0746-80  | Contact tip $\Phi$ 1.0mm M6x45 CuCrZr |
|     | ICU0746-82  | Contact tip $\Phi$ 1.2mm M6x45 CuCrZr |
|     | ICU0746-84  | Contact tip $\Phi$ 1.4mm M6x45 CuCrZr |
|     | ICU0746-86  | Contact tip $\Phi$ 1.0mm M6x45 CuCrZr |
|     | ICU0746-100 | Contact tip $\Phi$ 1.0AL M6x45 CuCrZr |
|     | ICU0746-102 | Contact tip $\Phi$ 1.2AL M6x45 CuCrZr |

### Liners

| No. | Part Number | Description                           |
|-----|-------------|---------------------------------------|
| C   | IIC0518     | Black steel liner $\Phi$ 1.2-1.6mm 3m |

# BND 300/350

Rating: Gas Cooled, 300/350 Amp Co., 250/300 Amp MIX. wires: 0.6-1.6 mm.

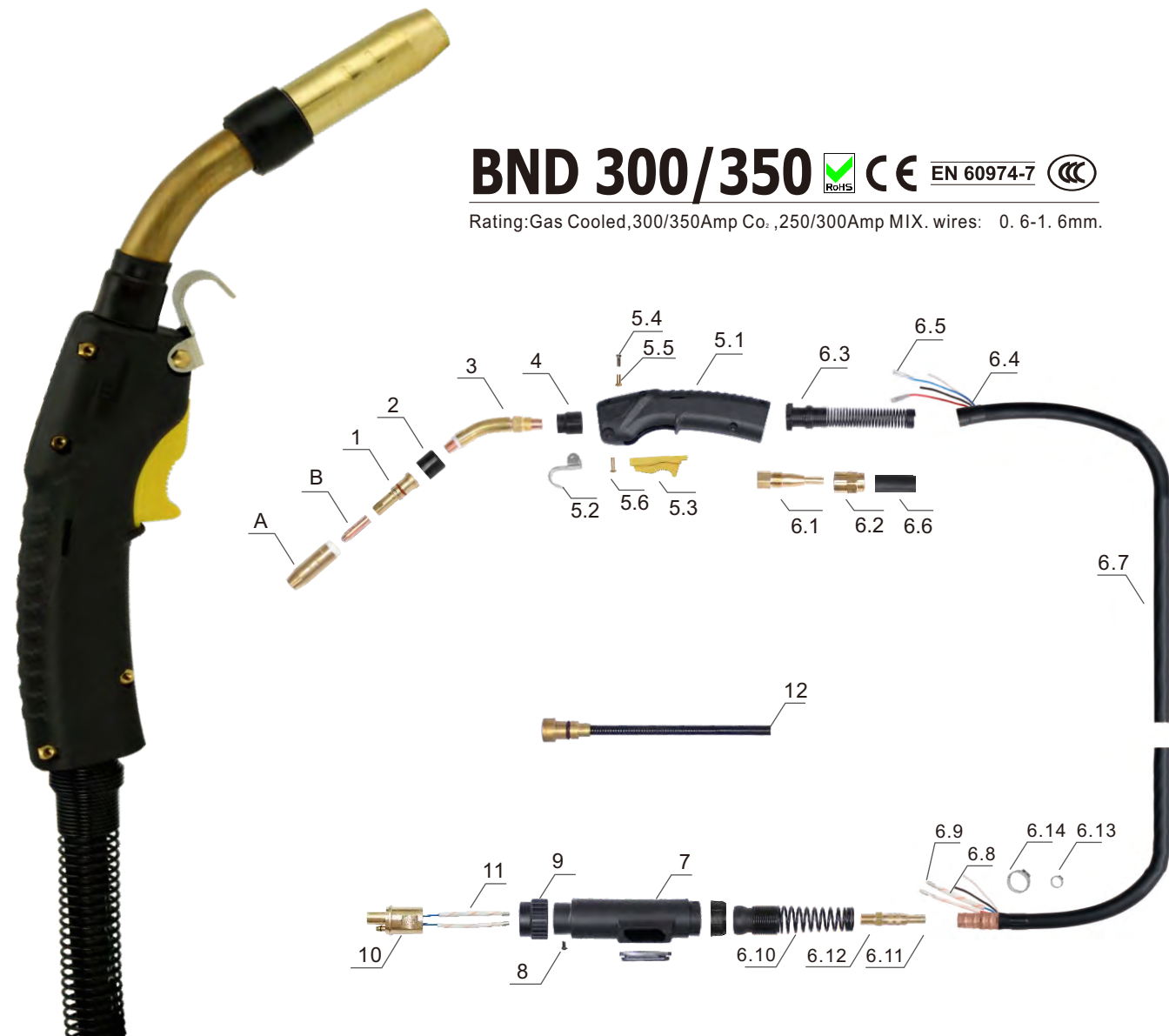

### Model

| Description        | Part Number |         |
|--------------------|-------------|---------|
| BND 300/350        | 3.6m        | 4.6m    |
| torch Euro adaptor | ICT5770     | ICT5776 |

### Nozzles

| No. | Part Number | Description                 |
|-----|-------------|-----------------------------|
| A   | ICS0965     | NOZZLE D.12.5 BRASS BD 4392 |

### Contact Tips

| No. | Part Number | Description                   |
|-----|-------------|-------------------------------|
| B   | ICU0765-16  | CONTACT TIP D.1.6 BD SERIE 74 |

### Liners

| No. | Part Number | Description                      |
|-----|-------------|----------------------------------|
| C   | IIC0095     | Liner 4,5 m - 1,2-1,6 mm.(44215) |

### Components

| No.  | Part Number | Description                            |
|------|-------------|--|
| 1    | ICF0660     | DIFFUSER BD 4335                       |
| 2    | IHJ0045     | INSULATOR TORCHBODY BERNARD            |
| 3    | ICZ0715     | TORCHHEAD/QT2/45DEGREE                 |
| 4    | IHJ0036     | NECK INSULATOR 4780                    |
| 5.1  | ICV0053     | HANDLE/BLACK/BND                       |
| 5.2  | IFT0972     | HOOK/BND                               |
| 5.3  | IHQ0019     | TRIGGER FOR BND/5662/YELLOW            |
| 5.4  | IFT0616     | SCRWE M3.5x0.6-10                      |
| 5.5  | IFT0656     | NUT M3.5x0.6-11 CH6.3/NICKEL PLATING   |
| 5.6  | IFT0650-01  | NUT M3.5x0.6-15 CH6.3/NICKEL PLATING   |
| 6.1  | ITY6700     | Back Fitting Cable BD4213B             |
| 6.2  | IFT0930     | MUT/BND                                |
| 6.3  | IFT0839     | CABLE SUPPOR SPRING/BERNARD300-400     |
| 6.4  | IHQ0700     | Female Trigger Wire Connector          |
| 6.5  | IHQ0708     | INSULATOR FOR CONNECTOR                |
| 6.6  | ICK0876     | Heat shrink tubing                     |
| 6.7  | ICN0376     | COAXIAL CABLE 4.6M/4WIRES              |
| 6.8  | IHQ0090     | INSULATOR TUBE/Φ3 M                    |
| 6.9  | IHQ0740     | Preinsulated Male Cylindrical Plug     |
| 6.10 | IZH0864     | Joint With Spring                      |
| 6.11 | ISG0977     | Rings For Cable Clamping D19,3X21,3X42 |
| 6.12 | ITY0690     | BACK FITTING CABLE/BND                 |
| 6.13 | IFT0739     | Clamp Φ11,5mm                          |
| 6.14 | IFT0720     | Clamp Φ20mm                            |
| 7    | IHJ0713     | BACK BOX FOR AIR COOLING               |
| 8    | IFT0063     | SCREW M4X6 UNI 6107                    |
| 9    | IHJ0078     | Gun Plug Nut/BINZEL TYPE/BRASS SCREW   |
| 10   | ITB0035     | ASSEMBLY OF EURO CENTRE ADAPTOR/BND    |
| 11   | IHQ0050     | INSULATOR TUBE/Φ5 M                    |

# BND 400

Rating: Gas Cooled, 400 Amp Co., 350 Amp MIX. wires: 0.9-1.6 mm.

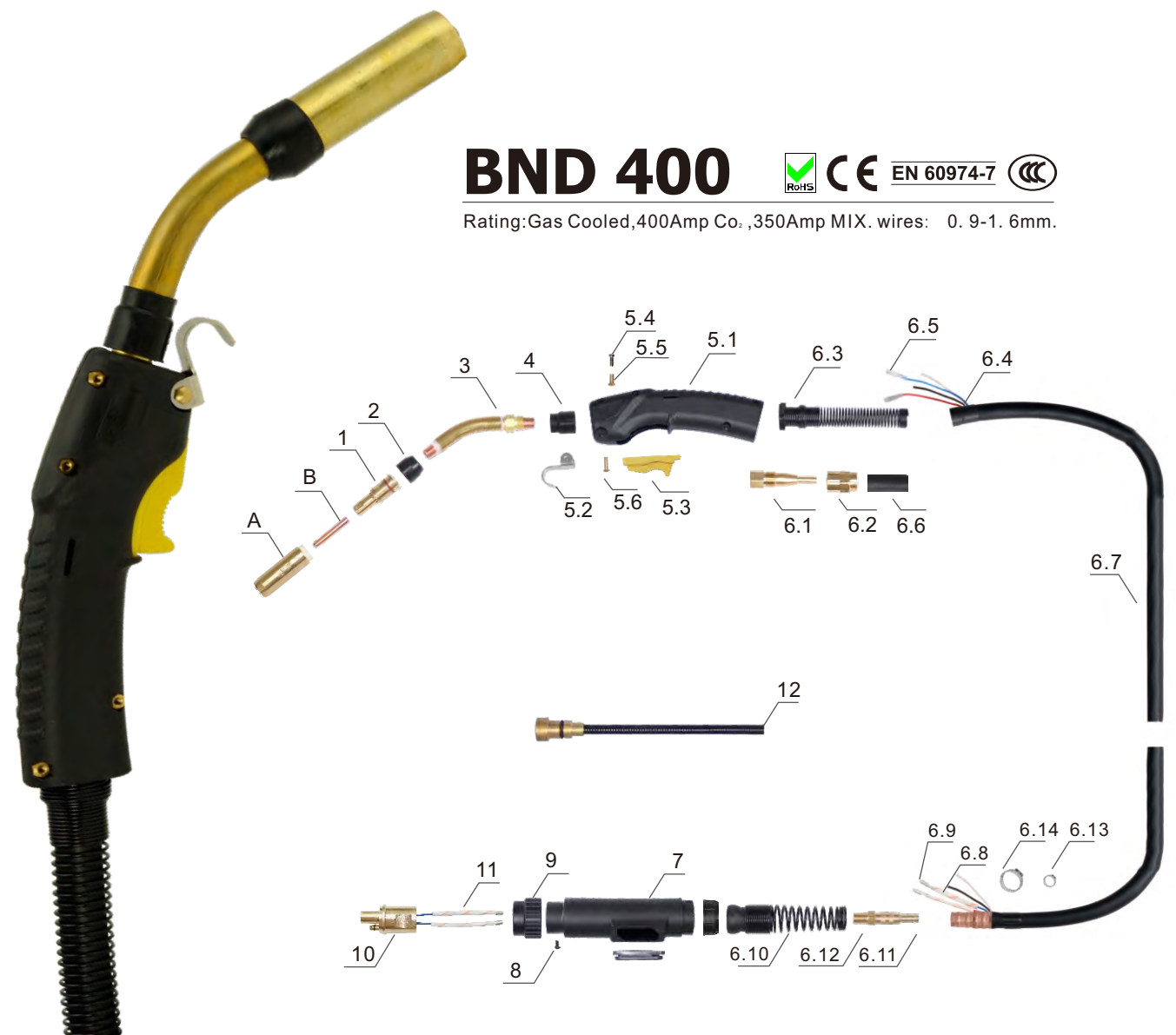

### Model

| Description        | Part Number |         |
|--------------------|-------------|---------|
| BND 300/350        | 3.6m        | 4.6m    |
| torch Euro adaptor | ICT5770     | ICT5776 |

### Nozzles

| No. | Part Number | Description              |
|-----|-------------|--------------------------|
| A   | ICS0970     | NOZZLE D.19 BRASS BD4491 |

### Contact Tips

| No. | Part Number | Description                   |
|-----|-------------|-------------------------------|
| B   | ICU0769-16  | CONTACT TIP D.1.6 BD SERIE 74 |

### Liners

| No. | Part Number | Description                      |
|-----|-------------|----------------------------------|
| C   | IIC0095     | Liner 4,5 m - 1,2-1,6 mm.(44215) |

### Components

| No.  | Part Number | Description                            |
|------|-------------|--|
| 1    | ICF0667     | DIFFUSER GASBD 4635                    |
| 2    | IHJ0042     | NOZZLE INSULATOR/BERNARD/4423          |
| 3    | ICZ0710     | TORCHHEAD/4790                         |
| 4    | IHJ0036     | NECK INSULATOR 4780                    |
| 5.1  | ICV0053     | HANDLE/BLACK/BND                       |
| 5.2  | IFT0972     | HOOK/BND                               |
| 5.3  | IHQ0019     | TRIGGER FOR BND/5662/YELLOW            |
| 5.4  | IFT0616     | SCRWE M3.5x0.6-10                      |
| 5.5  | IFT0656     | NUT M3.5x0.6-11 CH6.3/NICKEL PLATING   |
| 5.6  | IFT0650-01  | NUT M3.5x0.6-15 CH6.3/NICKEL PLATING   |
| 6.1  | ITY6700     | Back Fitting Cable BD4213B             |
| 6.2  | IFT0930     | MUT/BND                                |
| 6.3  | IFT0839     | CABLE SUPPOR SPRING/BERNARD300-400     |
| 6.4  | IHQ0700     | Female Trigger Wire Connector          |
| 6.5  | IHQ0708     | INSULATOR FOR CONNECTOR                |
| 6.6  | ICK0876     | Heat shrink tubing                     |
| 6.7  | ICN0376     | COAXIAL CABLE 4.6M/4WIRES              |
| 6.8  | IHQ0090     | INSULATOR TUBE/Φ3 M                    |
| 6.9  | IHQ0740     | Preinsulated Male Cylindrical Plug     |
| 6.10 | IZH0864     | Joint With Spring                      |
| 6.11 | ISG0977     | Rings For Cable Clamping D19,3X21,3X42 |
| 6.12 | ITY0690     | BACK FITTING CABLE/BND                 |
| 6.13 | IFT0739     | Clamp Φ11,5mm                          |
| 6.14 | IFT0720     | Clamp Φ20mm                            |
| 7    | IHJ0713     | BACK BOX FOR AIR COOLING               |
| 8    | IFT0063     | SCREW M4X6 UNI 6107                    |
| 9    | IHJ0078     | Gun Plug Nut/BINZEL TYPE/BRASS SCREW   |
| 10   | ITB0035     | ASSEMBLY OF EURO CENTRE ADAPTOR/BND    |
| 11   | IHQ0050     | INSULATOR TUBE/Φ5 M                    |



# TW-200

Rating: Gas Cooled, 200Amp Co., 150mp MIX. wires: 0.6-1.2mm.

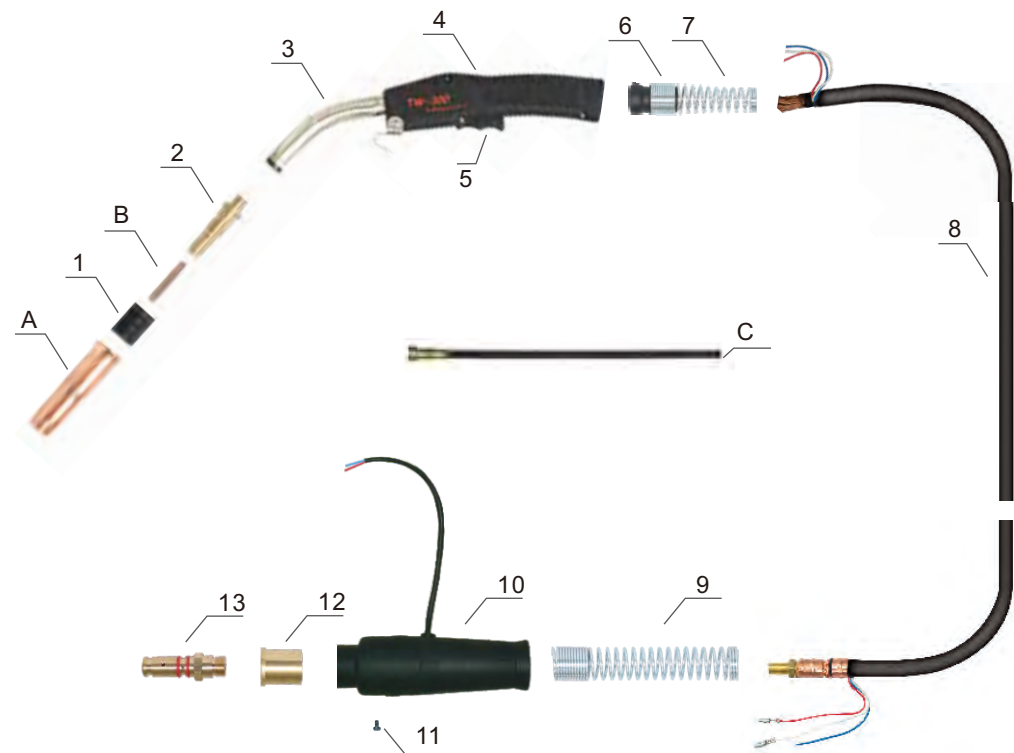

# TW-400

Rating: Gas Cooled, 400Amp Co., 350mp MIX. wires: 0.8-2.0mm.

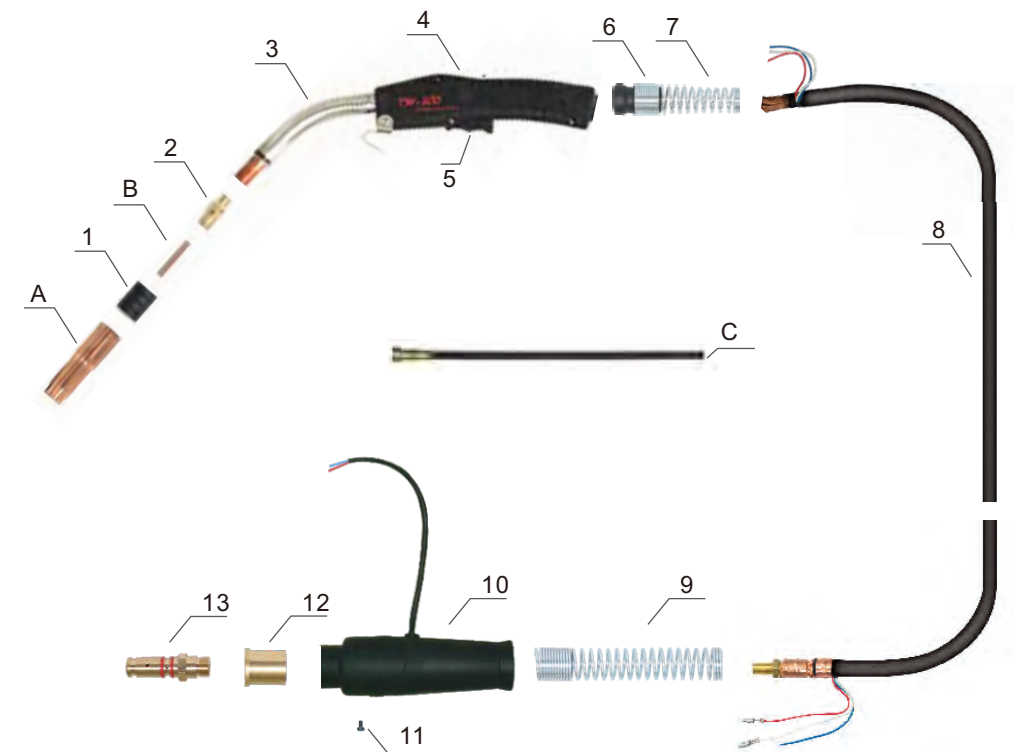
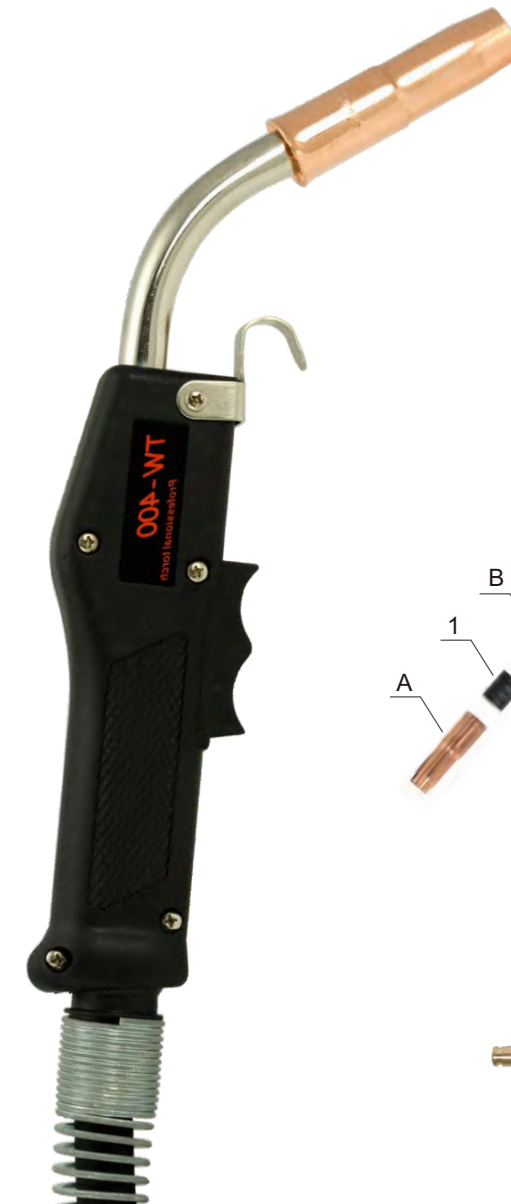

| Model                    |             |         |         |
|--------------------------|-------------|---------|---------|
| Description              | Part Number |         |         |
| TW2 torch                | 3m          | 4m      | 4.6m    |
|                          | ICT5700     | ICT5706 | ICT5707 |
|                          | 3m          | 4m      | 4.6m    |
| TW2 torch euro adaptor   | ICT5715     | ICT5711 | ICT5712 |
|                          | 3m          | 4m      | 5m      |
| TW2 torch Miller adaptor | ICT5713     | ICT5714 | ICT5720 |

| Nozzles |             |                      |
|---------|-------------|----------------------|
| No.     | Part Number | Description          |
| A       | ICS0789     | Gas nozzle $\phi$ 13 |

| Contact Tips |             |                                     |
|--------------|-------------|-------------------------------------|
| No.          | Part Number | Description                         |
| B            | ICU0008-06  | Contact tip $\phi$ 0.6mm 0.035" Ecu |
|              | ICU0008-08  | Contact tip $\phi$ 0.8mm 0.035" Ecu |
|              | ICU0008-09  | Contact tip $\phi$ 0.9mm 0.035" Ecu |
|              | ICU0008-10  | Contact tip $\phi$ 1.0mm 0.035" Ecu |
|              | ICU0008-12  | Contact tip $\phi$ 1.2mm 0.035" Ecu |
|              | ICU0008-13  | Contact tip $\phi$ 1.3mm 0.035" Ecu |
|              | ICU0008-16  | Contact tip $\phi$ 1.6mm 0.035" Ecu |
|              | ICU0008-20  | Contact tip $\phi$ 2.0mm 0.035" Ecu |
|              | ICU0008-62  | Contact tip $\phi$ 1.2mm 0.035" Ecu |
|              | ICU0008-66  | Contact tip $\phi$ 1.6mm 0.035" Ecu |

| Liners |             |                               |
|--------|-------------|-------------------------------|
| No.    | Part Number | Description                   |
| C      | IIC0067-06  | Steel liner 11' 0.030"-0.035" |

| Components |             |   |
|------------|-------------|---|
| No.        | Part Number | Description   |
| 1          | ICK0680     | Insulator   |
| 2          | ICF0077     | Diffuser  |
| 3          | ICZ0691-02  | Torch head 45GR/62J-45/Nickel-Plated outer tube /With fitting |
| 4          | ICV0792     | MIG handle with screw   |
| 5          | IHQ0063     | Trigger switch assembly                                       |
| 6          | IHJ0787     | Joint for TW1-4   |
| 7          | IFT0890-01  | Spring for cable support/Zin/TW                               |
| 8          | ICN0798     | Cable assembly/3M   |
| 9          | IFT0824     | Spring for cable support/Blue and white zinc plating          |
| 10         | IHJ0872     | Back box with closing ring                                    |
| 11         | IFT0063     | Screw M4x6  |
| 12         | IZH7051     | Continental adaptor / Miller M10X1                            |
| 13         | ITO0092     | Connetcing adaptor TW1-4                                      |



| Model                    |             |         |         |
|--------------------------|-------------|---------|---------|
| Description              | Part Number |         |         |
| TW4 torch                | 3m          | 4m      | 4.6m    |
|                          | ICT5900     | ICT5906 | ICT5907 |
| TW4 torch euro adaptor   | 3m          | 4m      | 4.6m    |
|                          | ICT5915     | ICT5911 | ICT5912 |
| TW4 torch Miller adaptor | 3m          | 4m      | 4.6m    |
|                          | ICT5913     | ICT5914 | ICT5920 |

| Nozzles |             |                      |
|---------|-------------|----------------------|
| No.     | Part Number | Description          |
| A       | ICS0691     | Gas nozzle $\phi$ 16 |

| Contact Tips |             |                                  |
|--------------|-------------|----------------------------------|
| No.          | Part Number | Description                      |
| B            | ICU0009-09  | Contact tip 0.9/ 1/4-28X37.4 Ecu |
|              | ICU0009-10  | Contact tip 1.0/ 1/4-28X37.4 Ecu |
|              | ICU0009-12  | Contact tip 1.2/ 1/4-28X37.4 Ecu |
|              | ICU0009-13  | Contact tip 1.3/ 1/4-28X37.4 Ecu |
|              | ICU0009-16  | Contact tip 1.6/ 1/4-28X37.4 Ecu |
|              | ICU0009-20  | Contact tip 2.0/ 1/4-28X37.4 Ecu |
|              | ICU0009-62  | Contact tip 1.2/ 1/4-28X37.4 Ecu |
|              | ICU0009-66  | Contact tip 1.6/ 1/4-28X37.4 Ecu |

| Liners |             |                             |
|--------|-------------|-----------------------------|
| No.    | Part Number | Description                 |
| C      | IIC0009-03  | Steel liner 3.4M 0.9-1.2/TW |

| Components |             |  |
|------------|-------------|--|
| No.        | Part Number | Description  |
| 1          | ICK0686     | Insulator  |
| 2          | ICF0070     | Diffuser   |
| 3          | ICZ0699-01  | Torch head 60GR/TW4/64J-60/Nickel-plated outer tube  |
| 4          | ICV0793     | MIG handle with screw                                |
| 5          | IHQ0081     | Trigger Kit/TW                                       |
| 6          | IHJ0777     | Joint for MIG handle                                 |
| 7          | IFT0876-02  | Spring for cable support/Zin/Long/TW                 |
| 8          | ICN0908     | Cable assembly/3M                                    |
| 9          | IFT0824     | Spring for cable support/Blue and white zinc plating |
| 10         | IHJ0872     | Back box with closing ring                           |
| 11         | IFT0063     | Screw M4x6   |
| 12         | IZH7051     | Continental adaptor / Miller M10X1                   |
| 13         | ITO0092     | Connetcing adaptor TW1-4                             |



# MIG MAXI 150



Rating: Gas Cooled, 180Amp Co., 140mp MIX. wires: 0.6-1.2mm.

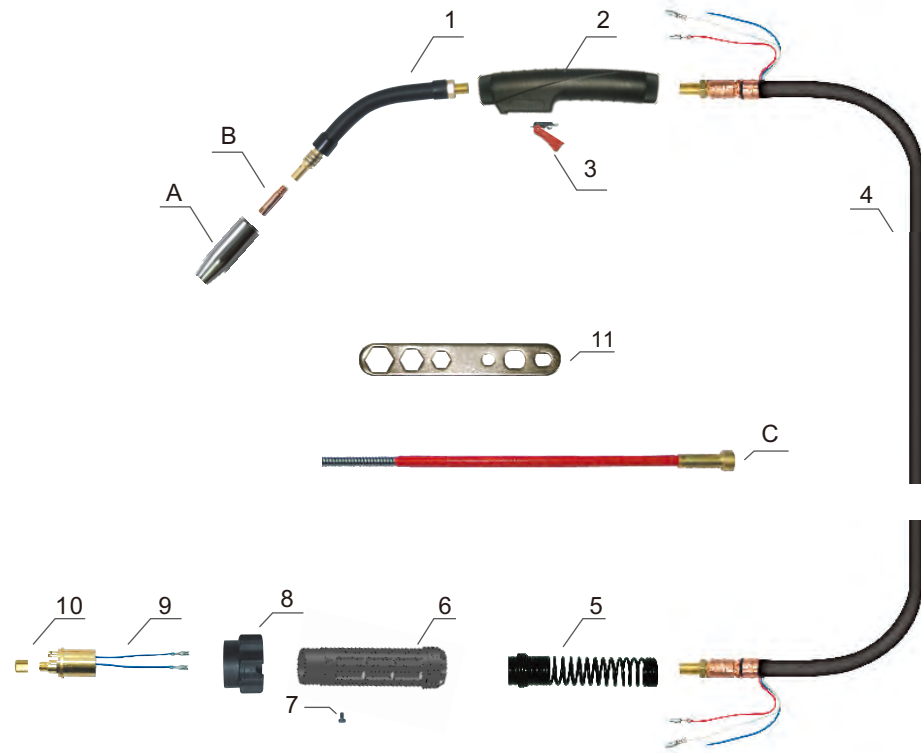

### Model

| Description                    | Part Number |         |         |
|--------------------------------|-------------|---------|---------|
| <b>MIG MAXI 150</b> Euro torch | 3m          | 4m      | 5m      |
| TW with spring pins            | ICT1615     | ICT1611 | ICT1612 |

### Nozzles

| No. | Part Number | Description                      |
|-----|-------------|----------------------------------|
| A   | ICS0001     | Gas nozzle $\phi$ 14 mm MAXI 150 |
|     | ICS0002     | Spot Welding Gas nozzle          |
|     | ICS0005     | Gas nozzle $\phi$ 11 mm MAXI 150 |

### Contact Tips

| No. | Part Number | Description                           |
|-----|-------------|---------------------------------------|
| B   | ICU0003-06  | Contact tip $\phi$ 0.6mm M6x25 Ecu    |
|     | ICU0003-08  | Contact tip $\phi$ 0.8mm M6x25 Ecu    |
|     | ICU0003-09  | Contact tip $\phi$ 0.9mm M6x25 Ecu    |
|     | ICU0003-10  | Contact tip $\phi$ 1.0mm M6x25 Ecu    |
|     | ICU0003-58  | Contact tip $\phi$ 0.8mm M6x25 CuAl   |
|     | ICU0003-59  | Contact tip $\phi$ 0.9mm M6x25 CuAl   |
|     | ICU0003-60  | Contact tip $\phi$ 1.0mm M6x25 CuAl   |
|     | ICU0003-62  | Contact tip $\phi$ 1.2mm M6x25 CuAl   |
|     | ICU0003-76  | Contact tip $\phi$ 0.6mm M6x25 CuCrZr |
|     | ICU0003-78  | Contact tip $\phi$ 0.8mm M6x25 CuCrZr |
|     | ICU0003-80  | Contact tip $\phi$ 1.0mm M6x25 CuCrZr |
|     | ICU0003-82  | Contact tip $\phi$ 1.2mm M6x25 CuCrZr |

### Liners

| No. | Part Number | Description                |
|-----|-------------|----------------------------|
| C   | IIC0066-03  | Steel liner 3.4m 0.8-1.0mm |

### Components

| No. | Part Number | Description                               |
|-----|-------------|---|
| 1   | ICZ0007     | Torch head                                |
| 2   | ICV0057     | Handle                                    |
| 3   | IHQ0070     | Trigger                                   |
| 4   | ICN0860     | Coaxial cable                             |
| 5   | IFT0897     | Spring cable support                      |
| 6   | IHJ0645     | Back box                                  |
| 7   | IFT0063     | Screw                                     |
| 8   | IHJ0063     | Adaptor nut                               |
| 9   | ITB0038     | Central adaptor TW/Euro M12x1/Spring pins |
| 10  | IZT0072     | Liner nut M11x1                           |
| 11  | ICG6000     | Spanner for MIG                           |

# MIG MAXI 250



Rating: Gas Cooled, 250Amp Co., 200mp MIX. wires: 0.8-1.2mm.

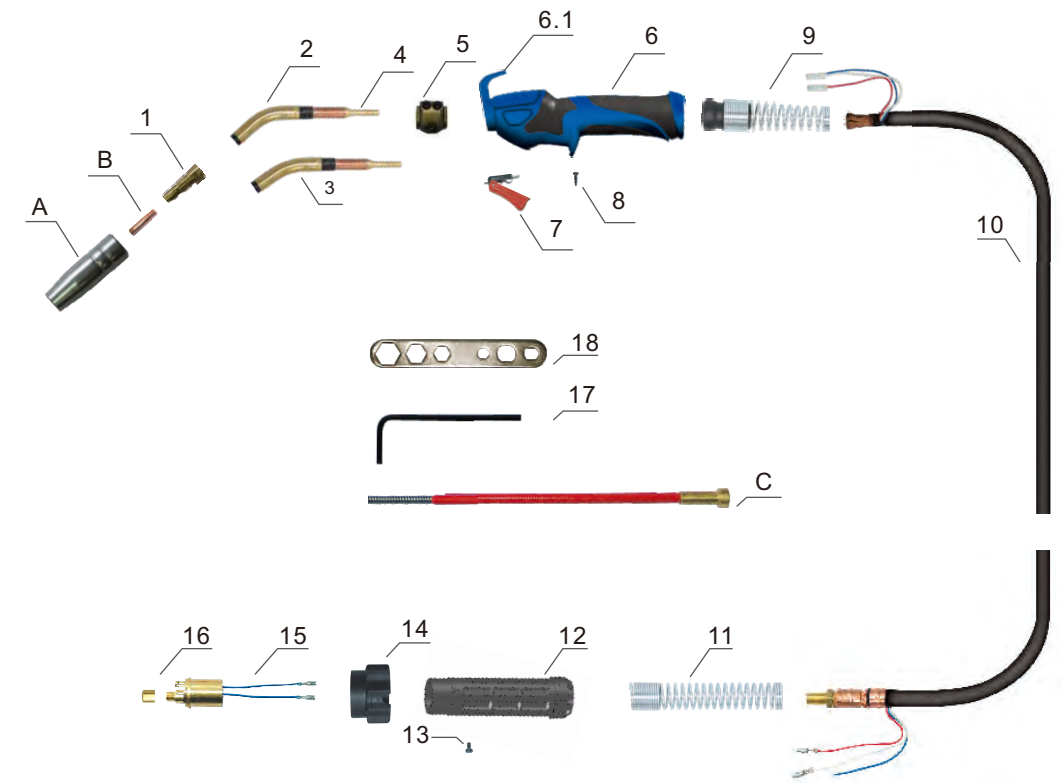
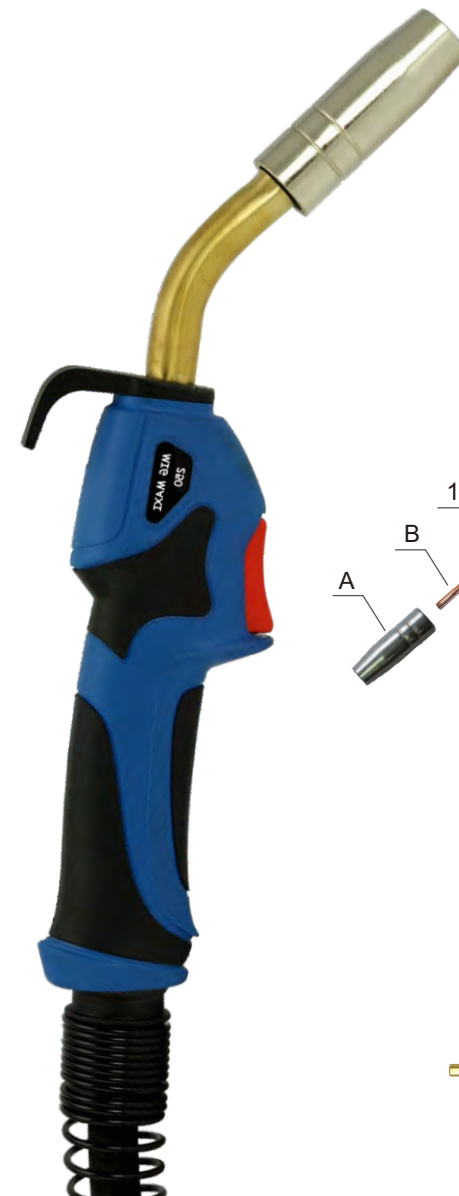

### Model

| Description                    | Part Number |            |            |
|--------------------------------|-------------|------------|------------|
| <b>MIG MAXI 250</b> Euro torch | 3m          | 4m         | 5m         |
| TW with spring pins            | ICT1715-36  | ICT1711-36 | ICT1712-36 |

### Nozzles

| No. | Part Number | Description                      |
|-----|-------------|----------------------------------|
| A   | ICS0003     | Gas nozzle $\phi$ 11 mm MAXI 250 |
|     | ICS0004     | Gas nozzle $\phi$ 14 mm MAXI 250 |
|     | ICS0060     | Gas nozzle $\phi$ 16 mm          |
|     | ICS0673     | Gas nozzle $\phi$ 18 mm MAXI 250 |
|     | ICS0674     | Tapered Gas nozzle $\phi$ 14 mm  |

### Contact Tips

| No. | Part Number | Description                         |
|-----|-------------|-------------------------------------|
| B   | ICU0008-06  | Contact tip $\phi$ 0.6mm 1/4-28 Ecu |
|     | ICU0008-08  | Contact tip $\phi$ 0.8mm 1/4-28 Ecu |
|     | ICU0008-09  | Contact tip $\phi$ 0.9mm 1/4-28 Ecu |
|     | ICU0008-10  | Contact tip $\phi$ 1.0mm 1/4-28 Ecu |
|     | ICU0008-12  | Contact tip $\phi$ 1.2mm 1/4-28 Ecu |
|     | ICU0008-13  | Contact tip $\phi$ 1.3mm 1/4-28 Ecu |
|     | ICU0008-16  | Contact tip $\phi$ 1.6mm 1/4-28 Ecu |
|     | ICU0008-20  | Contact tip $\phi$ 2.0mm 1/4-28 Ecu |
|     | ICU0008-62  | Contact tip $\phi$ 1.2mm 1/4-28 Ecu |
|     | ICU0008-66  | Contact tip $\phi$ 1.6mm 1/4-28 Ecu |

### Liners

| No. | Part Number | Description                |
|-----|-------------|----------------------------|
| C   | IIC0067-03  | Steel liner 3.0m 0.8-0.9mm |

### Components

| No. | Part Number | Description                               |
|-----|-------------|---|
| 1   | ICF0006     | Gas diffuser                              |
| 2   | ICZ0629     | Torch head 45°                            |
| 3   | ICZ0628     | Torch head 60°                            |
| 4   | ITY0072     | Gas Hose Nipple                           |
| 5   | ICG0020     | Adjusting Block Kit Clamp                 |
| 6   | ICV0855-01  | Handle                                    |
| 6.1 | IHJ0672     | Hanger for handle MAXI250 $\phi$ 16       |
| 7   | IHQ0070     | Trigger                                   |
| 8   | IFT0874     | Screw 3.0x10                              |
| 9   | IHJ0777     | Joint with spring                         |
| 10  | ICN0798     | Coaxial cable 3m                          |
| 11  | IFT0897-01  | Spring cable Support                      |
| 12  | IHJ0645     | Back box                                  |
| 13  | IFT0063     | Screw M4x6                                |
| 14  | IHJ0070     | Gun plug nut                              |
| 15  | ITB0038     | Central adaptor TW/Euro M12x1/Spring pins |
| 16  | IZT0072     | Liner nut M11x1                           |
| 17  | ICG6007     | Spanner for Pan torch                     |
| 18  | ICG6000     | Spanner for MIG                           |

# MIG MAXI 350



Rating: Gas Cooled, 400Amp Co., 300mp MIX. wires: 0.8-1.6mm.

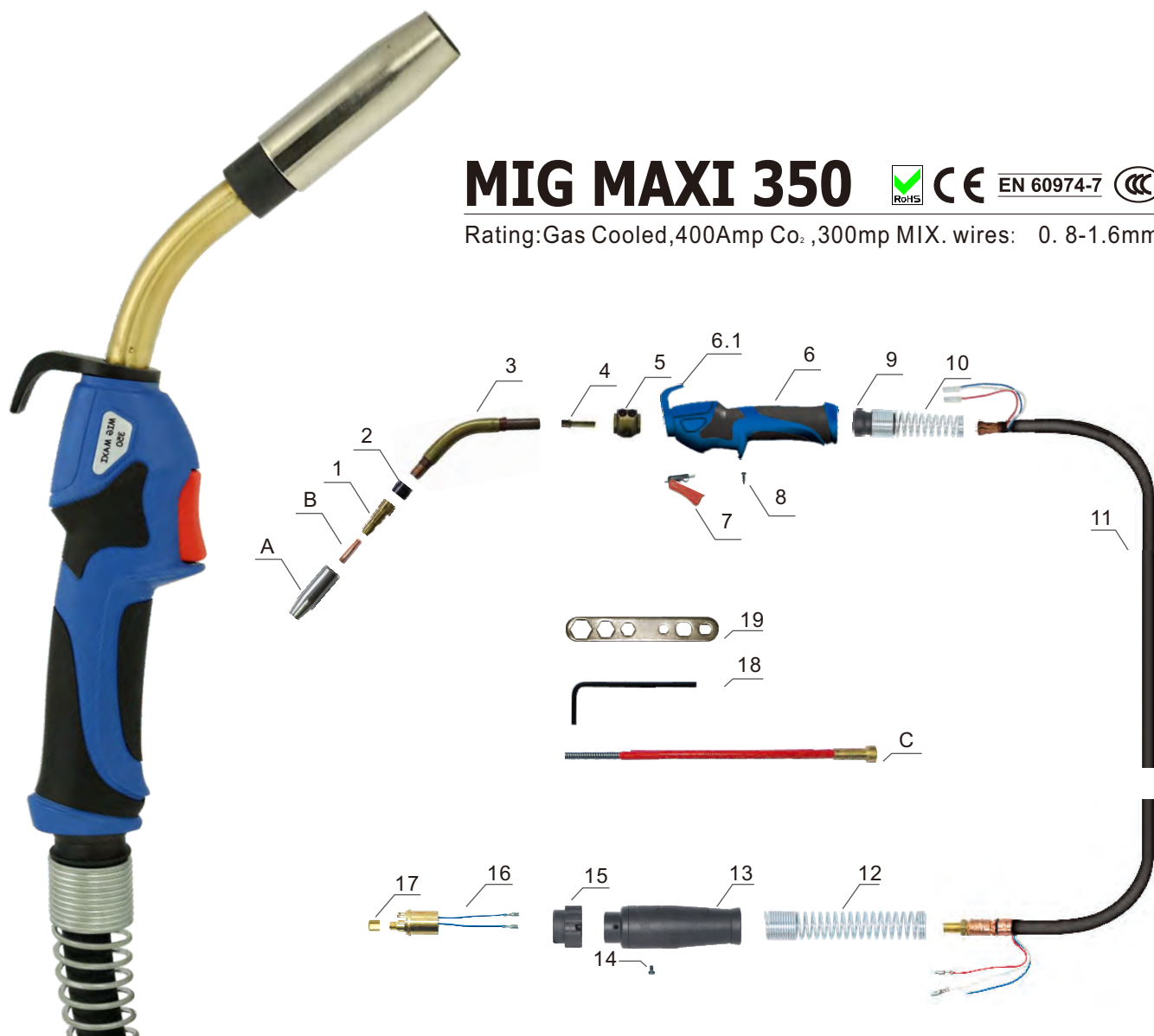

| Model  |             |            |            |
|--|-------------|------------|------------|
| Description                                    | Part Number |            |            |
| MIG MAXI 350 Euro torch<br>TW with spring pins | 3m          | 4m         | 5m         |
|  | ICT1815-36  | ICT1811-36 | ICT1812-36 |

| Nozzles |             |                                  |
|---------|-------------|----------------------------------|
| No.     | Part Number | Description                      |
| A       | ICS0066     | Gas nozzle $\phi$ 16 mm MAXI 350 |
|         | ICS0067     | Gas nozzle $\phi$ 18 mm MAXI 350 |
|         | ICS0068     | Gas nozzle $\phi$ 20 mm MAXI 350 |
|         | ICS0743     | nozzle $\phi$ 14 mm              |

| Contact Tips |             |                                     |
|--------------|-------------|-------------------------------------|
| No.          | Part Number | Description                         |
| B            | ICU0009-09  | Contact tip $\phi$ 0.9mm 1/4-28 Ecu |
|              | ICU0009-10  | Contact tip $\phi$ 1.0mm 1/4-28 Ecu |
|              | ICU0009-12  | Contact tip $\phi$ 1.2mm 1/4-28 Ecu |
|              | ICU0009-13  | Contact tip $\phi$ 1.3mm 1/4-28 Ecu |
|              | ICU0009-16  | Contact tip $\phi$ 1.6mm 1/4-28 Ecu |
|              | ICU0009-20  | Contact tip $\phi$ 2.0mm 1/4-28 Ecu |
|              | ICU0009-62  | Contact tip $\phi$ 1.2mm 1/4-28 Ecu |
|              | ICU0009-66  | Contact tip $\phi$ 1.6mm 1/4-28 Ecu |

| Liners |             |                            |
|--------|-------------|----------------------------|
| No.    | Part Number | Description                |
| C      | IIC0068-06  | Steel liner 3.4m 1.2-1.6mm |

| Components |             |  |
|------------|-------------|--|
| No.        | Part Number | Description  |
| 1          | ICF0008     | Gas diffuser   |
| 2          | ICK0637     | Insulator for Torch head                             |
| 3          | ICZ0792     | Torch head   |
| 4          | ITY0073     | Back fitting coaxial cable                           |
| 5          | ICG0027     | Adjusting Block Kit Clamp                            |
| 6          | ICV0855-01  | Handle   |
| 6.1        | IHJ0670     | Hanger for handle $\phi$ 18                          |
| 7          | IHQ0070     | Trigger  |
| 8          | IFT0874     | Screw 3.0x10   |
| 9          | IHJ0777     | Joint for MIG handle                                 |
| 10         | IFT0876-01  | Spring for cable support/Blue and white zinc plating |
| 11         | ICN0791     | Coaxial cable 3m                                     |
| 12         | IFT0829     | Spring for cable support/Blue and white zinc plating |
| 13         | IHJ0872     | Back box with closing ring                           |
| 14         | IFT0063     | Screw M4x6   |
| 15         | IHJ0070     | Adaptor nut  |
| 16         | ITB0038     | Central adaptor TW/Euro M12x1/Spring pins            |
| 17         | I2T0072     | Liner nut M11x1                                      |
| 18         | ICG6007     | Spanner for pan torch                                |
| 19         | ICG6000     | Spanner for MIG                                      |

# MIG MAXI 450



Rating: Gas Cooled, 500Amp Co., 400mp MIX. wires: 0.8-2.0mm.



| Model  |             |            |            |
|--|-------------|------------|------------|
| Description                                    | Part Number |            |            |
| MIG MAXI 450 Euro torch<br>TW with spring pins | 3m          | 4m         | 5m         |
|  | ICT1915-36  | ICT1911-36 | ICT1912-36 |

| Nozzles |             |                                  |
|---------|-------------|----------------------------------|
| No.     | Part Number | Description                      |
| A       | ICS0066     | Gas nozzle $\phi$ 16 mm MAXI 350 |
|         | ICS0067     | Gas nozzle $\phi$ 18 mm MAXI 350 |
|         | ICS0068     | Gas nozzle $\phi$ 20 mm MAXI 350 |
|         | ICS0743     | nozzle $\phi$ 14 mm              |

| Contact Tips |             |                                       |
|--------------|-------------|---------------------------------------|
| No.          | Part Number | Description                           |
| B            | ICU0005-08  | Contact tip $\phi$ 0.8mm M8x30 Ecu    |
|              | ICU0005-10  | Contact tip $\phi$ 1.0mm M8x30 Ecu    |
|              | ICU0005-12  | Contact tip $\phi$ 1.2mm M8x30 Ecu    |
|              | ICU0005-16  | Contact tip $\phi$ 1.6mm M8x30 Ecu    |
|              | ICU0005-20  | Contact tip $\phi$ 2.0mm M8x30 Ecu    |
|              | ICU0005-24  | Contact tip $\phi$ 2.4mm M8x30 Ecu    |
|              | ICU0005-58  | Contact tip $\phi$ 0.8mm M8x30 CuAl   |
|              | ICU0005-59  | Contact tip $\phi$ 0.9mm M8x30 CuAl   |
|              | ICU0005-60  | Contact tip $\phi$ 1.0mm M8x30 CuAl   |
|              | ICU0005-62  | Contact tip $\phi$ 1.2mm M8x30 CuAl   |
|              | ICU0005-66  | Contact tip $\phi$ 1.6mm M8x30 CuAl   |
|              | ICU0005-70  | Contact tip $\phi$ 2.0mm M8x30 CuAl   |
|              | ICU0005-74  | Contact tip $\phi$ 2.4mm M8x30 CuAl   |
|              | ICU0005-78  | Contact tip $\phi$ 0.8mm M8x30 CuCrZr |
|              | ICU0005-80  | Contact tip $\phi$ 1.0mm M8x30 CuCrZr |
|              | ICU0005-82  | Contact tip $\phi$ 1.2mm M8x30 CuCrZr |

| Liners |             |                            |
|--------|-------------|----------------------------|
| No.    | Part Number | Description                |
| C      | IIC0068-06  | Steel liner 3.4m 1.2-1.6mm |

| Components |             |  |
|------------|-------------|--|
| No.        | Part Number | Description  |
| 1          | ICF0001     | Gas diffuser   |
| 2          | ICK0637     | Insulator for Torch head                             |
| 3          | ICZ0031     | Torch head   |
| 4          | ITY0073     | Back fitting coaxial cable                           |
| 5          | ICG0027     | Adjusting Block Kit Clamp                            |
| 6          | ICV0855-01  | Handle   |
| 6.1        | IHJ0673     | Hanger for handle $\phi$ 20                          |
| 7          | IHQ0070     | Trigger  |
| 8          | IFT0874     | Screw 3.0x10   |
| 9          | IHJ0777     | Joint for MIG handle                                 |
| 10         | IFT0876-01  | Spring for cable support/Blue and white zinc plating |
| 11         | ICN0794     | Coaxial cable 3m                                     |
| 12         | IFT0829     | Spring for cable support/Blue and white zinc plating |
| 13         | IHJ0872     | Back box with closing ring                           |
| 14         | IFT0063     | Screw M4x6   |
| 15         | IHJ0070     | Adaptor nut  |
| 16         | ITB0038     | Central adaptor TW/Euro M12x1/Spring pins            |
| 17         | I2T0072     | Liner nut M11x1                                      |
| 18         | ICG6007     | Spanner for pan torch                                |
| 19         | ICG6000     | Spanner for MIG                                      |

# CONTACT TIPS

SUITABLE FOR BINZEL/PANASONIC

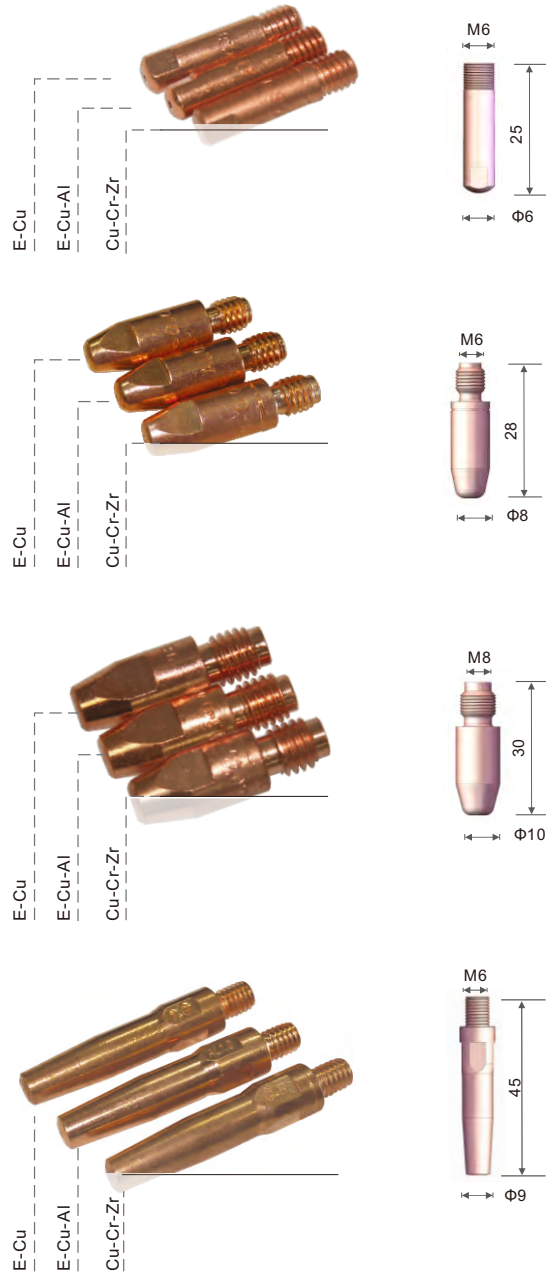

## E-Cu

| Code       | Wire | Code       | Wire | Code       | Wire |
|------------|------|------------|------|------------|------|
| ICU0003-06 | Φ0.6 | ICU0003-58 | Φ0.8 | ICU0003-76 | Φ0.6 |
| ICU0003-08 | Φ0.8 | ICU0003-59 | Φ0.9 | ICU0003-78 | Φ0.8 |
| ICU0003-09 | Φ0.9 | ICU0003-60 | Φ1.0 | ICU0003-80 | Φ1.0 |
| ICU0003-10 | Φ1.0 | ICU0003-62 | Φ1.2 | ICU0003-82 | Φ1.2 |

## E-Cu

| Code       | Wire | Code       | Wire | Code       | Wire |
|------------|------|------------|------|------------|------|
| ICU0004-06 | Φ0.6 | ICU0004-58 | Φ0.8 | ICU0004-78 | Φ0.8 |
| ICU0004-08 | Φ0.8 | ICU0004-59 | Φ0.9 | ICU0004-80 | Φ1.0 |
| ICU0004-10 | Φ1.0 | ICU0004-60 | Φ1.0 | ICU0004-82 | Φ1.2 |
| ICU0004-12 | Φ1.2 | ICU0004-62 | Φ1.2 |            |      |
| ICU0004-16 | Φ1.6 | ICU0004-66 | Φ1.6 |            |      |

## E-Cu

| Code       | Wire | Code       | Wire | Code       | Wire |
|------------|------|------------|------|------------|------|
| ICU0005-08 | Φ0.8 | ICU0005-58 | Φ0.8 | ICU0005-78 | Φ0.8 |
| ICU0005-10 | Φ1.0 | ICU0005-59 | Φ0.9 | ICU0005-80 | Φ1.0 |
| ICU0005-12 | Φ1.2 | ICU0005-60 | Φ1.0 | ICU0005-82 | Φ1.2 |
| ICU0005-16 | Φ1.6 | ICU0005-62 | Φ1.2 | ICU0005-84 | Φ1.4 |
| ICU0005-20 | Φ2.0 | ICU0005-66 | Φ1.6 | ICU0005-86 | Φ1.6 |
| ICU0005-24 | Φ2.4 | ICU0005-70 | Φ2.0 |            |      |
|            |      | ICU0005-74 | Φ2.4 |            |      |

## E-Cu

| Code       | Wire | Code       | Wire | Code        | Wire   |
|------------|------|------------|------|-------------|--------|
| ICU0746-08 | Φ0.8 | ICU0746-60 | Φ1.0 | ICU0746-78  | Φ0.8   |
| ICU0746-10 | Φ1.0 | ICU0746-62 | Φ1.2 | ICU0746-79  | Φ0.9   |
| ICU0746-12 | Φ1.2 | ICU0746-64 | Φ1.4 | ICU0746-80  | Φ1.0   |
| ICU0746-14 | Φ1.4 |            |      | ICU0746-82  | Φ1.2   |
| ICU0746-16 | Φ1.6 |            |      | ICU0746-84  | Φ1.4   |
|            |      |            |      | ICU0746-86  | Φ1.6   |
|            |      |            |      | ICU0746-100 | Φ1.0AL |
|            |      |            |      | ICU0746-102 | Φ1.2AL |



# CONTACT TIPS

SUITABLE FOR TWECO



## E-Cu

| Code       | Wire |
|------------|------|
| ICU0762-06 | Φ0.6 |
| ICU0762-08 | Φ0.8 |
| ICU0762-09 | Φ0.9 |
| ICU0762-10 | Φ1.0 |
| ICU0762-12 | Φ1.2 |

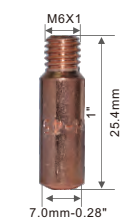

## E-Cu

| Code       | Wire |
|------------|------|
| ICU0763-08 | Φ0.8 |
| ICU0763-09 | Φ0.9 |
| ICU0763-10 | Φ1.0 |
| ICU0763-12 | Φ1.2 |

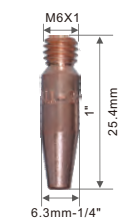

## E-Cu

| Code       | Wire |
|------------|------|
| ICU0764-06 | Φ0.6 |
| ICU0764-08 | Φ0.8 |
| ICU0764-09 | Φ0.9 |
| ICU0764-10 | Φ1.0 |
| ICU0764-12 | Φ1.2 |



## E-Cu

| Code       | Wire |
|------------|------|
| ICU0008-06 | Φ0.6 |
| ICU0008-08 | Φ0.8 |
| ICU0008-09 | Φ0.9 |
| ICU0008-10 | Φ1.0 |
| ICU0008-12 | Φ1.2 |
| ICU0008-13 | Φ1.3 |
| ICU0008-16 | Φ1.6 |
| ICU0008-20 | Φ2.0 |
| ICU0008-62 | Φ1.2 |
| ICU0008-66 | Φ1.6 |

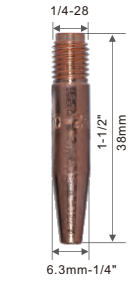

## E-Cu

| Code       | Wire |
|------------|------|
| ICU0768-06 | Φ0.6 |
| ICU0768-08 | Φ0.8 |
| ICU0768-09 | Φ0.9 |
| ICU0768-10 | Φ1.0 |
| ICU0768-12 | Φ1.2 |
| ICU0768-13 | Φ1.3 |
| ICU0768-16 | Φ1.6 |



## E-Cu

| Code       | Wire |
|------------|------|
| ICU0009-09 | Φ0.9 |
| ICU0009-10 | Φ1.0 |
| ICU0009-12 | Φ1.2 |
| ICU0009-13 | Φ1.3 |
| ICU0009-16 | Φ1.6 |
| ICU0009-20 | Φ2.0 |
| ICU0009-62 | Φ1.2 |
| ICU0009-66 | Φ1.6 |



## E-Cu

| Code       | Wire |
|------------|------|
| ICU0761-09 | Φ0.9 |
| ICU0761-10 | Φ1.0 |
| ICU0761-12 | Φ1.2 |
| ICU0761-13 | Φ1.3 |
| ICU0761-16 | Φ1.6 |
| ICU0761-20 | Φ2.0 |

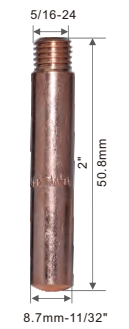

## E-Cu

| Code       | Wire |
|------------|------|
| ICU0060-09 | Φ0.9 |
| ICU0060-12 | Φ1.2 |
| ICU0060-14 | Φ1.4 |
| ICU0060-16 | Φ1.6 |
| ICU0060-20 | Φ2.0 |
| ICU0060-24 | Φ2.4 |
| ICU0060-28 | Φ2.8 |

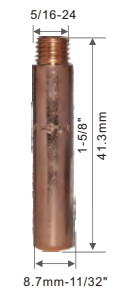

## E-Cu

| Code       | Wire   |
|------------|--------|
| ICU0061-09 | Φ0.9   |
| ICU0061-12 | Φ1.2   |
| ICU0061-13 | Φ1.3   |
| ICU0061-16 | Φ1.6   |
| ICU0061-20 | Φ2.0   |
| ICU0061-24 | Φ2.4   |
| ICU0061-28 | Φ2.8   |
| ICU0061-32 | Φ3.2   |
| ICU0061-62 | Φ1.2AL |
| ICU0061-66 | Φ1.6AL |

BERNARD  
ESAB  
LINCOLN  
MILLER  
SAF  
TREGASKISS  
INTERCHANGEABLE AT REQUEST

# NOZZLES

SUITABLE FOR BINZEL



## MIG 15

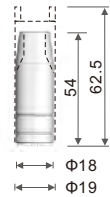

| Code    | Description                     | Pack |
|---------|---------------------------------|------|
| ICS0062 | Gas nozzle Φ 9.5mm;             | 10   |
| ICS0063 | Gas nozzle Φ 12mm;              | 10   |
| ICS0064 | Gas nozzle Φ 16mm;              | 10   |
| ICS0070 | Spot welding gas nozzle Φ 16mm; | 10   |
| ICS0711 | Tapered gas nozzle Φ 13mm;      | 10   |

## MIG 24/240

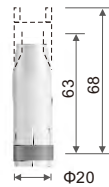

| Code    | Description              | Pack |
|---------|--------------------------|------|
| ICS0800 | Gas nozzle Φ 17mm;       | 10   |
| ICS0806 | Gas nozzle Φ 12.5mm;     | 10   |
| ICS0807 | Gas nozzle Φ 10mm;       | 10   |
| ICS0808 | Spot welding gas nozzle; | 10   |

## MIG 25



| Code    | Description                   | Pack |
|---------|-------------------------------|------|
| ICS0077 | Gas nozzle Φ 11mm;            | 10   |
| ICS0078 | Gas nozzle Φ 15mm;            | 10   |
| ICS0079 | Gas nozzle Φ 18mm;            | 10   |
| ICS0715 | Tapered gas nozzle Φ 11mm;    | 10   |
| ICS0712 | Tapered gas nozzle Φ 14mm;    | 10   |
| ICS0075 | Spot welding gas nozzle 18mm; | 10   |

## MIG 26/400/500



| Code    | Description                     | Pack |
|---------|---------------------------------|------|
| ICS0713 | Gas nozzle Φ 16mm;              | 10   |
| ICS0740 | Gas nozzle Φ 14mm;              | 10   |
| ICS0746 | Gas nozzle Φ 19mm;              | 10   |
| ICS0747 | Adjusted tapered nozzle Φ 15mm; | 10   |
| ICS0748 | Spot welding gas nozzle Φ 20mm; | 10   |

## MIG 36



| Code    | Description                     | Pack |
|---------|---------------------------------|------|
| ICS0071 | Gas nozzle Φ 12mm;              | 10   |
| ICS0072 | Gas nozzle Φ 16mm;              | 10   |
| ICS0073 | Gas nozzle Φ 19mm;              | 10   |
| ICS0660 | Spot welding gas nozzle Φ 20mm; | 10   |

# NOZZLES

SUITABLE FOR BINZEL

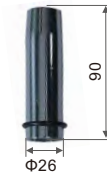

## MIG 40KD

| Code    | Description             | Pack |
|---------|-------------------------|------|
| ICS0700 | Gas nozzle Φ 18mm 40KD; | 10   |
| ICS0701 | Gas nozzle Φ 21mm 40KD; | 10   |
| ICS0702 | Gas nozzle Φ 14mm 40KD; | 10   |

SUITABLE FOR MIG MAXI

| Code    | Description                | Pack |
|---------|----------------------------|------|
| ICS0001 | Gas nozzle Φ 14mm MAXI150; | 10   |
| ICS0002 | Spot Welding Gas Nozzle;   | 10   |
| ICS0005 | Gas nozzle Φ 11mm MAXI150; | 10   |

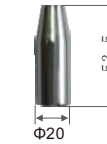

| Code    | Description                | Pack |
|---------|----------------------------|------|
| ICS0003 | Gas nozzle Φ 11mm MAXI250; | 10   |
| ICS0004 | Gas nozzle Φ 14mm MAXI250; | 10   |
| ICS0060 | Gas Nozzle Φ 18mm;         | 10   |
| ICS0673 | Gas nozzle Φ 16mm MAXI250; | 10   |
| ICS0674 | Tapered Gas Nozzle Φ 14mm; | 10   |



| Code    | Description                | Pack |
|---------|----------------------------|------|
| ICS0066 | Gas nozzle Φ 16mm MAXI350; | 10   |
| ICS0067 | Gas nozzle Φ 18mm MAXI350; | 10   |
| ICS0068 | Gas nozzle Φ 20mm MAXI350; | 10   |
| ICS0743 | Nozzle Φ 14mm ;            | 10   |



# TW TYPE NOZZLES

SUITABLE FOR TWECO



| Type    | Image   | Code                               | Description                 |
|---------|---------|------------------------------------|-----------------------------|
| TW2-TW4 |         | ICS0577                            | Gas nozzle 3/8" (Φ9.5mm) ;  |
|         |         | ICS0084                            | Gas nozzle 1/2" (Φ12.7mm) ; |
|         |         | ICS0090                            | Gas nozzle 5/8" (Φ16mm) ;   |
|         |         | ICS0096                            | Gas nozzle 3/4" (Φ19mm) ;   |
|         |         | ICS0792                            | Gas nozzle 3/8" (Φ9.5mm) ;  |
|         |         | ICS0773                            | Gas nozzle 1/2" (Φ12.7mm) ; |
|         |         | ICS0774                            | Gas nozzle 5/8" (Φ16mm) ;   |
|         |         | ICS0780                            | Gas nozzle 3/4" (Φ19mm) ;   |
|         |         | ICS0786                            | Gas nozzle 5/8" (Φ16mm) ;   |
|         |         | ICS0787                            | Gas nozzle 3/4" (Φ19mm) ;   |
|         |         | ICS0575                            | Gas nozzle 3/4" (Φ19mm) ;   |
|         |         | ICS0578                            | Gas nozzle 1/2" (Φ12.7mm) ; |
|         | ICS0579 | Gas nozzle 5/8" (Φ16mm) ;          |                             |
|         | ICS0571 | Gas nozzle 5/8" (Φ16mm) L=52.3mm ; |                             |
|         | ICS0572 | Gas nozzle 5/8" (Φ16mm) L=39mm ;   |                             |

| Type | Image | Code    | Description                 |
|------|-------|---------|-----------------------------|
| TW5  |       | ICS0730 | Gas nozzle 1/2" (Φ12.7mm) ; |
|      |       | ICS0736 | Gas nozzle 3/4" (Φ19mm) ;   |
|      |       | ICS0737 | Gas nozzle 5/8" (Φ16mm) ;   |

| Type    | Image | Code    | Description     |
|---------|-------|---------|-----------------|
| TW2     |       | ICK0680 | Insulator 32;   |
| TW3-TW4 |       | ICK0686 | Insulator 34A;  |
| TW2-TW4 |       | ICS0085 | Insulator 34CT; |
|         |       | ICS0739 | Insulator 34FN; |
| TW5     |       | ICS0738 | Insulator 35CT; |



# TW TYPE NOZZLES

SUITABLE FOR TWECO



| Type | Image   | Code                       | Description                |
|------|---------|----------------------------|----------------------------|
| TW1  |         | ICS0080                    | Gas Nozzle 3/8" Φ 9.5mm ;  |
|      |         | ICS0086                    | Gas Nozzle 1/2" Φ 12.5mm ; |
|      |         | ICS0087                    | Gas Nozzle 5/8" Φ 16mm ;   |
|      |         | ICS0500                    | Gas nozzle 3/8" Φ 9.5mm ;  |
|      |         | ICS0506                    | Gas nozzle 3/8" Φ 9.5mm ;  |
|      |         | ICS0507                    | Gas nozzle 3/8" Φ 9.5mm ;  |
|      | ICS0971 | Gas nozzle 1/2" Φ 12.5mm ; |                            |
|      | ICS0972 | Gas nozzle 5/8" Φ 16 ;     |                            |

| Type | Image   | Code                        | Description                 |
|------|---------|-----------------------------|-----------------------------|
| TW2  |         | ICS0785                     | Gas nozzle 5/8" Φ 16mm;     |
|      |         | ICS0788                     | Gas nozzle 3/8" (Φ 9.5mm) ; |
|      |         | ICS0789                     | Gas nozzle 1/2" Φ 12.5mm;   |
|      |         | ICS0509                     | Gas nozzle 3/8" (Φ 9.5mm) ; |
|      |         | ICS0501                     | Gas nozzle 1/2" (Φ12.5mm) ; |
|      | ICS0502 | Gas nozzle 5/8" (Φ16mm) ;   |                             |
|      | ICS0505 | Gas nozzle 3/8" (Φ 9.5mm) ; |                             |

| Type    | Image   | Code                        | Description                 |
|---------|---------|-----------------------------|-----------------------------|
| TW2-TW4 |         | ICS0097                     | Gas nozzle 3/8" Φ 9.5mm;    |
|         |         | ICS0098                     | Gas nozzle 1/2" Φ 12.5mm;   |
|         |         | ICS0099                     | Gas nozzle 5/8" Φ 16mm;     |
|         |         | ICS0698                     | Gas nozzle 3/4" Φ 19mm;     |
|         |         | ICS0797                     | Gas nozzle ;                |
|         |         | ICS0798                     | Gas nozzle ;                |
|         |         | ICS0799                     | Gas nozzle ;                |
|         |         | ICS0795                     | Gas nozzle 3/4" (Φ19mm) ;   |
|         |         | ICS0503                     | Gas nozzle 1/2" (Φ12.5mm) ; |
|         |         | ICS0504                     | Gas nozzle 5/8" (Φ16mm) ;   |
|         |         | ICS0500                     | Gas nozzle 3/8" (Φ9.5mm) ;  |
|         |         | ICS0566                     | Gas nozzle 3/8" (Φ9.5mm);   |
|         |         | ICS0567                     | Gas nozzle 3/8" (Φ9.5mm) ;  |
|         |         | ICS0695                     | Gas nozzle 1/2" Φ 12.5mm;   |
|         |         | ICS0691                     | Gas nozzle 5/8" Φ 16mm;     |
|         |         | ICS0692                     | Gas nozzle 3/4" Φ 19mm;     |
|         |         | ICS0568                     | Gas nozzle 3/8" (Φ9.5mm) ;  |
|         |         | ICS0569                     | Gas nozzle 1/2" (Φ12.5mm) ; |
|         | ICS0565 | Gas nozzle 5/8" (Φ16mm) ;   |                             |
|         | ICS0561 | Gas nozzle 3/4" (Φ19mm) ;   |                             |
|         | ICS0562 | Gas nozzle 1/2" (Φ12.5mm) ; |                             |
|         | ICS0563 | Gas nozzle 5/8" (Φ16mm) ;   |                             |
|         | ICS0564 | Gas nozzle 3/4" (Φ19mm) ;   |                             |
|         | ICS0570 | Gas nozzle 5/8" (Φ16mm) ;   |                             |
|         | ICS0576 | Gas nozzle 3/4" (Φ19mm) ;   |                             |



# DIFFUSERS AND TIP HOLDERS

SUITABLE FOR BINZEL



## MIG 24/240

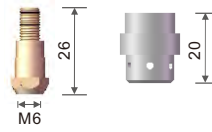

| Code      | Description                 |
|-----------|-----------------------------|
| ○ ICF0039 | White plastic gas diffuser; |
| ○ ICF0539 | White ceramic gas diffuser; |
| ● ICU0683 | Contact tip holder ;        |
| ICU0684   | Contact tip holder ;        |
| ● ICF0839 | Red silicon gas diffuser;   |

## MIG 25

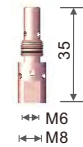

| Code      | Description           |
|-----------|-----------------------|
| ● ICF0061 | Gas diffuser M6x35mm; |
| ● ICF0090 | Gas diffuser M8x35mm; |

## MIG 26

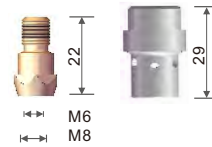

| Code      | Description                 |
|-----------|-----------------------------|
| ● ICU0016 | Contact tip holder M6x22mm; |
| ● ICU0017 | Contact tip holder M8x22mm; |
| ○ ICF0035 | White plastic gas diffuser; |
| ○ ICF0535 | White ceramic gas diffuser; |
| ● ICF0935 | Black plastic gas diffuser; |

## MIG 36

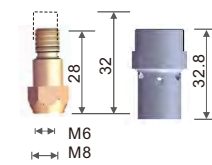

| Code      | Description                 |
|-----------|-----------------------------|
| ○ ICF0062 | White plastic gas diffuser; |
| ● ICF0096 | Black plastic gas diffuser; |
| ○ ICF0562 | White ceramic gas diffuser; |
| ● ICU0018 | Contact tip holder M6x28mm; |
| ● ICU0019 | Contact tip holder M8x28mm; |
| ● ICU0686 | Contact tip holder M6x32mm; |
| ● ICU0687 | Contact tip holder M8x32mm; |

## MIG 40KD

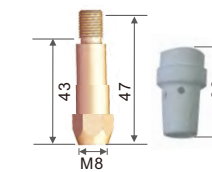

| Code      | Description                      |
|-----------|----------------------------------|
| ● ICU0026 | Contact tip holder 40KD/M8/43mm; |
| ● ICU0027 | Contact tip holder 40KD/M8/47mm; |
| ○ ICF0097 | White plastic gas diffuser 40KD; |
| ○ ICF0531 | White ceramic gas diffuser 40KD; |

# DIFFUSERS AND TIP HOLDERS

SUITABLE FOR BINZEL



## MIG 400/500

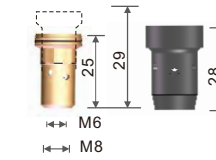

| Code      | Description                        |
|-----------|------------------------------------|
| ● ICF0021 | Contact tip holder M8x25mm;        |
| ○ ICF0024 | White plastic gas diffuser;        |
| ● ICF0029 | Black plastic gas diffuser;        |
| ● ICF0036 | Contact tip holder M6x25mm;        |
| ● ICF0037 | Contact tip holder M6x29mm;        |
| ● ICF0038 | Contact tip holder M8x29mm;        |
| ○ ICF0524 | White ceramic gas diffuser;        |
| ● ICF0840 | Contact tip holder M8x25mm/COPPER; |
| ● ICF0846 | Contact tip holder M8x29mm/COPPER; |

SUITABLE FOR TWECO



| Type    | Image | Code    | Description                                       |
|---------|-------|---------|---|
| TW1     |       | ICF0063 | Diffuser ;  |
| TW2     |       | ICF0077 | Diffuser ;<br>(used with 32 insulator)            |
|         |       | ICF0073 | Diffuser ;<br>(used with 23series nozzles or 34A) |
|         |       | ICF0064 | Diffuser ;  |
| TW3-TW4 |       | ICF0070 | Diffuser ;  |
| TW5     |       | ICF0076 | Diffuser ;  |
|         |       | ICF0071 | Diffuser ;  |
|         |       | ICF0072 | Diffuser ;  |

# LINERS

SUITABLE FOR BINZEL



## EURO-TYPE / STEEL

### Blue $\Phi$ 0.6-0.8mm

Insulation steel liner Blue  $\Phi$ 1.4x4.0x4.6mm

| L    | Code    | Pack |
|------|---------|------|
| 3.4m | IIC0500 | 1    |
| 4.4m | IIC0506 | 1    |
| 5.4m | IIC0507 | 1    |
| 500m | IIC0065 | 1    |

### Yellow $\Phi$ 1.2-1.6mm (flat)

Insulation steel liner Yellow  $\Phi$ 2.4x4.2x4.7mm

| L    | Code    | Pack |
|------|---------|------|
| 3.4m | IIC0590 | 1    |
| 4.4m | IIC0596 | 1    |
| 5.4m | IIC0597 | 1    |
| 500m | IIC0017 | 1    |

### $\Phi$ 0.8-1.0mm

Steel liner  $\Phi$ 1.4x4.5mm

| L    | Code    | Pack |
|------|---------|------|
| 3.5m | IIC0577 | 1    |
| 4.5m | IIC0578 | 1    |
| 5.5m | IIC0579 | 1    |
| 500m | IIC0025 | 1    |

### $\Phi$ 1.2-1.6mm

Steel liner  $\Phi$ 2.5x4.5mm

| L    | Code    | Pack |
|------|---------|------|
| 3.5m | IIC0580 | 1    |
| 4.5m | IIC0586 | 1    |
| 5.5m | IIC0587 | 1    |
| 500m | IIC0016 | 1    |

## EURO-TYPE / TEFLON

### Blue $\Phi$ 0.6-0.9mm

Teflon liner  $\Phi$ 1.5x4mm

| L    | Code    | Pack |
|------|---------|------|
| 3.5m | IIC0100 | 1    |
| 4.5m | IIC0106 | 1    |
| 5.5m | IIC0107 | 1    |
| 200m | IIC0070 | 1    |

### Red $\Phi$ 1.0-1.2mm

Insulation steel liner Red  $\Phi$ 2x4.0x4.6mm

| L    | Code    | Pack |
|------|---------|------|
| 3.4m | IIC0560 | 1    |
| 4.4m | IIC0566 | 1    |
| 5.4m | IIC0567 | 1    |
| 500m | IIC0018 | 1    |

### Yellow $\Phi$ 1.2-1.6mm (rounded)

Insulation steel liner Yellow  $\Phi$ 2.5x4.5x4.7mm

| L    | Code    | Pack |
|------|---------|------|
| 3.4m | IIC0550 | 1    |
| 4.4m | IIC0556 | 1    |
| 5.4m | IIC0557 | 1    |
| 500m | IIC0012 | 1    |

### $\Phi$ 1.0-1.2mm

Steel liner  $\Phi$ 2.0x4.5mm

| L    | Code    | Pack |
|------|---------|------|
| 3.5m | IIC0571 | 1    |
| 4.5m | IIC0572 | 1    |
| 5.5m | IIC0573 | 1    |
| 500m | IIC0019 | 1    |

### Red $\Phi$ 1.0-1.2mm

红色特氟龙送丝管

Teflon liner  $\Phi$ 2x4mm

| L    | Code    | Pack |
|------|---------|------|
| 3.5m | IIC0160 | 1    |
| 4.5m | IIC0166 | 1    |
| 5.5m | IIC0167 | 1    |
| 200m | IIC0064 | 1    |



# LINERS

SUITABLE FOR BINZEL



## EURO-TYPE / TEFLON

### Yellow $\Phi$ 1.2-1.6mm

Teflon liner  $\Phi$  3.8x4.5mm

| L    | Code    | Pack |
|------|---------|------|
| 3.5m | IIC0210 | 1    |
| 4.5m | IIC0216 | 1    |
| 5.5m | IIC0217 | 1    |
| 200m | IIC0077 | 1    |

### Blue $\Phi$ 0.6-0.9mm

Teflon liner  $\Phi$  4.0x1.5mm+terminator

| L    | Code    | Pack |
|------|---------|------|
| 3.5m | IIC0260 | 1    |
| 4.5m | IIC0266 | 1    |
| 5.5m | IIC0267 | 1    |

## EURO-TYPE / GRAPHITE

### $\Phi$ 1.0-1.2mm

Graphite liners  $\Phi$  4.8x2.0mm+Terminator

| L    | Code    | Pack |
|------|---------|------|
| 3.5m | IIC0275 | 1    |
| 4.5m | IIC0271 | 1    |
| 5.5m | IIC0272 | 1    |
| 200m | IIC0088 | 1    |

### $\Phi$ 1.2-1.6mm

Graphite liners  $\Phi$ 4.7x2.7mm

| L    | Code    | Pack |
|------|---------|------|
| 200m | IIC0059 | 1    |

SUITABLE FOR PAN

## PAN-TYPE

### Black $\Phi$ 0.8-1.0mm

Insulation steel liner  $\Phi$  1.8x4.2x5.0mm

| L    | Code    | Pack |
|------|---------|------|
| 3.1m | IIC0551 | 1    |
| 4.1m | IIC0552 | 1    |
| 5.1m | IIC0553 | 1    |
| 500m | IIC0010 | 1    |

### Black $\Phi$ 1.2-1.6mm

Insulation steel liner  $\Phi$  2x5x5.6mm

| L    | Code    | Pack |
|------|---------|------|
| 3.5m | IIC0518 | 1    |
| 4.5m | IIC0519 | 1    |
| 5.5m | IIC0515 | 1    |
| 500m | IIC0061 | 1    |

### Red $\Phi$ 1.0-1.2mm

Teflon liner  $\Phi$  2.8x4.0mm+terminator

| L    | Code    | Pack |
|------|---------|------|
| 3.5m | IIC0265 | 1    |
| 4.5m | IIC0261 | 1    |
| 5.5m | IIC0262 | 1    |

### Yellow $\Phi$ 1.2-1.6mm

Teflon liner  $\Phi$  3.8x4.5mm+terminator

| L    | Code    | Pack |
|------|---------|------|
| 3.5m | IIC0280 | 1    |
| 4.5m | IIC0286 | 1    |
| 5.5m | IIC0287 | 1    |

### $\Phi$ 1.2-1.6mm

Graphite liners  $\Phi$ 4.5x2.7mm+Terminator

| L    | Code    | Pack |
|------|---------|------|
| 3.5m | IIC0291 | 1    |
| 4.5m | IIC0292 | 1    |
| 5.5m | IIC0293 | 1    |
| 200m | IIC0089 | 1    |

### Green $\Phi$ 1.0-1.2mm

Insulation steel liner  $\Phi$  1.8x4.6x5.2mm

| L    | Code    | Pack |
|------|---------|------|
| 3.5m | IIC0510 | 1    |
| 4.5m | IIC0516 | 1    |
| 5.5m | IIC0517 | 1    |
| 500m | IIC0051 | 1    |



# LINERS

SUITABLE FOR BINZEL

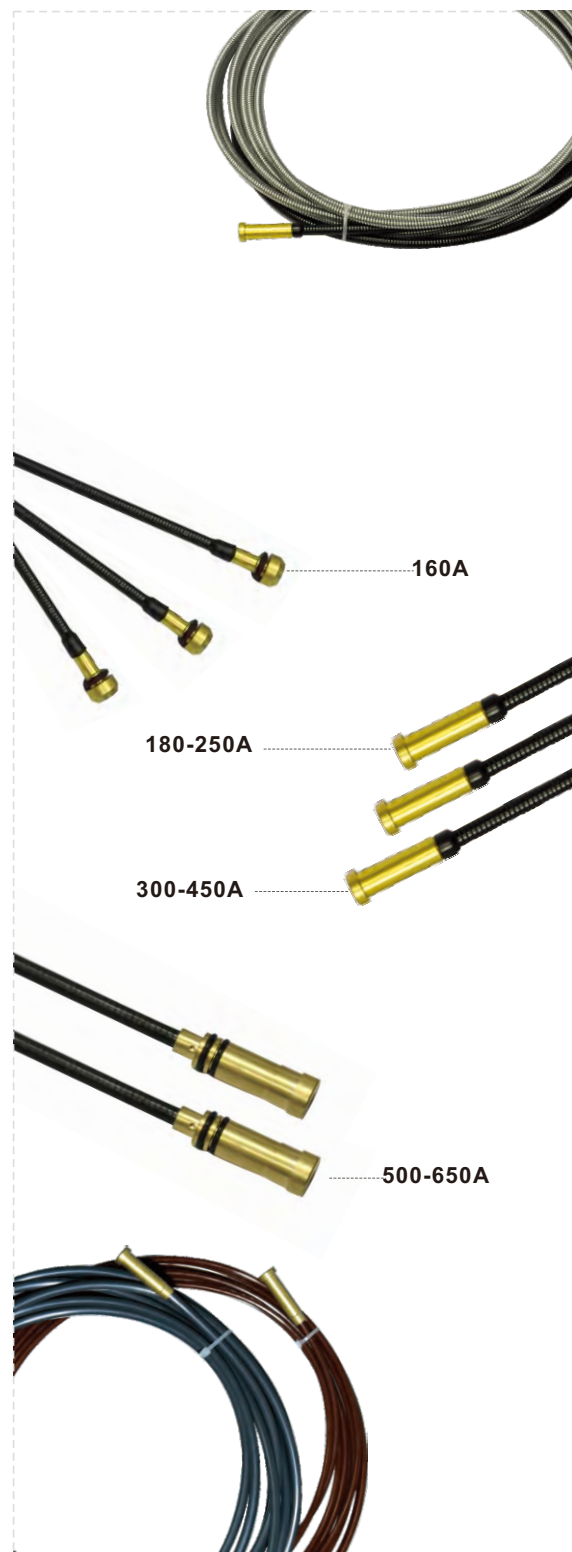

| Amp      | L(in/m)   | Code       | Wire                   | Pack |
|----------|-----------|------------|------------------------|------|
| 160A     | 15"(4.6m) | IIC0743    | 0.23"(0.6)             | 1    |
|          | 15"(4.6m) | IIC0744    | 0.030"-0.035"(0.8-0.9) | 1    |
|          | 15"(4.6m) | IIC0004    | 0.040"-0.045"(1.0-1.2) | 1    |
| 180-250A | 15"(4.6m) | IIC0800    | 0.23"(0.6)             | 1    |
|          | 11"(3.4m) | IIC0066-03 | 0.030"-0.035"(0.8-0.9) | 1    |
|          | 15"(4.6m) | IIC0066    | 0.030"-0.035"(0.8-0.9) | 1    |
| 300-450A | 11"(3.4m) | IIC0067-03 | 0.035"-0.045"(0.9-1.2) | 1    |
|          | 15"(4.6m) | IIC0771    | 0.035"-0.045"(0.9-1.2) | 1    |
|          | 11"(3.4m) | IIC0068-03 | 0.052"-1/16"(1.3-1.6)  | 1    |
|          | 15"(4.6m) | IIC0068    | 0.052"-1/16"(1.3-1.6)  | 1    |
|          | 11"(3.4m) | IIC0776-03 | 5/64"(2.0)             | 1    |
|          | 15"(4.6m) | IIC0776    | 5/64"(2.0)             | 1    |
| 500-650A | 15"(4.6m) | IIC0866    | 3/32"(2.4)             | 1    |
|          | 15"(4.6m) | IIC0071    | 0.035"-0.045"(0.9-1.2) | 1    |
|          | 15"(4.6m) | IIC0072    | 0.052"-1/16"(1.3-1.6)  | 1    |
|          | 15"(4.6m) | IIC0073    | 5/64"(2.0)             | 1    |

| Amp      | L(in/m)   | Code    | Wire                   | Pack |
|----------|-----------|---------|------------------------|------|
| 160A     | 10"(3m)   | IIC0980 | 0.030"-0.035"(0.8-0.9) | 1    |
|          | 10"(3m)   | IIC0986 | 0.040"-3/64"(1.0-1.2)  | 1    |
| 180-250A | 15"(4.6m) | IIC0987 | 0.036"-3/64"(0.8-1.2)  | 1    |
|          | 15"(4.6m) | IIC0988 | 0.036"-3/64"(0.8-1.2)  | 1    |
| 300-450A | 15"(4.6m) | IIC0989 | 1/16"(1.6)             | 1    |
|          | 15"(4.6m) | IIC0256 | 0.030"-3/64"(0.8-1.2)  | 1    |
|          | 15"(4.6m) | IIC0989 | 1/16"(1.6)             | 1    |

# COMPLETE CABLES



## EURO TYPE

| 15AK |         |      | 24-25KD |         |      |
|------|---------|------|---------|---------|------|
| L    | Code    | Pack | L       | Code    | Pack |
| 3m   | ICN0663 | 1    | 3m      | ICN0664 | 1    |
| 4m   | ICN0676 | 1    | 4m      | ICN0679 | 1    |
| 5m   | ICN0677 | 1    | 5m      | ICN0675 | 1    |

| 26KD |         |      | 36KD |         |      |
|------|---------|------|------|---------|------|
| L    | Code    | Pack | L    | Code    | Pack |
| 3m   | ICN0696 | 1    | 3m   | ICN0670 | 1    |
| 4m   | ICN0697 | 1    | 4m   | ICN0672 | 1    |
| 5m   | ICN0699 | 1    | 5m   | ICN0673 | 1    |

| 40KD |         |      |
|------|---------|------|
| L    | Code    | Pack |
| 3m   | ICN0619 | 1    |
| 4m   | ICN0615 | 1    |
| 5m   | ICN0611 | 1    |

## PAN TYPE

| PAN180 |         |      | PAN350 |         |      |
|--------|---------|------|--------|---------|------|
| L      | Code    | Pack | L      | Code    | Pack |
| 3m     | ICN0110 | 1    | 3m     | ICN0188 | 1    |
| 4m     | ICN0116 | 1    | 4m     | ICN0189 | 1    |
| 5m     | ICN0117 | 1    | 5m     | ICN0185 | 1    |

| EURO TYPE |         |      | Water cooled cable 240/400/500 |         |      |
|-----------|---------|------|--------------------------------|---------|------|
| L         | Code    | Pack | L                              | Code    | Pack |
| 3m        | ICN0180 | 1    | 3m                             | ICD0067 | 1    |
| 4m        | ICN0186 | 1    | 4m                             | ICD0068 | 1    |
| 5m        | ICN0187 | 1    | 5m                             | ICD0069 | 1    |

| Power cable |         |      | Gas tube |         |      |
|-------------|---------|------|----------|---------|------|
| L           | Code    | Pack | L        | Code    | Pack |
| 3m          | IKT0064 | 1    | 3m       | IKH0030 | 1    |
| 4m          | IKT0070 | 1    | 4m       | IKH0036 | 1    |
| 5m          | IKT0076 | 1    | 5m       | IKH0037 | 1    |

| Wire conduit |         |      | Control wire |            |      |
|--------------|---------|------|--------------|------------|------|
| L            | Code    | Pack | L            | Code Ref.  | Pack |
| 3m           | IKH0027 | 1    | 3m           | IHQ0690-03 | 1    |
| 4m           | IKH0028 | 1    | 4m           | IHQ0690-04 | 1    |
| 5m           | IKH0029 | 1    | 5m           | IHQ0690-05 | 1    |

| Water inlet tube |         |      | Rubber tube |           |      |
|------------------|---------|------|-------------|-----------|------|
| L                | Code    | Pack | L           | Code Ref. | Pack |
| 3m               | IKH0021 | 1    | 3m          | ICK0705   | 1    |
| 4m               | IKH0022 | 1    | 4m          | ICK0701   | 1    |
| 5m               | IKH0023 | 1    | 5m          | ICK0702   | 1    |

# CENTRAL ADAPTORS

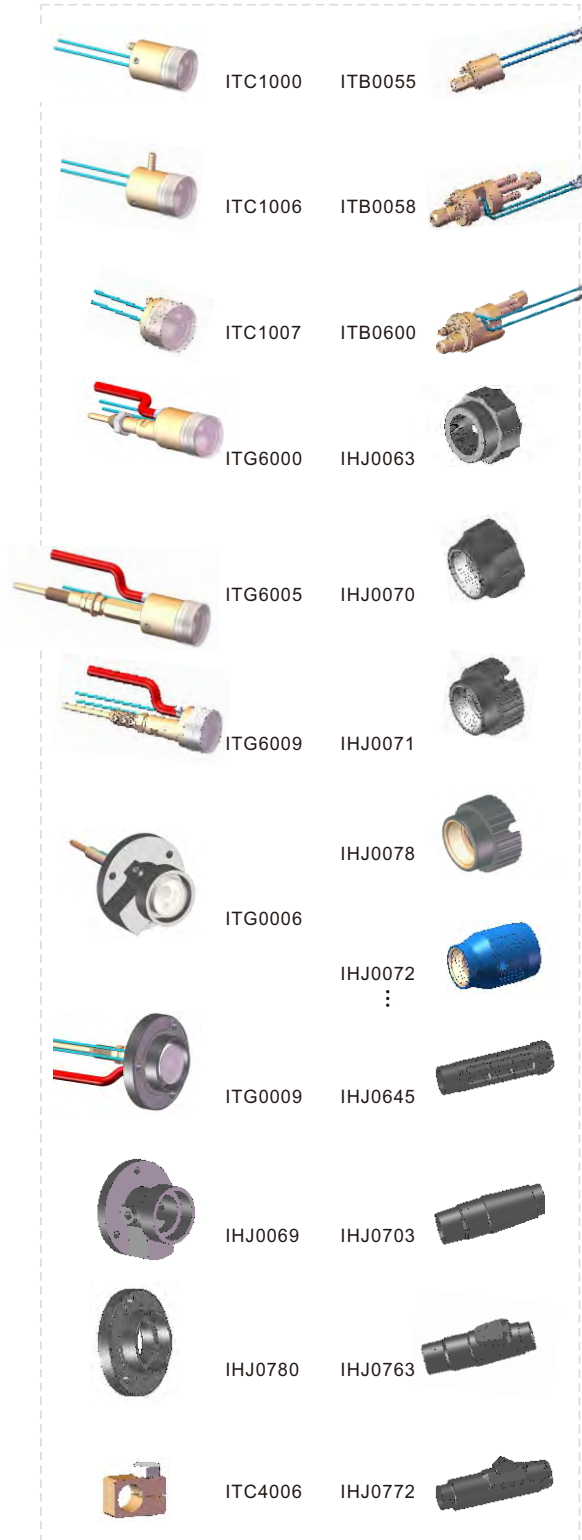

| Code    | Description   |
|---------|---|
| ITB0055 | Euro central adaptor body/spring pins/with Nut;       |
| ITB0058 | Water euro central adaptor body/spring pins/with Nut; |
| ITB0600 | Euro central adaptor/water/tynos/spring pin;          |
| ITC1000 | Euro central adaptor femaler/machine side-axial;      |
| ITC1006 | Euro central adaptor femaler radial;                  |
| ITC1007 | Mini euro central adaptor fdmale-axial;               |
| ITC4006 | Current clamp 16mm;                                   |
| ITG0006 | Central adaptor female machine side;                  |
| ITG0009 | Mini central adaptor female machine side;             |
| ITG6000 | Euro central adaptor female machine side;             |
| ITG6005 | Euro central adaptor female machine side;             |
| ITG6009 | Mini euro central adaptor female machine side;        |
| IHJ0063 | Gun plug nut/plastic nut;                             |
| IHJ0069 | Plastic housing;                                      |
| IHJ0070 | Gun plug nut;   |
| IHJ0071 | Gun plug nut BZ type;                                 |
| IHJ0072 | Gun plug nut new blue;                                |
| IHJ0073 | Gun plug nut new red;                                 |
| IHJ0074 | Gun plug nut new orange;                              |
| IHJ0078 | Gun plug nut/BZ type/brass screw;                     |
| IHJ0645 | Back box hole;  |
| IHJ0703 | Back box hole;  |
| IHJ0763 | Back box hole/water;                                  |
| IHJ0780 | Plastic housing/MINI;                                 |
| IHJ0772 | Back box hole/water;                                  |
| IHQ0200 | Spring pin with wire and insulator for air cooling;   |
| IHQ0207 | Spring pin with wire and insulator for water cooling; |
| IHQ0778 | Control wire with pin/0.5mm <sup>2</sup> /800mm;      |
| IKH0070 | Blue wired hose Φ 5×8mm;                              |
| IKH0075 | Red wired hose Φ 5×8mm;                               |
| IKH0062 | Black wired hose Φ 5×8mm;                             |
| IKH0087 | PU tube Φ 6×8mm/high temprature;                      |
| IFT0723 | Clamp Φ 7.0mm;  |
| IFT0734 | Clamp Φ 8.7mm;  |
| IFT0735 | Clamp Φ 10.5mm;                                       |
| IFT0737 | Clamp Φ 9.5mm;  |



more clamps at request