

Thank you for purchasing the world's first invention of Bluetooth Barbecue Probe. It enables Bluetooth wireless connection between the probe and the smart phone. You only need to download the APP "Grill ProbeE" to monitor if the food is cooked well. Once the grilled food reaches the preset temperature, it will automatically alarm to make your grilling process much easier.

## 1 Appearance

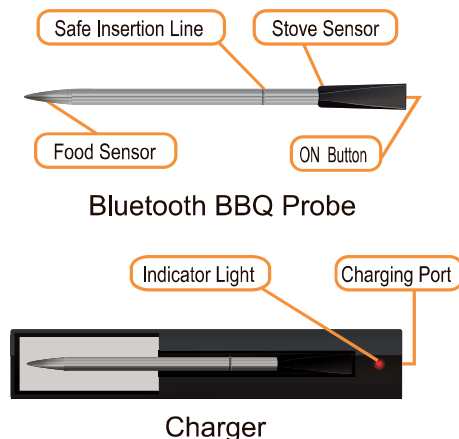

## 2 Features

- Stainless steel structured. The probe can monitor temperature of both the food and oven.
- Support BLE4.0 with transmission distance of 10 meters
- Tracking temperature by Grill ProbeE APP
- Allow 3 preset grilled modes: Recipes, Target Temperature or Timer
- Support 4 probes to be operated at the same time
- Food temperature measurement range: 0~85°C
- Internal temperature measurement range of oven: 0~275°C
- Fast charge for 5 minutes and the probe can be operated for 4 hours

## 3 Using the probe

### 1) Download APP



Scan the QR Code or download the Grill ProbeE App available on App Store (for IOS) or Google Play Store (for Android)

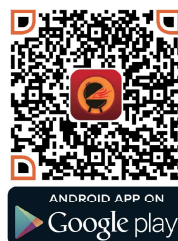

### 2) Charges probe

- Keep the probe in the charger before use or the battery is low.
- The external power supply is connected to the USB. Red Light on indicates charging in progress. Each charging requires about 5 minutes.

### 3) Insert probe into food

Insert the probe into the food to be grilled.  
Note: The insertion depth must beyond the safe insertion line as shown below.

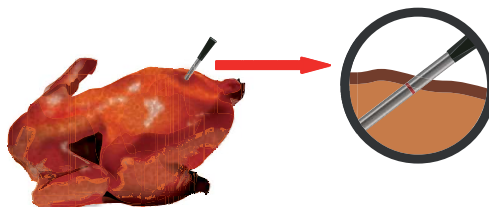

## 4 APP operation

### 1) APP Interface

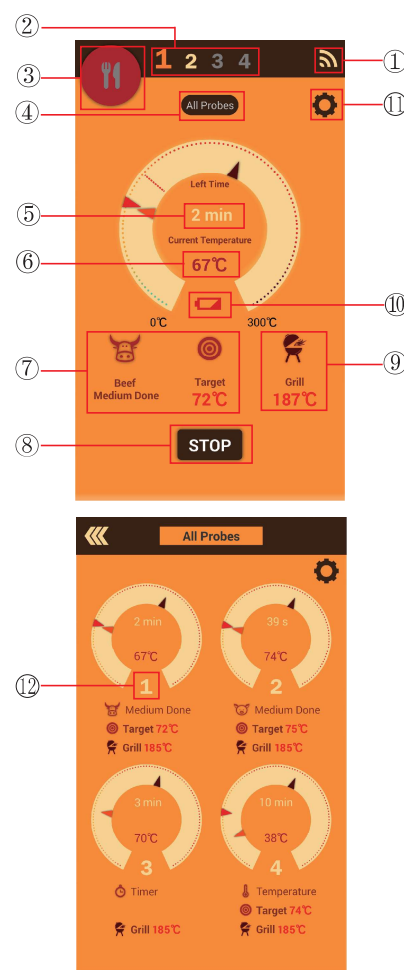

## Quick Start Guide

- ⑤ Time left
- ⑥ Food temperature
- ⑦ Barbecue mode
- ⑧ Start / Stop, click to start / stop the barbecue process
- ⑨ Oven temperature
- ⑩ Low battery alarm, need to recharge the probe
- ⑪ System setting interface
- ⑫ Click to view a single probe barbecue

### 2) Connect the bluetooth

Download & Open the App Grill ProbeE. Press the "ON" button at the top of the probe followed by clicking "ON" in the top right corner of the screen. Then, select the probe from the list. Bluetooth connection is connected when the screen shows "ON" and show the channel number.

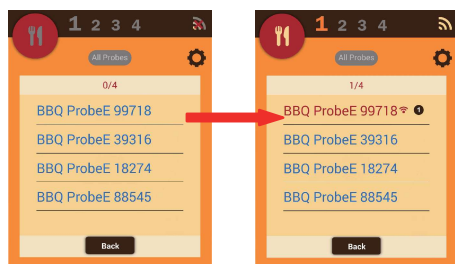

**Note:** Support maximum to 4 probes, can be operate at the same time.

### 3) Disconnect the bluetooth

Click "OFF" in the top right corner of the screen. Then, Select the connected probe and click "Y" to disconnect Bluetooth connection.

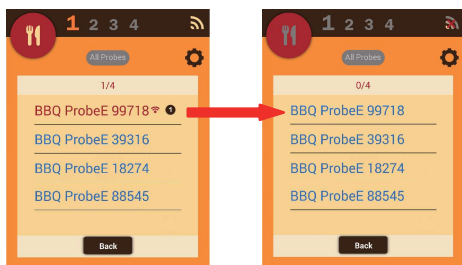

### 4) System Settings

Temperature Unit: Celsius / Fahrenheit  
Alarm Type: Ring, Vibration, Ring & Vibration

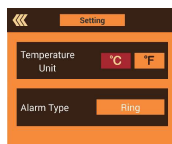

### 5) Barbecue mode setting

Three barbecue modes: Recipe, Timer, Temperature.  
Press "START" to start barbecue process.

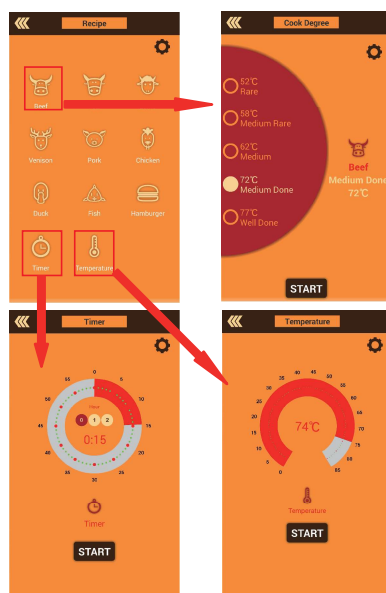

**Note:** Each barbecue probe are independent of each other, user must set barbecue mode each probe individually.

### 5) Alarm

#### 1) Barbecue alarm

When the grill food reaches the preset temperature, the smartphone will alarm you the end of grilling

process. At that time, please take out the food & remove the probe from the oven immediately.

#### 2) Bluetooth disconnection alarm

When the Bluetooth connection between the smartphone and the probe is interrupted, an alarm message will pop up to remind you to keep the smartphone closer to the probe within 2 minutes so not affect your grilling process.

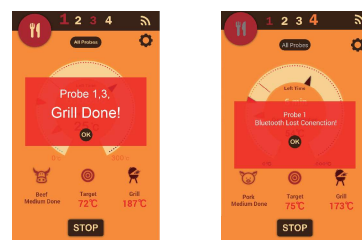

### 6) Using the sealing cap

- When the barbecue is smoky, please put on the sealing cap on top of probe handle.
- After the top of probe handle is put on the sealing cap, it can be cleaned under water.



### 7) Attention

- When the probe stays away from the mobile phone or the oven temperature is below 50°C for ten minutes, the probe will automatically turn off. Please press "ON" button to restart the Bluetooth connection.
- The communication distance is limited to 1 meter when the probe is inside a metal shielded oven.
- Do not put probes without food into the barbecue oven.
- Barbecue food should be lower than 85°C. Oven temperature should be lower than 275°C. If exceed this limit, the probe will be permanently damaged. When this happens, the user should quickly remove the probe.
- This product works under high temperature. Improper use will cause damage of the probe. In such circumstances, the manufacturer will not provide any warranty for repair and/or replacement services.