

2.4GHz Wireless BBQ Thermometer

SH252B

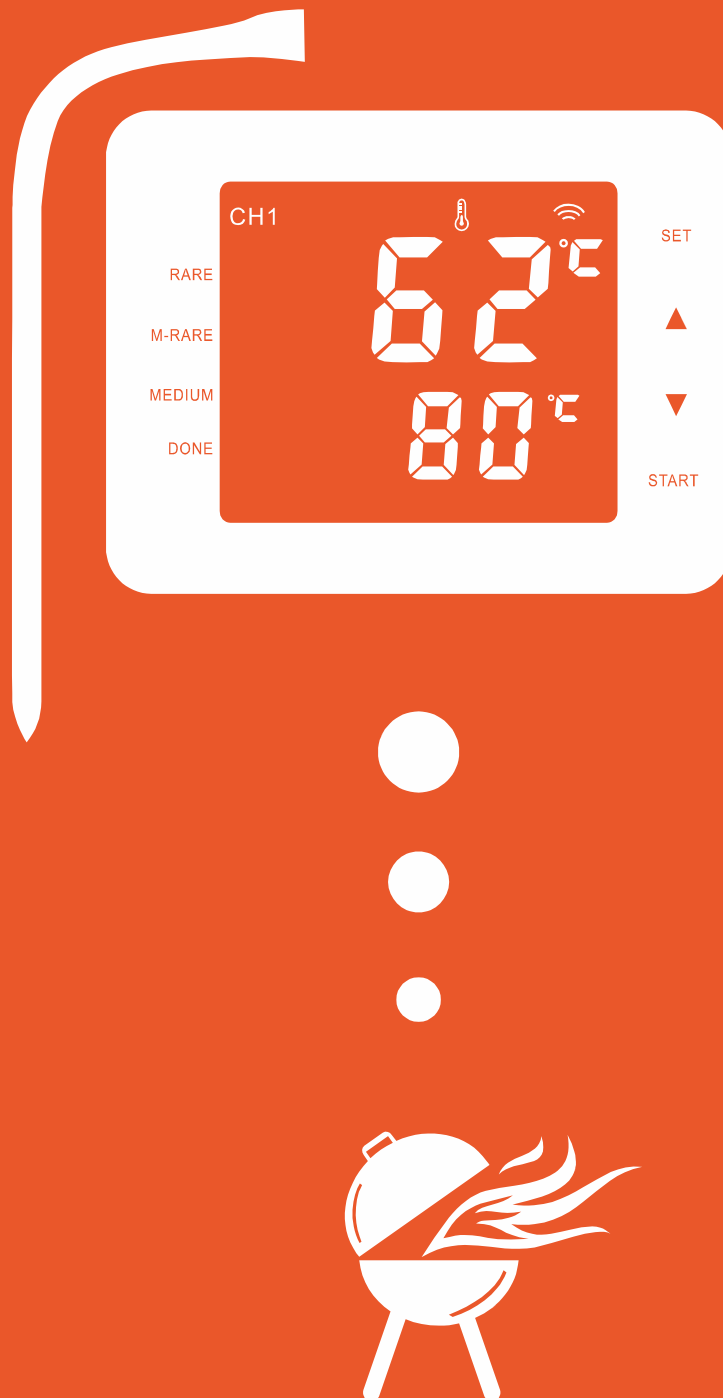

Thanks for having purchased SH252B Bluetooth BBQ Thermometer which consists of a thermometer, a temperature sensor wrapped in stainless steel probe, and a downloadable mobile APP GRILL EASY. SH252B is bringing simplicity, flexibility, intelligence and happiness to your BBQ time. SH252B supported by Bluetooth 4.0. To ensure using this product correctly, please read this manual before operation. Please also be sure to keep this manual well for future reference.

Product appearance

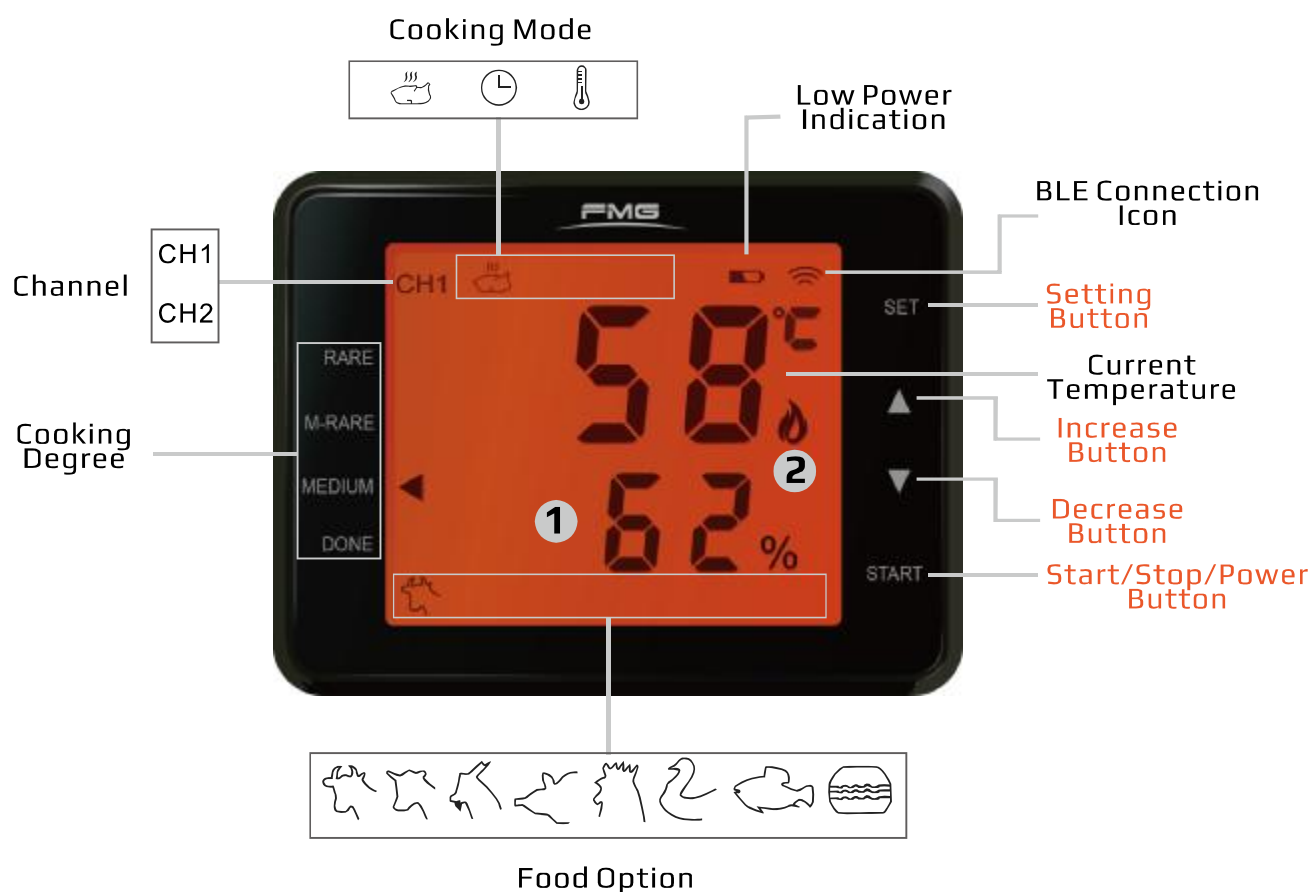

- 1 Target Temperature / Target Time / Countdown Time / Percentage of Cooking
- 2 Cooking Mode in Progress Icon

Preparation before use

Make sure your smart device supports

Bluetooth 4.0 .

Download the *Grill Easy* APP from Apple Store or Google Play and install the APP on your smart phone or tablet.



Grill Easy

Plug the probe sensor into the thermometer before turning on the power.

Install batteries

Open the cover of battery compartment on the back of the BBQ thermometer and install 3pcs AAA alkaline batteries in it.



Alkaline Battery



Probes

This thermometer can support 2 probes simultaneously, please plug probe into “CH1” (Channel1) or “CH2”(Channel2) on the thermometer before use.



Turn on the thermometer

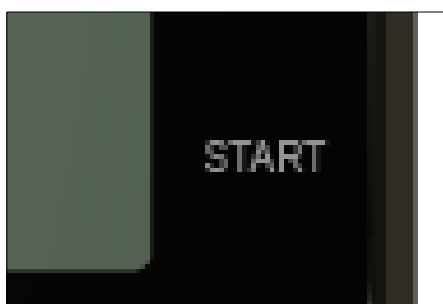

1

Press and hold “START” button (longer than 3 seconds) until to turn on the thermometer.

***You can also press and hold “START” button to turn off the thermometer.*

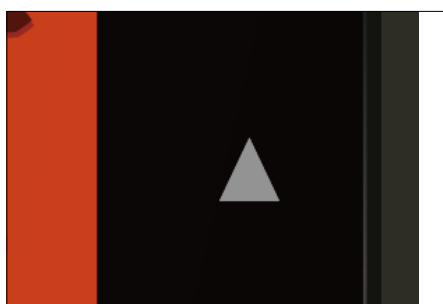

2



3

Press and hold Increase button until the “BLE Connection Icon” appears.

Open the Grill Easy APP on your smart phone and keeping the Bluetooth is on.

Main interface of APP

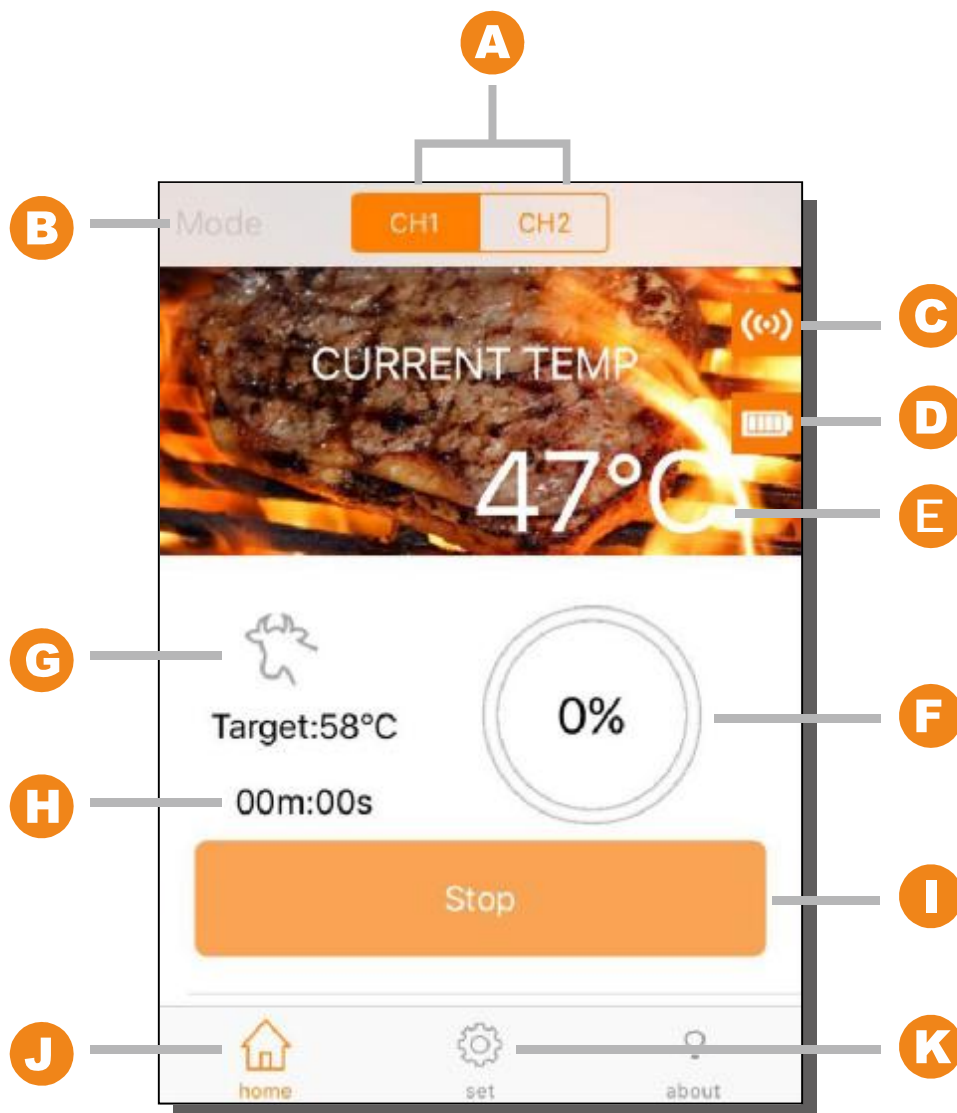

- | | | |
|--|------------------------------|---------------------------------|
| A Temperature channels | E Current temperature | I Start or Stop |
| B Mode selection | F Progress percentage | J Back to main interface |
| C Bluetooth pairing icon | G Current grill mode | K Go to setting page |
| D Low battery indicator for BBQ Thermometer | H Grilling time | |

Connect and disconnect Bluetooth

Open Grill Easy APP on your smart phone, and click  (Bluetooth Pairing Icon) :

Method 1:

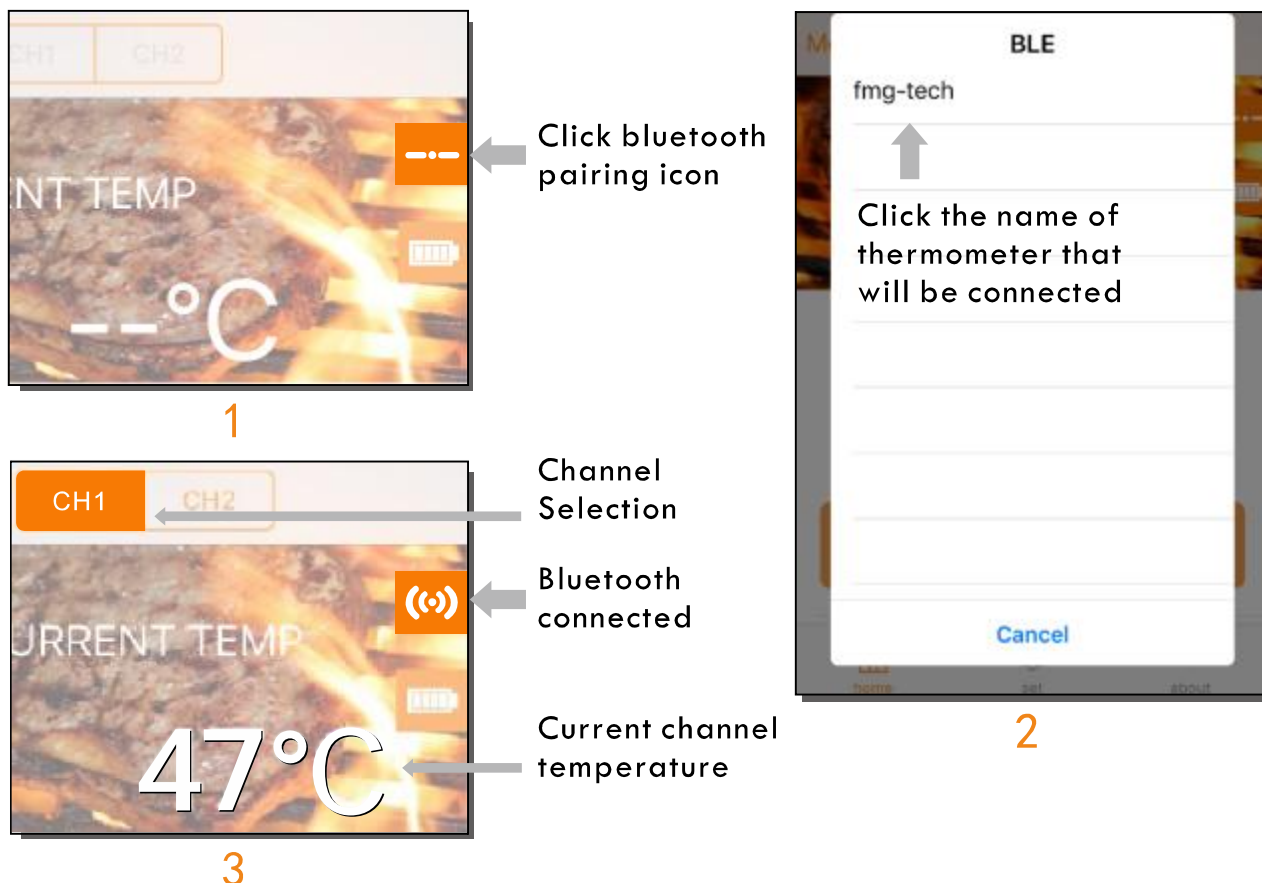

Method 2:

Click  enter setting page and click **Scan** to select the name of thermometer that will be connected. Or click **Disconnect** to break connection.

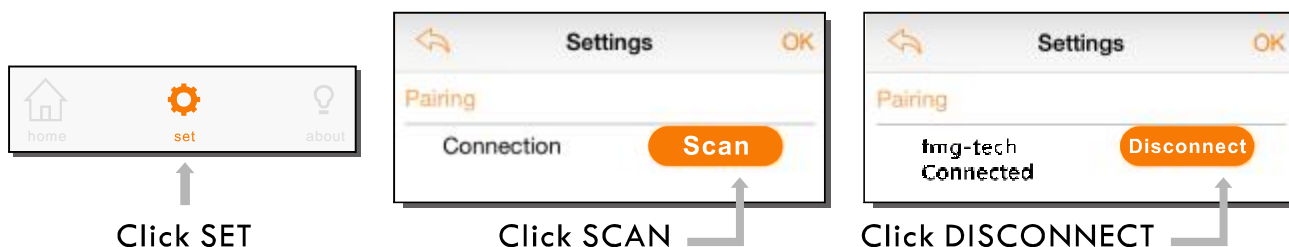

System setting

Click  enter system setting page. On this page you can connect or disconnect Bluetooth, set temperature unit and alarm.



1

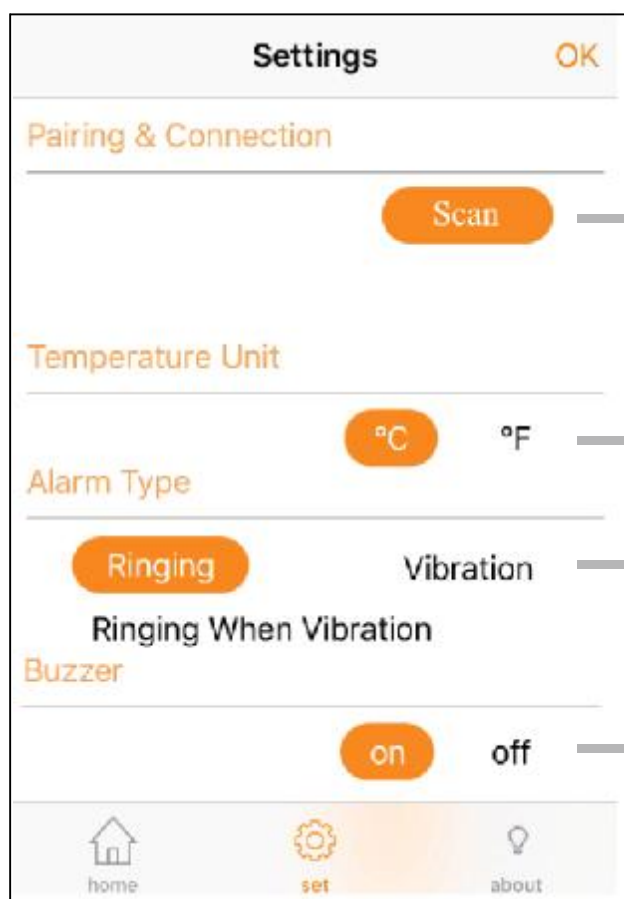

Searching thermometer
/disconnect

Temperature unit conversion

Alarm type for smart devices

Thermometer buzzer on/off

2

Select grill mode

Click and enter grill mode page



Recipe mode

Temperature mode

Timer mode

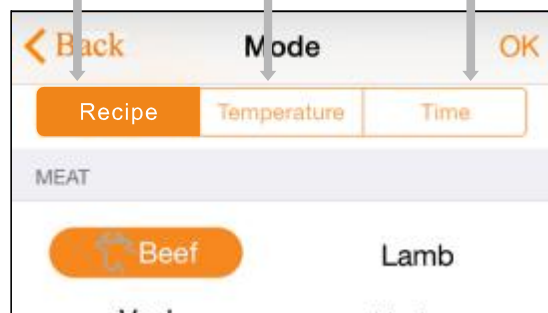

Recipe mode

8 pre-setting foods can be selected for grilling:
Beef, Veal, Pork, Chicken, Lamb, Hamburger, Turkey, Fish.

Selection of cooking level:
Rare, Medium-Rare, Medium, Well-Done.

Click **OK** to confirm the recipe which you selected and return to main interface.

3
Click to confirm the selection

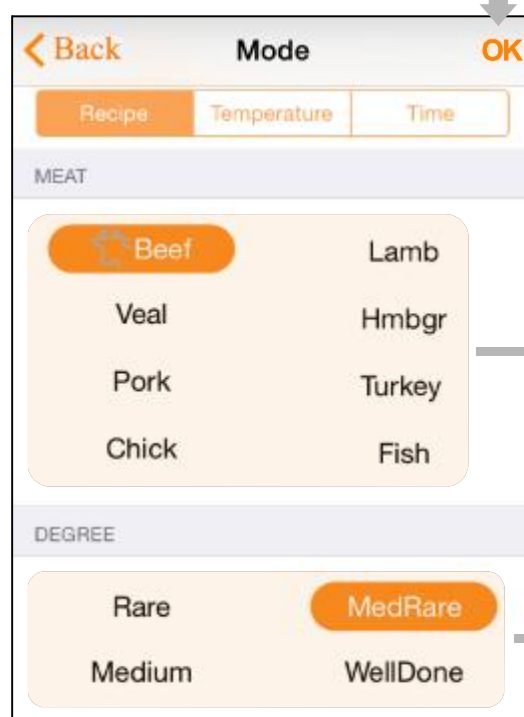

1
Food selection

2
Cooking level selection

Temperature mode

The target grilling temperature can be selected from 1~300 Celsius degree (33~572 Fahrenheit degree). Dial circle icon to select target temperature on the APP.

Press **OK** to confirm the selection

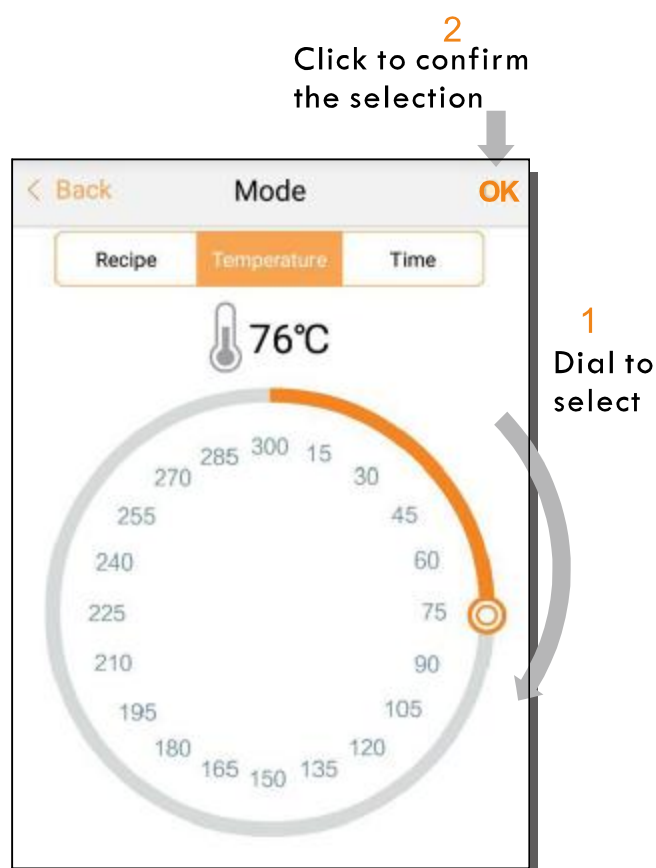

Timer mode

The target grilling time can be selected from 1 minute to 15 hours and 59 minutes. Dial two circle icons to select target hours and minutes respectively on the APP.

Press **OK** to confirm the selection

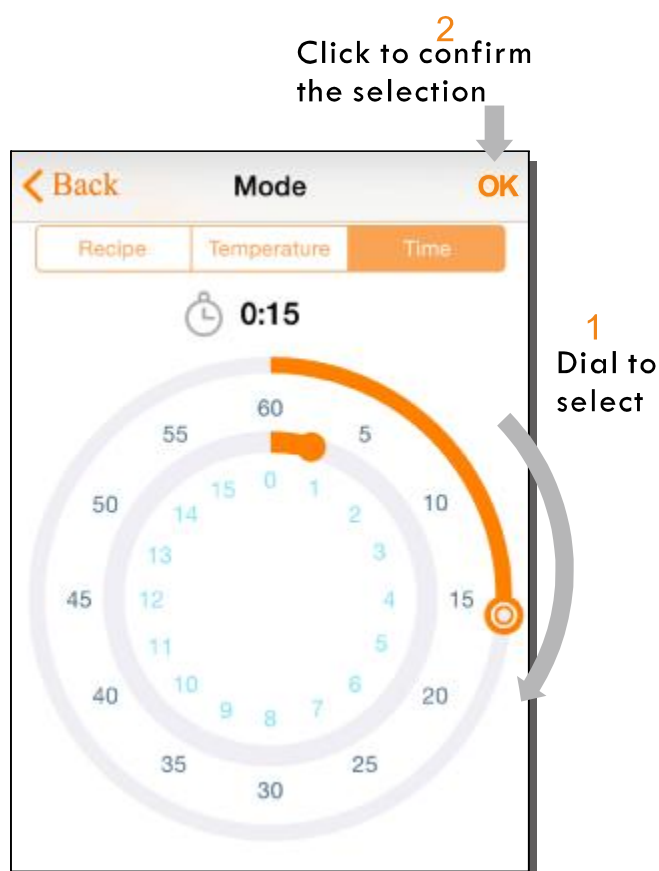

Grilling progress

Click to confirm the selection

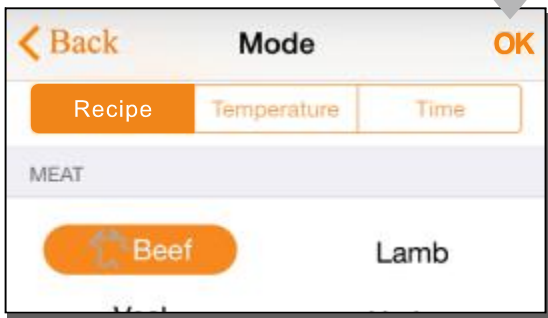

1

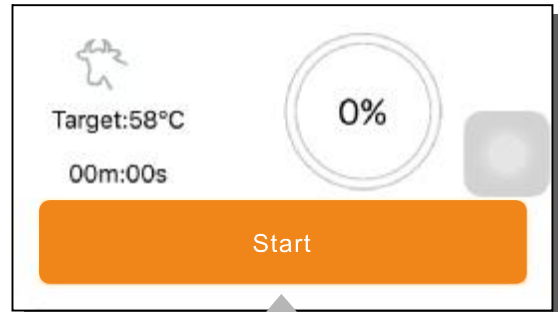

2

Click to start grilling progress

Click **OK** to finish grill mode selection and return to main interface. Click **START** to start grilling progress or press **STOP** to stop grilling progress.

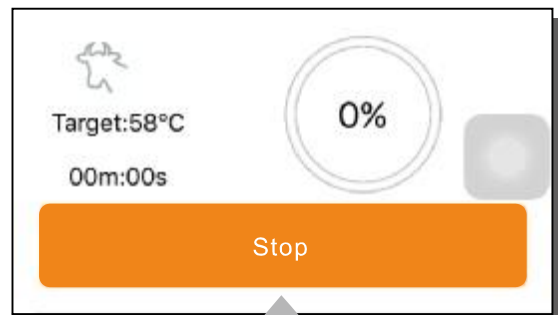

3

Click to stop grilling progress

When progress is on, the grilling level percentage will be displayed on the APP.

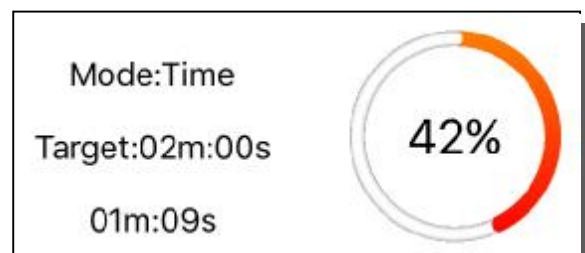

4

Operation On The Thermometer

You can set cooking mode on the thermometer directly in case there is no connection with the APP.



Temperature unit conversion

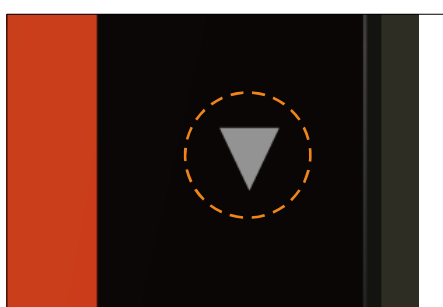

Decrease Button

Exit grill setting mode (There is not any icon blink on the LCD), press and hold ▼ button until the temperature unit change.

°C → °F or °F → °C

Channel selection

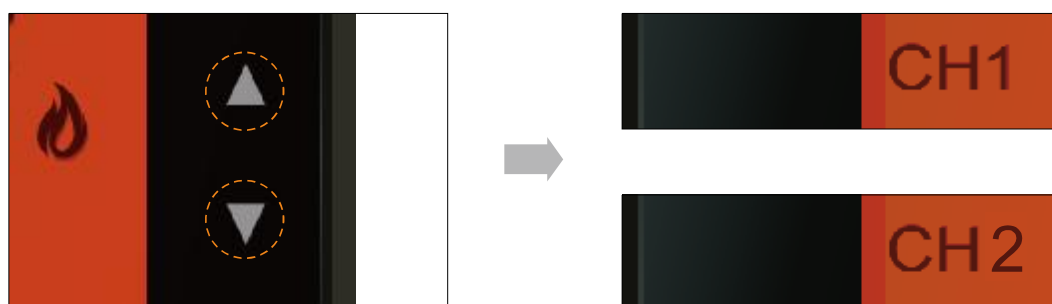

If there are two probes connect with the thermometer, exit grill setting mode (There is not any icon blinks on the LCD), press ▲ button or ▼ button to select the channel.

Grill mode setting

Recipe mode:

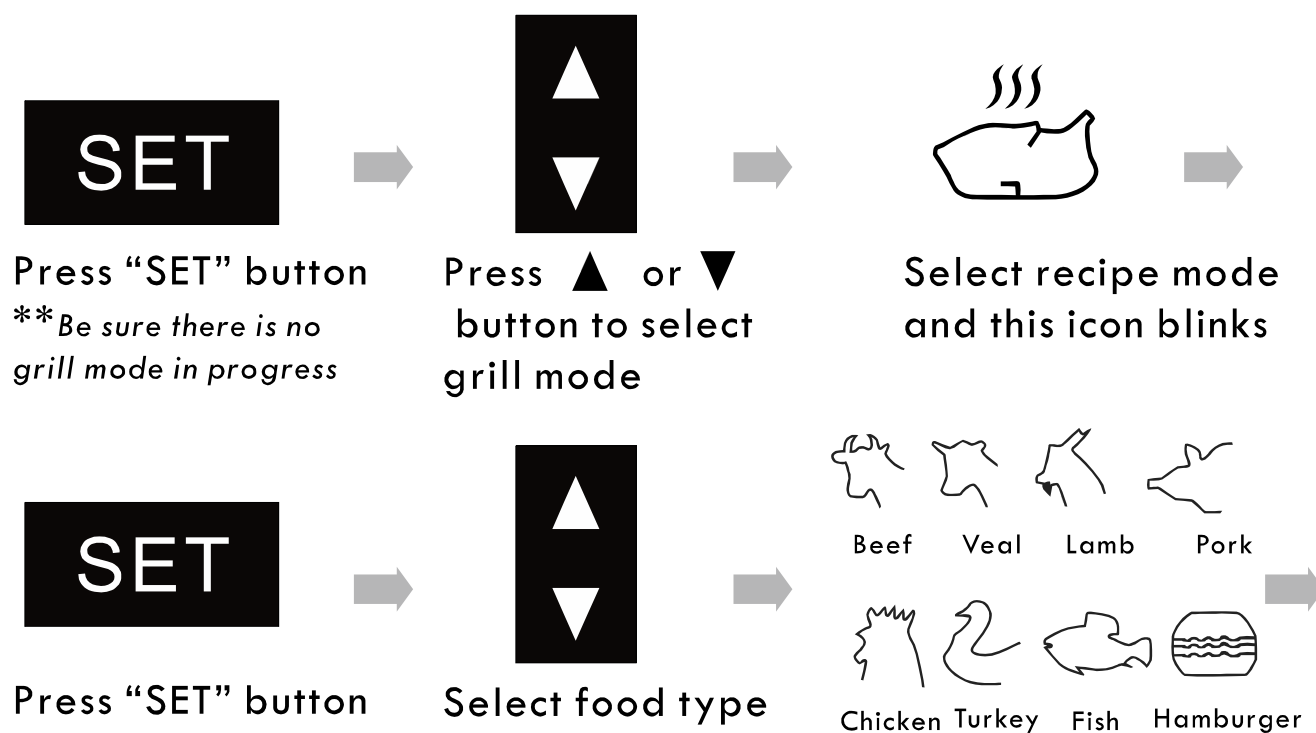

SET

Press "SET" button



Select cooking degree

RARE
M-RARE
MEDIUM
DONE

SET

Press "SET" button to finish setting

START

Press "START" button start cooking progress and a fire icon appears



Current Temperature

Target Temperature

Press "START" button to Stop cooking progress, and LCD displays current temperature and target temperature



Cooking Mode in Progress Icon

Percentage of Progress

Start cooking progress, displays current temperature and percentage of the progress

Grill mode setting

Temperature mode:

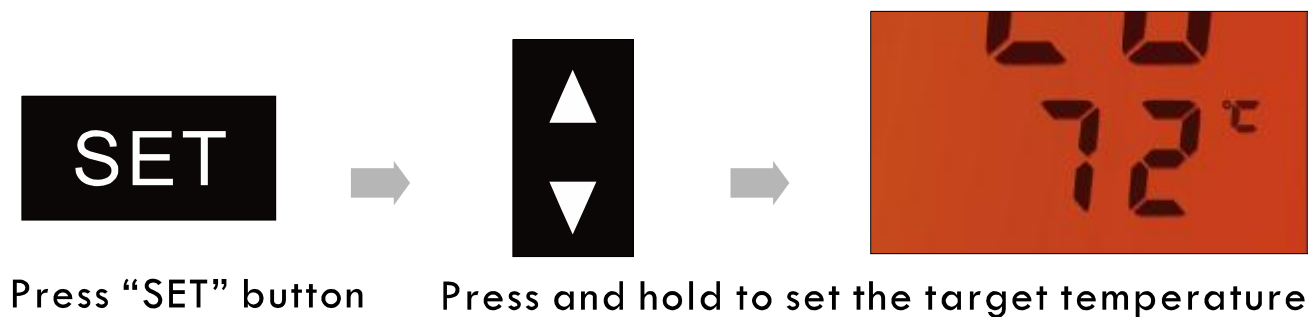
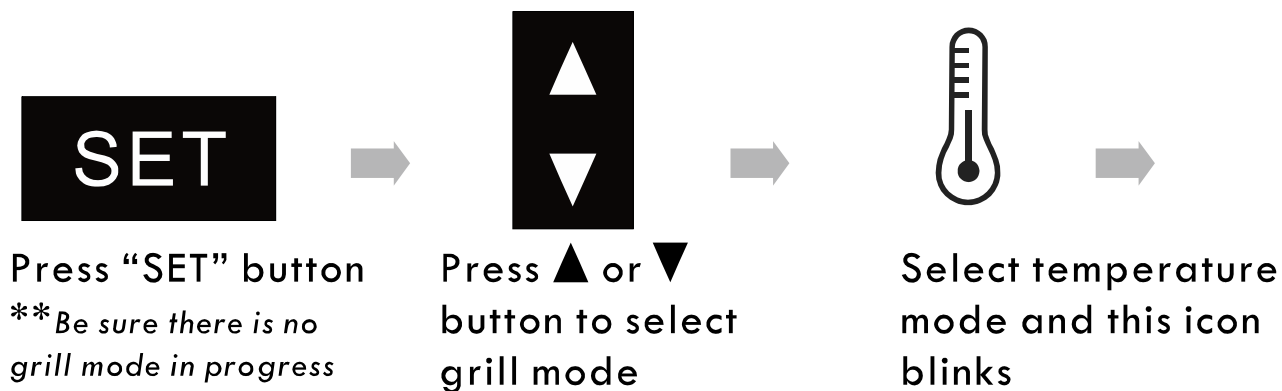

Grill mode setting

Timer mode:

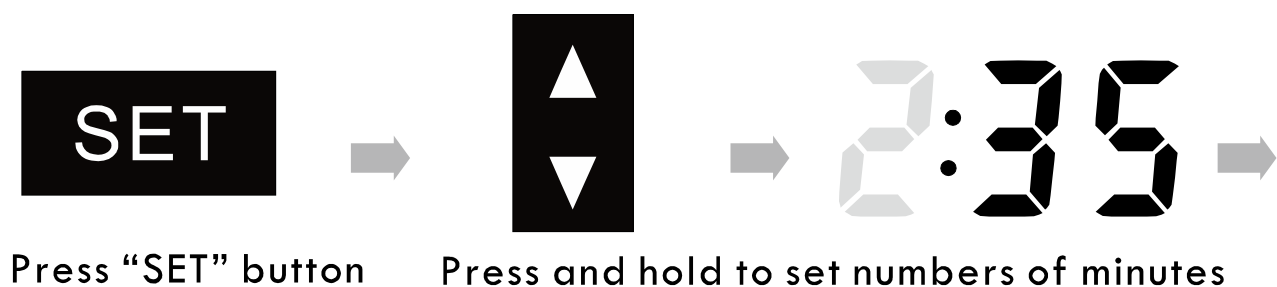
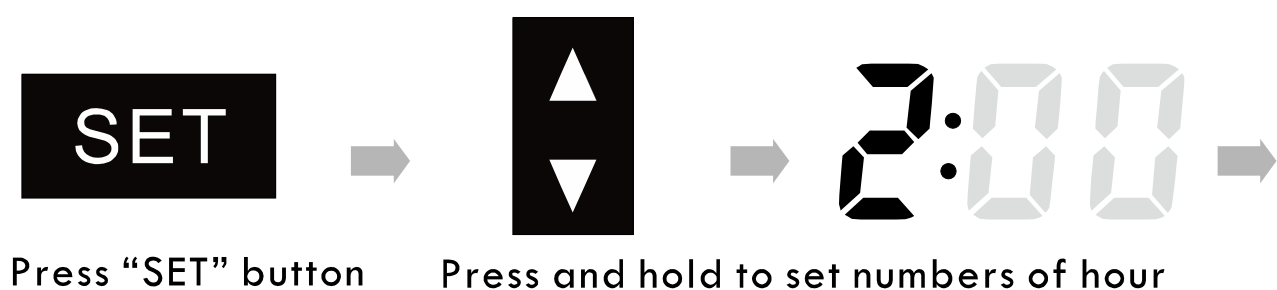
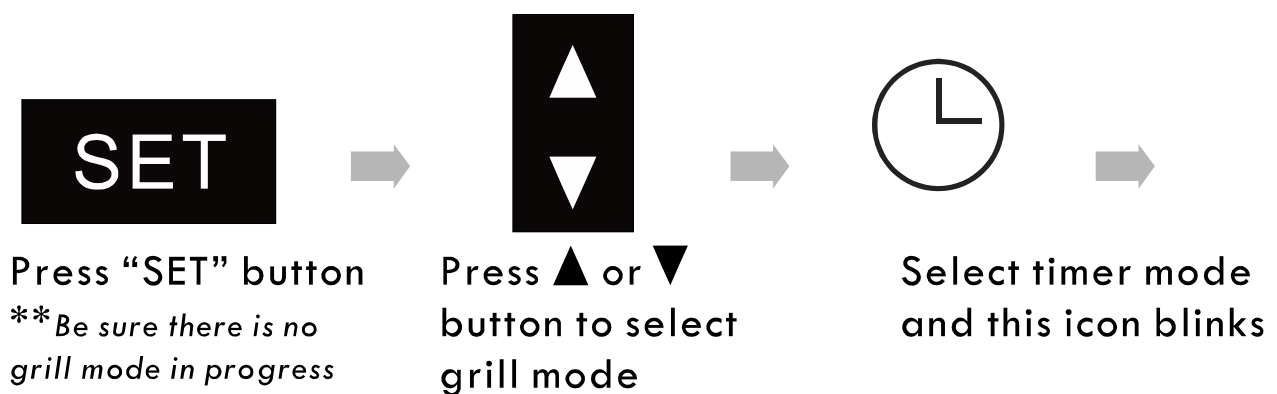

Attentions

Grill done.

When grill done, both the APP and the thermometer will alarm to warn you grill progress is finished. You can click “OK” on the APP or press any button on the thermometer to stop the alarm.

There are two reasons for Bluetooth unconnected.

- 1)The power of batteries in thermometer is too low to connect with APP
- 2)The distance between smart devices and thermometer is beyond the Bluetooth communication range (approximately over 10 meters).

Disconnect Bluetooth when grilling progress is working.

The thermometer is still working if there is a grilling progress in the process, and it will be working until finish the progress.

Grilling temperature beyond the range 0°C~200°C(32°F~392°F).

If the grilling temperature lower than 0°C(32°F) or higher than 200°C(392°F), the APP will show the current temperature is only 0°C(32°F) or 200°C(392°F) and blinks at the same time.

Use your smart phone scan and download Grill Easy APP on your phone



Grill Easy for BBQ Thermometer
iOS version

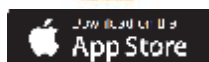

Grill Easy for BBQ Thermometer
Android version

