

JMP230-60 (225-270W)

Electrical specifications	JMP225	JMP230	JMP235	JMP240	JMP245	JMP250	JMP255	JMP260	JMP265	JMP270	
Maximum power (Pmpp)	225±5%	230±5%	235±5%	240±5%	245±5%	250±5%	255±5%	260±5%	265±5%	270±5%	Wp
Maximum power point voltage (Vmpp)	29.5	29.5	30	30	30	30.5	30.5	30.5	31	31	V
Maximum power point current (Impp)	7.63	7.8	7.83	8	8.17	8.2	8.36	8.52	8.55	8.71	A
Short circuit current (Isc)	8.24	8.42	8.46	8.65	8.74	8.85	9.02	9.19	9.22	9.39	A
Open circuit voltage (Voc)	36.6	36.6	37.2	37.2	37.2	37.8	37.8	37.8	38.4	38.4	V
Module efficiency	13.75	14.05	14.36	14.66	14.97	15.27	15.58	15.88	16.19	16.50	%
Power cells	3.75	3.83	3.92	4.00	4.08	4.12	4.25	4.33	4.42	4.50	Wp
Cells efficiency	15.41	15.76	16.10	16.44	16.78	17.12	17.47	17.81	18.15	18.50	%
Maximum system voltage	1000.00	1000	1000	1000	1000	1000	1000	1000	1000	1000	V-DC
Maximum Series Fuse Rating	15	15	15	15	15	15	15	15	15	15	A
Operational Temperature	-40to+85	-40to+85	-40to+85	-40to+85	-40to+85	-40to+85	-40to+85	-40to+85	-40to+85	-40to+85	°C

Mechanical Data **Dimension of PV Module**

Cell Type	poly	
Number of cells	60 (6*10)	pcs
Dimensions (h x w)	1650*992	mm
Thickness	50	mm
Weight	19.5	kg
Loading in 40GP	588	pcs

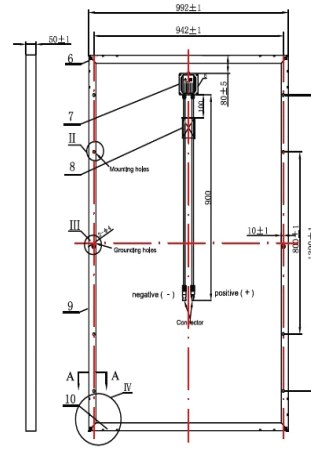
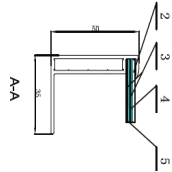
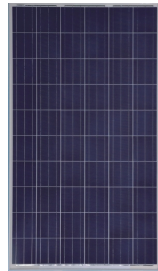

Materials	
Cells	156*156
Glass	High transparency glass, 3.2mm
Back sheet	KREPEL TPT
Junction box	PV-ZH008
Cables	2 x 0.9m, 4mm ² , UV resistant,
Connectors	MultiContact MC4, IP67

Temperature Rates **IV CURVES**

NOCT	47°C ± 2°C
Temperature Coefficient of P _{mp}	- 0.45%/K
Temperature Coefficient of V _{oc}	- 0.35%/K
Temperature Coefficient of I _{sc}	+ 0.06%/K

Warranty	
Power	±3%
Warranty 5 yeas Workman ship	
10 years 90% of P _{mp}	
25 years 80% of P _{mp}	

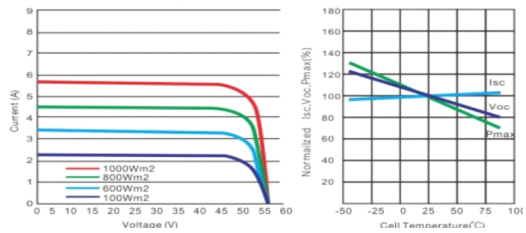

CAUTION: READ SAFETY AND INSTALLATION INSTRUCTIONS BEFORE USING THE PRODUCT

©January 2011, Sunever Solar . All rights reserved.