

Jumbo Collection_Milano Event





The Mirror_Sir Frank Francis Bernard Dicksee_1896 private collection

Lace_dining
Boheme_living



Cashmere



The luxurious softness of cashmere Loro Piana upholsters the Boheme collection.



Cashmere is a textile fiber obtained from the *Hircus* goat, living in Asian mountain regions and plateaus. The word Cashmere derives from the Indian region of Kashmir, from where this fiber has been exported to Europe since the beginning of the nineteenth century. Today only small quantities are produced in the Indian region of Kashmir, while the largest producers are Tibet, Mongolia, China, Iran and Afghanistan. Cashmere is characterized by its soft, silky and velvety fibers. It is noted as providing a natural light-weight insulation without bulk. The goats produce a double fleece consisting of the fine, soft undercoat or underdown of hair mingled with a straighter and much coarser outer coating of hair called Guard Hair. The grow of undercoat is associated with the particular climatic conditions and drastic changes in temperature between day and night in these areas. More than all animal fibers, this hair is able to thermo-regulate the body of the animal, protecting it both from low and from high temperatures. Cashmere is collected during the spring moulting season when the goats naturally shed their winter coat. The mixed mass of down and coarse hair is removed by hand with a coarse comb. It is estimated that on average yearly production per goat is 100-200 grams.







LAC-14R Round table
diam. 170
LAC-16 Chair
61 x 58 x h 117





LAC-14R Round table
diam. 170

LAC-16 Chair
61 x 58 x h 117

CHA-L106/24 Chandelier
140 x h 110



- LAC-11 Buffet
285 x 52 x h 90
- LAC-12 Mirror
190 x h 130
- CHA Standing lamp
diam. 60 x h 200
- BOH-71 Armchair
105 x 80 x h 120
- LAC-133 Bookshelf
150 x 40 x h 270



ВОН-43F 3 seaters sofa
250 x 108 x h 135
ВОН-47 Side table
diam. 60 x h 78





BOH-47 Side table
diam. 60 x h 78

BOH-43V 3 seaters sofa
250 x 108 x h 135



BOH-71 Armchair
105 x 80 x h 120

BOH-43V 3 seaters sofa
250 x 108 x h 135

PAI-7E2FP Painting
"Donna con specchio"
170 x h 220

CHA-L106/8 Chandelier
82 x h 71





BOH-43V 3 seaters sofa
250 x 108 x h 135
PAI-EGEP Painting "Passione"
170 x h 220
CHA-L106/8 Chandelier
82 x h 71



MOR-42 2 seaters sofa
175 x 96 x h 90
CHA Standing lamp
diam. 60 x h 200





Hermes_living & dining

Mother-of-pearl

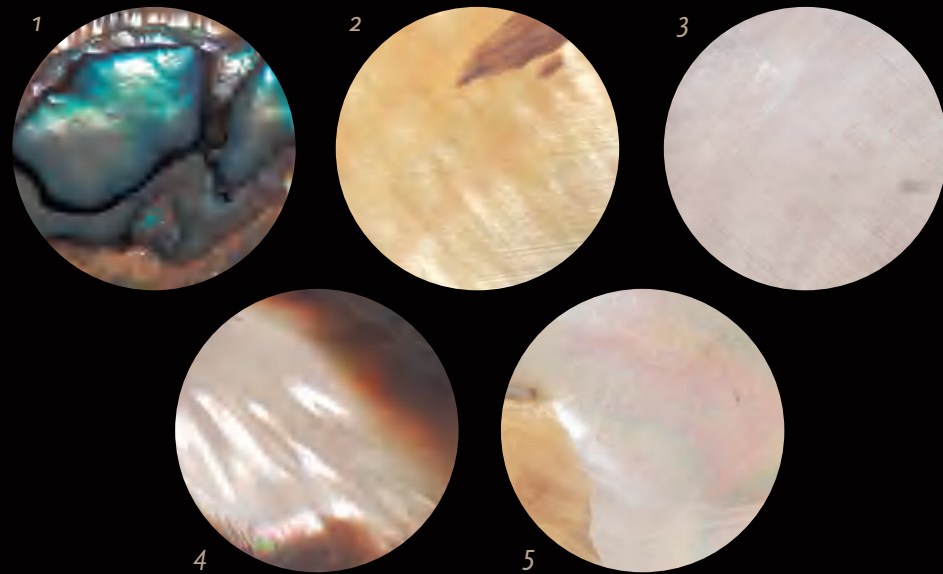

5 special mother-of-pearls, from 5 different areas of the world, embellish the inlays of the Hermes collection.



1 - Goldfish mother-of-pearl

2 - Yellow mother-of-pearl

3 - White mother-of-pearl

4 - Grey mother-of-pearl

5 - White mother-of-pearl

Mother-of-pearl is a precious material produced by some mollusks, especially oysters, as an inner shell layer. It has usually an iridescent pearl white colour. Due to its hardness, it is used in the production of various objects and for the decoration of certain surfaces. The most valuable mother-of-pearl comes from the East Indies, Indian Ocean and Red Sea. Depending on the origin its colour may vary from classic white shade to grey or yellow shades. In the colonial period, the port of Massawa in Eritrea was the main market of the Red Sea for this product, which was mainly exported to France and Italy. Mother-of-pearl was and is still used for the creation of inlay designs on furniture, especially during the Renaissance period, as well as for jewelry, cutlery, buttons, mosaics, fans, binoculars, keys for musical instruments. Mother-of-pearl is composed of hexagonal platelets of aragonite (calcium carbonate crystals) arranged in a continuous parallel lamina. These layers are separated by sheets of organic matrix composed of elastic biopolymers.

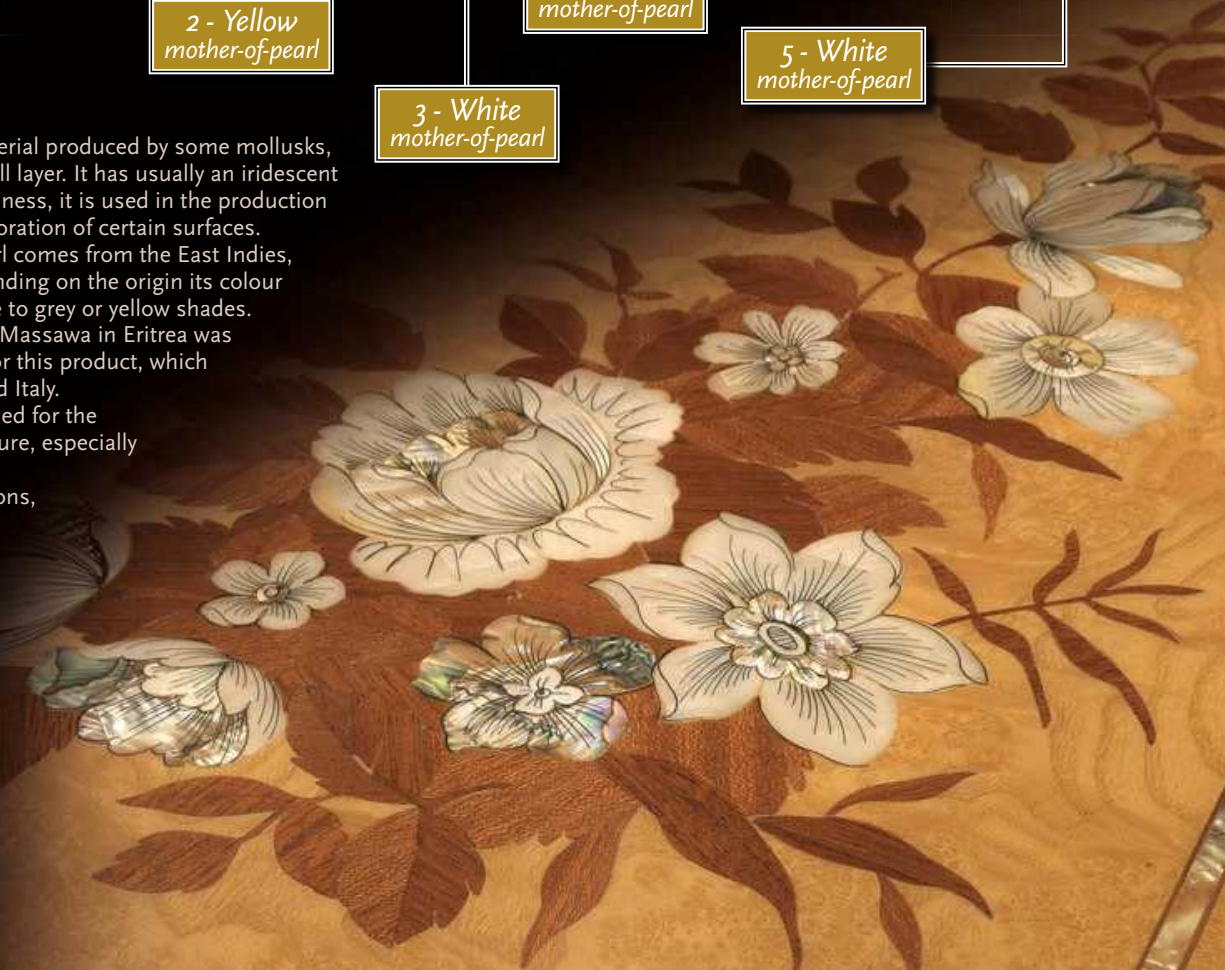



HER-73 3 seaters sofa
320 x 110 x h 95
PAI-7D19P Painting "Uccelli"
200 x h 270





- HER-73 3 seaters sofa
320 x 110 x h 95
- HER-46 Central table
168 x 168 x h 44
- MAN-171B Armchair
120 x 105 x h 90
- CHA-L256/20 Chandelier
120 x h 120
- PAI-7D19P Painting "Uccelli"
200 x h 270





MAN-171B Armchair
120 x 105 x h 90





HER-46 Central table
168 x 168 x h 44

MAN-192 2 seaters sofa
200 x 90 x h 125

PAI-7DD5P Painting
"Uomo africano"
127 x h 156





HER-47 Side table
88 x 88 x h 83





HER-14-2B Rectangular table
300 x 120 x 78

HER-15 Armchair
65 x 68 x h 116

HER-16 Chair
62 x 68 x h 104

HER-13 Cabinet
130 x 45 x h 212

PAI-7E7EP Painting "Ghepardo"
180 x h 270

CHA-FLA Flambeau
diam. 100 x h 304
(with base)

- PAI-7E7EP Painting "Ghepardo"
180 x h 270
- HER-14-2B Rectangular table
300 x 120 x h 78
- HER-15 Armchair
65 x 68 x h 116
- HER-16 Chair
62 x 68 x h 104
- HER-13 Cabinet
130 x 45 x h 212





HER-11 Buffet
146 x 68 x h 100



HER-11 Buffet
146 x 68 x h 100
PAI-7D99P Painting "Ritratto"
127 x h 156



CHA-FLA Flambeau
diam. 100 x h 304
(with base)





HER-13 Cabinet
130 x 45 x h 212



Casta Diva_*boiserie*





Casta Diva,
boiserie and ceiling
ros-21 Chest of drawers
167 x 57 x h 100



Casta Diva,
boiserie and ceiling





Casta Diva,
boiserie and ceiling

ROS-21 Chest of drawers
167 x 57 x h 100

ABS-22 Consolle
100 x 40 x h 85

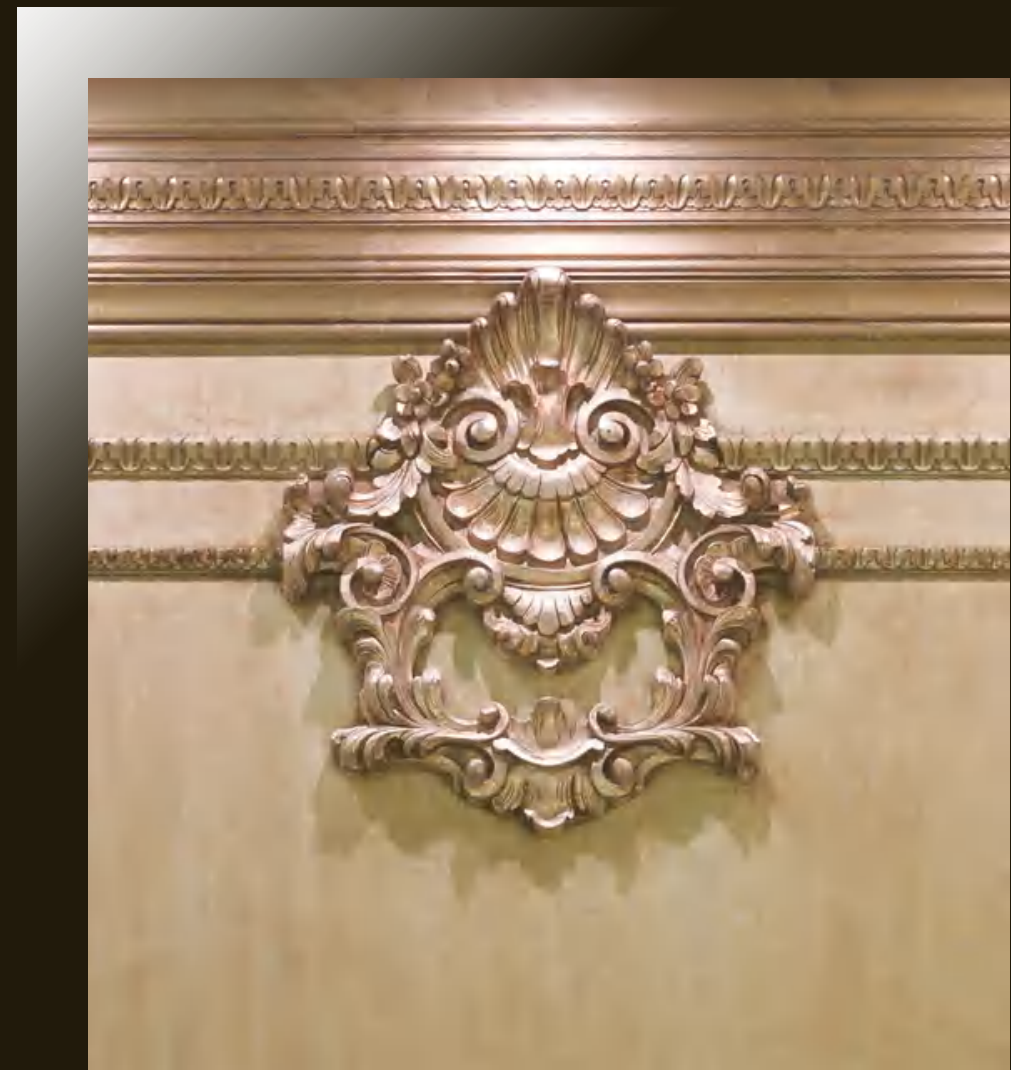

Lace_*bedroom*
Caravaggio_*living*



- LAC-102 Bed with canopy
275 x 250 x h 256
- LAC-125 Bedcover set
- LAC-ACC1 Bed sheet
- LAC-ACC2 Cashmere plaid
- LAC-105 Night table
63 x 35 x h 60
- CAR-42 2 seaters sofa
215 x 90 x h 72
- CAR-41 Armchair
133 x 85 x h 72
- CAR-46 Central table
diam. 130 x h 52
- CHA-L270/12 Chandelier
85 x h 90
- PAI-7F16P Painting
145 x h 245
- CHA-LAC One light lamp with shade
diam. 50 x h 94





- CAR-42 2 seaters sofa
215 x 90 x h 72
- CAR-41 Armchair
133 x 85 x h 72
- PAI-7F16P Painting
145 x h 245



- CAR-42 2 seaters sofa
215 x 90 x h 72
- CAR-41 Armchair
133 x 85 x h 72
- CAR-46 Central table
diam. 130 x h 52





LAC-102 Bed with canopy
275 x 250 x h 256
LAC-125 Bedcover set
LAC-ACC1 Bed sheet
LAC-ACC2 Cashmere plaid



LAC-103 Toilette
205 x 50 x h 85

LAC-104 Mirror
178 x h 115

LAC-106 Chair
62 x 56 x h 85

CHA-LAC One light lamp with shade
diam. 50 x h 94





- LAC-102 Bed with canopy
275 x 250 x h 256
- LAC-125 Bedcover set
- LAC-ACC1 Bed sheet
- LAC-ACC2 Cashmere plaid
- LAC-105 Night table
63 x 35 x h 60
- CAR-41 Armchair
133 x 85 x h 72
- CAR-46 Central table
diam. 130 x h 52



LAC-202 Bed with sommier
202 x 220 x h 180

LAC-125 Bedcover set
(for mattress 180 x 200)

LAC-202B Bed with sommier
222 x 220 x 180

LAC-125B Bedcover set
(for mattress 200 x 200)

LAC-ACC1 Bed sheet

LAC-ACC2 Cashmere plaid

LAC-105 Night table
63 x 35 x h 60



LAC-202 Bed with sommier
202 x 220 x h 180

LAC-125 Bedcover set
(for mattress 180 x 200)

LAC-202B Bed with sommier
222 x 220 x h 180

LAC-125B Bedcover set
(for mattress 200 x 200)

LAC-ACC1 Bed sheet

LAC-ACC2 Cashmere plaid

LAC-105 Night table
63 x 35 x h 60





Jumbo Collection *_divisions*

Jumbo Collection is made up of 3 different and complementary divisions:

– luxury furniture division

– kitchen division

– contract division

with the intent to go beyond the simple supply of furniture, so as to propose a total housing taste, a Jumbo concept, to define a unique and distinctive atmosphere.

Jumbo Collection

luxurious furniture division

The Luxurious Furniture division proposes collections comparing themselves with a wide horizon of tastes, to offer a wrapping sense of luxury and prestige. Hallmarks typical of the 'Italianism' of collections appear in the extreme attention to details, in the constant search for highest-quality materials, in the greatest care of finishes, fabrics, trimmings, in the bold formal research oriented to an unconventional creativity. The principle of originality of a piece drives the work on volumes, on the combination of materials and on the opportunity to change radically the impact of each proposal, also through a careful use of decoration and finishing.



Jumbo Collection *kitchen division*

JKC kitchens are designed following the style of Jumbo Collection dining rooms and are therefore made in a neoclassical style incorporating elements of different decorative inspiration, from Empire to Louis XVI style.

Each component is individually designed according to a specific project in order to maximize the available space and obtain a unique and customized design.

All kitchens are produced with the most advanced materials: structures in marine multilayer wood suitable for damp rooms, varnishes resistant to wear, heat and humidity, technological appliances of the most prestigious brands.



Jumbo Collection

contract division

The Contract Division was established following the rising need of clients to be assisted and guided, not only in the choice of furniture, but also in the global design of rooms, that should express the appeal and seduction of a unique and distinctive style. This branch also offers the market a line of house complements, such as doors, stair banisters, boiserie and wooden ceilings. Step by step, from first inspection in the building yard until inaugural toast in the new house, we attend customers, who choose a "global" service.

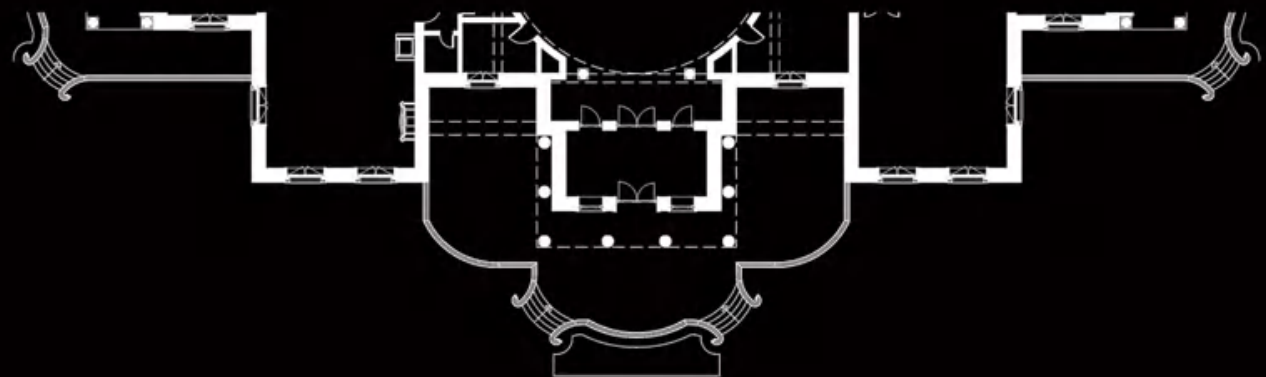



Istant book



Milano event





Furniture Designer_Livio Ballabio
Graphic Design_Indaco, Milano
Photos_Azimak Photo, Cantù (MI)
Pre-press_Scalzini Fotolito, Cantù (MI)

Special thanks:
Loro Piana Spa, Quarona Sesia (VC)

Printed in Italy by Grafica Gioia Srl, Cantù (MI)
© Copyright 2009 by Jumbo Collection Srl

No part of this catalogue may be reproduced in any form
without written permission of the publisher.

JUMBO  COLLECTION
luxurious furniture

Via per Montesolaro 14/b - 22063 Cantù (Co) - Italy
Tel. +39 031 70757 - Fax +39 031 711540 - www.jumbo.it - info@jumbo.it

JUMBO  COLLECTION
luxurious furniture