

Windows (Doors) and Curtain Wall System

Address: 301, MingRun Business Building, Huangbian No.9 North Road, Baiyun District, Guangzhou, China

TEL: +86-20-22107806 +86-13434304906 E-mail: susan@marblelegend.com

Pfm does not accept liability for errors, changes and omissions. 201510

PFM
PRODUCT APPLICATION GUIDE

High-performance
Windows & Doors System Solution Provider



>> Contents

WINDOWSYSTEM OPTION OF OPENING	▶	03	
		07	◀ NOW OUTWARD OPENING WINDOW
NOWS OUTWARD OPENING WINDOW	▶	21	
		27	◀ EOW OUTWARD OPENING WINDOW
NWTILT & TURNWINDOW	▶	33	
		41	◀ NS SLIDING WINDOW
			
			
DOORSYSTEM OPTION OF OPENING	▶	47	
		51	◀ ND SIDE HINGED DOOR
NS SLIDING DOOR	▶	59	
		73	◀ NS LIFT & SLIDE DOOR
NFD FOLDING DOOR	▶	83	
		87	◀ CASE REFERENCE

PRODUCTS

Window System



NOW50.N



NOW55



NOW65



NOWS50.N



NOWS55



EOW50.N



EOW55



NW50.N



NW55



NW65



NS40.N



NS40

likezhou
2015-11-04 10:45:32

Casement

▶ NOW Outward Opening Window

NOW50.N Outward Opening Window	07/08
NOW55 Outward Opening Window	09/10
NOW65 Outward Opening Window	11/12
NOW Outward Opening Window Hardware System	13/14
▶ NOW 55 Outward Casement Window System	15/17
NOW55 Awning System	18/20



▶ NOWS Outward Opening Window

NOWS50.N Outward opening window	21/22
NOWS55 Outward Opening Window	23/24
NOWS Outward Opening Window Hardware System	25/26

▶ EOW Outward Opening Window

EOW50.N Outward Opening Window	27/28
EOW55 Outward Opening Window	29/30
EOW Outward Opening Window Hardware System	31/32

▶ NW Tilt & Turn Window

NW50.N Tilt & Turn Window	33/34
NW55 Tilt & Turn Window	35/36
NW65 Tilt & Turn Window	37/38
NW Tilt & Turn Window Hardware System	39/40

▶ NS Sliding Window

NS40.N Sliding Window	41/42
NS40 Sliding Window	43/44
NS40/NS40.N Sliding Window Hardware System	45/46

Option of Opening

likezhou
2015-11-04 10:43:52

Configuration

Window System	NOW50.N	NOW55	NOW65	NOWS50.N	NOWS55	EOW50.N

Window System	EOW55	NW50.N	NW55	NW65	NS40.N	NS40

PRODUCTS

NOW50.N Outward Opening Window System



Product Profile

NOW50.N outward opening window system provides a comprehensive solution to the building. Its product has high quality performance. Its parallel and level design of the inner and outer frames and sashes gives the building a pretty simple and pleasing look. Its simple, convenient and fast manufacturing and installation technology makes a further advantage. In addition, the unique anti-prizing design guarantees the powerful anti-theft performance and well solves the safety problems of outward opening windows. All these make the product suitable to be used in high-end projects.

Technical Parameters

Frame depth/mm	50mm
Sash depth/mm	50mm
Visible width of inner/outer frame/mm	43.5/19mm
Visible width of inner/outer sash/mm	20.5/65mm
Sash's clamping glass thickness range/mm	5~29mm

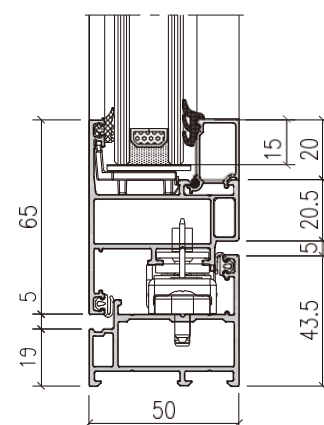

Performance

Thermal insulation	The K value for thermal insulation can reach 3.5 W/m ² .k (Grade 3) (depending on the glass configuration)
Sound proof	the attenuation value of sound after passing windows can reach 34 dB(Grade 3) (depending on the glass configuration)
Air tightness	the value exceeds 600 Pa (Grade 8)
Water tightness	the value exceeds 700 Pa (Grade 6)
Wind load resistance	the value can reach 4000 Pa (Grade 7)



Product Features

Wider application

- Abundant configuration options to satisfy application requirements of different window patterns.

More secure for use

- Leading outward opening window hardware patented technology and the anti-falling security design;
- Unique anti-prizing design technique, in accordance with EU WK2 security level.

More convenient processing

- Mature and standard processing technique effectively improves the processing efficiency by 50%;
- Quick positioning and adjustable fast assembly of friction hinges, lock points and lock seats.

Longer service life

- Repeated opening design up to 50,000 times (GB 10,000 times), in accordance with the lifespan of 30 years.

Technical standard

- Compliance with EU CE standard, USA ASTM standard and Chinese GB standard.

Openable Dimension Range

Option of opening	Height-width ratio	Hardware load bearing	Dimension range(mm)				
			Net dimensions of sash (mm)		Module dimensions (mm)		
			Width FB	Height FH	Width W	Height H	Suggested dimensions
Single leaf outward opening	FH/FB≥1	28kg/34kg	415~650	415~1700	460~780	460~1830	650x1200
Single leaf outward hanging	FH/FB≤1	50kg/80kg	415~1400	415~1100	460~1530	460~1230	1000x750
Double leaf outward folio opening	FH/FB≥1	28kg/34kg	415~650	415~1300	460~700	460~1350	600x1200

PRODUCTS

NOW55 Outward Opening Window System



Product Profile

NOW55 outward opening window system provides a comprehensive solution to the building. Its product has high quality performance. Its parallel and level design of the inner and outer frames and sashes gives the building a pretty simple and pleasing look. Its simple, convenient and fast manufacturing and installation technology makes a further advantage. In addition, the unique anti-prizing design guarantees the powerful anti-theft performance and well solves the safety problems of outward opening windows. All these make the product quite suitable to be used in high-end projects where the basic thermal insulation requirements are to be met.

Technical Parameters

Frame depth/mm	55mm
Sash depth/mm	55mm
Visible width of inner/outer frame/mm	43.5/19mm
Visible width of inner/outer sash/mm	20.5/65mm
Sash's clamping glass thickness range/mm	10~34mm

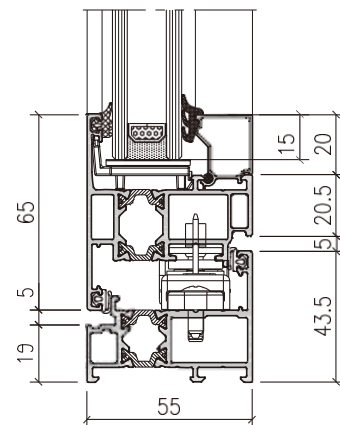

Performance

Thermal insulation	The K value for thermal insulation can reach 2.1 W/m ² .k (Grade 6) (depending on the glass configuration)
Sound proof	Sound attenuation value of sound after passing windows can reach 40 dB(Grade 5) (depending on the glass configuration)
Air tightness	Pressure value exceeds 600 Pa (Grade 8)
Water tightness	Pressure value exceeds 700 Pa (Grade 6)
Wind load resistance	Pressure value can reach 4500 Pa (Grade 8)



Product Features

Wider application

- Abundant configuration options to satisfy application requirements of different window patterns.

More secure for use

- Leading outward opening window hardware patented technology and the anti-falling security design;
- Unique anti-prizing design technique, in accordance with EU WK2 security level.

More convenient processing

- Mature and standard processing technique effectively improves the processing efficiency by 50%;
- Quick positioning and adjustable fast loading friction hinge and lock point and lock seat.

Longer service life

- Repeated opening design up to 50,000 times (GB 10,000 times), in accordance with the lifespan of 30 years.

Technical standard

- Compliance with EU CE standard, USA ASTM standard and Chinese GB standard.

Openable Dimension Range

Option of opening	Height-width ratio	Hardware load bearing	Dimension range(mm)				
			Net dimensions of sash (mm)		Module dimensions (mm)		
			Width FB	Height FH	Width W	Height H	Suggested dimensions
Single leaf outward opening	FH/FB≥1	28kg/34kg	415~650	415~1700	460~780	460~1830	650x1200
Single leaf outward hanging	FH/FB≤1	50kg/80kg	415~1400	415~1100	460~1530	460~1230	1000x750
Double leaf outward folio opening	FH/FB≥1	28kg/34kg	415~650	415~1300	460~700	460~1350	600x1200

PRODUCTS

NOW65 Outward Opening Window System



Product Profile

NOW65 outward opening window system provides a comprehensive solution to the building. This product has high quality performance. Its parallel and level design of the inner and outer frames and sashes gives the building a pretty simple and pleasing look. Its simple, convenient and fast manufacturing and installation technologies further demonstrate its advantages. In addition, the unique anti-prizing design guarantees the powerful anti-theft performance and well solves the safety problems of outward opening windows. A triple sealing is done, making the product a very suitable choice in projects where the requirements on the thermal insulation, air tightness and water tightness are relatively strict.

Technical Parameters

Sash depth/mm	65mm
Visible width of inner/outer sash/mm	20.5/65mm

Performance

Thermal insulation	The K value for thermal insulation can reach 1.9 W/m ² .k (Grade 7) (depending on the glass configuration)
Sound proof	The attenuation value of sound after passing windows can reach 45 dB(Grade 6) (depending on the glass configuration)
Air tightness	The value exceeds 600 Pa (Grade 8)
Water tightness	The value exceeds 700 Pa (Grade 6)
Wind load resistance	The value can reach 5000 Pa (Grade 9)

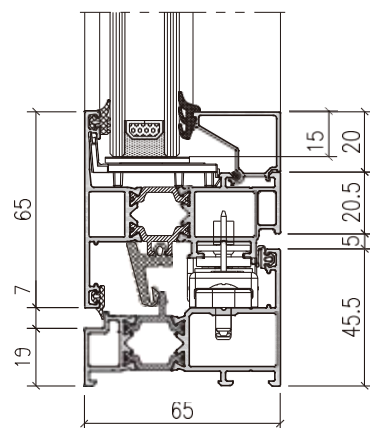

Product Features

Wider application

- Abundant configuration options to satisfy application requirements of different window patterns.

More secure for use

- Leading outward opening window hardware patented technology and the anti-falling security design;
- Unique anti-prizing design technique, in accordance with EU WK2 security level.

More convenient processing

- Mature and standard processing technique effectively improves the processing efficiency by 50%;
- Quick positioning and adjustable fast assembly of the friction hinges and lock points and lock seats.

Longer service life

- Repeated opening design up to 50,000 times (GB 10,000 times), in accordance with the lifespan of 30 years.

Technical standard

- Compliance with the EU CE standard, USA ASTM standard and Chinese GB standard.

Openable Dimension Range

Option of opening	Height-width ratio	Hardware load bearing	Dimension range(mm)				
			Net dimensions of sash (mm)		Module dimensions (mm)		
			Width FB	Height FH	Width W	Height H	Suggested dimensions
Single leaf outward opening	FH/FB≥1	28kg/34kg	415~650	415~1700	460~780	460~1830	650x1200
Single leaf outward hanging	FH/FB≤1	50kg/80kg	415~1400	415~1100	460~1530	460~1230	1000x750
Double leaf outward folio opening	FH/FB≥1	28kg/34kg	415~650	415~1300	460~700	460~1350	600x1200



PRODUCTS

NOW Outward Opening Window Hardware System

Hardware Features

Hardware fast assembly design

- Mature and standard processing technique is adopted to realize the fast assembly of the C-shape hardware slots, effectively improving the processing efficiency by 70%.

Effective anti-drop design

- Leading outward opening window hardware patented technology and clamp-on anti-falling of steel plate security design;

Ultra-high sealing performance design

- Hinges with point-locking function are used to wrap the angles and lock the points, which enhances the locking effects of the turning side;
- The strong back point-locking structure ensures 7 lock points on single window, which effectively guarantees the sealing performance of the opening windows under the circumstances of typhoon.

Security angle and anti-falling design

- Opening windows are designed with multi-angle positioning, meeting the safety requirements of special window patterns;

Security and anti-falling design

- Unique anti-prizing design technique, in accordance with EU WK2 security level.

Short torque and noise reduction design

- Transmission structure is moved inward, making the transmission fork short and the force upon the handle smaller.
- High-intensive noise reduction and transmission design.

Superior anti-corrosion design for parts

- Capable of withstanding the neutral salt spray test 240 hours longer than that of the EU standard, more suitable for coastal and harsh environments.

Hardware Configuration

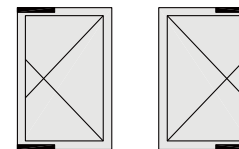

Luxury handle Standard handle

More type of handles are available

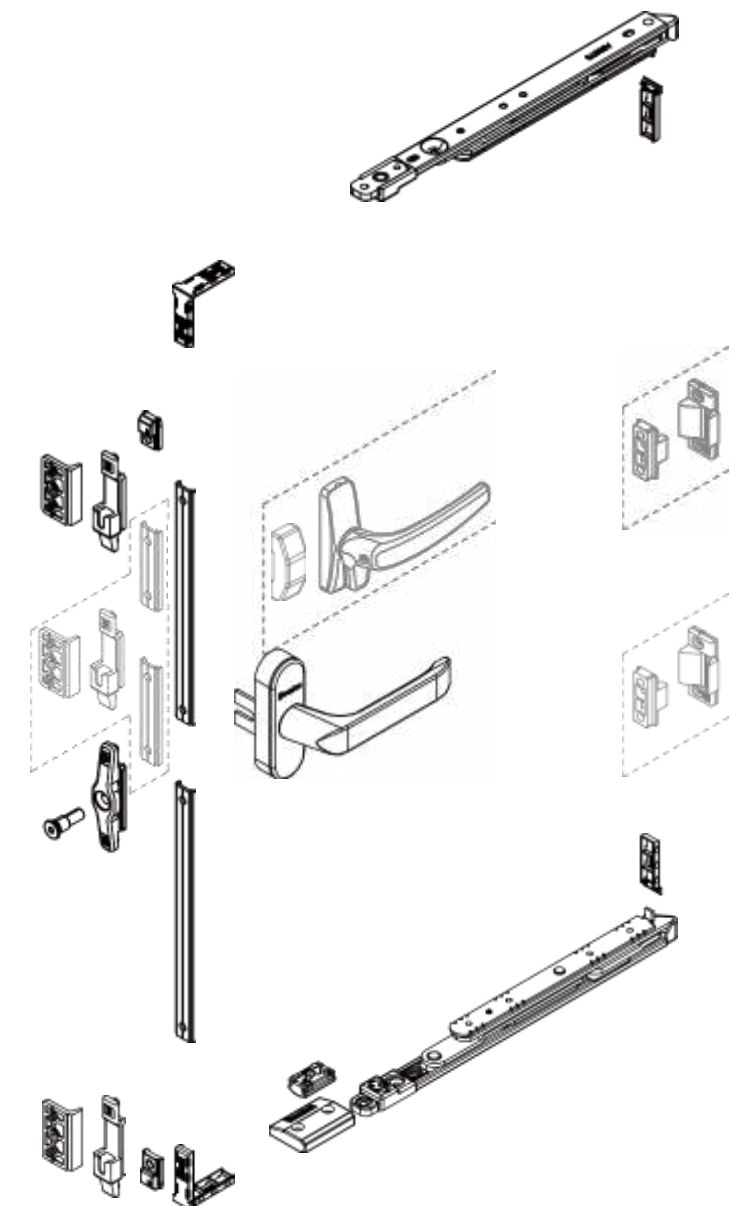

PRODUCTS

NOW55 Outward Casement Window System



Product Profile

NOW55 Outward Casement Window System has innovative structure which gives parallel and level visual effect of the inner and outer frames and sashes. It integrates convenient assembly hardware and is fully symbolized in modern high quality life. The product not only has all functions of ordinary casement window, but also has leisure opening mode. It can realize locking at every opening angle and free selection for lighting and ventilation.

Technical Parameters

Frame depth/mm	55/77mm
Sash depth/mm	55mm
Visible Width of Inner/Outer Frame	70/18mm
Visible Width of Inner/Outer Sash	20/65mm

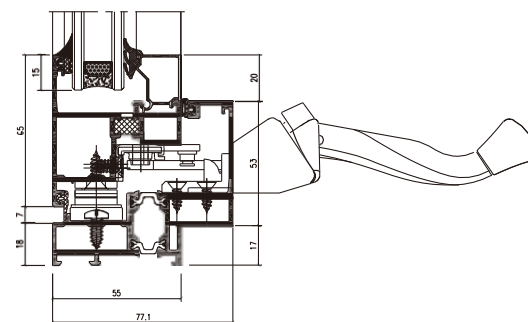

Performance

Thermal insulation	The K value for thermal insulation can be up to 1.8W/m ² .K (Grade 6)
Sound proof	The attenuation value of sound after passing windows can reach 40dB (Grade 5) (Depending on glass configuration)
Air Permeability	The value exceeds 600Pa (Grade 8)
Water tightness	The value exceeds 700 Pa (Grade 6)
Wind load resistance	The value can reach 4500Pa (Grade 8)



Product Features

More Application

- Abundant configuration options to satisfy application requirements of different window patterns
- No matter that cupboard is by the window or withstanding large sash, it can be opened smoothly.

Convenient for Collocation

- Collocated with window screen. And the visible area is simple & pleasing with excellent anti-mosquito effect.

More Security

- Handle is installed on the frame. With low handle height, it can be opened by swinging the operator.

Easy Assembling

- Standard assembling technique, effectively improving the assembling efficiency by 50%

Technical Standard

- Meet EU CE standard, USA ASTM standard and China GB standard.

Openable Dimension Range

Option of opening	Height-width ratio	Hardware load bearing	Dimension range(mm)				
			Net dimensions of sash (mm)		Module dimensions (mm)		
			Width FB	Height FH	Width W	Height H	Suggested dimensions
Single leaf outward casement opening	FH/FB≥1	30kg/38kg	420~750	415~1700	470~800	460~1830	650x1200



PRODUCTS

NOW55 Awning System

likezhou
2015-11-04 10:46:18

Casement Product Profile

NOW55 awning system has leisure opening mode. It can realize locking at every opening angle and free selection for lighting and ventilation. It's product has innovative structure which gives parallel and level visual effect of the inner and outer frames and sashes. It's fully symbolized in modern high quality life.

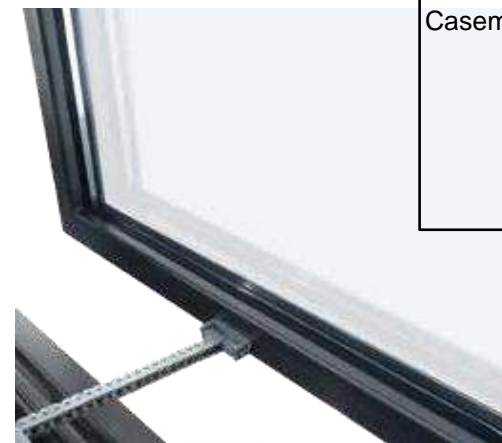

Hardware Features

Fast Assembly Design

- Standardized design of friction stay & rail, effectively improving installation efficiency

Ultra-high Sealing Performance Design

- Vertical lock structure independently guarantees the sealing performance of the windows

Security Design

- Friction stay with multi-angle positioning and excellent anti-falling function

Convenient Operation

- Force-saved swing operator design, to be operated casually.

Durability Design

- Hardware fittings are made through several layers of coating processing, with high quality coating effect and anti-corrosion function
- Compliance with AAMA904.1 standard

Technical Parameters

Frame depth/mm	55/105mm
Sash depth/mm	55mm
Visible Width of Inner/Outer Frame	43/19mm
Visible Width of Inner/Outer Sash	40/65mm

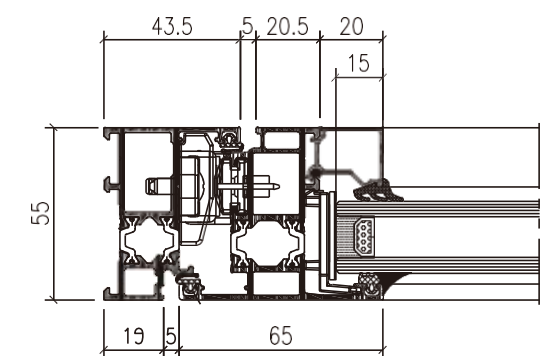

Performance

Thermal insulation	The K value for thermal insulation can be up to $2.1W/m^2.K$ (Grade 6)
Sound proof	The attenuation value of sound after passing windows can reach 40dB (Grade 5) (Depending on glass configuration)
Air tightness	The value exceeds 600Pa (Grade 8)
Water tightness	The value exceeds 700 Pa (Grade 6)
Wind load resistance	The value can reach 4500Pa (Grade 8)



Product Features

More Application

- Applicable for window in high position, no matter the window is by the cupboard or withstanding large sash, it can be opened easily.
- Maximum opening distance is up to 300mm

More Security

- Handle is installed on the frame. With low handle height, it can be opened by swinging the operator.

Easy Assembling

- Standard assembling technique, effectively improving assembling efficiency
- Simple & practical hardware fittings, easy for installation.

Technical Standard

- Meet EU CE standard, USA ASTM standard and China GB standard.

Openable Dimension Range

Option of opening	Height-width ratio	Hardware load bearing	Dimension range(mm)				
			Net dimensions of sash (mm)		Module dimensions (mm)		
			Width FB	Height FH	Width W	Height H	Suggested dimensions
Top hung	FH/FB≥1	36kg~80kg	415~1400	415~1100	460~1500	460~1200	1000x700

Hardware Features

Convenient for Operation

- Force-saved swing operator design, to be operated casually.
- Adjustable opening angle with mechanism locking system
- Simple & fast installation method, force is divided effectively.

Durability Design

- The material is mostly high strength structural steel, engineering plastic and zinc alloy. Superior anti-corrosion and longer service life.

PRODUCTS

NOWS50.N Outward Opening Window System



Product Profile

NOWS50.N outward opening window system provides a comprehensive solution to the building. This product has high quality performance. Its parallel and level design of the outer frame and sash gives the building a pretty simple and pleasing look. It is suitable to be used in medium- and high-end projects.

Technical Parameters

Frame depth/mm	50mm
Sash depth/mm	42mm
Visible width of inner/outer frame/mm	43.5/19mm
Visible width of inner/outer sash/mm	43.5/58mm
Sash's clamping glass thickness range/mm	22~24mm (open casement) /5~29mm (fixed casement)

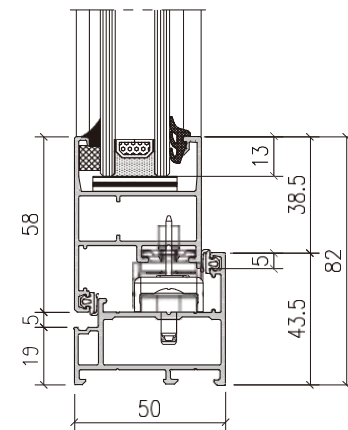

Performance

Thermal insulation	The K value for thermal insulation can reach 3.5 W/m ² .k (Grade 3) (depending on the glass configuration)
Sound proof	The attenuation value of sound after passing windows can reach 34 dB(Grade 3) (depending on the glass configuration)
Air tightness	The value exceeds 600 Pa.(Grade 8)
Water tightness	The value exceeds 700 Pa.(Grade 6)
Wind load resistance	The value can reach 4000 Pa.(Grade 7)



Product Features

Wider application

- Abundant configuration options to satisfy application requirements of different window patterns.

More secure for use

- Adopting anti-falling security safety design

More convenient processing

- Mature and standard processing technique effectively improves the processing efficiency by 50%.
- Quick positioning and adjustable fast assembly of friction hinges, lock points and lock seats.

Longer service life

- Repeated opening design up to 50,000 times (GB 10,000 times), in accordance with the lifespan of 30 years.

Technical standard

- Compliance with EU CE standard, USA ASTM standard and Chinese GB standard.

Openable Dimension Range

Option of opening	Height-width ratio	Hardware load bearing	Dimension range(mm)				
			Net dimensions of sash (mm)		Module dimensions (mm)		
			Width FB	Height FH	Width W	Height H	Suggested dimensions
Single leaf outward opening	FH/FB≥1	28kg/34kg	378~600	378~1500	426~706	426~1606	600x1200
Single leaf outward hanging	FH/FB≤1	50kg/80kg	378~1400	378~1000	426~1506	426~1106	1000x750
Double leafs outward folio opening	FH/FB≥1	28kg/34kg	378~600	378~1300	426~648	426~1348	600x1200

PRODUCTS

NOWS55 Outward Opening Window System



Product Profile

NOWS55 outward opening window system provides a comprehensive solution to the building. Its product has high quality performance. Its parallel and level design of the outer frame and sash gives the building a pretty simple and pleasing look. It is suitable to be used in medium- and high-end projects where the basic thermal insulation requirements are to be met.

Technical Parameters

Frame depth/mm	55mm
Sash depth/mm	46.4mm
Visible width of inner/outer frame/mm	43.5/19mm
Visible width of inner/outer sash/mm	43.5/58mm
Sash's clamping glass thickness range/mm	22~24mm (open casement) /10~34mm (fixed casement)

Performance

Thermal insulation	The K value for thermal insulation can reach 2.1 W/m ² .k (Grade 6) (depending on the glass configuration)
Sound proof	Its attenuation value of sound after passing windows can reach 40 dB(Grade 5) (depending on the glass configuration)
Air tightness	Its value exceeds 600 Pa (Grade 8)
Water tightness	Its value exceeds 700 Pa (Grade 6)
Wind load resistance	Its value can reach 4500 Pa (Grade 8)

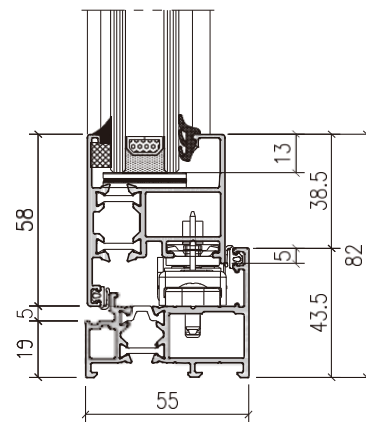

Product Features

Wider application

- Abundant configuration options to satisfy application requirements of different window patterns.

More secure for use

- Adopting anti-falling security design;

More convenient processing

- Mature and standard processing technique effectively improves the processing efficiency by 50%.
- Quick positioning and adjustable fast assembly of friction hinges, lock points and lock seats.

Longer service life

- Repeated opening design up to 50,000 times (GB 10,000 times), in accordance with the lifespan of 30 years.

Technical standard

- Compliance with EU CE standard, USA ASTM standard and Chinese GB standard.

Openable Dimension Range

Option of opening	Height-width ratio	Hardware load bearing	Dimension range(mm)				
			Net dimensions of sash (mm)		Module dimensions (mm)		
			Width FB	Height FH	Width W	Height H	Suggested dimensions
Single leaf outward opening	FH/FB≥1	28kg/34kg	378~600	378~1500	426~706	426~1606	600x1200
Single leaf outward hanging	FH/FB≤1	50kg/80kg	378~1400	378~1000	426~1506	426~1106	1000x750
Double leaf outward folio opening	FH/FB≥1	28kg/34kg	378~600	378~1300	426~648	426~1348	600x1200



PRODUCTS

NOWS Outward Opening Window Hardware System

Hardware Features

Hardware fast assembly design

- Mature and standard processing technique is adopted to realize the fast assembly of the C-shaped hardware slots, effectively improving the processing efficiency by 70%.

ERective anti-drop design

- Clamp-on anti-falling of steel plate security design;

Ultra-high sealing performance design

- Hinges with point-locking function are used to wrap the angles and lock the points, which enhances the locking effects of the turning side;
- The strong back point-locking structure ensures 7 locking points on single window, which effectively guarantees the sealing performance of the opening windows under the circumstances of typhoon.

Security angle and anti-falling design

- Opening windows are designed with multi-angle positioning, meeting the safety requirements of special window patterns;

Short torque and noise reduction design

- Transmission structure is moved inward, making the transmission fork short and the force upon the handle smaller.
- High-intensive noise reduction and transmission design.

Superior anti-corrosion design for parts

- Capable of withstanding the neutral salt spray test 240 hours longer than that of the EU standard, more suitable for coastal and harsh environments

Hardware Configuration

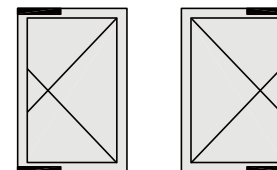

Luxury handle Standard handle

More type of handles are available

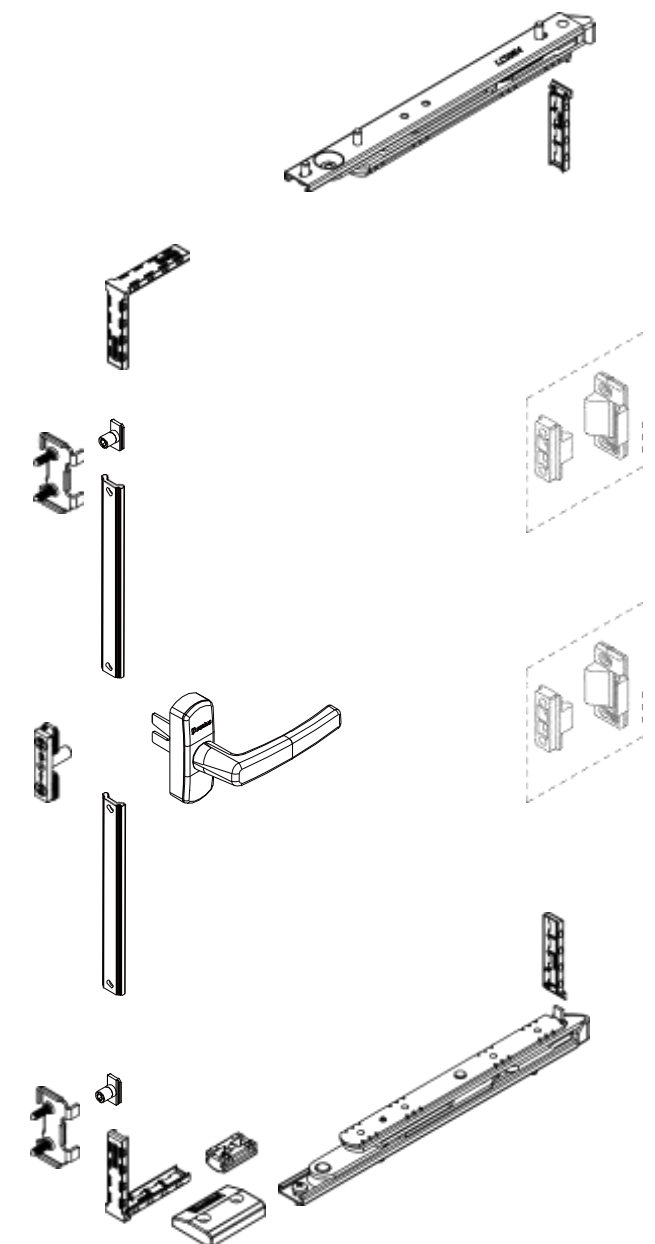

PRODUCTS

EOW50.N Outward Opening Window System



Product Profile

EOW50.N is a non-thermal insulating outward opening window system. Through the optimization of the structure and the processing technique, the product is highly cost-effective and suitable to be used in medium-end projects.

Technical Parameters

Frame depth/mm	50mm
Sash depth/mm	41.4mm
Visible width of inner/outer frame/mm	38.5/14mm
Visible width of inner/outer sash/mm	43.5/53mm
Sash's clamping glass thickness range/mm	22~24mm (open casement) /5~29mm (fixed casement)

Performance

Thermal insulation	The K value for thermal insulation can reach $3.5 \text{ W/m}^2\cdot\text{K}$ (Grade 3) (depending on the glass configuration)
Sound proof	the attenuation value of sound after passing windows can reach 34 dB(Grade 3) (depending on the glass configuration)
Air tightness	the value exceeds 600 Pa (Grade 8)
Water tightness	the value exceeds 700Pa (Grade 6)
Wind load resistance	the value can reach 3600 Pa (Grade 6)

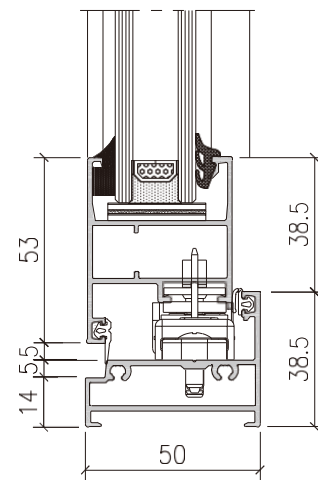

Product Features

Wider application

- Abundant configuration options to satisfy different windows application requirements.

More secure for use

- Adopting anti-falling security design

More convenient processing

- Mature and standard processing technique effectively improves the processing efficiency by 50%.
- Quick positioning and adjustable fast loading friction hinge and lock point and lock seat.

Longer service life

- Design can be repeatedly opened up to 50,000 times (GB 10,000 times), in accordance with the lifespan of 30 years.

Technical standard

- Compliance with EU CE standard, USA ASTM standard and Chinese GB standard.

Openable Dimension Range

Option of opening	Height-width ratio	Hardware load bearing	Dimension range(mm)				
			Net dimensions of sash (mm)		Module dimensions (mm)		
			Width FB	Height FH	Width W	Height H	Suggested dimensions
Single leaf outward vertical hinged opening	FH/FB≥1	28kg/34kg	378~600	378~1500	418~640	422~1544	650x1200
Single leaf outward hanging	FH/FB≤1	50kg/80kg	378~1400	378~1000	418~1440	422~1044	1000x750

PRODUCTS

EOW55 Outward Opening Window System



Product Profile

EOW55 is a thermal insulating outward opening window system. Through the optimization of the structure and the processing technique, the product is highly cost-effective and suitable to be used in medium-end projects where the basic thermal insulation is required.

Technical Parameters

Frame depth/mm	55mm
Sash depth/mm	46.4mm
Visible width of inner/outer frame/mm	38.5/14mm
Visible width of inner/outer sash/mm	43.5/53mm
Sash's clamping glass thickness range/mm	22~24mm (open casement) /10~34mm (fixed casement)

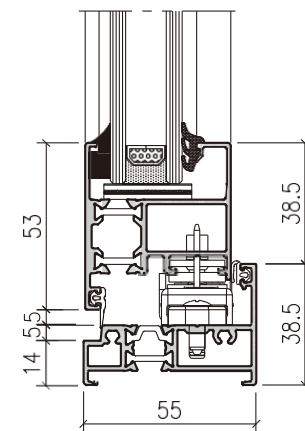

Performance

Thermal insulation	The K value for thermal insulation can reach 2.1W/m ² .k (Grade 6) (depending on the glass configuration)
Sound proof	the attenuation value of sound after passing windows can reach 40 dB(Grade 5) (depending on the glass configuration)
Air tightness	the value exceeds 600 Pa (Grade 8)
Water tightness	the value exceeds 700Pa (Grade 6)
Wind load resistance	the value can reach 4300 Pa(Grade 7)



Product Features

Wider application

- Abundant configuration options to satisfy different windows application requirements.

More secure for use

- Adopting anti-falling security design

More convenient processing

- Mature and standard processing technique effectively improves the processing efficiency by 50%.
- Quick positioning and adjustable fast assembly of friction hinges, lock points and lock seats.

Longer service life

- Repeated opening design up to 50,000 times (GB 10,000 times), in accordance with the lifespan of 30 years.

Technical standard

- Compliance with EU CE standard, USA ASTM standard and Chinese GB standard.

Openable Dimension Range

Option of opening	Height-width ratio	Hardware load bearing	Dimension range(mm)				
			Net dimensions of sash (mm)		Module dimensions (mm)		
			Width FB	Height FH	Width W	Height H	Suggested dimensions
Single leaf outward vertical hinged opening	FH/FB≥1	28kg/34kg	378~600	378~1500	418~640	422~1544	650x1200
Single leaf outward hanging	FH/FB≤1	50kg/80kg	378~1400	378~1000	418~1440	422~1044	1000x750



PRODUCTS

EOW Outward Opening Window Hardware System

Hardware Features

Hardware fast assembly design

- Mature and standard process is adopted to realize the fast assembly of the C-shape hardware slots, effectively improving the processing efficiency by 70%.

ERective anti-drop design

- Clamp-on anti-falling of steel plate security design;

Ultra-high sealing performance design

- Hinges with point-locking function are used to wrap the angles and lock the points, which enhances the locking effects of the turning side;
- The strong back point-locking structure ensures 7 locking points on single window, which effectively guarantees the sealing performance of the opening windows under the circumstances of typhoon.

Security angle and anti-falling design

- Opening windows are designed with multi-angle positioning, meeting the safety requirements of special window patterns;

Short torque and noise reduction design

- Transmission structure is moved inward, making the transmission fork short and the force upon the handle smaller.
- High-intensive noise reduction and transmission design.

Superior anti-corrosion design for parts

- Capable of withstanding the neutral salt spray test 240 hours longer than that of the EU standard, more suitable for coastal and harsh environments

Hardware Configuration

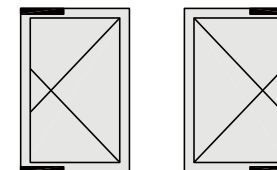

Luxury handle Standard handle

More type of handles are available

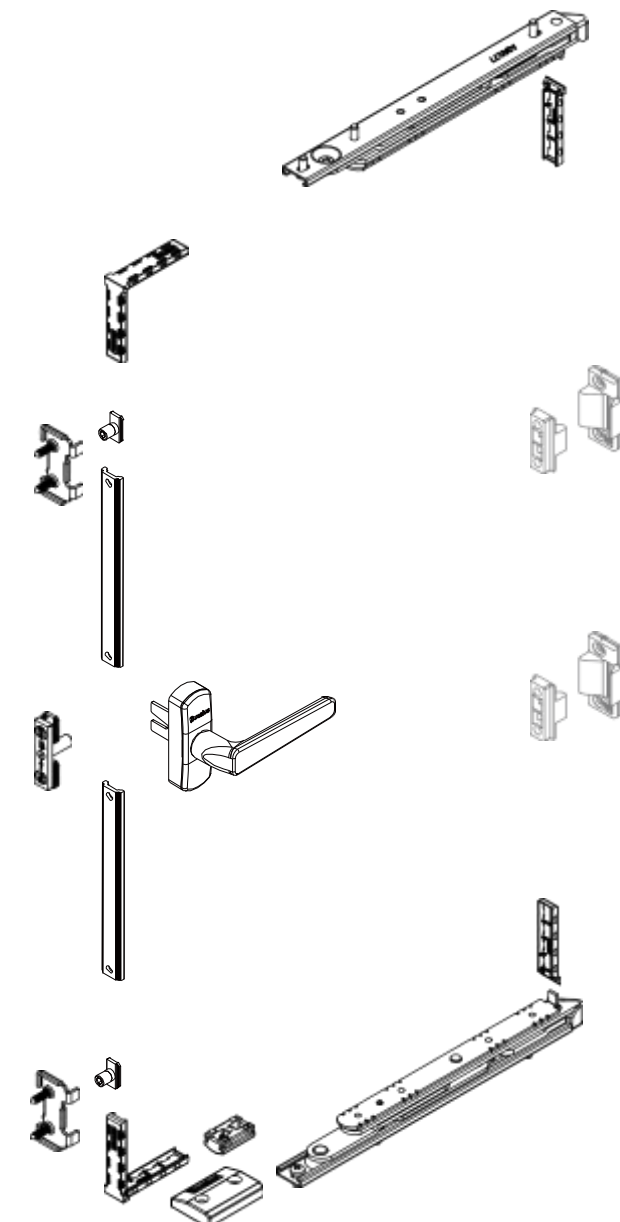

PRODUCTS

NW50.N Tilt & Turn Window System



Product Profile

NW50.N tilt & turn window system provides a comprehensive solution to the building. Triple sealing is done to the product with the adhesive tape. The middle adhesive tape gives full play to the rain screen principle, ensuring the good air tightness and water tightness of the product. The higher hardware load bearing can ensure the opening of big modules, which will meet the partition requirements of the building more readily. Its parallel and level design of the outer frame and sash gives the building a pretty simple and pleasing look. All these make it suitable to be used in medium- and high-end projects.

Technical Parameters

Frame depth/mm	50mm
Sash depth/mm	60mm
Visible width of inner/outer frame/mm	28/48mm&39/59mm
Visible width of inner/outer sash/mm	45/33.5mm & 56/44.5mm
Sash's clamping glass thickness range/mm	5~29mm

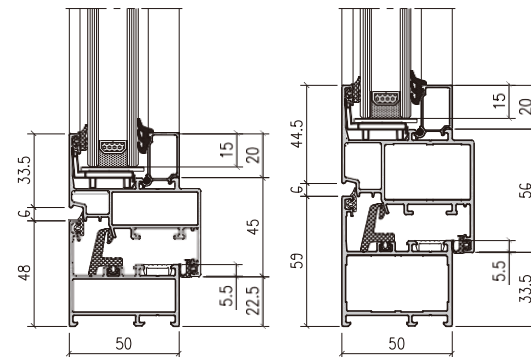

Performance

Thermal insulation	The K value for thermal insulation can reach 3.5 W/m ² .k (Grade 3) (depending on the glass configuration)
Sound proof	The attenuation value of sound after passing windows can reach 35 dB(Grade 4) (depending on the glass configuration)
Air tightness	The value exceeds 600 Pa (Grade 8)
Water tightness	The value exceeds 700 Pa (Grade 6)
Wind load resistance	The value can reach 4000 Pa (Grade 7)



Product Features

Excellent performance

- Water tightness level 6, air tightness level 8, the sound insulation up to 35 dB;
- Thermal insulation K-value can reach 2.1 at most.

Super anti-theft performance

- Special design for anti-prizing, in accordance with EU WK2 security level.

More convenient processing

- Mature and standard processing technique, improving the processing efficiency.

Longer service life

- Repeated opening design up to 50,000 times (GB 10,000 times), in accordance with the lifespan of 30 years.

Technical standard

- Compliance with EU CE standard, USA ASTM standard and Chinese GB standard.

Openable Dimension Range

Option of opening	Height-width ratio	Hardware load bearing	Dimension range(mm)				
			Net dimensions of sash (mm)		Module dimensions (mm)		
			Width FB	Height FH	Width W	Height H	Suggested dimensions
Single leaf tilt and turn	FH/FB≥1.25	100kg/150kg	350~1200	700~2800	395~1267	745~2867	750x1200
Single leaf inward opening	FH/FB≥1.25	70kg/100kg	350~1200	700~2800	395~1267	745~2867	750x1200
Single leaf inward turning	FH/FB≤0.8	90kg/100kg	700~2800	350~1400	745~2867	395~1467	1200x800
Double leaf inward folio opening	FH/FB≥1.25	70kg/100kg	350~1200	700~2100	375~1236	745~2167	650x1200

PRODUCTS

NW55 Tilt & Turn Window System



Product Profile

NW55 tilt & turn window system provides a comprehensive solution to the building. Triple sealing is done to the product with the adhesive tape. The middle adhesive tape gives full play to the rain screen principle, ensuring the good air tightness and water tightness of the product. The higher hardware load bearing can ensure the opening of big modules, which will meet the partition requirements of the building more readily. Its parallel and level design of the outer frame and sash gives the building a pretty simple and pleasing look. All these make it quite suitable to be used in high-end projects where basic thermal insulation requirements are to be met.

Technical Parameters

Frame depth/mm	55mm
Sash depth/mm	65mm
Visible width of inner/outer frame/mm	28/48mm & 39/59mm
Visible width of inner/outer sash/mm	45/33.5mm & 56/44.5mm
Sash's clamping glass thickness range/mm	10~34mm

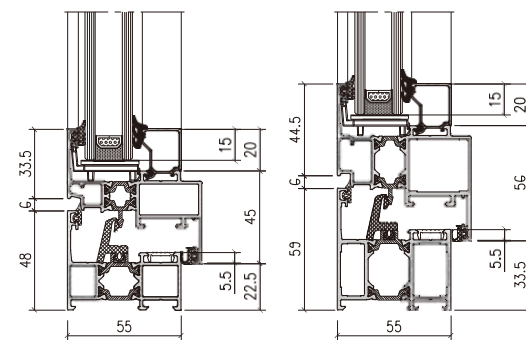

Performance

Thermal insulation	The K value for thermal insulation can reach 2.1 W/m ² .k (Grade 6) (depending on the glass configuration)
Sound proof	The attenuation value of sound after passing windows can reach 40 dB (Grade 5) (depending on the glass configuration)
Air tightness	The value exceeds 600 Pa (Grade 8)
Water tightness	The value exceeds 700 Pa (Grade 6)
Wind load resistance	The value can reach 4500 Pa (Grade 8)



Product Features

Excellent performance

- Water tightness level 6, air tightness level 8, the sound insulation up to 40 dB;
- Thermal insulation K-value can reach 2.1 at most.

Super anti-theft performance

- Special design for anti-prizing, in accordance with EU WK2 security level.

More convenient processing

- Mature and standard processing technique improves the processing efficiency.

Longer service life

- Repeated opening design up to 50,000 times (GB 10,000 times), in accordance with the lifespan of 30 years.

Technical standard

- Compliance with EU CE standard, USA ASTM standard and Chinese GB standard.

Openable Dimension Range

Option of opening	Height-width ratio	Hardware load bearing	Dimension range(mm)				
			Net dimensions of sash (mm)		Module dimensions (mm)		
			Width FB	Height FH	Width W	Height H	Suggested dimensions
Single leaf tilt and turn	FH/FB≥1.25	100kg/150kg	350~1200	700~2800	395~1267	745~2867	750x1200
Single leaf inward opening	FH/FB≥1.25	70kg/100kg	350~1200	700~2800	395~1267	745~2867	750x1200
Single leaf inward turning	FH/FB≤0.8	90kg/100kg	700~2800	350~1400	745~2867	395~1467	1200x800
Double leaf inward folio opening	FH/FB≥1.25	70kg/100kg	350~1200	700~2100	375~1236	745~2167	650x1200

PRODUCTS

NW65 Tilt & Turn Window System



Product Profile

NW65 tilt & turn window system provides a comprehensive solution to the building. Triple sealing is done to the product with the adhesive tape. The middle adhesive tape gives full play to the rain screen principle, ensuring the good air tightness and water tightness of the product. The higher hardware load bearing can ensure the opening of big modules, which will meet the partition requirements of the building more readily. Its parallel and level design of the outer frame and sash gives the building a pretty simple and pleasing look. With the wide heat insulation bar containing the heat insulation cotton, the product has obvious thermal insulation effects. All these make it quite suitable to be used in projects that require higher thermal insulation performance.

Technical Parameters

Frame depth/mm	65mm
Sash depth/mm	75mm
Visible width of inner/outer frame/mm	28/48mm & 39/59mm
Visible width of inner/outer sash/mm	45/33.5mm & 56/44.5mm
Sash's clamping glass thickness range/mm	20~44mm

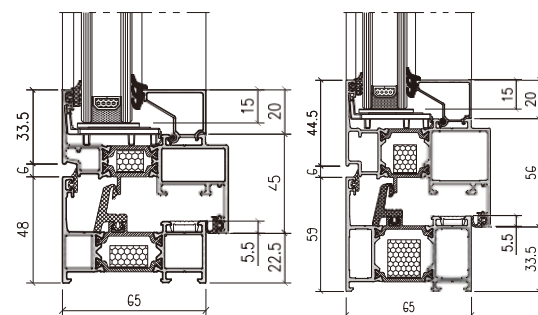

Performance

Thermal insulation	The K value for thermal insulation can reach 1.9 W/m ² .k. (Grade 7) (depending on the glass configuration)
Sound proof	The attenuation value of sound after passing windows can reach 45 dB(Grade 6) (depending on the glass configuration)
Air tightness	The value exceeds 600Pa (Grade 8)
Water tightness	The value exceeds 700 Pa (Grade 6)
Wind load resistance	The value can reach 5000 Pa (Grade 9)



Product Features

Excellent performance

- Water tightness level 6, air tightness level 8 and the sound insulation up to 45 dB;
- Thermal insulation K-value can reach 1.9 at most.

Super anti-theft performance

- Special design for anti-prizing, in accordance with EU WK2 security level.

More convenient processing

- Mature and standard processing technique improves the processing efficiency.

Longer service life

- Repeated opening design up to 50,000 times (GB 10,000 times), in accordance with the lifespan of 30 years.

Technical standard

- Compliance with EU CE standard, USA ASTM standard and Chinese GB standard.

Openable Dimension Range

Option of opening	Height-width ratio	Hardware load bearing	Dimension range(mm)				
			Net dimensions of sash (mm)		Module dimensions (mm)		
			Width FB	Height FH	Width W	Height H	Suggested dimensions
Single leaf tilt and turn	FH/FB≥1.25	100kg/150kg	350~1200	700~2800	395~1267	745~2867	750x1200
Single leaf inward opening	FH/FB≥1.25	70kg/100kg	350~1200	700~2800	395~1267	745~2867	750x1200
Single leaf inward turning	FH/FB≤0.8	90kg/100kg	700~2800	350~1400	745~2867	395~1467	1200x800
Double leaf inward folio opening	FH/FB≥1.25	70kg/100kg	350~1200	700~2100	375~1236	745~2167	650x1200



PRODUCTS

NW Tilt & Turn Window Hardware System

Hardware Features

Hardware fast assembly design

- Mature and standard processing technique is adopted to realize the fast installation of the C-shape hardware slots, effectively improving the processing efficiency by 70%.

Universal standard slots

- The hardware slots follow the European standard V.01. basic sizes, fully taking advantage of the standard resources efficiently at a low cost to get manufactured. They have high universality.

Convenient installation design

- Mature and standard installation technique effectively improves the installation efficiency by 50%.
- Accessory tools and installation tools are equipped, quickening the positioning of lock points and lock seats.

Ultra-high sealing performance design

- The strong point-locking structure is used to make all the four sides of the sash locked uniformly.

Safety and anti-prizing design

- Leading inward opening hardware patented technology and unique anti-prizing design technique are used, which is in accordance with EU WK2 security level.

Superior anti-corrosion design for parts

- Capable of withstanding the neutral salt spray test 240 hours longer than that of the EU standard, more suitable for coastal and harsh environments.

Hardware Configuration

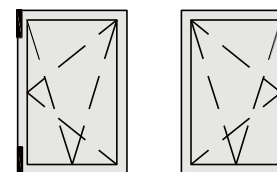

Luxury handle Standard handle

More type of handles are available

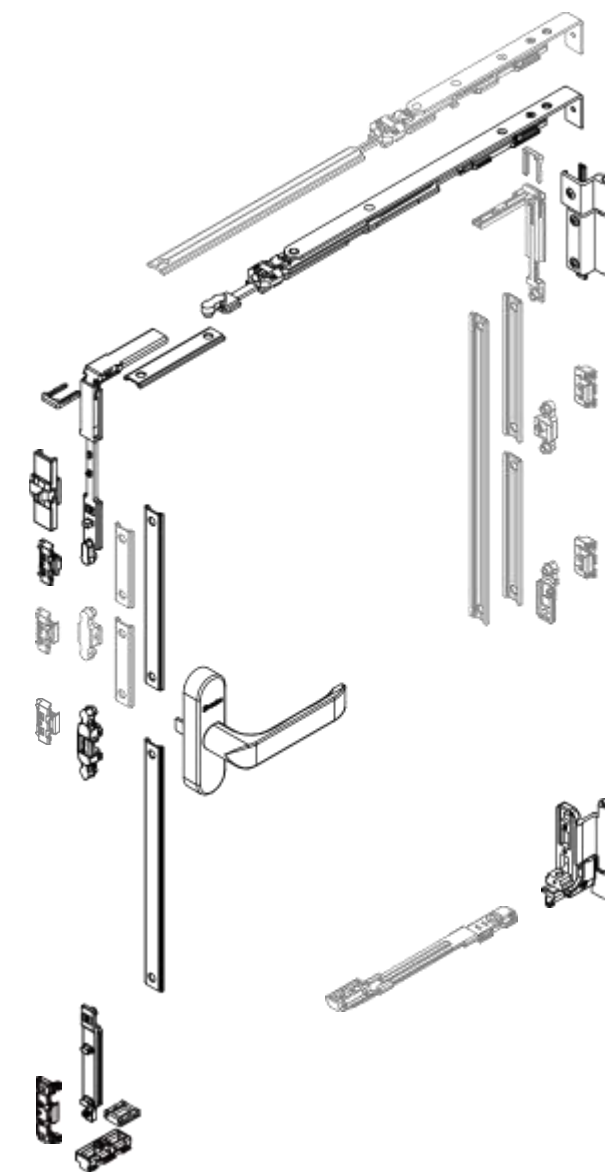

PRODUCTS

NS40.N Sliding Window System



Product Profile

NS40.N sliding window system is an ideal solution for indoor or areas with no additional requirements for thermal insulation. Its compact look makes the sliding window save the indoor and outdoor room to the limit. It is compatible with the side hinged door and window system to meet diverse demands. Its system is moderate in price and combines advanced technology with beauty and simplicity.

Technical Parameters

Frame depth/mm	55/100mm
Sash depth/mm	38mm
Visible width of inner/outer frame/mm	28/50mm&50/50mm
Visible width of inner/outer sash/mm	45/45mm(vertical frame)&78/78mm(horizontal frame)
Sash's clamping glass thickness range/mm	16~24mm

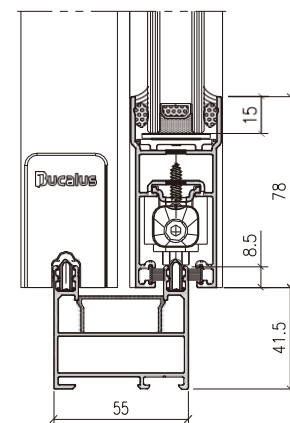

Performance

Thermal insulation	The K value for thermal insulation can reach 4.0 W/m ² .k (Grade 2) (depending on the glass configuration)
Sound proof	the attenuation value of sound after passing windows can reach 32 dB(Grade 3) (depending on the glass configuration)
Air tightness	the value can reach 400 Pa (Grade 4)
Water tightness	the value can reach 300 Pa (Grade 3)
Wind load resistance	the value can reach 4000 Pa (Grade 7)



Product Features

Superior security design

- Hidden anti-prizing lock point and lock seat design, more secure for use.

More convenient assembly

- Standard slot design, quick installation of hardware and accessories effectively improve the processing efficiency by 30%.

Larger window leaf bearing

- Equipped with large bearing pulley block and achieving up to 160 kg window application.

Longer service life

- Replaceable high-quality stainless steel rails, higher strength, longer life, smaller motion resistance and repeated opening design up to 50,000 times (GB 10,000 times), in accordance with the lifespan of 30 years.

Technical standard

- Compliance with EU CE standard, USA ASTM standard and Chinese GB standard.

Openable Dimension Range

Option of opening	Height-width ratio	Hardware load bearing	Dimension range(mm)				
			Net dimensions of sash (mm)		Module dimensions (mm)		
			Width FB	Height FH	Width W	Height H	Suggested dimensions
Sliding	FH/FB<2.5	80kg/160kg	<1180	<1700	<1200	<1800	650x1200

PRODUCTS

NS40 Sliding Window System



Product Profile

NS40 sliding window system is an ideal solution for indoor or areas with no additional requirements for thermal shelter. Its compact look makes the sliding window save the indoor and outdoor room to the limit. It is compatible with the side hinged door and window system to meet diverse demands. It is moderate in price and combines advanced technology with beauty and simplicity.

Technical Parameters

Frame depth/mm	55/100mm
Sash depth/mm	38mm
Visible width of inner/outer frame/mm	28/50mm&50/50mm
Visible width of inner/outer sash/mm	45/45mm(vertical frame) &78/78mm(horizontal frame)
Sash's clamping glass thickness range/mm	16~24mm

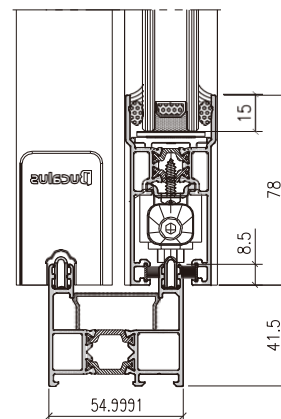

Performance

Thermal insulation	The K value for thermal insulation can reach $3.0W/m^2 \cdot K$ (Grade 4) (depending on the glass configuration)
Sound proof	the attenuation value of sound after passing windows can reach 35 dB(Grade 3) (depending on the glass configuration)
Air tightness	the value can reach 400 Pa (Grade 4)
Water tightness	the value can reach 300 Pa (Grade 3)
Wind load resistance	the value can reach 4000 Pa (Grade 7)



Product Features

Superior security design

- Hidden anti-prizing lock point and lock seat design, more secure for use.

More convenient assembly

- Standard slot design, quick installation of hardware and accessories effectively improve the processing efficiency by 30%.

Larger window leaf bearing

- Equipped with large bearing pulley block and achieving up to 160 kg window application.

Longer service life

- Replaceable high-quality stainless steel rails, higher strength, longer life, smaller motion resistance and repeated opening design up to 50,000 times (GB 10,000 times), in accordance with the lifespan of 30 years.

Technical standard

- Compliance with EU CE standard, USA ASTM standard and Chinese GB standard.

Openable Dimension Range

Option of opening	Height-width ratio	Hardware load bearing	Dimension range(mm)				
			Net dimensions of sash (mm)		Module dimensions (mm)		
			Width FB	Height FH	Width W	Height H	Suggested dimensions
Sliding	FH/FB<2.5	80kg/160kg	<1180	<1700	<1200	<1800	650x1200



PRODUCTS

NS40/NS40.N Sliding Window Hardware System

Hardware Configuration

1A

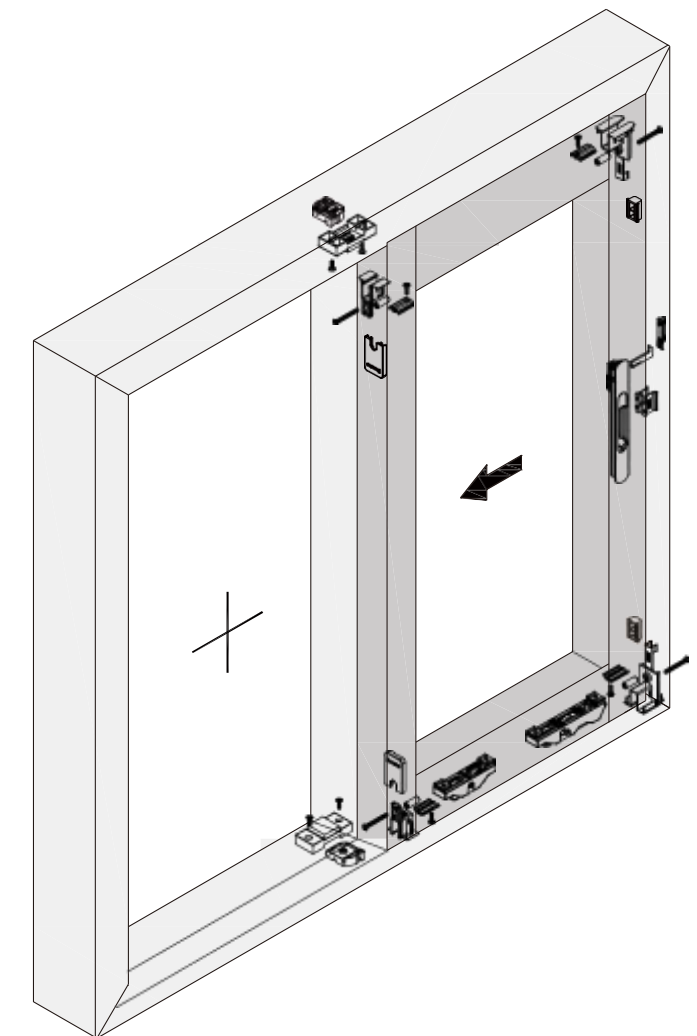
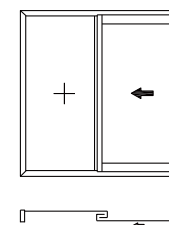

Hardware Features

Hardware fast installation design

- Mature and standard processing technique is adopted to realize the fast installation of the C-shape hardware slots, effectively improving the processing efficiency by 70%.

Convenient installation design

- Mature and standard installing technique effectively improves the installing efficiency by 50%.
- It is equipped with auxiliary tools and installation tools, quickly positioning lock points and lock seats.

Security design

- The leaf frame blocks, the frame seal kit and the security blocks ensure the sealing and increase the safety as well.

Hidden lock seat

- The notch of the frame is positioned to install. The positioning is of high precision and the lock seat is hidden to avoid knocking.

Anti-corrosion design for parts

- Capable of withstanding the neutral salt spray test 72 hours longer than that of the GB standard, suitable for coastal and harsh environments.

PRODUCTS

Door System



ND50.N



ND55



ND65



NS55



NS55.N



NS55.N-300



NS55-300



NS65.N



NS65



NS40.N.D



NS40.D



NFD70

ND Side Hinged Door

ND50.N Side Hinged Door	51/52
ND55 Side Hinged Door	53/54
ND65 Side Hinged Door	55/56
ND Side hinged door hardware system	57/58

NS Sliding Door

NS55.N Sliding Door	59/60
NS55 Sliding Door	61/62
NS55/NS55.N Sliding Door Hardware System	63/64
NS40.N.D sliding door	65/66
NS40.D Sliding Door	67/68
NS40.D/NS40.N.D Sliding Door Hardware System	69/70
NS46 Slim Sliding Door System	71/72

NS Lift & Slide Door

NS65.N Lift & Slide Door	73/74
NS65 Lift & Slide Door	75/76
NS55.N-300 Lift & Slide Door	77/78
NS55-300 Lift & Slide Door	79/80
NS Lift & Slide Door Hardware System	81/82

NFD Folding Door

NFD70 Folding Door	83/84
NFD70 Folding Door Hardware System	

likezhou 85/86
2015-11-04 10:50:50

Bi-Folding

Option of Opening

likezhou
2015-11-04 10:44:09

Configuration

Door System	ND50.N	ND55	ND65	NS55	NS55.N	NS55.N30	NS55.30	NS65.N	NS65	NS40.ND	NS40.D	NFD70

Door System	ND50.N	ND55	ND65	NS55	NS55.N	NS55.N30	NS55.30	NS65.N	NS65	NS40.ND	NS40.D	NFD70

PRODUCTS

ND50.N Side Hinged Door System



Product Profile

ND50.N Side hinged door system is suitable to be used in areas where no thermal insulation is required. The system is mature and stable. It has superior anti-theft performance, flexible compatibility with door systems and simple processing technique. Its hinge is three-dimensionally adjustable and easy to install. After the installation, fine tuning can be made on the hinge directly to ensure the installation precision.

Technical Parameters

Frame depth/mm	50mm
Sash depth/mm	60mm
Visible width of inner/outer frame/mm	49/69mm & 69/49mm
Visible width of inner/outer sash/mm	76/64.5mm & 44.5/96mm
Sash's clamping glass thickness range/mm	5~29mm

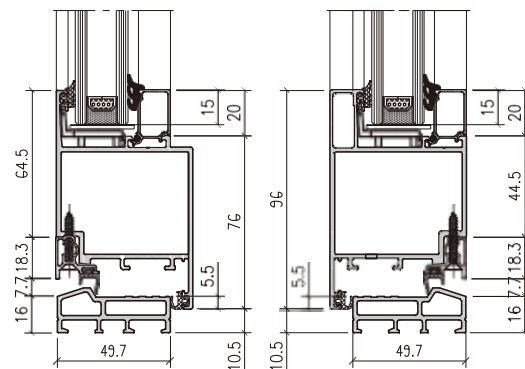

Performance

Thermal insulation	The K value for thermal insulation can reach 3.5 W/m ² .k (Grade 3) (depending on the glass configuration)
Sound proof	The attenuation value of sound after passing doors can reach 35 dB(Grade 4) (depending on the glass configuration)
Air tightness	The value can reach 600 Pa (Grade 6)
Water tightness	The value can reach 300 Pa (Grade 3)/ High doorsill 700 Pa (Grade 6)
Wind load resistance	The value can reach 5000 Pa (Grade 9)



Product Features

Full system compatibility

- Realizing the perfect integration with other Bucalus products.

Excellent performance

- Barrier-free doorsill design. With high doorsill structure adopted, the water tightness value of the door can be up to 700 Pa, solving the water tightness problem of the outer door.

Superior security design

- Unique lock point and lock seat design, in accordance with EU WK2 security level.

Longer service life

- Integrated design, hardware and profile perfect matching with high precision, repeated opening up to 120,000 times (GB 100,000 times), in accordance with lifespan of 30 years.

Technical standard

- Compliance with EU CE standard, USA ASTM standard and Chinese GB standard.

Openable Dimension Range

Option of opening	Height-width ratio	Hardware load bearing	Dimension range(mm)				
			Net dimensions of sash (mm)		Module dimensions (mm)		
			Width FB	Height FH	Width W	Height H	Suggested dimensions
Single leaf side-hinged opening	FH/FB≥2.0	100kg/120kg	<1000	<2500	<1050	<2550	850x2300
Double leafs folio opening	FH/FB≥2.0 single leaf	100kg/120kg	<1000	<2500	<1050	<2550	850x2300

PRODUCTS

ND55 Side Hinged Door System



Product Profile

ND55 Side hinged door system is mature and stable. It has superior anti-theft performance, flexible compatibility with door systems and simple processing technique. Its hinge is three-dimensional adjustable and easy to install. After the installation, fine tuning can be made on the hinge directly to ensure the installation precision. All these make the product quite suitable for project applications that have basic requirements on thermal insulation.

Technical Parameters

Frame depth/mm	55mm
Sash depth/mm	65mm
Visible width of inner/outer frame/mm	49/69mm & 69/49mm
Visible width of inner/outer sash/mm	76/64.5mm & 44.5/96mm
Sash's clamping glass thickness range/mm	10~34mm

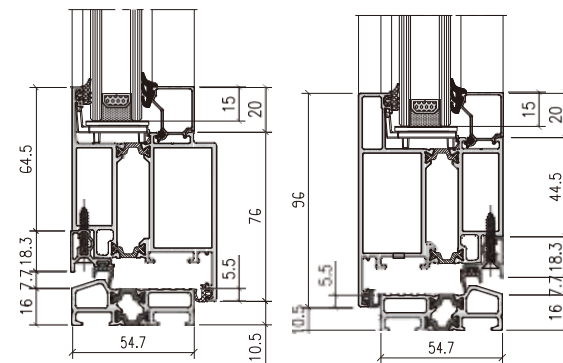

Performance

Thermal insulation	The K value for thermal insulation can reach 2.1 W/m ² .k. (Grade 6) (depending on the glass configuration)
Sound proof	The attenuation value of sound after passing doors can reach 38 dB(Grade 4) (depending on the glass configuration)
Air tightness	The value exceeds 600 Pa(Grade 6)
Water tightness	The value can reach 300 Pa (Grade 3)/ High doorsill 700 Pa (Grade 6)
Wind load resistance	The value can reach 5000 Pa (Grade 9)



Product Features

Full system compatibility

- Realizing the perfect integration with other Bucalus products.

Excellent performance

- Barrier-free doorsill design. With high doorsill structure adopted, the water tightness value of the door can be up to 700 Pa, solving the water tightness problem of the outer door.

Superior security design

- Unique lock point and lock seat design, in accordance with EU WK2 security level.

Longer service life

- Integrated design, hardware and profile perfect matching with high precision, repeated opening up to 120,000 times (GB 100,000 times), in accordance with lifespan of 30 years.

Technical standard

- Compliance with EU CE standard, USA ASTM standard and Chinese GB standard.

Openable Dimension Range

Option of opening	Height-width ratio	Hardware load bearing	Dimension range(mm)				
			Net dimensions of sash (mm)		Module dimensions (mm)		
			Width FB	Height FH	Width W	Height H	Suggested dimensions
Single leaf side-hinged opening	FH/FB≥2.0	100kg/120kg	<1000	<2500	<1050	<2550	850x2300
Double leafs folio opening	FH/FB≥2.0 single leaf	100kg/120kg	<1000	<2500	<1050	<2550	850x2300

PRODUCTS

ND65 Side Hinged Door System



Product Profile

ND65 Side hinged door system is mature and stable. It has superior anti-theft performance, flexible compatibility with door systems and simple processing technique. Its hinge is three-dimensional adjustable and easy to install. After the installation, fine tuning can be made on the hinge directly to ensure the installation precision. All these make the product quite suitable for project applications that have higher requirements on thermal insulation.

Technical Parameters

Frame depth/mm	65mm
Sash depth/mm	75mm
Visible width of inner/outer frame/mm	49/69mm & 69/49mm
Visible width of inner/outer sash/mm	76/64.5mm & 44.5/96mm
Sash's clamping glass thickness range/mm	20~44mm

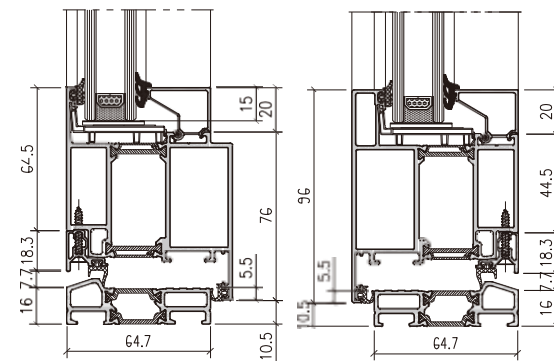

Performance

Thermal insulation	The K value for thermal insulation can reach 1.9 W/m ² .k. (Grade 7) (depending on the glass configuration)
Sound proof	The attenuation value of sound after passing doors can reach 42 dB(Grade 4) (depending on the glass configuration)
Air tightness	The value can reach 600 Pa (Grade 6)
Water tightness	The value can reach 300 Pa (Grade 3)/ High doorsill 700Pa (Grade 6)
Wind load resistance	The value can reach 5000 Pa (Grade 9)



Product Features

Full system compatibility

- Realizing the perfect integration with other Bucalus products.

Excellent performance

- Barrier-free doorsill design. With high doorsill structure adopted, the water tightness value of the door can be up to 700 Pa, solving the water tightness problem of the outer door.

Superior security design

- Unique lock point and lock seat design, in accordance with EU WK2 security level.

Longer service life

- Integrated design, hardware and profile perfect matching with high precision, repeated opening up to 120,000 times (GB 100,000 times), in accordance with lifespan of 30 years.

Technical standard

- Compliance with EU CE standard, USA ASTM standard and Chinese GB standard.

Openable Dimension Range

Option of opening	Height-width ratio	Hardware load bearing	Dimension range(mm)				
			Net dimensions of sash (mm)		Module dimensions (mm)		
			Width FB	Height FH	Width W	Height H	Suggested dimensions
Single leaf side-hinged opening	FH/FB≥2.0	100kg/120kg	<1000	<2500	<1050	<2550	850x2300
Double leafs folio opening	FH/FB≥2.0 single leaf	100kg/120kg	<1000	<2500	<1050	<2550	850x2300



PRODUCTS

ND Side Hinged Door Hardware System

Hardware Features

Hardware fast assembly design

- Mature and standard processing technique is adopted to realize the fast installation of the C-shape hardware slots, effectively improving the processing efficiency by 70%.

Universal standard slots

- The hardware slots follow the European standard V.01. basic sizes, fully taking advantage of the standard resources efficiently at a low cost to get manufactured. They have high universality.

Convenient installation design

- With mature and standard installation technology, effectively improving the installation efficiency by 50%.
- Three-dimensional adjustable columnar hinge with double clamping C-shape slots facilitates the quick positioning of lock points and lock seats.

Folio locking design

- Both leafs being able to be locked independently, side leaf middle driver, and hidden transmission structure.

Security and anti-prizing design

- Leading side hinged door hardware patented technology and unique anti-prizing design technique are used, which is in accordance with EU WK2 security level.

Superior anti-corrosion design for parts

- Capable of withstanding the neutral salt spray test 240 hours longer than that of the EU standard, more suitable for coastal and harsh environments.

Hardware Configuration

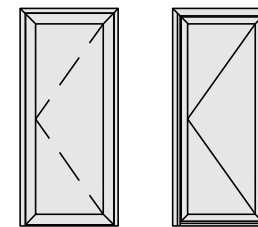

Luxury handle Standard handle

More type of handles are available

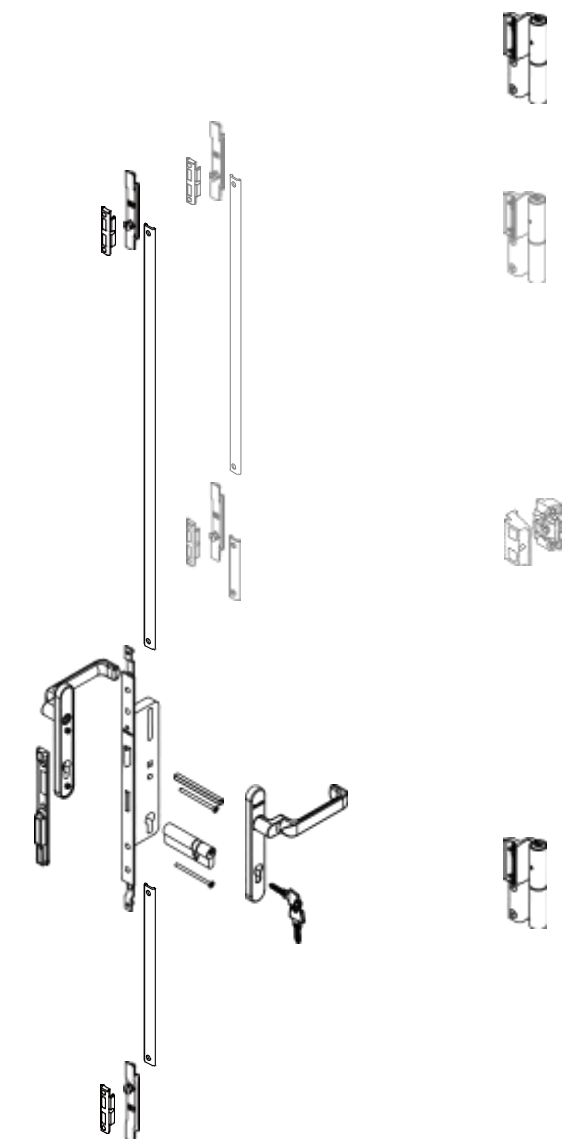

PRODUCTS

NS55.N Sliding Door System



Product Profile

NS55.N sliding door system has single rail, double rail and triple rail frames for choosing. The design provides various sliding opening modes. The small bottom sill plan of the system makes it convenient for going in and out of the building. Various beautiful and reliable sliding reinforcement designs make the wind load resistance value reach Class 7.

Technical Parameters

Frame depth/mm	130/205mm
Sash depth/mm	55mm
Visible width of inner/outer frame/mm	28/47.5mm
Visible width of inner/outer sash/mm	66/86mm
Sash's clamping glass thickness range/mm	10~34mm

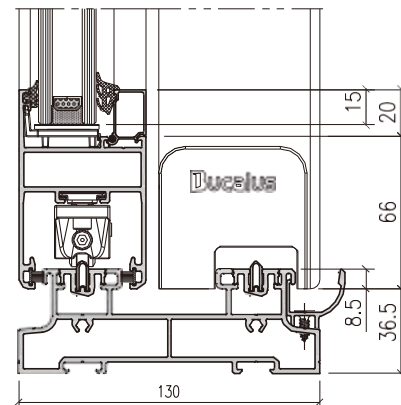

Performance

Thermal insulation	The K value for thermal insulation can reach 3.5 W/m ² .k (Grade 3) (depending on the glass configuration)
Sound proof	The attenuation value of sound after passing doors can reach 31 dB(Grade 3) (depending on the glass configuration)
Air tightness	The value can reach 400 Pa (Grade 4)
Water tightness	The value can reach 300 Pa (Grade 3)
Wind load resistance	The value can reach 4000Pa (Grade 7)



Product Features

Superior security design

- Hidden anti-prizing lock point and lock seat design, more secure for use.

More convenient assembly

- Quick design, hardware and accessories quick installation effectively improve the processing efficiency by 50%.

Longer service life

- Replaceable high-quality stainless steel rails, higher strength, longer life, smaller motion resistance and repeated opening design up to 120,000 times (GB 100,000 times), in accordance with the lifespan of 30 years.

Technical standard

- Compliance with EU CE standard, USA ASTM standard and Chinese GB standard.

Openable Dimension Range

Option of opening	Height-width ratio	Hardware load bearing	Dimension range(mm)				
			Net dimensions of sash (mm)		Module dimensions (mm)		
			Width FB	Height FH	Width W	Height H	Suggested dimensions
Sliding	FH/FB<2.5	80kg/160kg	<1180	<2900	<1200	<3000	900x2300

PRODUCTS

NS55 Sliding Door System



Product Profile

NS55 sliding door system has single rail, double rails and triple rails frames available for selection. The design provides various sliding opening modes. The small bottom sill plan of the system makes it convenient for going in and out of the building. Various beautiful and reliable sliding reinforcement designs make the wind load resistance value reach Class 7. It is suitable for the high-end projects that basic thermal insulation requirements are to be met.

Technical Parameters

Frame depth/mm	130/205mm
Sash depth/mm	55mm
Visible width of inner/outer frame/mm	28/47.5mm
Visible width of inner/outer sash/mm	66/86mm
Sash's clamping glass thickness range/mm	10~34mm

Performance

Thermal insulation	The K value for thermal insulation can reach 2.5 W/m ² .k (Grade 5) (depending on the glass configuration)
Sound proof	The attenuation value of sound after passing doors can reach 35 dB(Grade 4) (depending on the glass configuration)
Air tightness	The value can reach 400 Pa (Grade 4)
Water tightness	The value can reach 300 Pa (Grade 3)
Wind load resistance	The value can reach 4000Pa (Grade 7)

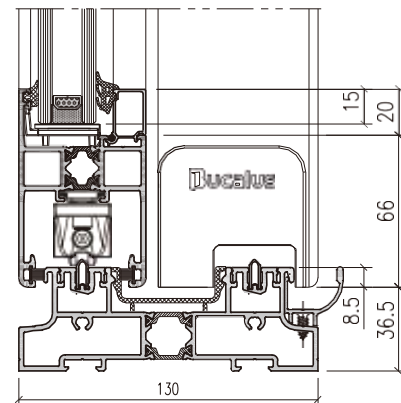

Product Features

Superior security design

- Hidden anti-prizing lock point and lock seat design, more secure for use.

More convenient assembly

- Quick design, hardware and accessories quick installation effectively improve the processing efficiency by 50%.

Longer service life

- Replaceable high-quality stainless steel rails, higher strength, longer life, smaller motion resistance and repeated opening design up to 120,000 times (GB 100,000 times), in accordance with the lifespan of 30 years.

Technical standard

- Compliance with EU CE standard, USA ASTM standard and Chinese GB standard.

Openable Dimension Range

Option of opening	Height-width ratio	Hardware load bearing	Dimension range(mm)				
			Net dimensions of sash (mm)		Module dimensions (mm)		
			Width FB	Height FH	Width W	Height H	Suggested dimensions
Sliding	FH/FB<2.5	80kg/160kg	<1180	<2900	<1200	<3000	900x2300



PRODUCTS

NS55/NS55.N Sliding Door Hardware System

Hardware Features

Hardware fast assembly design

- Mature and standard processing technique is adopted to realize the fast assembly of the C-shape hardware slots, effectively improving the processing efficiency by 70%.

Convenient installation design

- Mature and standard installing technique effectively improves the installing efficiency by 50%.
- It is equipped with auxiliary tools and installation tools, quickly positioning lock points and lock seats.

Security design

- The leaf frame blocks, the frame seal kit and the security blocks ensure the sealing and increase the safety as well.
- Patented locking technology can set multiple lock points according to the door height. Easy operation makes the locking more reliable and secure.

Hidden lock bracket

- Hidden lock point design makes it safer in use. It is beautiful in appearance and reliable in locking.

Superior anti-corrosion design for parts

- Capable of withstanding the neutral salt spray test 240 hours longer than that of the EU standard, more suitable for coastal and harsh environments.

Hardware Configuration

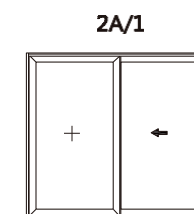

(2A/1, 2A)



Luxury handle

Standard handle

More type of handles are available

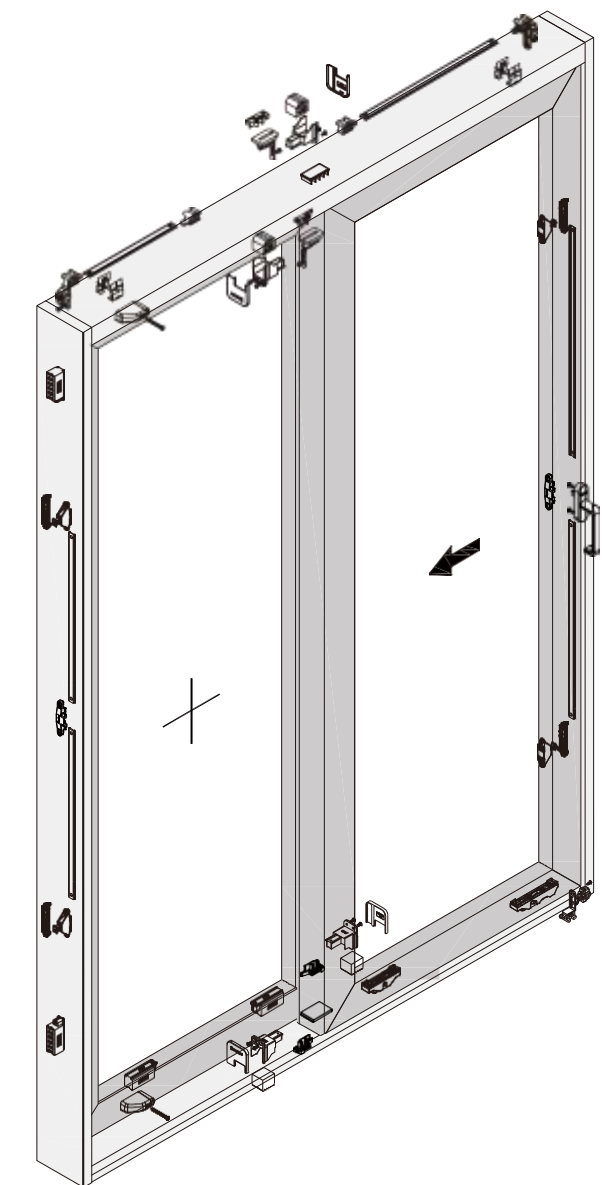

PRODUCTS

NS40.N.D Sliding Door System



Product Profile

NS40.N.D sliding door system is an ideal solution for indoor or areas with no additional requirements for thermal insulation. The frame is compatible with the side hinged door and window system to meet diverse demands. This system is moderate in price and combines advanced technology with beauty and simplicity.

Technical Parameters

Frame depth/mm	55mm&100mm
Sash depth/mm	38mm
Visible width of inner/outer frame/mm	51/29mm&51/51mm
Visible width of inner/outer sash/mm	55/55mm (vertical frame) & 78/78mm (horizontal frame)
Sash clamping glass thickness range/mm	16-24mm (open casement) / 16-34 (fixed casement)

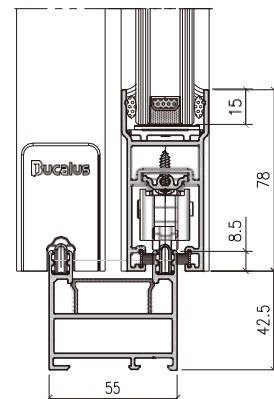

Performance

Thermal insulation	The K value for thermal insulation can reach 4.0W/m ² .k (Class 2) (depending on the glass configuration)
Sound proof	The attenuation value of sound after passing doors can reach 32 dB(Class 3) (depending on the glass configuration)
Air tightness	The value can reach 400 Pa (Class 4)
Water tightness	The value can reach 300 Pa (Class 3)
Wind load resistance	The value can reach 4000 Pa (Class 7)



Product Features

Superior security design

- Multi-point lock design and anti-misoperation design, more secure for use.

More convenient assembly

- Standard C-shape slot transmission, quick installation of hardware and accessories effectively improve the processing efficiency by 30%.

Larger window load bearing

- Equipped with large bearing pulley block and achieving up to 160 kg door application.

Longer service life

- Replaceable high-quality stainless steel rails, higher strength, longer life, smaller motion resistance and repeated opening design up to 120,000 times (GB 100,000 times), in accordance with the lifespan of 30 years.

Technical standard

- Compliance with EU CE standard, USA ASTM standard and Chinese GB standard.

Openable Dimension Range

Option of opening	Height-width ratio	Hardware load bearing	Dimension range(mm)				
			Net dimensions of sash (mm)		Module dimensions (mm)		
			Width FB	Height FH	Width W	Height H	Suggested dimensions
Sliding	FH/FB<2.5	80kg/160kg	<1180	<2400	<1200	<2500	900x2300

PRODUCTS

NS40.D Sliding Door System



Product Profile

NS40.D sliding door system is an ideal solution for indoor or areas with no additional requirements for thermal insulation. Its compact look makes the sliding door save the inside and outside room to the limit. It is compatible with the side hinged door and window system to meet diverse demands. This system is moderate in price and combines advanced technology with beauty and simplicity.

Technical Parameters

Frame depth/mm	55mm&100mm
Sash depth/mm	38mm
Visible width of inner/outer sash/mm	55/55mm (vertical frame) &78/78mm (horizontal frame)
	16-24mm (open casement)/ 16-34 (fixed casement)

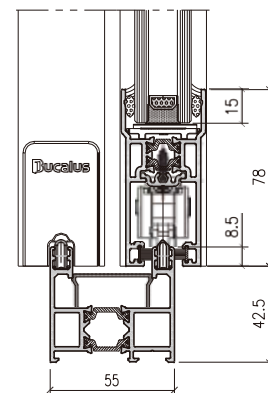

Performance

Thermal insulation	The K value for thermal insulation can reach 3.0W/m ² .k (Class 4) (depending on the glass configuration)
Sound proof	The attenuation value of sound after passing doors can reach 35 dB(Class 3) (depending on the glass configuration)
Air tightness	The value can reach 400 Pa (Class 4)
Water tightness	The value can reach 300 Pa (Class 3)
Wind load resistance	The value can reach 4000 Pa (Class 7)



Product Features

Superior security design

- Multi-points lock design and anti-misoperation design, more secure for use.

More convenient assembly

- Standard C-shape slot transmission, quick operation of hardware and accessories effectively improve the processing efficiency by 30%.

Larger window load bearing

- Equipped with large bearing pulley block and achieving up to 160 kg door application.

Longer service life

- Replaceable high-quality stainless steel rails, higher strength, longer life, smaller motion resistance
- Repeated opening design up to 120,000 times (GB 100,000 times), in accordance with the lifespan of 30 year.

Technical standard

- Compliance with EU CE standard, USA ASTM standard and Chinese GB standard

Openable Dimension Range

Option of opening	Height-width ratio	Hardware load bearing	Dimension range(mm)				
			Net dimensions of sash (mm)		Module dimensions (mm)		
			Width FB	Height FH	Width W	Height H	Suggested dimensions
Sliding	FH/FB<2.5	80kg/160kg	<1180	<2400	<1200	<2500	900x2300



PRODUCTS

NS40.N.D/NS40.D Sliding Door Hardware System

Hardware Configuration

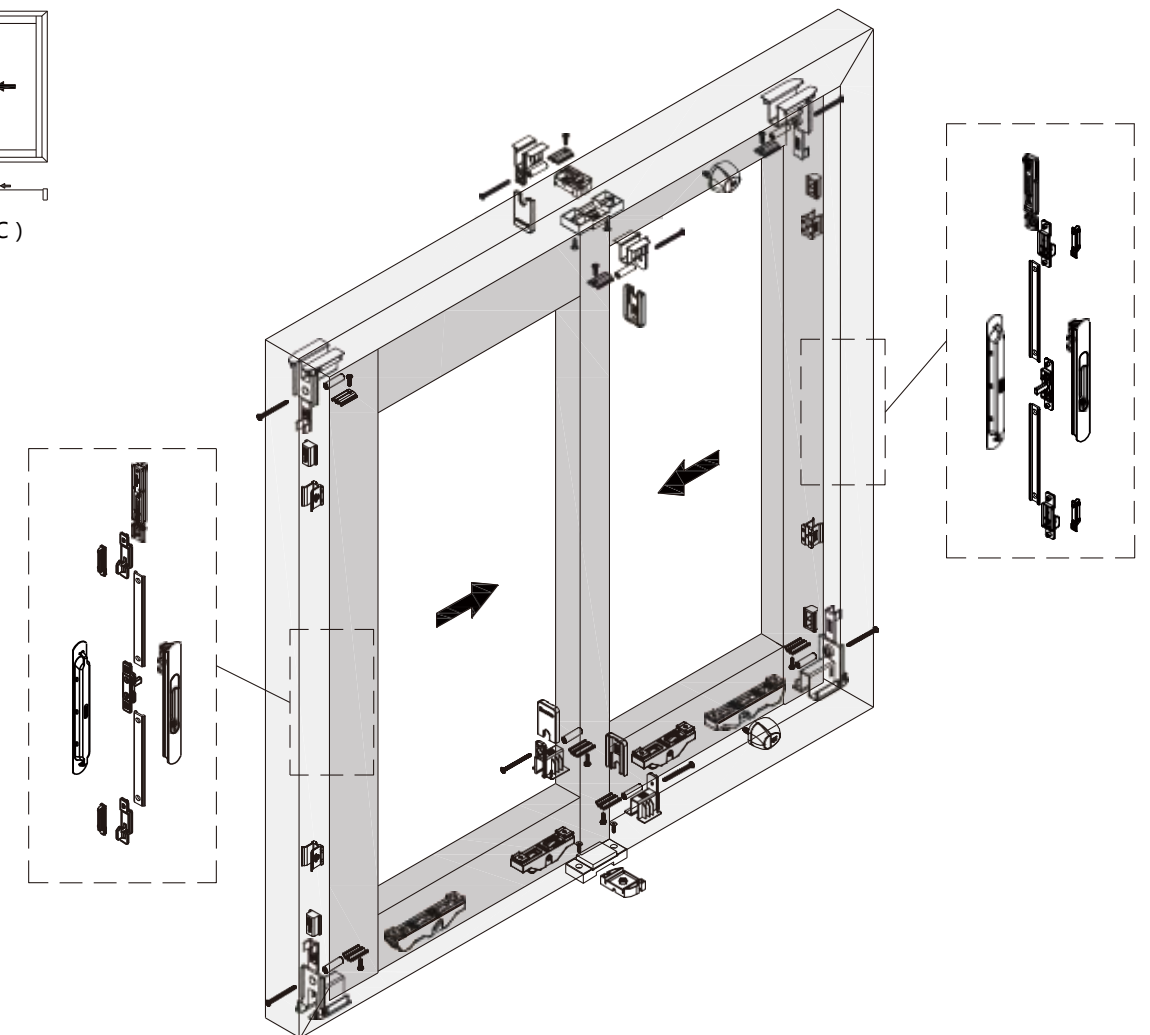
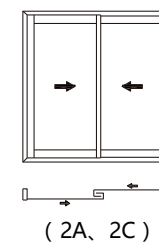

Hardware Features

Hardware fast assembly design

- Mature and standard processing technique is adopted to realize the fast assembly of the C-shaped hardware slots, effectively improving the processing efficiency by 70%.

Convenient installation design

- Mature and standard installing technique effectively improves the installing efficiency by 50%.

Security design

- The leaf frame blocks, the frame seal kit and the security blocks ensure the sealing and increase the safety performance as well.
- Patented locking technology can set multiple lock points, making it more reliable. With an anti-misoperation design, making it safer.

Hidden lock bracket

- Hidden lock point design makes it safer in use. It is beautiful in appearance and reliable in locking.

Anti-corrosion design for parts

- Capable of withstanding the neutral salt spray test 72 hours longer than that of the GB standard, suitable for coastal and harsh environments.

PRODUCTS

NS46 Slim Sliding Door System

Product Profile

NS46 slim sliding door system has excellent thermal insulation and more transparent and comfortable. It brings adequate sunlight in the room and attractive external view. Slender profile face width, frameless and super large sash width makes impressive panoramic sight view. It's the best solution to enjoy the external view.

Technical Parameters

Frame depth/mm	138mm
Sash depth/mm	46mm
Visible Width of Inner/Outer Frame	60mm
Visible Width of Inner/Outer Sash	13/25mm

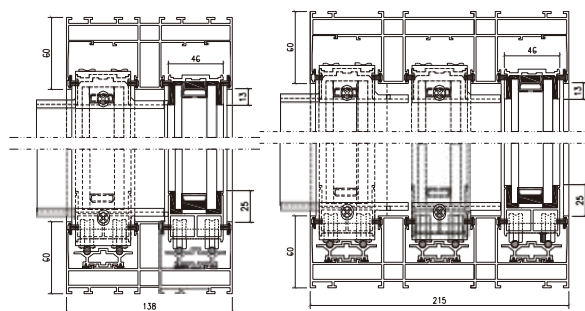

Performance

Thermal insulation	The K value for thermal insulation can reach 1.6W/m ² .K (Grade 7)
Sound proof	The attenuation value of sound after passing windows can reach 35dB (Grade 4) (Depending on glass configuration)
Air tightness	The value exceeds 400Pa (Grade 4)
Water tightness	The value exceeds 400 Pa (Grade 4)
Wind load resistance	The value can reach 3000Pa (Grade 5)

Openable Dimension Range

Option of opening	Height-width ratio	Hardware load bearing	Dimension range(mm)				
			Net dimensions of sash (mm)		Module dimensions (mm)		
			Width FB	Height FH	Width W	Height H	Suggested dimension s
Single leaf outward casement opening	FH/FB≥1	30kg/38kg	420~750	415~1700	470~800	460~1830	650x1200



Product Features

Innovative Design

- New frameless profile-integrated driver and locking system
- Innovative rail design with roller fitted into the track, withstanding large loading and easier for people to go in and out.

High Thermal Insulation

- Visible frame-sash ratio is small, making maximum thermal insulation

Fabulous sight view

- Large cave opening, large load bearing and three-sided concealed door leaf, it guarantees fabulous sight view of curtain wall in great extent

Technical Standard

- Meet EU CE standard, USA ASTM standard and China GB standard.

Hardware Features

Fast Assembly Design

- Standardized design of friction stay & rail, effectively improving installation efficiency

Ultra-high Sealing Performance Design

- Vertical lock structure independently guarantees the sealing performance of the windows

Security Design

- Friction stay with multi-angle positioning and excellent anti-falling function

Convenient Operation

- Force-saved swing operator design, to be operated casually.

Durability Design

- Hardware fittings are made through several layers of coating processing, with high quality coating effect and anti-corrosion function
- Certificated and compliance with AAMA904.1 standard

PRODUCTS

NS65.N Lift & Slide Door System



Product Profile

NS65.N lift and slide door system has diverse opening modes, with single rail frame, double rail frame and triple rail frame available. The barrier-free design of the low doorsill makes it easier for people to go in and out. Due to the joint efforts of the good air tightness, water tightness and sound insulation performance and the beautiful and stable reinforcement design, this product is applicable to extreme weather conditions where typhoons occur frequently. Its unique corner design with no stand columns gives the product a super-wide viewing angle, which makes the product the best choice for viewing platforms in high-end projects.

Technical Parameters

Frame depth/mm	150/235mm
Sash depth/mm	65mm
Visible width of inner/outer frame/mm	28/47.5mm
Visible width of inner/outer sash/mm	75/95mm
Sash's clamping glass thickness range/mm	20~44mm

Performance

Thermal insulation	The K value for thermal insulation can reach 3.5 W/m ² .k (Grade 3) (depending on the glass configuration)
Sound proof	The attenuation value of sound after passing doors can reach 35 dB(Grade 4) (depending on the glass configuration)
Air tightness	The value exceeds 600Pa (Grade 8)
Water tightness	The value can reach 600 Pa (Grade 5)
Wind load resistance	The value can reach 5000 Pa (Grade 9)

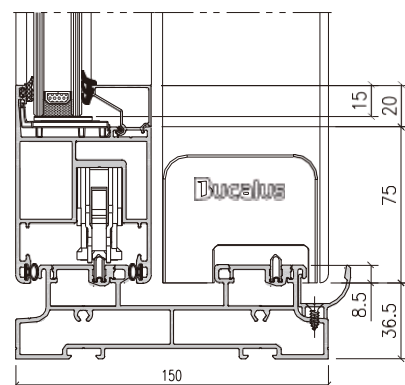

Product Features

Multifunctional door leaf application

- Meeting the large application demand of up to 400 kg on single leaf
- Providing electric and manual opening modes
- Providing diverse application choices: single rail, double rail, triple rail and 90°corner with no stand column.

Excellent whole door performance

- Unique special sealing design; water tightness level 5; air tightness level 8.

Human-centered design

- With the Bucalus proprietary lifting and assisting hardware mechanism, the operating force upon the handle can be reduced by 40%.

Longer service life

- Replaceable high-quality stainless steel rails, higher strength, longer life, smaller motion resistance
- Repeated opening design up to 120,000 times (GB 100,000 times), in accordance with the lifespan of 30 years.

Technical standard

- Compliance with EU CE standard, USA ASTM standard and Chinese GB standard.

Openable Dimension Range

Option of opening	Height-width ratio	Hardware load bearing	Dimension range(mm)				
			Net dimensions of sash (mm)		Module dimensions (mm)		
			Width FB	Height FH	Width W	Height H	Suggested dimensions
Lift and slide	FH/FB<2.5	300kg/400kg	720~2500	1800~3300	750~2530	1900~3400	1800x2300

PRODUCTS

NS65 Lift & Slide Door System



Product Profile

NS65 lift and slide door system has diverse opening modes, with single rail frame, double rail frame and triple rail frame available. The barrier-free design of the low doorsill makes it easier for people to go in and out. Due to the joint efforts of the good air tightness, water tightness and sound insulation performance and the beautiful and stable reinforcement design, this product is applicable to extreme weather conditions where typhoons occur frequently. With the wide heat insulation bar containing the heat insulation cotton, the product has obvious thermal insulation effects. All these together make the product very suitable to be used in projects where higher thermal insulation performance is required.

Technical Parameters

Frame depth/mm	150/235mm
Sash depth/mm	65mm
Visible width of inner/outer frame/mm	28/47.5mm
Visible width of inner/outer sash/mm	75/95mm
Sash's clamping glass thickness range/mm	20~44mm

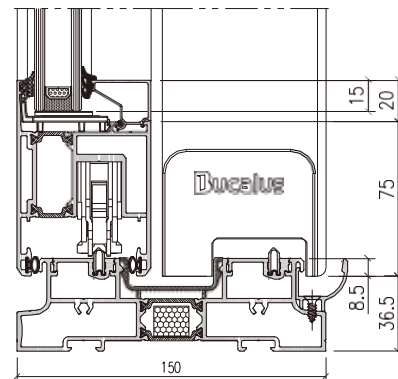

Performance

Thermal insulation	The K value for thermal insulation can reach 2.3 W/m ² .k (Grade 6) (depending on the glass configuration)
Sound proof	The attenuation value of sound after passing doors can reach 40 dB(Grade 5) (depending on the glass configuration)
Air tightness	The value exceeds 600Pa (Grade 8)
Water tightness	The value can reach 600 Pa (Grade 5)
Wind load resistance	The value can reach 5000 Pa (Grade 9)



Product Features

Multifunctional door leaf application

- Meeting the large application demand of up to 400 kg on single leaf
- Providing electric and manual opening modes,
- Providing diverse application choices: single rail, double rail, triple rail and 90°corner with no stand column.

Excellent whole door performance

- Unique special sealing design; water tightness level 5; air tightness level 8.

Human centered design

- With the Bucalus proprietary lifting and assisting hardware mechanism, the operating force upon the handle can be reduced by 40%.

Longer service life

- Replaceable high-quality stainless steel rails, higher strength, longer life, smaller motion resistance
- Repeated opening design up to 120,000 times (GB 100,000 times), in accordance with the lifespan of 30 years.

Technical standard

- Compliance with EU CE standard, USA ASTM standard and Chinese GB standard.

Openable Dimension Range

Option of opening	Height-width ratio	Hardware load bearing	Dimension range(mm)				
			Net dimensions of sash (mm)		Module dimensions (mm)		
			Width FB	Height FH	Width W	Height H	Suggested dimensions
Lift and slide	FH/FB<2.5	300kg/400kg	720~2500	1800~3300	750~2500	1900~3400	1800x2300

PRODUCTS

NS55.N 300 Lift & Slide Door System



Product Profile

NS55.N-300 lift and slide door system has diverse opening modes, with single rail frame, double rail frame and triple rail frame available. The barrier-free design of the low doorsill makes it easier for people to go in and out. Due to the good air tightness, water tightness and sound insulation performance and the beautiful and stable reinforcement design, this product is applicable to extreme weather conditions where typhoons occur frequently.

Technical Parameters

Frame depth/mm	130/205mm
Sash depth/mm	55mm
Visible width of inner/outer frame/mm	28/47.5mm
Visible width of inner/outer sash/mm	80/100mm
Sash's clamping glass thickness range/mm	10~34mm

Performance

Thermal insulation	The K value for thermal insulation can reach 3.5 W/m ² .k (Grade 3) (depending on the glass configuration)
Sound proof	The attenuation value of sound after passing doors can reach 31 dB(Grade 3) (depending on the hardware configuration)
Air tightness	The value exceeds 600Pa (Grade 8)
Water tightness	The value can reach 600 Pa (Grade 5)
Wind load resistance	The value can reach 4000 Pa (Grade 7)

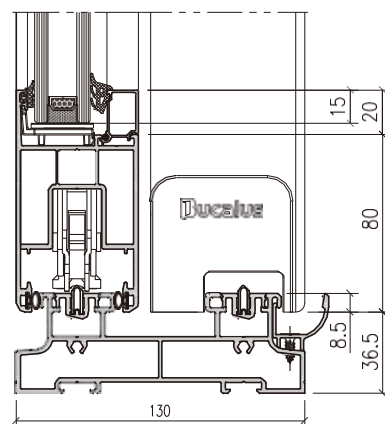

Product Features

Multifunctional door leaf application

- Meeting the large application demand of up to 400 kg on single leaf
- Providing electric and manual opening modes,
- Providing diverse application choices: single rail, double rail, triple rail and 90°corner with no stand column.

Excellent whole door performance

- Unique special sealing design; water tightness level 5; air tightness level 8.

Human centered design

- With the Bucalus proprietary lifting and assisting hardware mechanism, the operating force upon the handle can be reduced by 40%.

Longer service life

- Replaceable high-quality stainless steel rails, higher strength, longer life, smaller motion resistance
- Repeated opening design up to 120,000 times (GB 100,000 times), in accordance with the lifespan of 30 years.

Technical standard

- Compliance with EU CE standard, USA ASTM standard and Chinese GB standard.

Openable Dimension Range

Option of opening	Height-width ratio	Hardware load bearing	Dimension range(mm)				
			Net dimensions of sash (mm)		Module dimensions (mm)		
			Width FB	Height FH	Width W	Height H	Suggested dimensions
Lift and slide	FH/FB<2.5	300kg/400kg	720~2500	1800~3300	750~2530	1900~3400	1800x2300

PRODUCTS

NS55-300 Lift & Slide Door System



Product Profile

NS55-300 lift and slide door system has diverse opening modes, with single rail frame, double rail frame and triple rail frame available. The barrier-free design of the low doorsill makes it easier for people to go in and out. Due to the joint efforts of the good air tightness, water tightness and sound insulation performance and the beautiful and stable reinforcement design, this product is applicable to extreme weather conditions where typhoons occur frequently. All these together make the product suitable to be used in high-end projects where basic thermal insulation is required.

Technical Parameters

Frame depth/mm	130/205mm
Sash depth/mm	55mm
Visible width of inner/outer frame/mm	28/47.5mm
Visible width of inner/outer sash/mm	80/100mm
Sash's clamping glass thickness range/mm	10~34mm

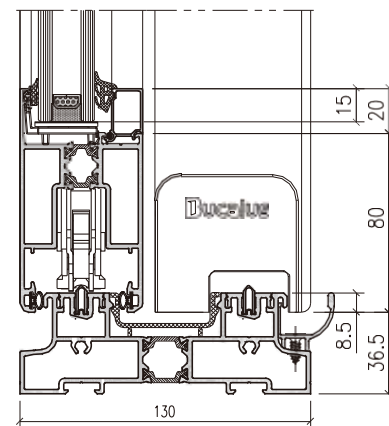

Performance

Thermal insulation	The K value for thermal insulation can reach 2.4 W/m ² .k (Grade 6) (depending on the glass configuration)
Sound proof	The attenuation value of sound after passing doors can reach 36 dB(Grade 4) (depending on the glass configuration)
Air tightness	The value exceeds 600Pa (Grade 8)
Water tightness	The value can reach 600 Pa (Grade 5)
Wind load resistance	The value can reach 4000 Pa (Grade 7)



Product Features

Multifunctional door leaf application

- Meeting the large application demand of up to 400 kg on single leaf
- Providing electric and manual opening modes,
- Providing diverse application choices: single rail, double rail, triple rail and 90°corner without stand column.

Excellent whole door performance

- Unique special sealing design; water tightness level 5; air tightness level 8.

Human centered design

- With the Bucalus proprietary lifting and assisting hardware mechanism, the operating force upon the handle can be reduced by 40%.

Longer service life

- Replaceable high-quality stainless steel rails, higher strength, longer life, smaller motion resistance
- Repeated opening design up to 120,000 times (GB 100,000 times), in accordance with the lifespan of 30 years.

Technical standard

- Compliance with EU CE standard, USA ASTM standard and Chinese GB standard.

Openable Dimension Range

Option of opening	Height-width ratio	Hardware load bearing	Dimension range(mm)				
			Net dimensions of sash (mm)		Module dimensions (mm)		
			Width FB	Height FH	Width W	Height H	Suggested dimensions
Lift and slide	FH/FB<2.5	300kg/400kg	720~2500	1800~3300	750~2530	1900~3400	1800x2300



PRODUCTS

NS Lift & Slide Door Hardware System

Hardware Configuration

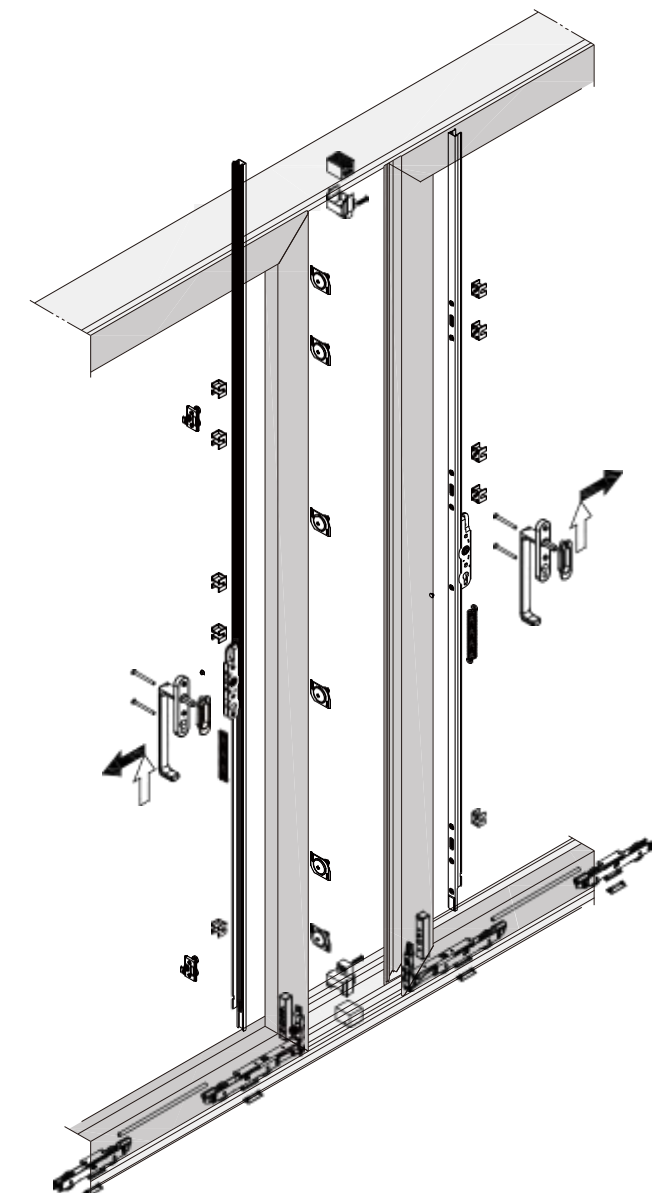
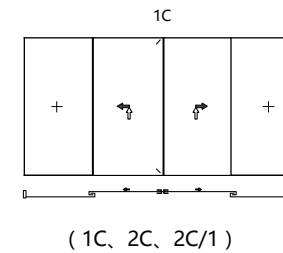

Hardware Features

European standard slots

- Using the European standard commonly used U-shape slots with the hardware mature and stable.

Hardware load bearing

- One single leaf can bear 400 KG, the load bearing of an super-large door leaf with its dimension as below: about width x height=4.2mx2.5m.

Handle and transmission mechanism

- The lift-up door handle has the buffering function, which can effectively avoid the handle springback.

Superior anti-corrosion design for parts

- Capable of withstanding the neutral salt spray test 240 hours longer than that of the EU standard, more suitable for coastal and harsh environments.



Luxury handle

Standard handle



Luxury handle

Standard handle

More type of handles are available

PRODUCTS

NFD70 Folding Door System



Product Profile

NFD70 folding door system can realize the folio opening of a total of 14 leaves with each single leaf's door height being 3 meters. It is the best solution for ultra-large cave opening. The width of the folding doors is the same. The simple appearance brings the building extremely concise and beautiful visual effects. It is suitable for the projects where basic thermal insulation requirements are to be met.

Technical Parameters

Frame depth/mm	84mm
Sash depth/mm	70mm
Visible width of inner/outer frame/mm	55/55mm
Visible width of inner/outer sash/mm	51/71mm
Sash's clamping glass thickness range/mm	20~44mm

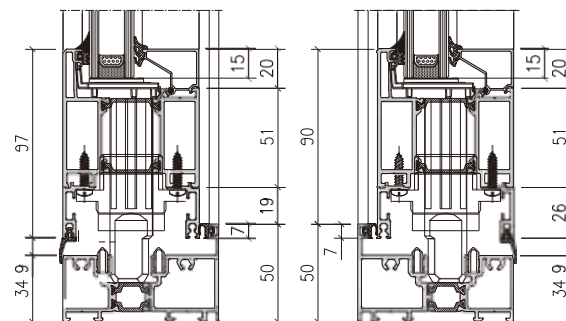

Performance

Thermal insulation	The K value for thermal insulation can reach 2.3 W/m ² .k (Grade 6) (depending on the glass configuration)
Sound proof	The attenuation value of sound after passing doors can reach 35 dB(Grade 4) (depending on the glass configuration)
Air tightness	The value can reach 600 Pa (Grade 6)
Water tightness	The value can reach 500 Pa (Grade 5)
Wind load resistance	The value can reach 5000 Pa (Grade 9)



Product Features

Larger opening area

- Realizing 90% cave opening area and larger opening demand.

Full sealing design

- Separately sealing each door leaf, water tightness level 5, air tightness level 6.

Human centered design

- Bucalus proprietary hardware mechanism for folding doors, making the opening and closing smoother and more stable, thus effectively reducing the noise when opening and closing ;
- Unique hand-pinching-proof design to ensure safety to the greatest extent.

Longer service life

- Replaceable high-quality stainless steel rails, higher strength, longer life, smaller motion resistance.
- Embedded adjustable frame design and bottom bearing design;
- Repeated opening design up to 120,000 times (GB 100,000 times), in accordance with the lifespan of 30 years.

Technical standard

- Compliance with EU CE standard, USA ASTM standard and Chinese GB standard.

Openable Dimension Range

Option of opening	Height-width ratio	Hardware load bearing	Dimension range(mm)				
			Net dimensions of sash (mm)		Module dimensions (mm)		
			Width FB	Height FH	Width W	Height H	Suggested dimensions
Side-hinged opening	FH/FB<2.5	90kg	<1100	<3300	<1200	<3400	850x2300



PRODUCTS

NFD70 Folding Door Hardware System

Hardware Features

Transmission design advantages

•The locking actuator positions with the lumen of the section bars. The processing is simple and the processing efficiency will be improved effectively.

Superior bolt design

•Independent heaven and earth bolt mechanism locks firmly. The proper use of cavity configuration of the proximate matters reduces processing techniques and improves appearance and quality.

Powerful pulley mechanism

- Proprietary backboard and position bars designs: fast installation, precision guarantee.
- Stainless steel pulley: Smooth and stable sliding, of high intensity and durable.
- Nylon guide rollers: of high intensity and stable.

Excellent noise reduction design

•Bolt, guide and top nylon guide roller are made of high quality materials respectively, which greatly reduce the noise in opening, closing and moving.

Anti-corrosion design for parts

•Capable of withstanding the neutral salt spray test 72 hours longer than that of the GB standard, suitable for coastal and harsh environments.

Hardware Configuration

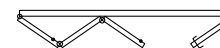
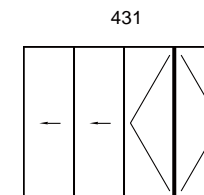

ikezhou
2015-11-04 10:51:24

Bi-Folding



Luxury handle

Standard handle

More type of handles are available

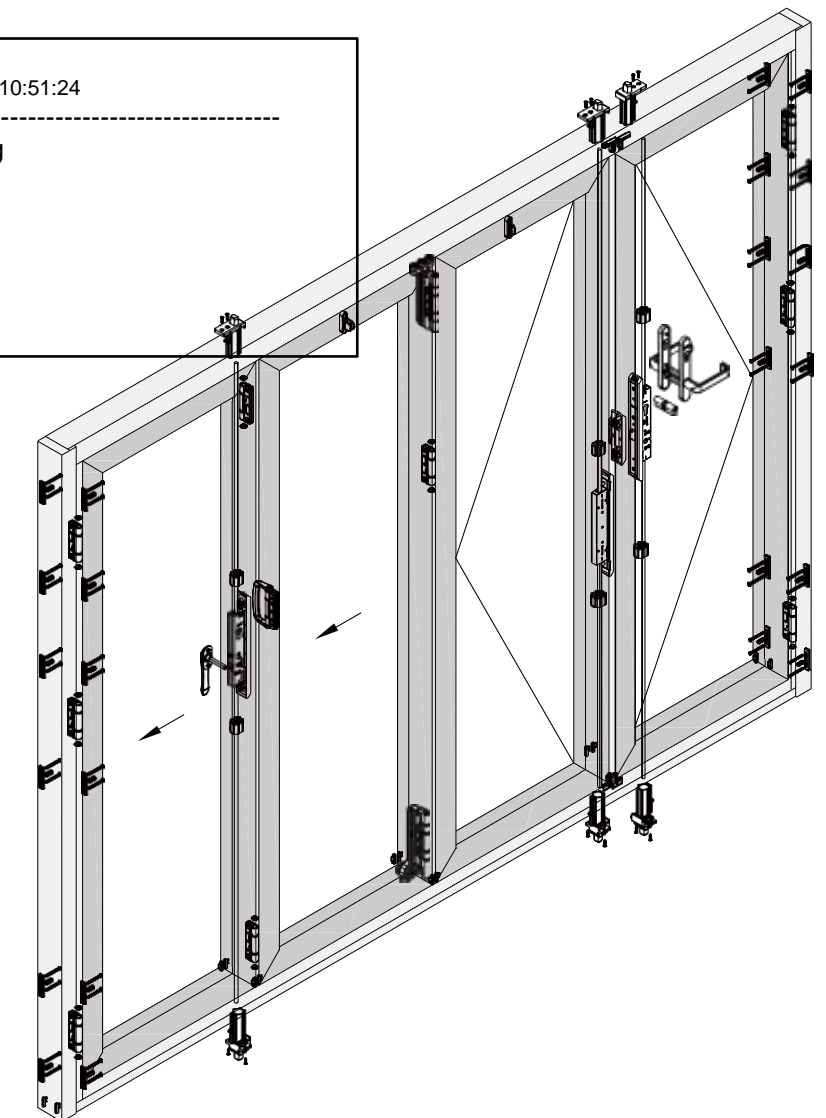

CASE REFERENCE



↳ The Hanking Hillside Villas, Shenzhen



National Seashore. Poly Wealth Center ↳



↗ Vanke Jiulong Mountain Villa, Shenzhen

↘ Grand Mansion of Poly, Guangzhou

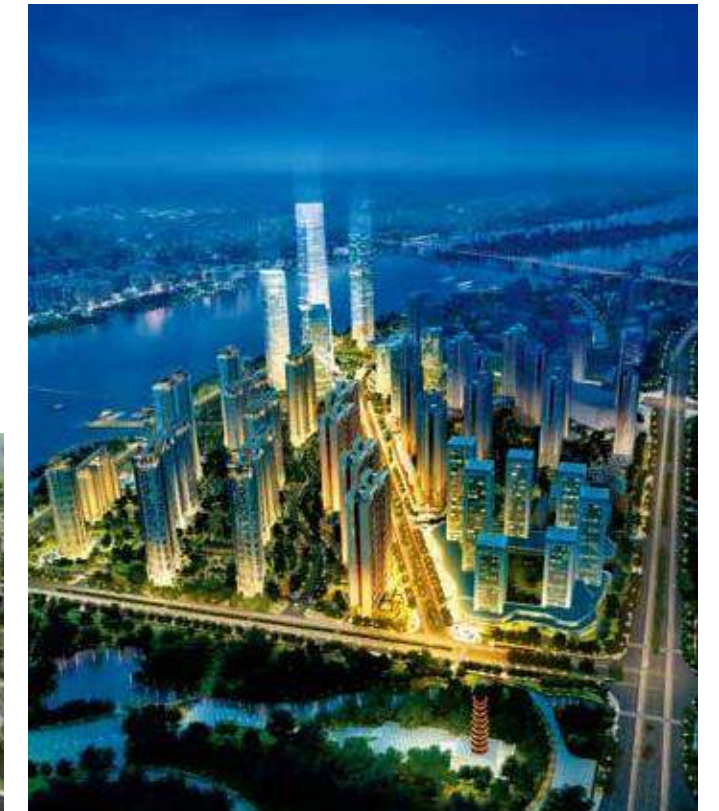

↘ Shenzhen Center .One Palace



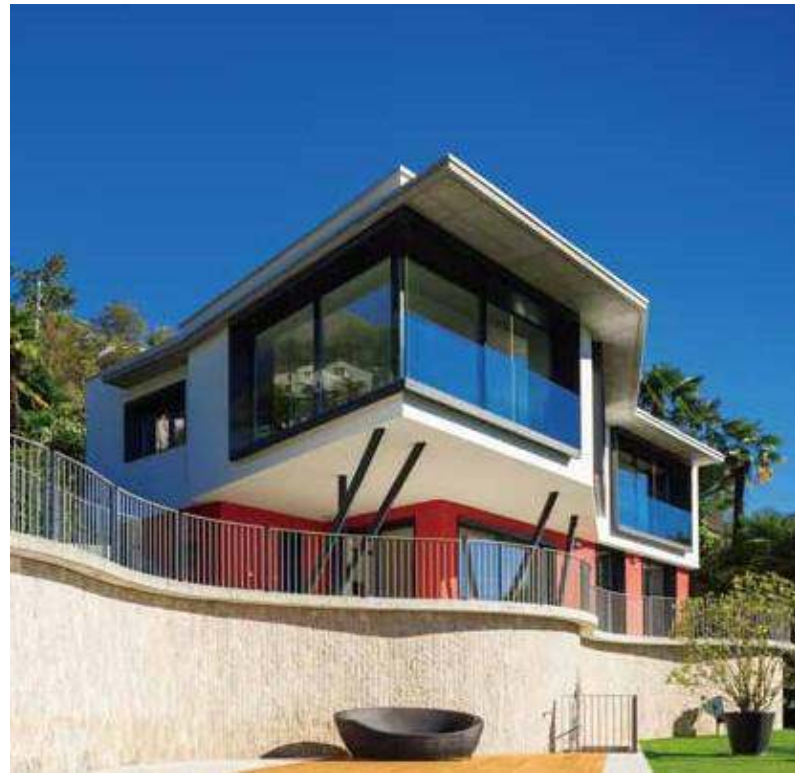

7 Dayi Villa, Guangzhou



7 China Merchants Hilton Hotel, Shenzhen



7 One City of Vanke, Shenzhen

7 The Landcom Hill Manor, Shenzhen



CASE REFERENCE



7 Waihonua at Kewalo, Honolulu, Hawaii



7 Qatar Samrya Building



Abu Dhabi Nation Building



The Collection,
South street & ALA
Moana Blvd., Honolulu,
Hawaii



New York HL23 Town



55 Ninth Street